



# INSTRUCTIONS

J06022

2023-02-26



## FAIRING BRACKET KIT

### GENERAL INFORMATION

Table 1. General Information

Kits	Suggested Tools	Skill Level <sup>(1)</sup>
47200278	Safety Glasses, Torque Wrench	
<i>(1) Tightening to torque value or other moderate tools and techniques required</i>		

### KIT CONTENTS

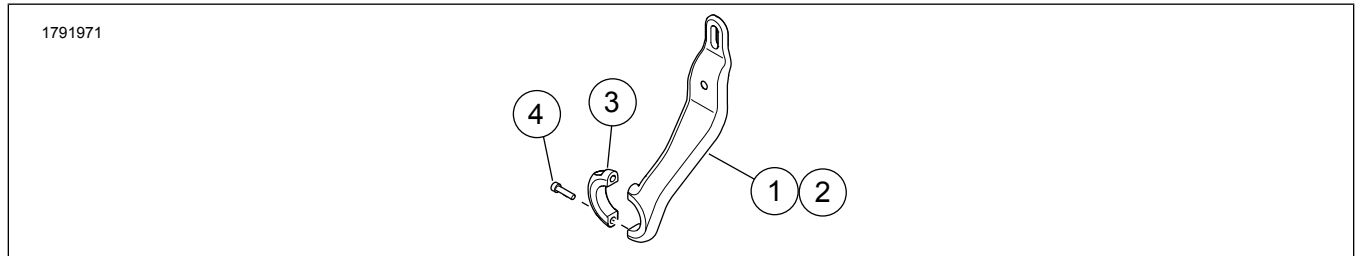

Figure 1. Kit Contents: Fairing Bracket Kit

Table 2. Kit Contents: Fairing Bracket Kit

<input checked="" type="checkbox"/>	Verify that all contents are present in the kit before installing or removing items from vehicle.				
	Item	Qty	Description	Part No.	Notes
<input type="checkbox"/>	1	1	Support bracket, fairing, right	Not sold separately	Shown
<input type="checkbox"/>	2	1	Support bracket, fairing, left	Not sold separately	Not shown
<input type="checkbox"/>	3	2	Clamp	47200281	
<input type="checkbox"/>	4	4	Screw	10201256	

### GENERAL

#### Models

For model fitment information, see the Parts and Accessories (P&A) Retail Catalog or the Parts and Accessories section of [www.harley-davidson.com](http://www.harley-davidson.com).

Verify that the most current version of the instruction sheet is used. It is available at: [h-d.com/isheets](http://h-d.com/isheets)

Contact Harley-Davidson Customer Support Center at 1-800-258-2464 (U.S. only) or 1-414-343-4056.

### Installation Requirements

#### ⚠ WARNING

Rider and passenger safety depend upon the correct installation of this kit. Use the appropriate service manual procedures. If the procedure is not within your capabilities or you do not have the correct tools, have a Harley-Davidson dealer perform the installation. Improper installation of this kit could result in death or serious injury. (00333b)

#### NOTE

This instruction sheet references service manual information. A service manual for the year and model motorcycle is required for this installation and is available from:

- A Harley-Davidson dealer.
- H-D Service Information Portal, a subscription-based access available for most 2001 and newer models. For more information see *Frequently ask questions about subscriptions*.

## **REMOVE**

1. Remove existing support brackets. See service manual.

## **INSTALL**

1. Install new support brackets. See service manual.
  - a. Use threadlocker on screws (4).  
LOCTITE 271 HIGH STRENGTH THREADLOCKER  
AND SEALANT (RED) (Loctite 271)