



INSTRUCTIONS

94100538

2024-01-23



HD ROULETTE 19 IN. FRONT WHEEL

GENERAL INFORMATION

Table 1. General Information

Kits	Suggested Tools	Skill Level ⁽¹⁾
43301047, 43301048	Safety Glasses, Torque Wrench, Wheel Bearing Puller and Installer	
<i>(1) Tightening to torque value or other moderate tools and techniques required</i>		

KIT CONTENTS

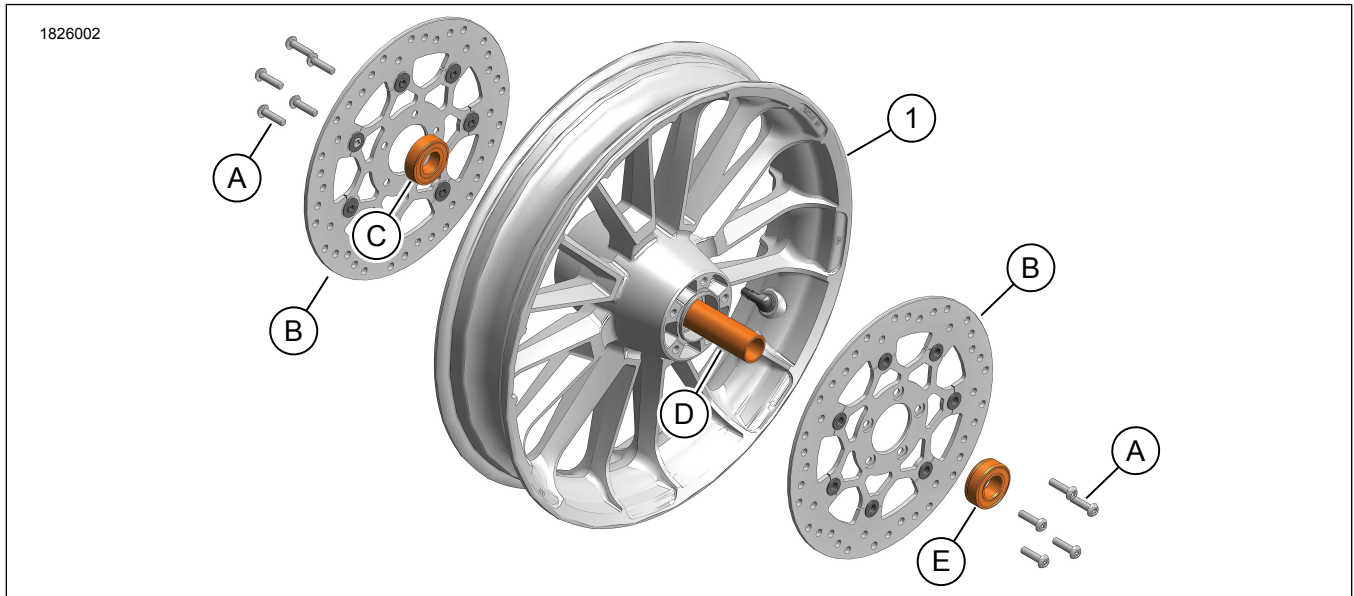

Figure 1. Kit Contents: HD Roulette 19 in. Wheel

Table 2. Kit Contents: HD Roulette 19 in. Wheel

Verify that all contents are present in the kit before installing or removing items from vehicle.					
<input checked="" type="checkbox"/>	Item	Qty	Description	Part No.	Notes
<input type="checkbox"/>	1	1	HD Roulette 19 in. Wheel, gloss black	Not sold separately	
<input type="checkbox"/>		1	HD Roulette 19 in. Wheel, gloss black with machined highlights	Not sold separately	
Items mentioned, but not included in kit					
<input checked="" type="checkbox"/>	A	1	Screw (Qty. 10): See Installation Requirements		
<input checked="" type="checkbox"/>	B	1	Brake rotor (Qty. 2): See Installation Requirements		
<input checked="" type="checkbox"/>	C	1	Bearing, right (Part No. 9252A)		
<input checked="" type="checkbox"/>	D	1	Bearing spacer (Part No. 41900-08)		
<input checked="" type="checkbox"/>	E	1	Bearing, left (Part No. 9276B)		

GENERAL

Models

For model fitment information, see the Parts and Accessories (P&A) Retail Catalog or the Parts and Accessories section of www.harley-davidson.com.

Verify that the most current version of the instruction sheet is used. It is available at: h-d.com/isheets

Contact Harley-Davidson Customer Support Center at 1-800-258-2464 (U.S. only) or 1-414-343-4056.

Installation Requirements

▲ WARNING

Rider and passenger safety depend upon the correct installation of this kit. Use the appropriate service manual procedures. If the procedure is not within your capabilities or you do not have the correct tools, have a Harley-Davidson dealer perform the installation. Improper installation of this kit could result in death or serious injury. (00333b)

NOTE

This instruction sheet references service manual information. A service manual for the year and model motorcycle is required for this installation and is available from:

- A Harley-Davidson dealer.
- H-D Service Information Portal, a subscription-based access available for most 2001 and newer models. For more information see *Frequently ask questions about subscriptions*.

These items are available at your local Harley-Davidson dealership.

- Separate purchase of two Brake Disc (Part No. 41500068) or Split 7 Spoke Front Brake Rotor (Part No. 41500107) is required for installation.
- Separate purchase of ten Torx Pan Head Screws (Part No. 3655A) or two Front Brake Disc Hardware Kits (Part No. 46646-05) is required for installation.
- Separate purchase of Tire Pressure Monitoring System (TPMS) stem for Japan (Part No. 42300143) is required for installation.
- Separate purchase of TPMS stem for Non-Japan (Part No. 42300142) is required for installation.
- Separate purchase of Valve Stem (Part No. 40999-87) is required for installation on vehicles not equipped with TPMS

PREPARE

1. Raise front wheel. See service manual.
2. Remove front brake calipers from fork. Support calipers. See service manual.

REMOVE

1. Remove Original Equipment (OE) wheel. See service manual.

2. See Figure 1. Remove front brake rotors.
 - a. Remove screws (A).
 - b. Remove OE front brake rotors (B).
3. Remove front tire.
4. Remove and discard sealed wheel bearings (C, E).
5. Remove wheel bearing spacer (D).
6. If equipped with TPMS, see service manual.

INSTALL

1. If equipped with TPMS, see service manual.
2. Install tire.
3. See Figure 1. Install bearing spacer (D) and **new** sealed wheel bearings (C, D).

NOTE

When installing front brake rotors, align rivets of both rotors.

4. Install brake rotors (B) using **new** screws (A). Tighten in a cross-wise pattern.
Torque: 21.7–32.5 N·m (16–24 ft-lbs)
5. Install wheel. See service manual.

COMPLETE

1. Install front brake calipers from fork. See service manual.