



INSTRUCTIONS

J05140

2024-01-23



TRIKE REAR WHEEL

GENERAL INFORMATION

Table 1. General Information

Kits	Suggested Tools	Skill Level ⁽¹⁾
40900070, 40900651, 40901028, 40901029	Safety Glasses, Torque Wrench	
<i>(1) Tightening to torque value or other moderate tools and techniques required</i>		

KIT CONTENTS

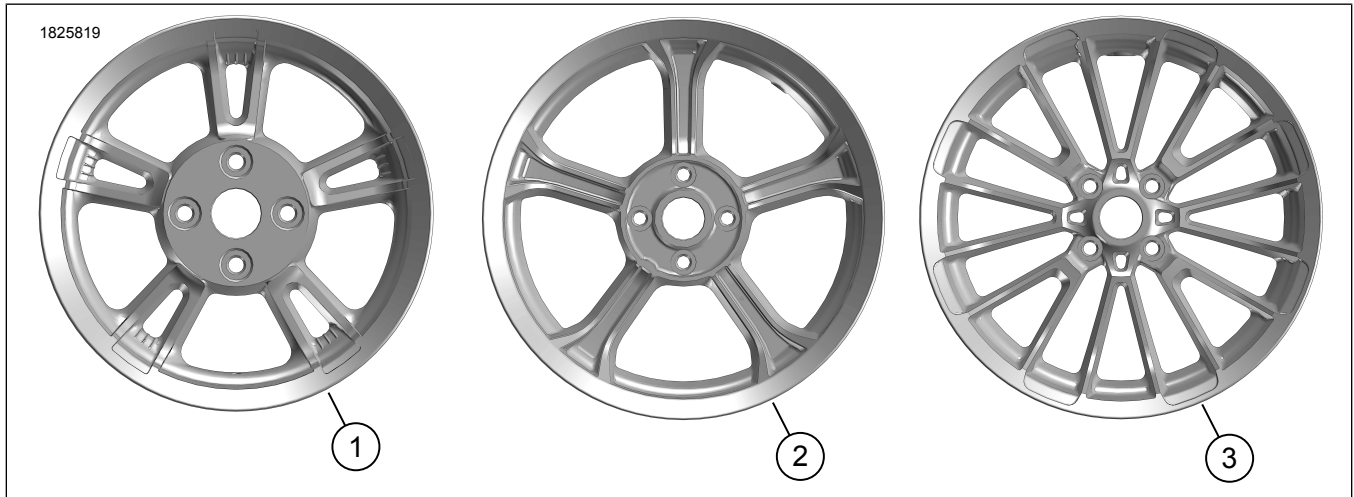

Figure 1. Kit Contents: Trike Rear Wheel

Table 2. Kit Contents: Trike Rear Wheel

<input checked="" type="checkbox"/>	Verify that all contents are present in the kit before installing or removing items from vehicle.				
Item	Qty	Description	Part No.	Notes	
<input type="checkbox"/>	1	Enforcer 15 in. Wheel, chrome	40900070		
<input type="checkbox"/>	2	Tomahawk 18 in. Wheel, gloss black with machined highlights	40900651		
<input type="checkbox"/>	3	Roulette 18 in. Wheel, gloss black	40901028		
<input type="checkbox"/>		Roulette 18 in. Wheel, gloss black with machined highlights	40901029		

GENERAL

Models

For model fitment information, see the Parts and Accessories (P&A) Retail Catalog or the Parts and Accessories section of www.harley-davidson.com.

Verify that the most current version of the instruction sheet is used. It is available at: h-d.com/isheets

Contact Harley-Davidson Customer Support Center at 1-800-258-2464 (U.S. only) or 1-414-343-4056.

Installation Requirements

⚠ WARNING

Rider and passenger safety depend upon the correct installation of this kit. Use the appropriate service manual procedures. If the procedure is not within your capabilities or you do not have the correct tools, have a Harley-Davidson dealer perform the installation. Improper installation of this kit could result in death or serious injury. (00333b)

NOTE

This instruction sheet references service manual information. A service manual for the year and model motorcycle is required for this installation and is available from:

- A Harley-Davidson dealer.
- H-D Service Information Portal, a subscription-based access available for most 2001 and newer models. For more information see Frequently ask questions about subscriptions.

PREPARE

1. Remove seat. See service manual.
2. Remove left side cover. See service manual.
3. Remove main fuse. See service manual.
4. Position jack to lift rear of vehicle. See service manual.

REMOVE

1. Before lifting vehicle, set parking brake and loosen four lug nuts in a crosswise pattern. Raise jack.
2. Remove center hub cap, if equipped.
3. Remove lug nuts and pull wheel from axle flange studs.
4. See Figure 2. If necessary, remove center cap.
 - a. Remove screw (4) and washer (3).
 - b. Remove backplate (2).
 - c. Remove center cap (1).
5. If equipped with Tire Pressure Monitoring System (TPMS), see service manual.

INSTALL

1. If equipped with TPMS, see service manual.
2. See Figure 2. If necessary, install center cap.
 - a. Apply threadlocker to screw (4).
LOCTITE 243 MEDIUM STRENGTH
THREADLOCKER AND SEALANT (BLUE)
(99642-97)
 - b. Install center cap (1).
 - c. Install backplate (2).
 - d. Install washer (3) and screw (4). Tighten.
Torque: 8–10.8 N·m (71–96 in-lbs)
3. Install wheel and tighten lug nuts to in a cross-wise pattern.
Torque: 122–135.6 N·m (90–100 ft-lbs)

4. Check lug nut torque within:
805–1,610 km (500–1,000 mi)

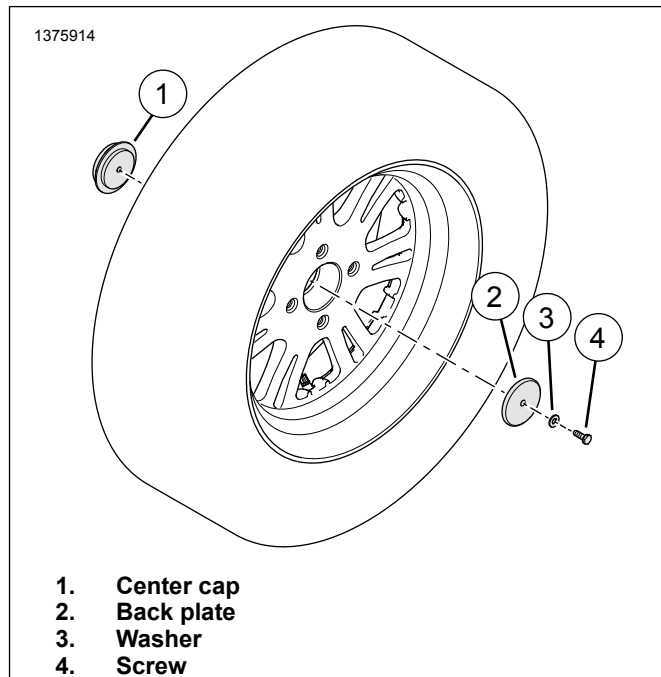

Figure 2. Center Cap

COMPLETE

1. Install main fuse. See service manual.
2. Install left side cover. See service manual.
3. Install seat. See service manual.