



INSTRUCTIONS

J06776

2024-01-24



RIDER FOOTBOARD

GENERAL INFORMATION

Table 1. General Information

Kits	Suggested Tools	Skill Level ⁽¹⁾
50501679, 50501648, 50501938, 50501939, 50501945, 50502526, 50502527	Safety Glasses, E-Clip tool	
<i>(1) Tightening to torque value or other moderate tools and techniques required</i>		

KIT CONTENTS

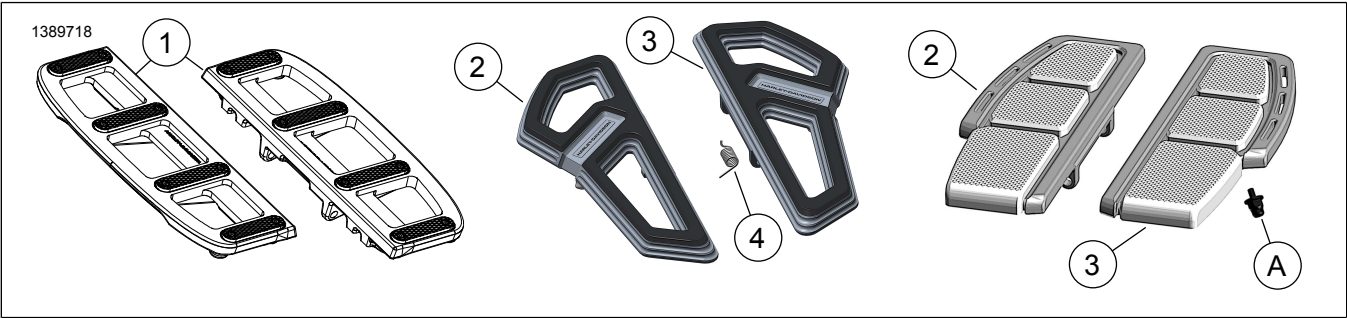

Figure 1. Kit Contents: Rider Footboard Components

Table 2. Kit Contents: Rider Footboard Components

<input checked="" type="checkbox"/>	Item	Qty	Description	Part No.	Notes
<input type="checkbox"/>	1	2	Footboard Assembly, graphite	50502097	
<input type="checkbox"/>			Footboard Assembly, black	50502098	
<input type="checkbox"/>				50502487	Kit 50502526
<input type="checkbox"/>			Footboard Assembly, silver	50502489	Kit 50502527
<input type="checkbox"/>	2	1	Footboard, left, black	50501940	
<input type="checkbox"/>			Footboard, left, machine cut	50501936	
<input type="checkbox"/>			Footboard, left, chrome	50501948	
<input type="checkbox"/>			Footboard, left, gray	50502335	
<input type="checkbox"/>			Footboard, left, black	50502334	
<input type="checkbox"/>	3	1	Footboard, right, black	50501944	
<input type="checkbox"/>			Footboard, right, machine cut	50501942	
<input type="checkbox"/>			Footboard, right, chrome	50501947	
<input type="checkbox"/>			Footboard, right, gray	50502333	
<input type="checkbox"/>			Footboard, right, black	50502332	
<input type="checkbox"/>	4	2	Spring	50502463	Kits 50501938, 50501939, 50509145
<input type="checkbox"/>	5	2	Wear plate (see Figure 4)	50502575	Kits 50502526, 50502527
<input type="checkbox"/>	6	2	Screw, wear plate (see Figure 4)	10200659	Kits 50502526, 50502527
Service Part					
<input type="checkbox"/>	A	1	Wear peg	50500628	Kits 50501938, 50501939, 50509145, 50502256, 50502257

NOTE

Verify that all contents are present in the kit before installing or removing items from vehicle.

GENERAL**Models**

For model fitment information, see the P&A Retail Catalog or the Parts and Accessories section of www.harley-davidson.com (English only).

Verify that the most current version of the instruction sheet is used. It is available at: www.harley-davidson.com/isheets

Contact Harley-Davidson Customer Support Center at 1-800-258-2464 (U.S. only) or 1-414-343-4056.

Installation Requirements

E-CLIP TOOL (PART NUMBER: HD-52369)

⚠ WARNING

Rider and passenger safety depend upon the correct installation of this kit. If the procedure is not within your capabilities or you do not have the correct tools, have a Harley-Davidson dealer perform the installation. Improper installation of this kit could result in death or serious injury. (00308b)

REMOVE

1. See Figure 2. Remove E-clip (3), clevis pin (1) and return torsion spring (2).
2. Remove footboard.
3. Save hardware for **new** footboard installation.
4. Clean and inspect footboard brackets.
5. Replace if worn, rusted or damaged.

INSTALL

1. Install footboard.
 - a. **Kits 50501679, 50501648, 50502256, 50502257:** See Figure 2. Insert short end of Original Equipment (OE) torsion spring (2) into forward most hole in footboard.
 - b. **Kits 50501938, 50501939, 50501945:** See Figure 1. Insert short end of **new** torsion spring (4) into forward most hole in footboard.
 - c. While holding torsion spring (2) in place, install footboard and torsion spring onto mounting bracket.
 - d. Install clevis pin (1).
 - e. Install E-clip (3).
 - f. Rotate footboard up and push torsion spring (2) into slot on mounting bracket.
2. Check that footboard pivots freely on clevis pin (1).
3. Repeat steps 1 and 2 on opposite side.

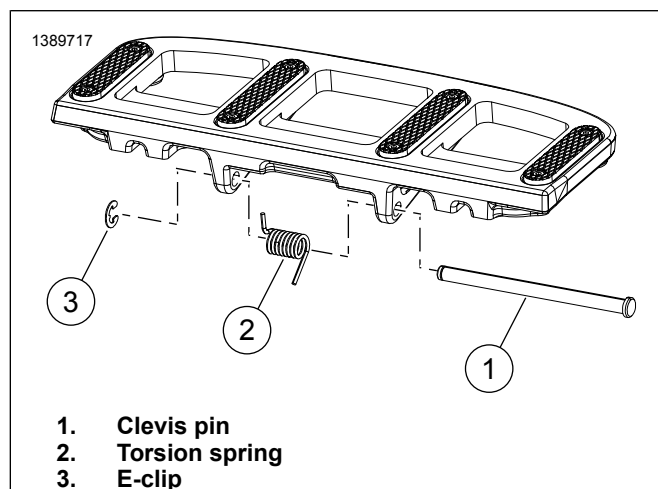

Figure 2. Rider Footboard Kit

Wear Peg Replacement

1. See Figure 3. Remove existing wear peg (1) from floorboard.
2. Apply 2 or 3 drops of threadlocker to threads of **new** wear peg (1) and install.

Consumable: LOCTITE 243 MEDIUM STRENGTH THREADLOCKER AND SEALANT (BLUE) (99642-97)
3. Tighten wear peg (1).

Torque: 3.4–4.8 N·m (30–42 **in-lbs**) *Wear peg*

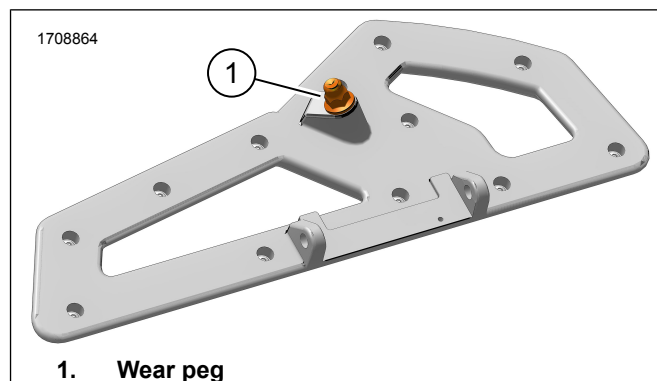

Figure 3. Floorboard Wear Peg (typical)

Wear Plate Replacement

1. See Figure 4. When servicing wear plate (1), remove existing wear plate screws (2).
2. Apply two or three drops of threadlocker to threads of screws.

Consumable: LOCTITE 243 MEDIUM STRENGTH THREADLOCKER AND SEALANT (BLUE) (99642-97)
3. Install **new** wear plate and screws.

Torque: 2.03 N·m (18 **in-lbs**)

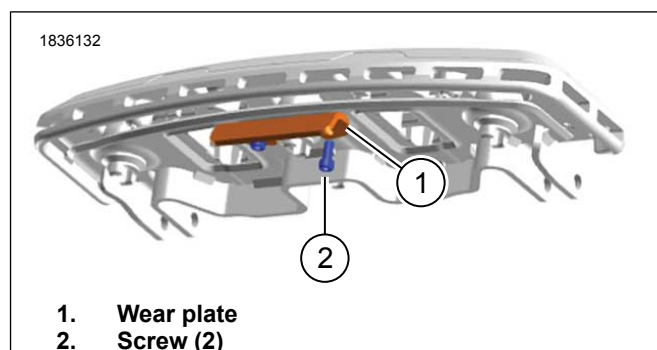

Figure 4. Floorboard Wear Plate