



INSTRUCTIONS

94100601

2023-09-11



TOUR-PAK SPACER KIT

GENERAL INFORMATION

Table 1. General Information

Kits	Suggested Tools	Skill Level ⁽¹⁾
53001105A	Safety Glasses, Torque Wrench	
(1) Tightening to torque value or other moderate tools and techniques required		

KIT CONTENTS

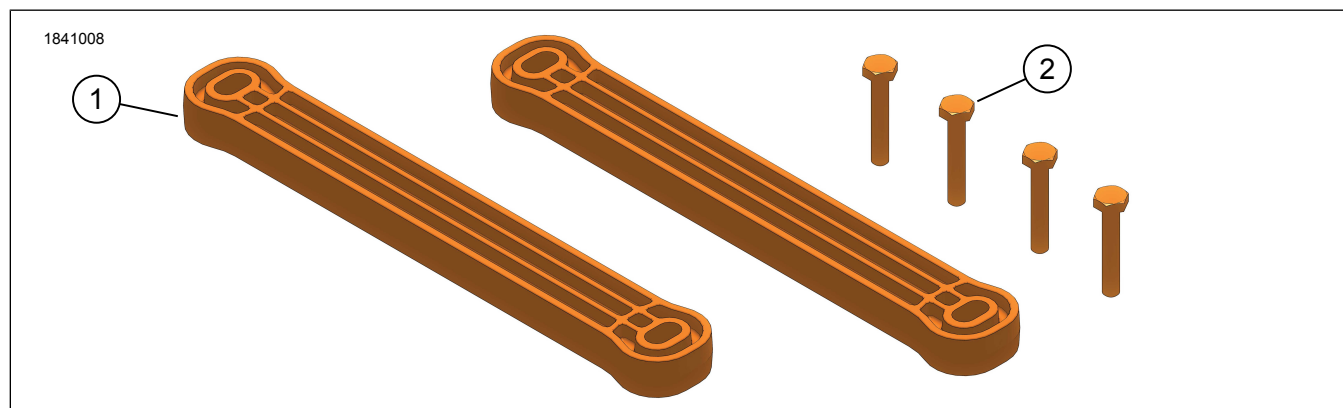

Figure 1. Kit Contents: Tour-Pak Spacer Kit

Table 2. Kit Contents: Tour-Pak Spacer Kit

<input checked="" type="checkbox"/>	Verify that all contents are present in the kit before installing or removing items from vehicle.				
	Item	Qty	Description	Part No.	Notes
<input type="checkbox"/>	1	2	Spacer	53001104	
<input type="checkbox"/>	2	4	Screw	2872W	

GENERAL

Models

For model fitment information, see the Parts and Accessories (P&A) Retail Catalog or the Parts and Accessories section of www.harley-davidson.com.

Verify that the most current version of the instruction sheet is used. It is available at: h-d.com/isheets

Contact Harley-Davidson Customer Support Center at 1-800-258-2464 (U.S. only) or 1-414-343-4056.

Installation Requirements

▲ WARNING

Rider and passenger safety depend upon the correct installation of this kit. Use the appropriate service manual procedures. If the procedure is not within your capabilities or you do not have the correct tools, have a Harley-Davidson dealer perform the installation. Improper installation of this kit could result in death or serious injury. (00333b)

NOTE

This instruction sheet references service manual information. A service manual for the year and model motorcycle is required for this installation and is available from:

- A Harley-Davidson dealer.
- H-D Service Information Portal, a subscription-based access available for most 2001 and newer models. For more information see *Frequently ask questions about subscriptions*.

INSTALL

NOTE

Use washers and nuts from Chopped Tour-Pak kit.

1. Install screws (2) and washers (3) from inside the Chopped Tour-Pak (1) through the spacers (4) and mounting rack (7).
2. Install washers (5) and nuts (6) from underneath of mounting rack (7).
3. Adjust Tour-Pak to desired location. Tighten.
Torque: 6.8–8.1 N·m (60–72 **in-lbs**)
4. Install Tour-Pak with mounting rack per instructions provided with rack kit.

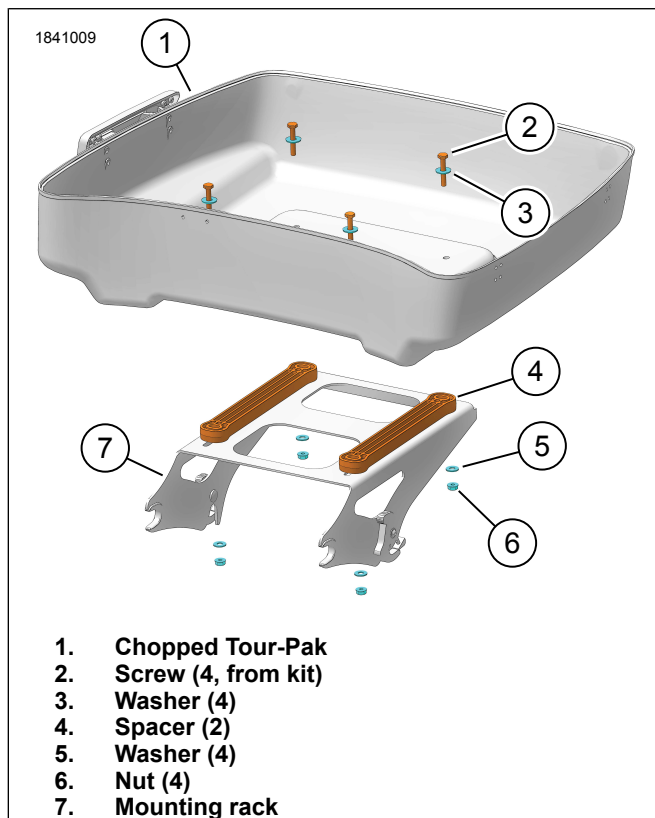

Figure 2. Chopped Tour-Pak Spacers