



# INSTRUCTIONS

J06537

2023-12-21



## LOWER REAR SUSPENSION KIT

### GENERAL INFORMATION

Table 1. General Information

Kits	Suggested Tools	Skill Level <sup>(1)</sup>
54000134A	Safety glasses, Torque wrench, Drill bit (11/32 in), Loctite 243 medium (blue), Frame Paint Touch-up Pen	
(1) Tightening to torque value or other moderate tools and techniques required		

### KIT CONTENTS

1049493

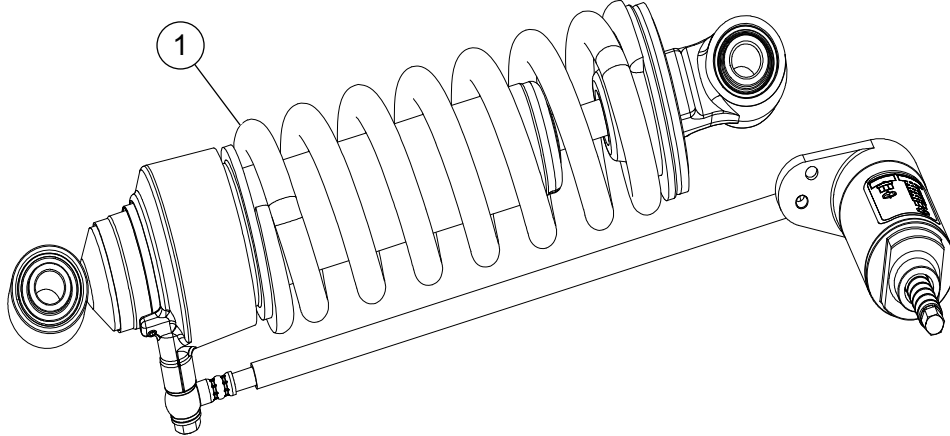

Figure 1. Kit Contents: Lower Rear Suspension

Table 2. Kit Contents: Lower Rear Suspension Kit

<input checked="" type="checkbox"/>	Verify that all contents are present in the kit before installing or removing items from vehicle.				
	Item	Qty	Description	Part No.	Notes
<input type="checkbox"/>	1	1	Rear shock assembly	Not sold separately	

### GENERAL

#### Models

For model fitment information, see the Parts and Accessories (P&A) Retail Catalog or the Parts and Accessories section of [www.harley-davidson.com](http://www.harley-davidson.com).

Verify that the most current version of the instruction sheet is used. It is available at: [h-d.com/isheets](http://h-d.com/isheets)

Contact Harley-Davidson Customer Support Center at 1-800-258-2464 (U.S. only) or 1-414-343-4056.

#### Installation Requirements

This kit requires threadlocker for proper installation. LOCTITE 243 MEDIUM STRENGTH THREADLOCKER AND SEALANT (BLUE) (99642-97)

#### ⚠ WARNING

Rider and passenger safety depend upon the correct installation of this kit. Use the appropriate service manual procedures. If the procedure is not within your capabilities or you do not have the correct tools, have a Harley-Davidson dealer perform the installation. Improper installation of this kit could result in death or serious injury. (00333b)

#### NOTE

This instruction sheet references service manual information. A service manual for the year and model motorcycle is required for this installation and is available from:

- A Harley-Davidson dealer.



- *H-D Service Information Portal, a subscription-based access available for most 2001 and newer models. For more information see Frequently ask questions about subscriptions.*

### ⚠ WARNING

Installation of any accessory suspension components can affect cornering clearance. This could distract the rider, causing loss of control and death or serious injury. (00431b)

## PREPARE

1. Remove seat. See service manual.
2. Disconnect battery. See service manual.
3. Remove fender, if necessary. See service manual.
4. Using a suitable lift, support frame and raise slightly to relieve pressure on the shock. See service manual.
5. Inspect preload adjuster mounting to frame crossmember bracket.
  - a. **If no lock nut is present**, Figure 2, a separate purchase of kit (Part No. 91500114) is required.
  - b. **If lock nut is present**, proceed to Remove and Install sections.
6. Remove Original Equipment (OE) 1/4-20 inch screw.

### NOTE

Use extreme caution to not damage the hydraulic hose connecting the PLA to the shock.

7. Figure 3 Using 11/32 inch drill bit (1), drill through crossmember bracket (4).
  - a. Using the existing hole on crossmember bracket (4) as a guide.
  - b. Remove any burrs from drilling the components.
  - c. Clean metal chips from under the seat area.
  - d. Using Frame Paint Touch-Up Pen (Part No. 93936) or local approved equivalent for international dealers, touch up the brackets from drilling and to prevent any corrosion from forming.
  - e. Allow paint to dry.

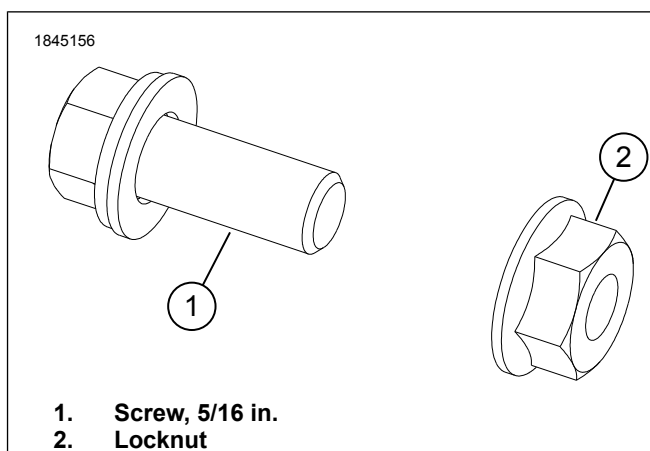

Figure 2. Kit (Part No. 91500114)

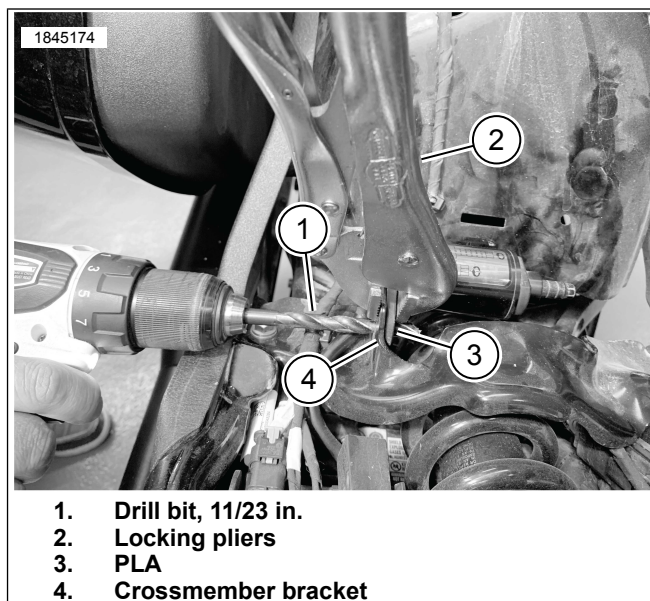

Figure 3. Rework Mounting Hole

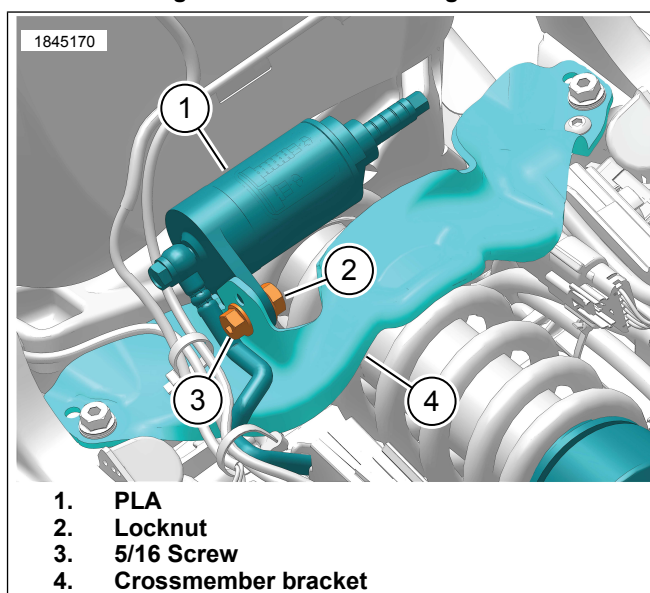

Figure 4. PLA with Locknut

## REMOVE

1. Remove OE rear shock. See service manual.

## INSTALL

### NOTE

This kit installs in the same manner as the OE rear shock.

1. Install **new** rear shock. See service manual.

## PRELOAD ADJUSTMENT

Adjust suspension to suit load conditions, riding style and personal comfort. Increase preload to accommodate the total load. Reduce preload if carrying less weight. Do not exceed maximum GVWR or GAWR when loading.

Figure 5 Rotate adjustment screw clockwise to increase preload setting, or counterclockwise to decrease preload setting until indicator shows appropriate preload setting.

See Table 3 for **new** preload settings.

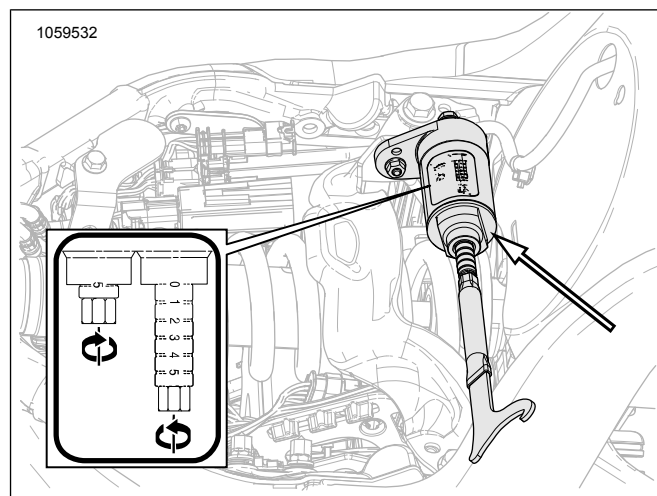

Figure 5. Preload Adjustment Screw

Table 3. Preload Setting

Rear Preload Setting											
Additional Weight of Passenger, Cargo and Added Accessories											
	Weight	0	9 kg 20 lb	18 kg 40 lb	27 kg 60 lb	36.5 kg 80 lb	45.5 kg 100 lb	54.5 kg 120 lb	63.5 kg 140 lb	72.5 kg 160 lb	81.5 kg 180 lb
Rider Weight	72.5 kg (160 lb)	0.5	1	1.5	2	2.5	2.5	3	3.5	4	4.5
	81.5 kg (180 lb)	1	1.5	1.5	2	2.5	3	3.5	4	4.5	5
	90.5 kg (200 lb)	1	1.5	2	2.5	3	3.5	4	4.5	5	5
	100 kg (220 lb)	1.5	2	2.5	3	3.5	3.5	4	4.5	5	5.5
	109 kg (240 lb)	2	2.5	2.5	3	3.5	4	4.5	5	5.5	5.5
	118 kg (260 lb)	2	2.5	3	3.5	4	4.5	5	5.5	5.5	-
	127 kg (280 lb)	2.5	3	3.5	4	-	-	-	-	-	-
	136 kg (300 lb)	-	-	-	-	-	-	-	-	-	-

## COMPLETE

1. Lower vehicle. See service manual.
2. If removed, install fender. See service manual.
3. Connect battery. See service manual.
4. Install seat. After installing seat, pull up on seat to verify that it is secure. See service manual.