



INSTRUCTIONS

J06371

2024-05-03



HOLDFAST DOCKING HARDWARE KITS

GENERAL INFORMATION

Table 1.

| Kits | Suggested Tools | Skill Level ⁽¹⁾ |
|---|--|----------------------------|
| 52300643, 52300644, 52300645, 52300646 | Safety Glasses, Torque Wrench, Loctite 243 medium strength threadlocker and sealant (blue) | |
| <i>(1) Tightening to torque value or other moderate tools and techniques required</i> | | |

KIT CONTENTS

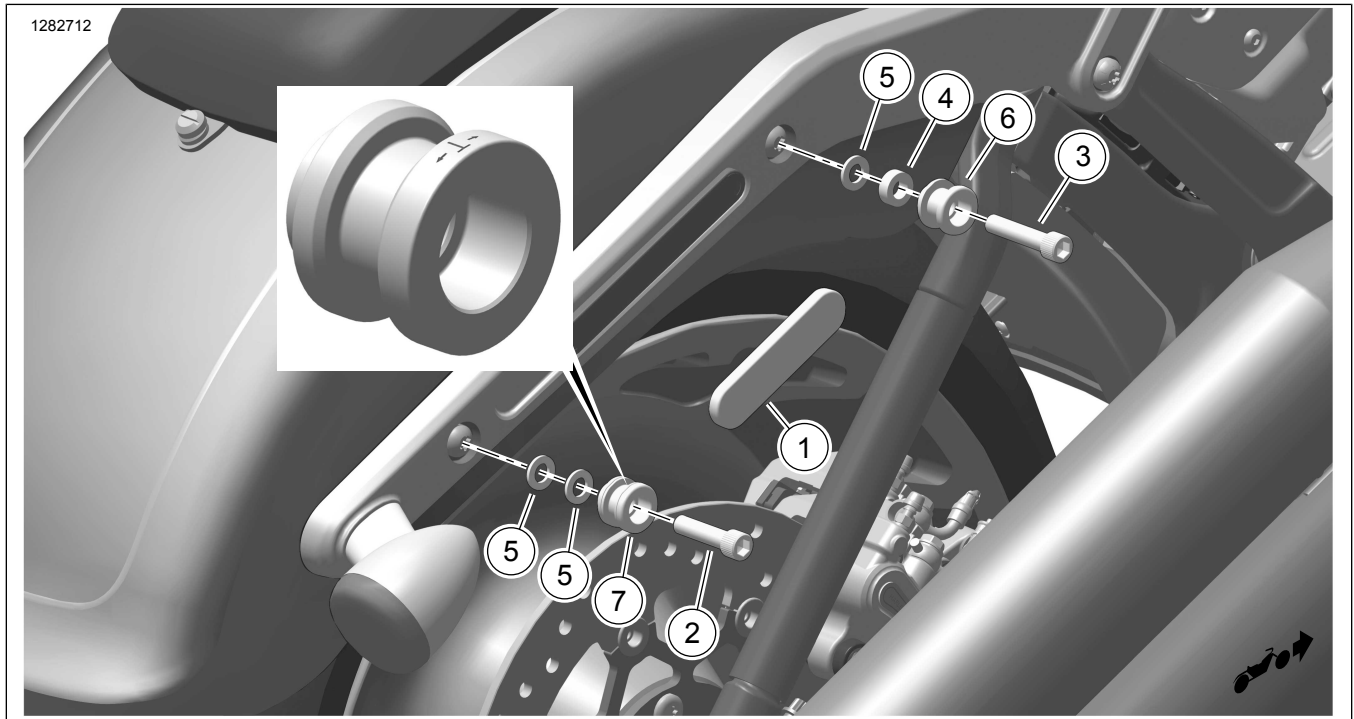

Figure 1. Kit Contents: Holdfast Docking Hardware Kits (Typical)

Table 2. Kit Contents: Holdfast Docking Hardware Kits

| <input checked="" type="checkbox"/> | Item | Qty | Description | Part No. | Notes |
|-------------------------------------|------|-----|--------------------------------------|-----------|---|
| <input type="checkbox"/> | 1 | 2 | Reflector, red | 59270-10 | |
| <input type="checkbox"/> | 2 | 2 | Screw, socket head hex | 94356-91T | Kit: 52300643 |
| | | 2 | Screw, socket head hex, black | 10200576 | Kit: 52300644 |
| | | 4 | Screw, socket head hex | 94355-91T | Kit: 52300645 |
| | | 4 | Screw, socket head hex, black | 10200575 | Kit: 52300646 |
| <input type="checkbox"/> | 3 | 2 | Screw, socket head hex | 94357-91T | Kit: 52300643 |
| | | 2 | Screw, socket head hex, black | 10200577 | Kit: 52300644 |
| <input type="checkbox"/> | 4 | 2 | Spacer, docking point, front | 12400141 | Kits: 52300643 and 5200644 FLFB, FXBR: One on each side at front. |
| <input type="checkbox"/> | 5 | 6 | Spacer, docking point | 12400142 | Kits: 52300643 and 5200644 FLFB: Two on each side at rear. One on each side at front. FXBR: One on each side at rear. |
| <input type="checkbox"/> | 6 | 2 | Bushing, docking point, front | 52300649 | Kits: 52300643 and 5200645 |
| | | 2 | Bushing, docking point, front, black | 52300650 | Kits: 52300644 and 5200646 |
| <input type="checkbox"/> | 7 | 2 | Bushing, docking point, rear | 52300647 | Kits: 52300643 and 5200645 |
| | | 2 | Bushing, docking point, rear, black | 52300648 | Kits: 52300644 and 5200646 |

GENERAL

NOTE

Verify all contents are present in the kit before installing or removing items from vehicle.

Instruction sheet is also available electronically. To verify you are using the most current version available, do one of the following:

- Go to h-d.com/isheets
- Scan QR code in upper left corner of the instruction sheet

Models

For model fitment information, see the P&A retail catalog or the Parts and Accessories section of www.harley-davidson.com (English only).

Contact Harley-Davidson Customer Support Center at 1-800-258-2464 (U.S. only) or 1-414-343-4056.

Installation Requirements

These kits can be used with Softail Detachable Racks or with Detachable Sissybar.

This item is available at a Harley-Davidson dealership.

- A separate purchase of a threadlocker is required for proper kit installation. **LOCTITE 243 MEDIUM STRENGTH THREADLOCKER AND SEALANT (BLUE) (99642-97)**

⚠ WARNING

Rider and passenger safety depend upon the correct installation of this kit. Use the appropriate service manual procedures. If the procedure is not within your capabilities or you do not have the correct tools, have a Harley-Davidson dealer perform the installation. Improper installation of this kit could result in death or serious injury. (00333b)

PREPARE

⚠ WARNING

To prevent accidental vehicle start-up, which could cause death or serious injury, remove main fuse before proceeding. (00251b)

NOTE

See the owner's manual for more detailed information regarding main fuse removal.

1. Remove left side cover.
2. **Models with security:**
 - a. Verify that fob is present.
 - b. Turn OFF/RUN switch to RUN.
3. Remove fuse cover.
 - a. Remove fuse block from Electronic Control Module (ECM) sub caddy.
 - b. Remove fuse cover.

4. Remove main fuse.
5. **Models with security:** Turn ignition switch OFF.

DOCKING HARDWARE SET-UP

NOTE

Rear docking points have plastic inserts.

1. See Figure 2. **FXLR, FLSL, FXFB, FLDE:** Remove right side Original Equipment (OE) screws.
 - a. Remove both screws from two screw pattern fender support or remove the inner screws (1) from a four screw pattern fender support.
 - b. Refer to DOCKING POINT INSTALLATION.

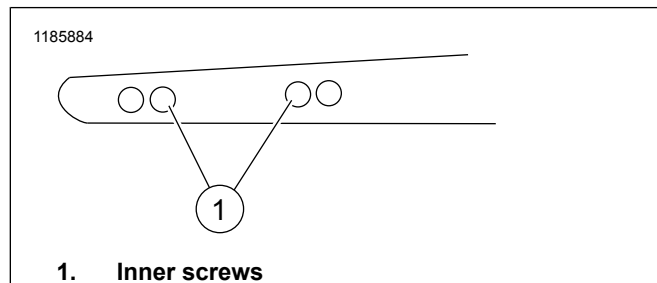

Figure 2. Inner Screws of Four Screw Pattern

2. See Figure 1. **FLFB and FXBR:** Remove both right side OE screws.
3. **FLFB:** Assemble spacers.
 - a. **Front:** One each thin spacer (5) and thick spacer (4).
 - b. **Rear:** Two thin spacers (5).
 - c. Refer to DOCKING POINT INSTALLATION.
4. **FXBR:** Assemble spacers.
 - a. **Front:** One thick spacer (4).
 - b. **Rear:** One thin spacer (5).
 - c. Refer to DOCKING POINT INSTALLATION.
5. See Figure 3. **FLHC:** Remove right side saddlebag from vehicle.
 - a. Open saddlebag lid.
 - b. Remove OE screws and loose spacers (1) attaching saddlebag to vehicle.
 - c. Separate saddlebag from vehicle.
 - d. Remove threadlocker from OE screws and mounting hole threads. Refer to DOCKING POINT INSTALLATION.

- e. See Figure 3 and Figure 4. Replace loose spacers (1) with docking points. The plastic docking points (2) in rear end of vehicle.
- f. Apply threadlocker to fasteners.
LOCTITE 243 MEDIUM STRENGTH
THREADLOCKER AND SEALANT (BLUE)
(99642-97)
- g. Install screw through OE saddlebag and docking points and attach to vehicle.
- h. Refer to steps 3 through 6 of DOCKING POINT INSTALLATION.

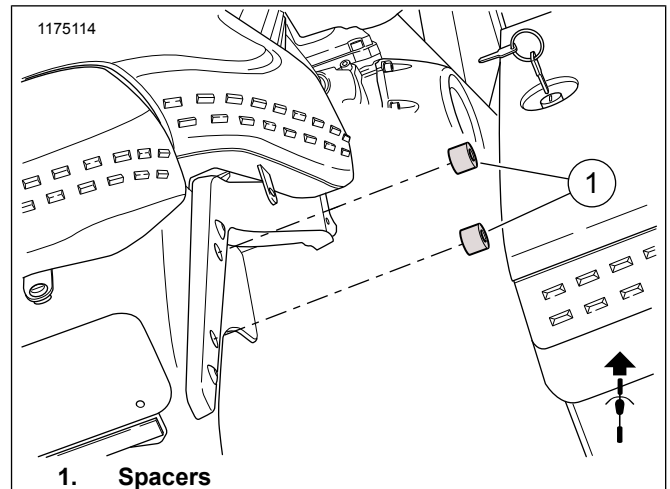

Figure 3. Replace OE Spacers with Docking Points (FLHC)

6. See Figure 4. **FLSB, FXLRST:** Remove right side saddlebag from vehicle.
 - a. Remove OE screws (3), saddlebag docking points (2) and spacers (1).
 - b. Remove threadlocker from OE screws (3) and mounting hole threads. Refer to CLEANING FASTENER THREADS.
 - c. Discard inner spacers (1) and replace with docking points from kit. The plastic docking point goes in the rear most position.
 - d. Apply threadlocker to fasteners.
LOCTITE 243 MEDIUM STRENGTH
THREADLOCKER AND SEALANT (BLUE)
(99642-97)
 - e. Install fasteners through OE saddlebag docking points and P&A docking points to vehicle. Refer to steps 3 through 6 of CLEANING FASTENER THREADS.

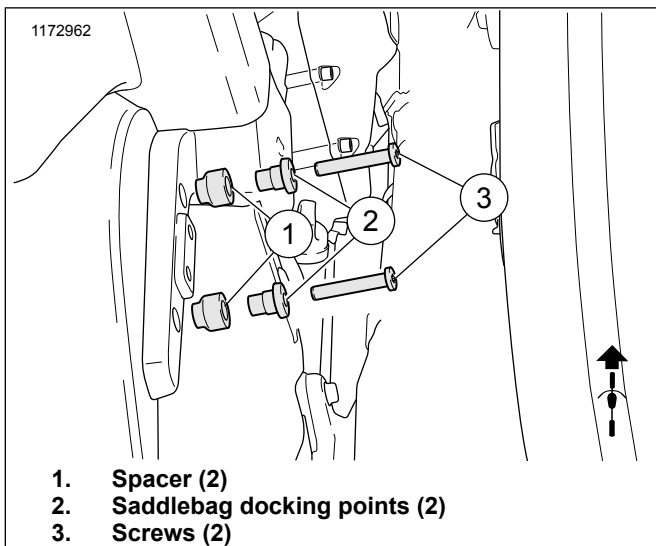

Figure 4. Replace OE Spacer with Docking Point (FLSB, FXLRST)

CLEANING FASTENER THREADS

To attain proper clamp load, always clean fastener threads and threaded holes prior to assembly.

NOTE

Never use a thread-cutting tap or die to clean threads.

- Clean all threadlocking material from fastener threads and threaded holes.
- Use a wire brush or thread-chasing die to clean fastener threads.
- Use a thread chaser to clean threaded holes.
- Use PJ1 cleaner or equivalent to remove all traces of oil and contaminants from threads.
- Clear all threaded holes with low-pressure compressed air.

Always verify cleanliness of blind holes before assembly. Tightening a screw with dirt, water or oil in the hole can cause castings to crack or break.

DOCKING POINT INSTALLATION

1. Remove threadlocker from mounting hole threads. Refer to CLEANING FASTENER THREADS.

2. See Figure 1. Apply threadlocker to screws (2).

Consumable: LOCTITE 243 MEDIUM STRENGTH THREADLOCKER AND SEALANT (BLUE) (99642-97)

NOTE

If used, spacers are placed between the fender support and docking point.

3. Install docking points (6,7).
 - a. Attach spacers, if used, and docking points to vehicle with screws (2,3).
 - b. Rotate docking point so "T"s are on top and bottom.
 - c. Finger tighten.

- d. Repeat DOCKING HARDWARE SET-UP and steps 1-3 of this section for left side.

4. Test fit upright or rack.

5. Adjust docking points.

ADJUST DOCKING POINT TIGHTNESS

NOTE

If the upright or rack rattles once installed, docking points must be adjusted. The black plastic docking point insert is elliptical. When "T"s on docking point are on top and bottom, docking point fit is at its loosest. When "T"s are at front and rear, docking point fit is at its tightest.

1. **FLSB:** Remove detachable saddlebags. See owner's manual.
2. See Figure 5. To adjust, rotate (3) in small increments so the "T" (1) is no longer on top and approaches either position (2).
3. At each increment, check fit with accessory.
4. Continue rotation in small increments and test until desired tightness is achieved. The tightest possible position is when the "T"s reach position (2).
5. Tighten docking point screws.
Torque: 28.5–37 N·m (21–27 ft-lbs)
6. **FLSB:** Install detachable saddlebags. See owner's manual.

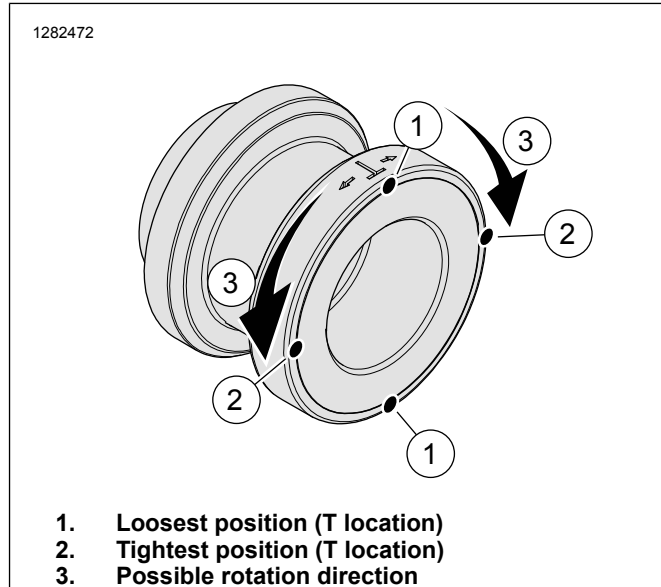

Figure 5. Docking Point Flats

REFLECTORS

⚠ WARNING

Federal Motor Vehicle Safety Standard (FMVSS) 108 requires motorcycles to be equipped with rear and side reflectors. Be sure rear and side reflectors are properly mounted. Poor visibility of rider to other motorists can result in death or serious injury. (00336b)

1. Reflectors need to be in a visible area.
2. Apply to left and right side of rack or upright.

MAINTENANCE

NOTE

Remove threadlocker from the docking point screws and mounting hole threads, see CLEANING FASTENER THREADS, before applying threadlocker to screw heads.

In time docking points wear, causing the installed detachable accessory to become loose and rattle. Tighten the fit using the following method.

1. See Figure 5. Record the current "T" position for each docking point. Remove screw from rear docking point.
2. Install docking points, screws and washers. Tighten finger-tight.
Consumable: LOCTITE 243 MEDIUM STRENGTH THREADLOCKER AND SEALANT (BLUE) (99642-97)
3. If "T"s are not in tightest position (2), rotate docking points slightly, moving "T"s toward (2) until a tight fit of the detachable accessory is achieved at each location.
4. Secure docking point screws. Tighten.
Torque: 28.5–37 N·m (21–27 ft-lbs)
5. If the docking point "T"s are in position (2):
 - a. Remove screw from rear docking points.
 - b. Rotate each docking point until the "T" on opposite side reaches loosest position (1).
 - c. Install the screws and washers. Tighten finger-tight.
LOCTITE 243 MEDIUM STRENGTH
THREADLOCKER AND SEALANT (BLUE)
(99642-97)
 - d. Check detachable accessory at each docking point, rotating the "T" toward (2) until a tight fit of the detachable accessory is achieved at each location. Secure docking point screws. Tighten.
Torque: 28.5–37 N·m (21–27 ft-lbs)
6. After multiple adjustments, if the detachable accessory continues to rattle or remains loose, replace the docking points.