



INSTRUCTIONS

94100328

2024-05-20



SECURITY SIREN

GENERAL INFORMATION

Table 1. General Information

Kits	Suggested Tools	Skill Level ⁽¹⁾
69000124	Safety Glasses, Torque Wrench	
<i>(1) Tightening to torque value or other moderate tools and techniques required</i>		

KIT CONTENTS

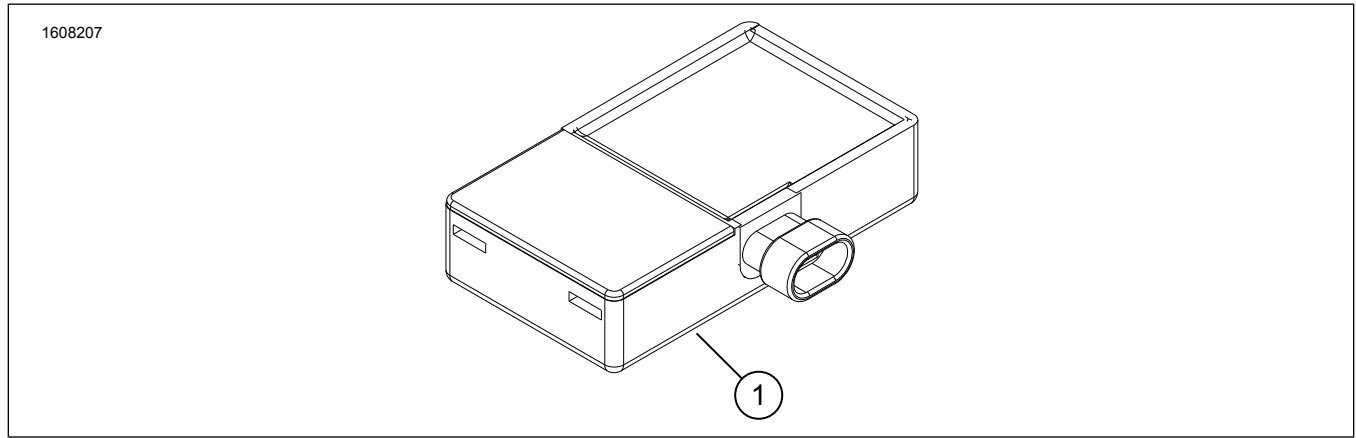

Figure 1. Kit Contents: Security Siren

Table 2. Kit Contents: Security Siren

<input checked="" type="checkbox"/> Verify that all contents are present in the kit before installing or removing items from vehicle.					
<input type="checkbox"/>	Item	Qty	Description	Part No.	Notes
<input type="checkbox"/>	1	1	Security siren	68958-07C	

GENERAL

Instruction sheet is also available electronically. To verify you are using the most current version available, do one of the following:

- Go to h-d.com/isheets
- Scan QR code in upper left corner of the instruction sheet

NOTE

This instruction sheet may have a Supplemental Video to assist installer in clarifying a certain part of the assembly. A linked video would be located at the end of this instruction sheet.

Models

For model fitment information, see the Parts and Accessories (P&A) Retail Catalog or the Parts and Accessories section of www.harley-davidson.com.

Verify that the most current version of the instruction sheet is used. It is available at: h-d.com/isheets

Contact Harley-Davidson Customer Support Center at 1-800-258-2464 (U.S. only) or 1-414-343-4056.

Installation Requirements

⚠ WARNING

Rider and passenger safety depend upon the correct installation of this kit. Use the appropriate service manual procedures. If the procedure is not within your capabilities or you do not have the correct tools, have a Harley-Davidson dealer perform the installation. Improper installation of this kit could result in death or serious injury. (00333b)

NOTE

This instruction sheet references service manual information. A service manual for the year and model vehicle is required for this installation and is available from:

- A Harley-Davidson dealer.

- *H-D Service Information Portal, a subscription-based access available for most 2001 and newer models. For more information see Frequently ask questions about subscriptions.*

The vehicle must be equipped with a Harley-Davidson® Factory Security System before this kit can be installed. See the P&A retail catalog or the Parts and Accessories section of www.harley-davidson.com (English only) for Factory Security Systems and model fitment information.

These items are available at your local Harley-Davidson dealership.

- **2021-Later RA1250, RA1250S, RH1250S models:** Separate purchase of Jumper Harness (Part No. 69202993) is required.
- **2021-Later RA1250, RA1250S, RH1250S models:** Separate purchase of two Cable Straps (Part No. 10065) is required.
- **2022-Later RH975/S models:** Separate purchase of Jumper Harness (Part No. 69202993) is required.
- **2022-Later RH975/S models:** Separate purchase of two Cable Straps (Part No. 10065) is required.
- **2017-Later Street models:** Separate purchase of Mounting Bracket (Part No. 69201473) is required.
- **2002-2006 VRSC models:** Separate purchase of Loop Fastener (Part No. 59274-01) is required.

PREPARE

⚠ WARNING

To prevent accidental vehicle start-up, which could cause death or serious injury, disconnect negative (-) battery cable before proceeding. (00048a)

⚠ WARNING

To prevent accidental vehicle start-up, which could cause death or serious injury, remove main fuse before proceeding. (00251b)

1. See service manual to prevent security module from actuating siren.
2. See service manual to disconnect negative (-) battery cable or remove main fuse.

INSTALL

2017-2020 STREET MODELS

1. Remove main fuse. See service manual.
2. Remove left side cover. See service manual.
3. Remove coolant overflow tank. See service manual.
4. See Figure 2. Install security siren (1).
5. Connect connector (2).
6. Install coolant overflow tank. See service manual.
7. Install left side cover. See service manual.

8. Install main fuse. See service manual.

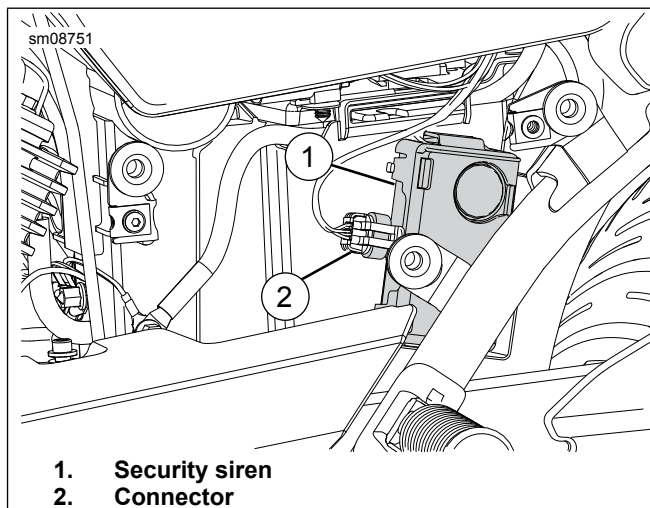

Figure 2. Street

2014-LATER SPORTSTER XL MODELS

1. Disarm security system. See owner's manual.
 2. Remove rear fender. See service manual.
 3. See Figure 3. Slide siren into battery tray with sounder disc facing down. Make sure tabs (1) lock siren in place.
 4. Connect connector [142B] (2) to siren.
 5. Install rear fender. See service manual.
- NOTE*
Two chirps after an arming command indicate a working siren.
6. Verify siren operation.
 7. Arm security system. See owner's manual.

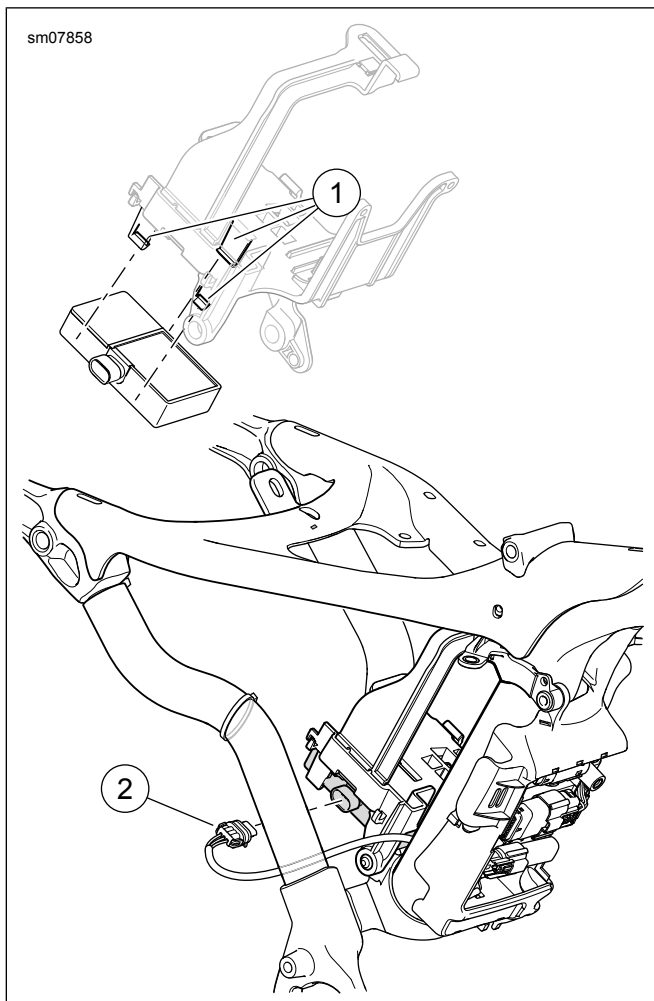

Figure 3. Sportster

2002-2006 VRSCA, VRSCB, VRSCD

1. Remove main fuse. See service manual.
2. Open seat.
3. See Figure 4. Remove splash guard nuts.
4. See Figure 5. Lower splash guard from installed position.
5. Remove fuel cap.
6. Remove fuel filler boot. Save boot for installation.
7. Install fuel cap.

NOTE

Security siren connector is a three-wire connector, not to be confused with two-wire connector (3) tied to harness (except on California models).

8. See Figure 6. Locate security siren connector (2) at end of harness lead that wraps around top of fuel tank.
 - a. Disconnect fuel pump and sender connector (1) to free security siren connector.

- b. Protective cap and cable strap on security siren connector can be discarded.

9. See Figure 7. Route siren harness lead out from under right side of fender.
10. Insert connector [142B] (2) into siren (1) receptacle until connector latches securely.
11. See Figure 8. With sounder disc (3) facing splash guard, install siren as shown.
12. Secure siren (1) to existing hook fasteners on splash guard with plain-backed loop fastener (2).
13. Install splash guard to underside of fender. Install and tighten splash guard nuts.

Torque: 8–12 N·m (70.8–106.2 in-lbs) Hex nut
14. Remove fuel cap.
15. Install fuel filler boot.
16. Install fuel cap
17. Close seat.

- a. After closing seat, pull up on seat to verify that it is secure.

18.

NOTE

Verify that ignition key switch is in OFF position **before** installing main fuse.

Install main fuse. See service manual.

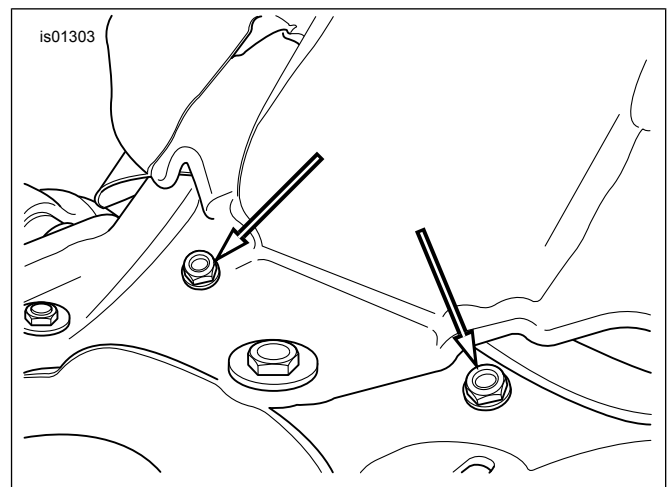

Figure 4. Remove Splash Guard Nuts (2002-2006 VRSCA/B/D)

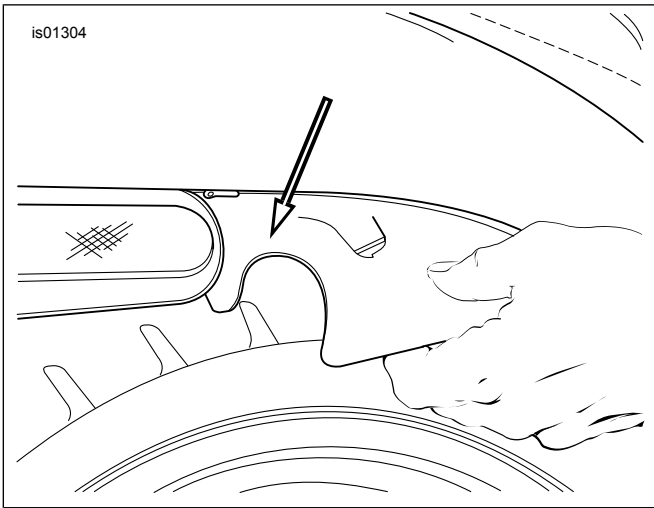

Figure 5. Lower the Splash Guard (2002-2006 VRSCA/B/D)

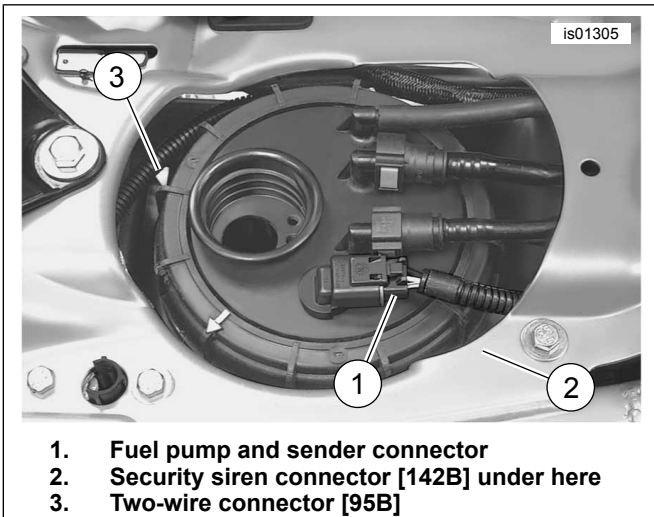

Figure 6. Locate Connector [142B] (All 2002-2006 VRSC Models) (Shown with Fuel Cap and Filler Boot Removed)

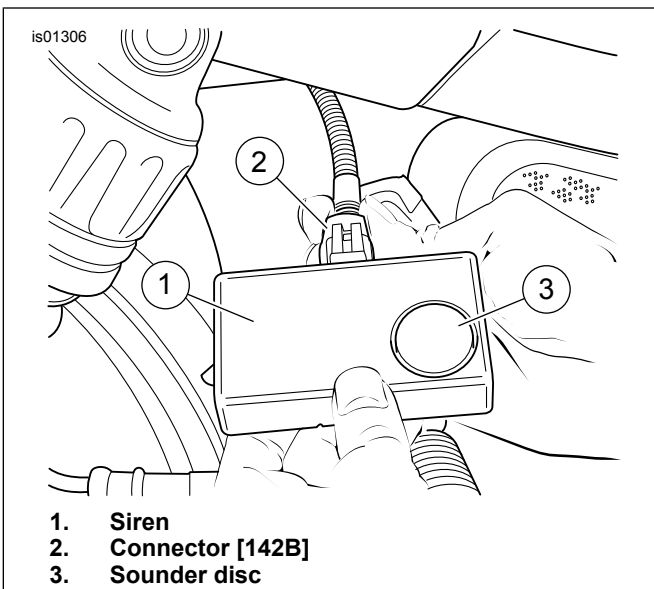
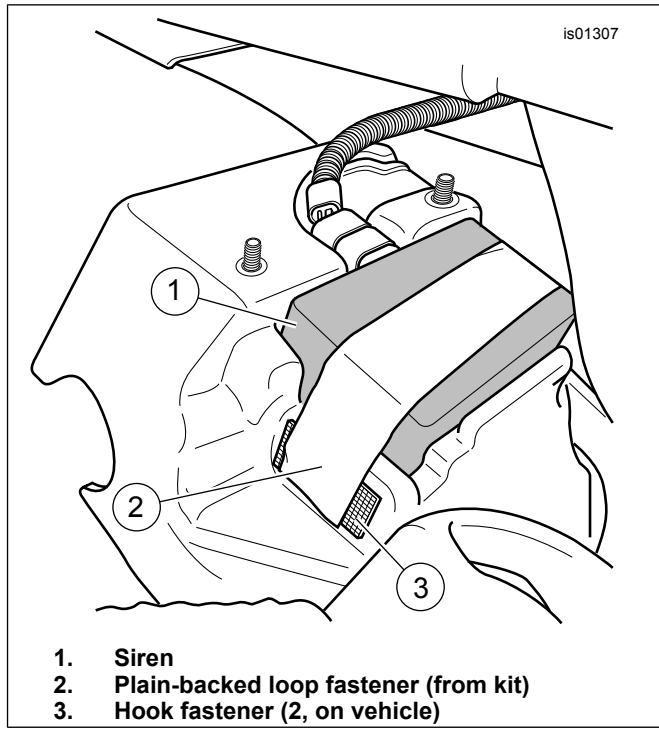

Figure 7. Siren Connector (All 2002-2006 VRSC)



1. Siren
2. Plain-backed loop fastener (from kit)
3. Hook fastener (2, on vehicle)

Figure 8. 2002-2006 VRSCA/B/D Models

2006-2007 VRSCR

1. Remove main fuse. See service manual.
2. Open seat.

⚠ WARNING

When servicing the fuel system, do not smoke or allow open flame or sparks in the vicinity. Gasoline is extremely flammable and highly explosive, which could result in death or serious injury. (00330a)

3. Remove fuel cap.
4. Remove fuel filler boot.
5. Install fuel cap.

NOTE

The security siren connector is a three-wire connector, not to be confused with two-wire connector (3) tied to harness (except on California models).

6. See Figure 6. Locate security siren connector (2), at end of harness lead that wraps around top of fuel tank.
 - a. Disconnect fuel pump and sender connector (1) to free security siren connector.
 - b. Protective cap and cable strap on security siren connector can be discarded.
7. See Figure 9. Remove flanged hex nut (2) and flat washer (3).
8. Remove seat (1).

9. See Figure 10. Remove rear outer fender (1).
 - a. Remove four hex head screws (2) and spacer washers (3).
10. See Figure 7. Route siren harness lead out from under right side of fender.
11. Insert connector [142B] (2) into siren (1) until connector latches securely.
12. See Figure 11. With sounder disc (2) facing out, clip siren (1) onto splash guard (3) as shown.

NOTE

Verify that outer fender tabs are latched with inner fender locking tabs.

13. Install rear outer fender (1).
14. Install flat washers (3) and screws (2). Tighten.
Torque: 4.5–7.5 N·m (40–66 **in-lbs**) *Hex head screw*
15. Install passenger seat with flanged hex nut and flat washer removed earlier. Tighten.
Torque: 20–25 N·m (15–19 **ft-lbs**) *Hex nut*
16. Remove fuel cap.
17. Install fuel filler boot.
18. Install fuel cap.

NOTICE

When closing the seat, make sure the ignition switch is in the FUEL position. If the ignition switch is in any other position when the seat is closed, the seat latch mechanism could be damaged. (00196a)

19. Close seat.
 - a. After closing seat, pull up on seat to verify that it is secure.

NOTE

*Verify that ignition key switch is in OFF position **before** installing main fuse.*

Install main fuse. See service manual.

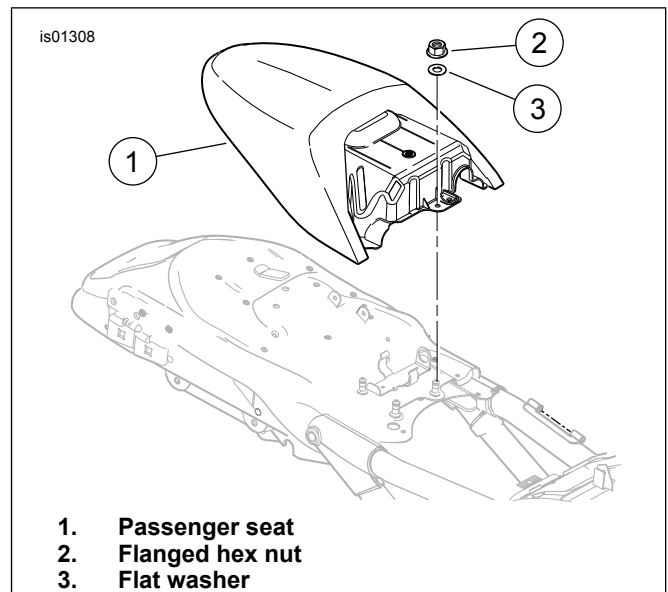

Figure 9. Remove Passenger Seat (2006-2007 VRSCR)

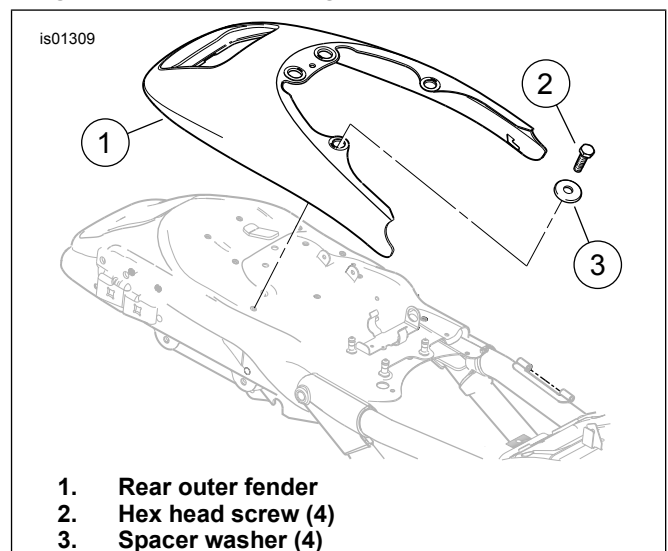

Figure 10. Fender Mounting Fasteners (2006-2007 VRSCR)

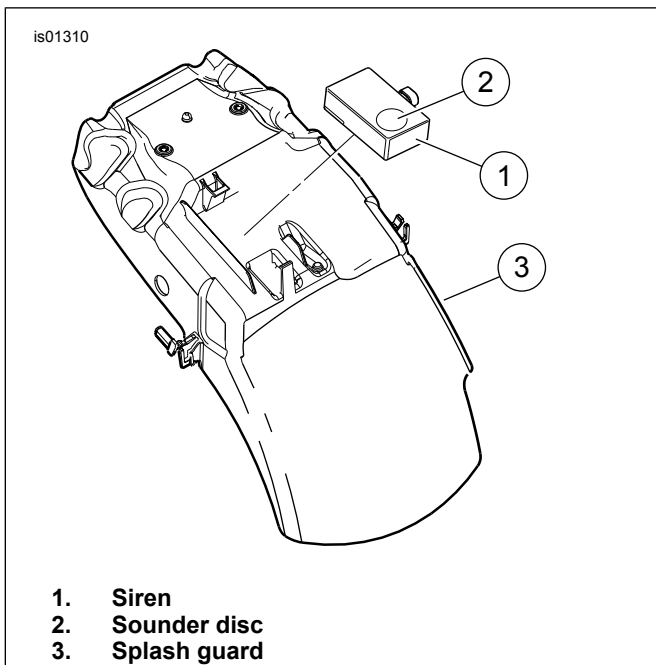

Figure 11. 2006-2007 VRSCR Models

2007-LATER VRSCA, VRSCD, VRSCF

1. Remove main fuse. See service manual.
2. Open seat.
3. Remove passenger seat (pillion) mounting nut and washer at left front of seat.
4. Remove rider seat retaining post at right front.
5. Slide passenger seat forward slightly to detach it from mounting tab on fender, then slide it back and out from under grab strap.
6. Remove seat from vehicle.
7. See Figure 12. Locate three-wire security siren connector [142B] (2), tied back to harness lead (1) that travels alongside TSSM mounting caddy. Cut tape to free connector and wires.
8. Insert siren connector [142B] into siren receptacle until connector latches securely.
9. With sounder disc (4) facing out, clip siren onto TSSM mounting caddy as shown.
10. If necessary, secure connector wiring to existing wiring with a cable strap (not provided).
11. Slide passenger seat under grab strap, and engage mounting tab on fender into slot in underside of seat. Make sure harnesses are not pinched under passenger seat frame.

12. Fasten passenger seat with rider seat retaining post at right front, and seat mounting nut and washer at left front. Tighten nuts.

Torque: 11–17 N·m (97–150 in-lbs) *hex nut*

NOTE

Verify that ignition key switch is in OFF position **before** installing main fuse.

13. Close seat.
 - a. After closing seat, pull up on seat to verify that it is secure.
14. Install main fuse. See service manual.

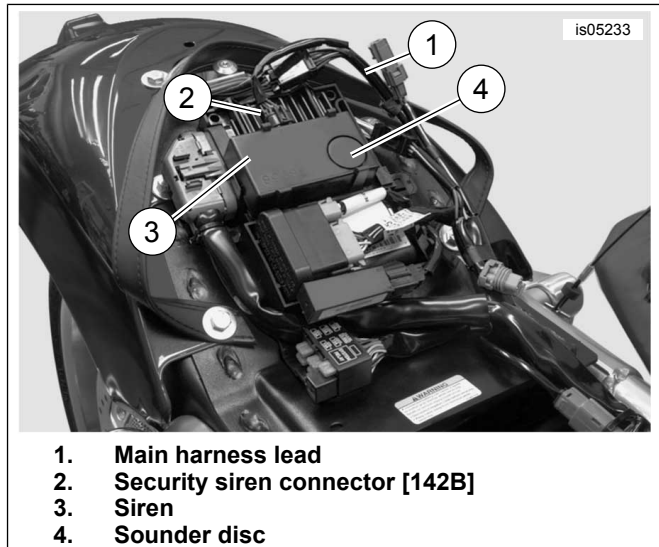

Figure 12. 2007 and Later VRSCA, VRSCD, VRSCF Models

2002-2007 TOURING MODELS

1. Remove main fuse. See service manual.
2. Remove right side saddlebag. See service manual.
3. Remove side cover from frame.
4. See Figure 13. Remove two flange nuts (2) from electrical bracket (1). Pull bracket assembly, with electronic control module (ECM) and connector attached, away from side of battery box.
5. See Figure 14. Remove siren harness lead (1) from back of electrical bracket, and take protective cap (2) off of security siren connector [142B].
6. See Figure 15. Insert security siren connector [142B] (2) into siren box receptacle until connector latches securely.
7. See Figure 16. Slide siren (2) into place on back of electrical bracket (1) so sounder disc faces out.

NOTE

Make sure that cables and conduit are properly routed so they are not pinched during assembly.

8. See Figure 17. Install electrical bracket assembly with siren back onto studs on side of battery box. Install two flange nuts onto studs and tighten.

Torque: 4.1–5.4 N·m (36–48 **in-lbs**) *hex nut*

9. Install side cover into frame.
10. Install right side saddlebag. See service manual.

NOTE

Verify that ignition key switch is in **OFF** position **before** installing main fuse or attaching battery cables.

11. **For 2004-2007 models:** See service manual and follow instructions to install main fuse. **For 2002-2003 models:** Apply a light coat of Harley-Davidson electrical contact lubricant (H-D Part No. 99861-02), petroleum jelly or corrosion retardant material to negative battery terminal. See service manual and follow instructions to attach negative battery cable.

12. Install seat. See service manual.
 - a. After installing seat, pull up on seat to verify that it is secure.

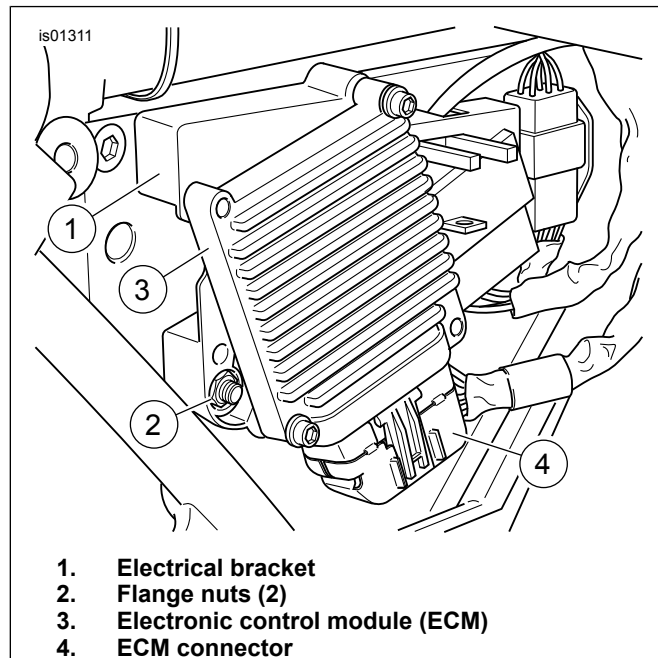

Figure 13. Electrical Bracket (2002-2007 Touring Models)

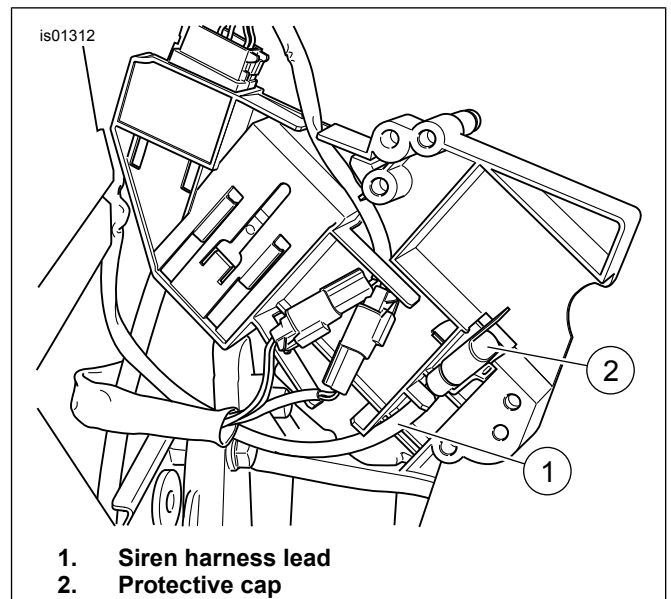

Figure 14. Siren Wire Harness (2002-2007 Touring)

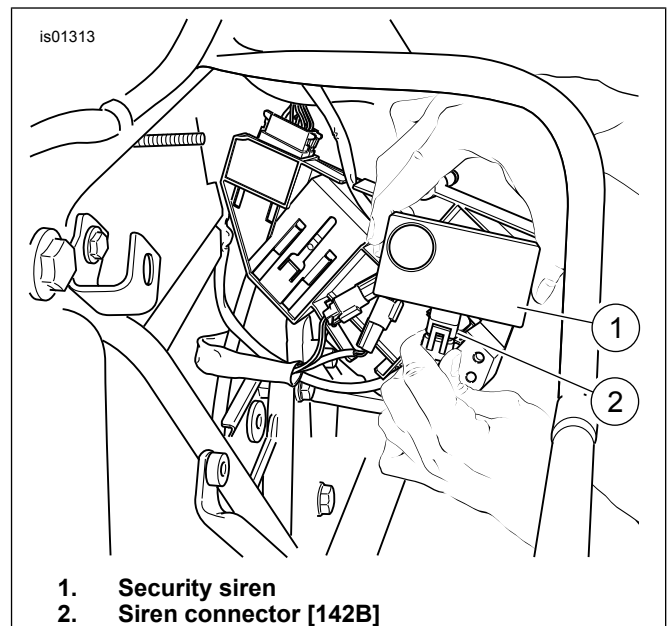

Figure 15. Siren Connector (2002-2007 Touring)

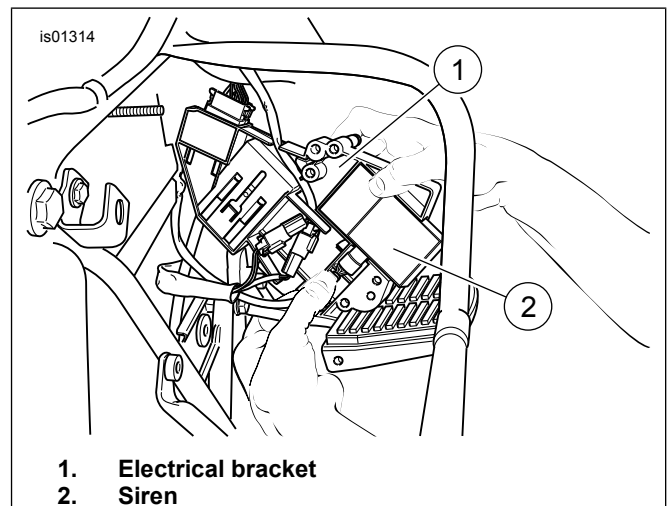

Figure 16. Install Siren (2002-2007 Touring)

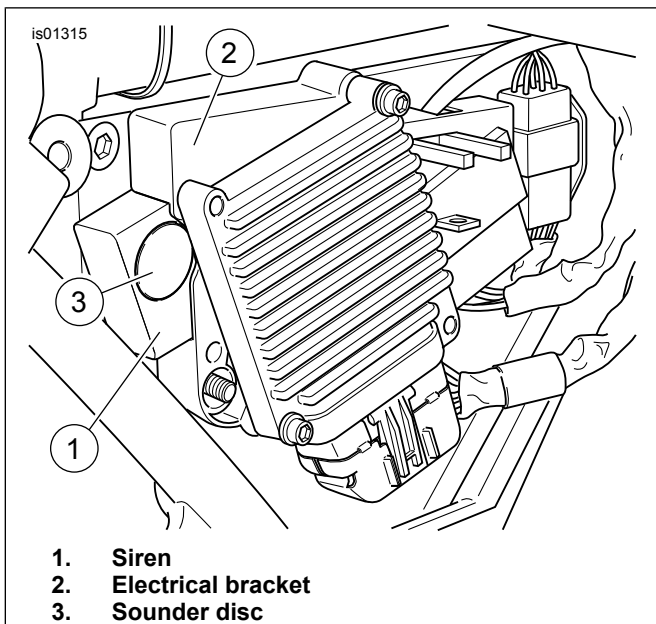

Figure 17. Siren and Electrical Bracket Installed (2002-2007 Touring Models)

2008-2013 TOURING and TRIKE MODELS

1. Remove left saddlebag. See service manual.
2. Remove left side cover. See service manual.
3. Remove main fuse. See service manual.
4. See Figure 18. Remove security siren connector [142B] (3) from retainer on electrical caddy. Insert security siren connector [142B] into security siren receptacle (5) until connector latches securely.
5. Slide siren into place on left side of electrical caddy so sounder disc (6) faces out.

NOTE

Verify that ignition key switch is in OFF position **before** installing main fuse.

6. Install main fuse. See service manual.
7. Install left side cover. See service manual.
8. Install left saddlebag. See service manual.

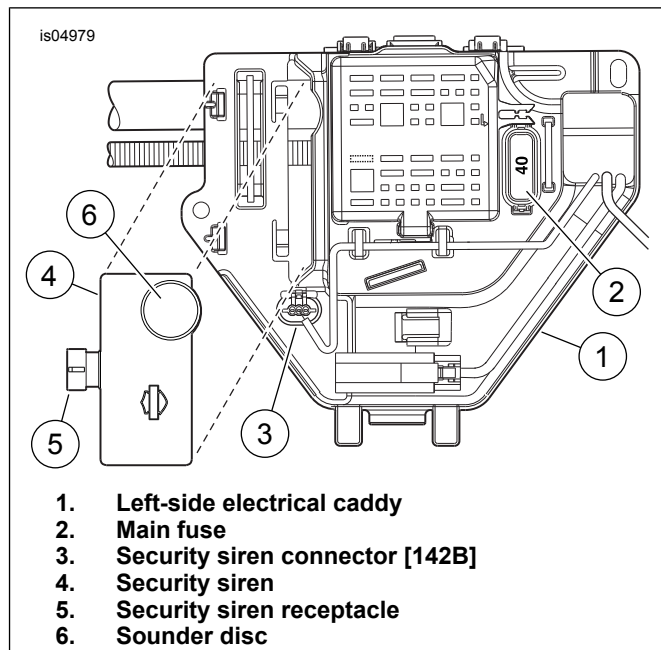

Figure 18. 2008-2013 Touring and Trike

2014-LATER TOURING and TRIKE MODELS (Except 2023-Later Center-Cooled Touring Models)

1. Remove left saddlebag. See service manual.
2. Remove left side cover. See service manual.
3. With security fob present, turn ignition on.
4. See Figure 19. Remove main fuse (3).
5. Install security siren (2).
6. Connect security siren connector (1).
7. Install main fuse (3).
8. Install left side cover. See service manual.
9. Install left saddlebag. See service manual.

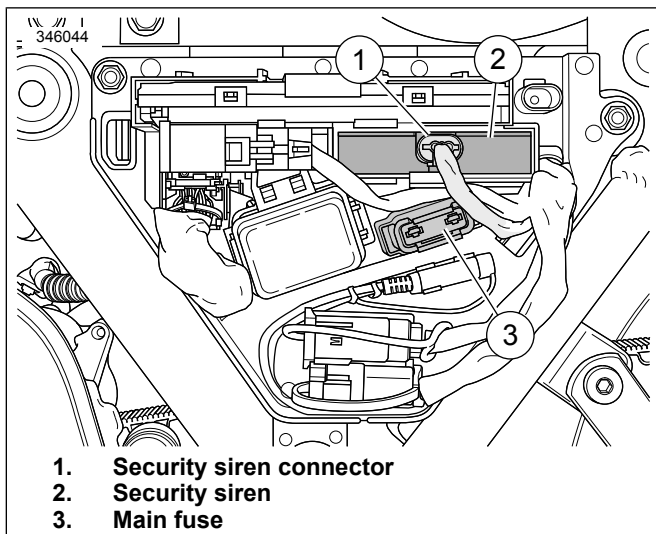

Figure 19. 2014 and Later Touring and Trike

2023-LATER CENTERED-COOLED TOURING MODELS

1. Remove left saddlebag. See service manual.
2. Remove left side cover. See service manual.
3. Remove main fuse. See service manual.
4. Remove main fuse. See service manual.
5. Remove seat. See service manual.
6. Remove top caddy. See service manual.
7. Remove Body Control Module (BCM) and BCM caddy.
8. Remove battery.

NOTE

Security siren is held in by clip on BCM caddy.

9. See Figure 20. Install Security siren.
 - a. Place security siren (1) on fins in battery box (3).
 - b. Connect connector (2).

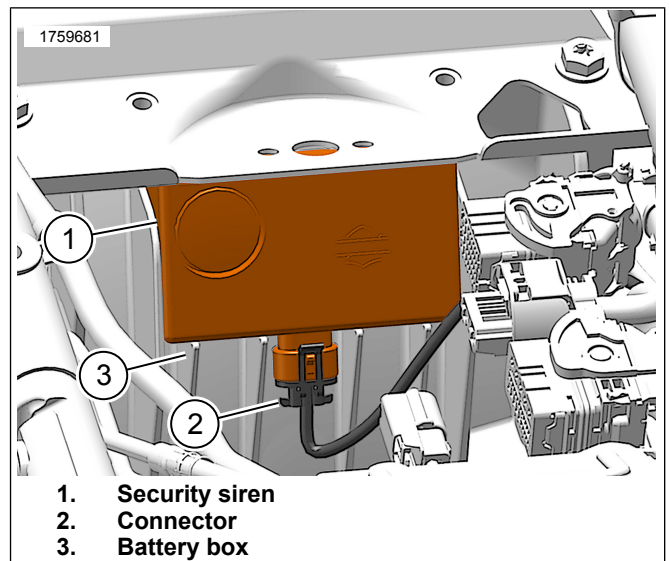

Figure 20. Security Siren (typical)

10. Install battery.
11. Install BCM and BCM caddy.
12. Install top caddy. See service manual.
13. Install seat. See service manual.
14. Install main fuse. See service manual.
15. Install left side cover. See service manual.
16. Install left saddlebag. See service manual.

2003-2017 SOFTAIL MODELS (Except FXCW/C)

1. Remove right side saddlebag (if equipped). See service manual.

NOTE

The siren connector is installed on an electrical panel under rear fender on all Softail models. The rear of vehicle may have to be raised slightly to allow removal of splash guard.

2. Remove two bolts at bottom of splash guard.
3. Bend upper right corner of splash guard toward rear tire and lift up to unhook splash guard from tab on rear fork.
4. Remove guard from beneath fender.
5. See Figure 21. Remove siren connector [142B] (2) from receptacle in mounting area (1) of electrical panel.
6. Insert siren connector [142B] into siren box receptacle until connector latches securely.
7. See Figure 22. Orient siren (1) as shown, with harness connector (2) toward bottom and sounder disc (5) facing out. Carefully snap siren into electrical panel.

8. Insert siren harness lead (4) into harness clip (3) to keep harness clear of other components.
9. If necessary, secure connector wiring to electrical panel wiring with a cable strap (not provided).
10. Hook slot at top of splash guard over tab on rear fork and install guard with two screws removed earlier. Tighten securely.
11. Install right side saddlebag (if equipped). See service manual.

NOTE

Verify that ignition key switch is in OFF position **before** attaching negative battery cable.

12. Apply a light coat of Harley-Davidson electrical contact lubricant (H-D Part No. 99861-02), petroleum jelly or corrosion retardant material to the negative battery terminal. See service manual and follow instructions to connect negative battery cable.

13. Install seat. See service manual.
 - a. After installing seat, pull up on seat to verify that it is secure.

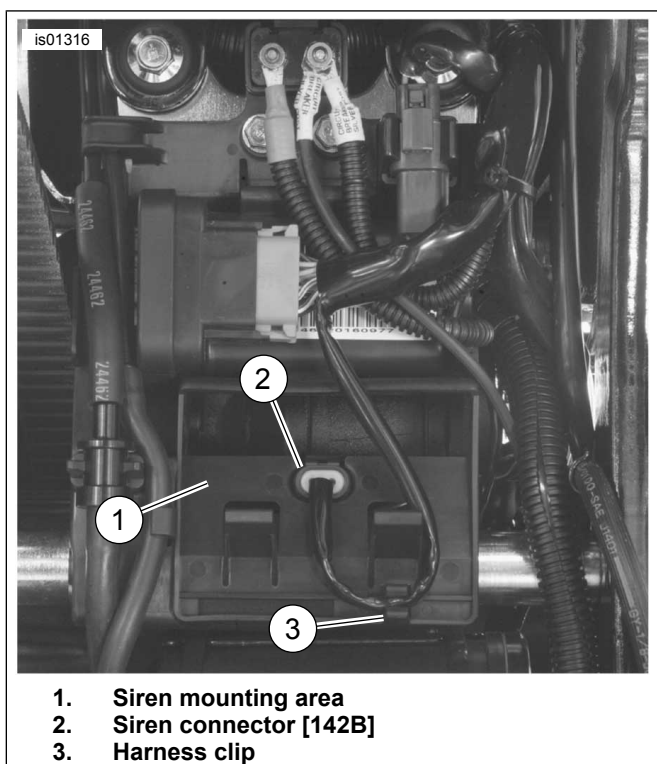
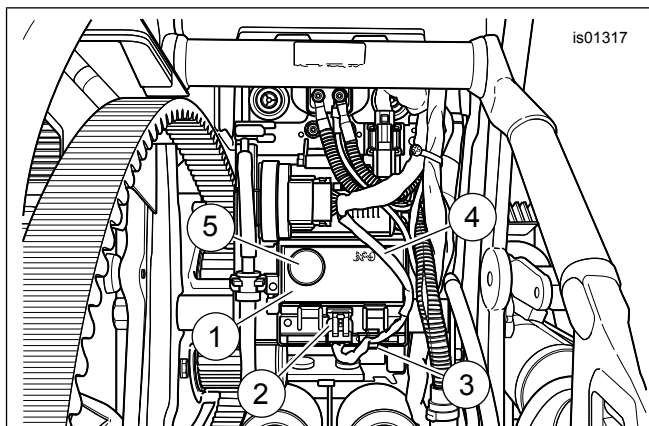

Figure 21. Siren Connector (Softail Models Except FXCW/C) (Rear Fender View with Rear Wheel Removed)



1. Security siren
2. Siren connector [142B]
3. Siren harness clip
4. Siren harness lead
5. Sounder disc

Figure 22. Siren Mounting (Softail Models Except FXCW/C) 2008-2011 SOFTAIL ROCKER (FXCW/C)

NOTE

Note fender wire routing and hardware locations before removal.

1. Remove rear fender from vehicle. See service manual and follow instructions:
 - a. Disconnect rear wiring harness connector [7] halves.
 - b. Remove lower fender mounting bolts and washers.
 - c. Remove upper fender mounting screws and washers.
 - d. Remove fender.
2. See Figure 23. Unfasten harness (1) clipped to right side of electrical compartment cover (splash guard, already removed in photo) just forward of the rear wheel. Remove two hex socket head screws with washers fastening cover and remove cover from vehicle.
3. Remove the siren connector [142B] from receptacle (3) near top of electrical panel (2).
4. Insert siren connector [142B] into siren box receptacle until connector latches securely.
5. See Figure 24. Position siren box (1) with harness connector toward rear and sounder disc (2) facing out. Carefully snap siren box into pocket (3) on right side of electrical panel.
6. Install electrical compartment cover. Install screws and washers. Tighten.

Torque: 4.1–6.8 N·m (36–60 **in-lbs**) hex socket head screw
7. See service manual and follow instructions:
 - a. Set fender into position.
 - b. Loosely install fender mounting hardware.

- c. Tighten fender mounting hardware, in indicated sequence, to specified torque.
- d. Connect rear wiring harness connector [7] halves.

NOTE

Verify that ignition key switch is in OFF position before attaching negative battery cable.

8. Apply a light coat of Harley-Davidson electrical contact lubricant (H-D Part No. 99861-02), petroleum jelly or corrosion retardant material to negative battery terminal. See service manual to connect negative battery cable.
9. Install seat. See service manual.
 - a. After installing seat, pull up on seat to verify that it is secure.

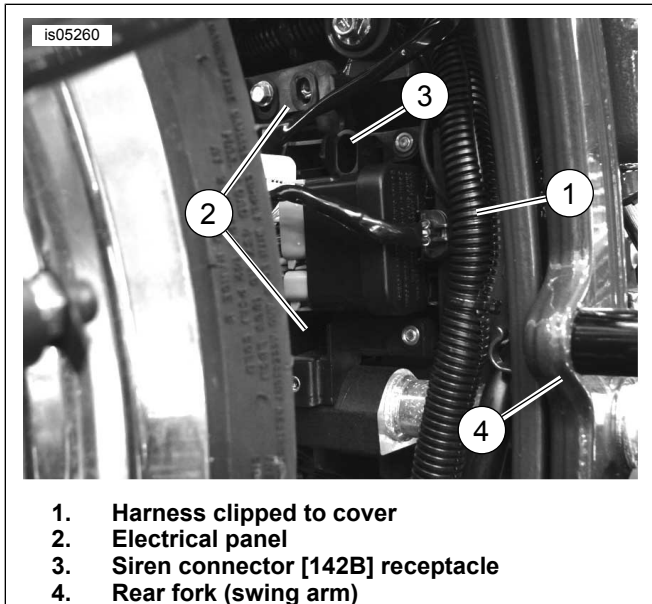

Figure 23. Electrical Panel (FXCW/C Models)

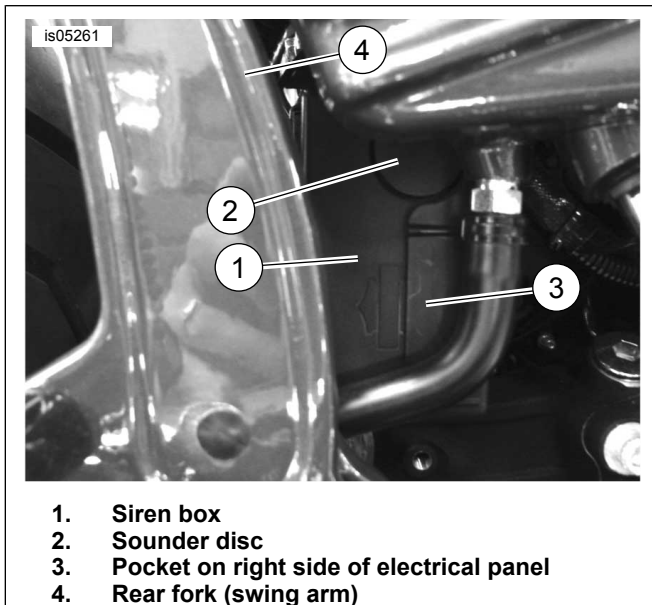
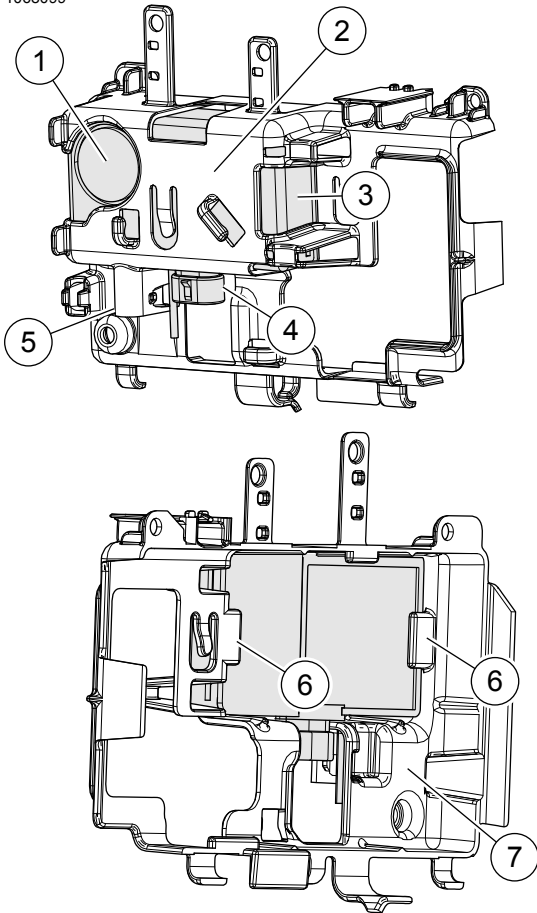

Figure 24. Siren Mounting (FXCW/C Models)

2018-LATER SOFTAIL MODELS

1. Remove right side cover. See service manual.
2. Disconnect negative battery cable. See service manual.
3. Remove battery. See service manual.
4. Remove battery tray. See service manual.
5. Rotate BCM out-of-way. See service manual.
6. See Figure 25. Disconnect security siren connector (5) from back side of BCM caddy (2).
7. Connect connector (4).
8. Install security siren into front side of BCM caddy (7)
 - a. Verify that sounder disc (1) is facing to the rear of the vehicle.
 - b. Place security siren into BCM caddy and press into place locking retainer tabs (6).
9. Install BCM. See service manual.
10. Install battery tray. See service manual.
11. Install battery. See service manual.
12. Connect negative battery cable. See service manual.
13. Install right side cover. See service manual.

1068099



1. Sounder disc
2. Back side, BCM caddy
3. Security siren
4. Siren connector
5. Siren connector storage port
6. Retainer tab
7. Front side, BCM caddy

Figure 25. 2018 and Later Softail

2004-LATER DYNA MODELS

1. See Figure 26. Remove electrical caddy cover (1).
2. Remove front electrical caddy screw and washer (2).
3. Remove two top electrical caddy screws and washers (7).

NOTE

When pulling electrical caddy away from vehicle, make sure that the wiring connections are not disturbed. Pull caddy away just far enough to allow installation of siren.

4. Get siren (5) from kit. Tip top of electrical caddy (3) away from vehicle slightly. Turn siren so sounder disc (6) faces up and wire receptacle is facing vehicle as shown.
5. Remove siren harness lead from behind electrical caddy and remove black dust cap from security siren connector [142B].

6. Insert connector [142B] into siren receptacle until connector latches securely. Insert siren into back of caddy, beneath ignition control module (4).
7. Install, but do not tighten, front electrical caddy screw and washer (2). Install top electrical caddy screws and washers (7).

- a. Tighten top screws.
Torque: 11.3 N·m (100 in-lbs) hex socket screw
- b. Tighten front screw.
Torque: 5.6 N·m (50 in-lbs) hex socket screw

8. NOTE

Verify that ignition key switch is in OFF position **before** installing main fuse.

Install main fuse. See service manual.

9. Install electrical caddy cover (1).

is01318

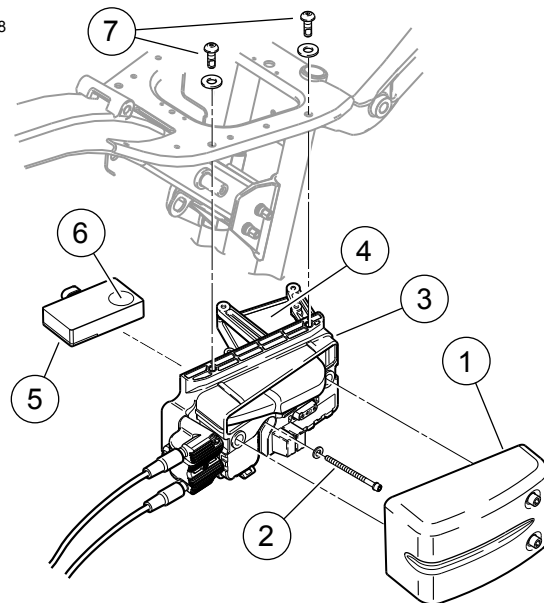

1. Cover
2. Front fastener
3. Electrical caddy
4. Ignition module
5. Siren
6. Sounder disc
7. Top fasteners (2)

Figure 26. Dyna

2021-LATER PAN AMERICA MODELS and SPORTSTER S

1. Remove seat. See service manual.
2. Remove main fuse. See service manual.
3. Remove seat base assembly. See service manual.
4. See Figure 27. Remove under seat caddy (1). See service manual.

5. Remove BCM from under seat caddy (1). See service manual.
6. See Figure 28 or Figure 29. Install security siren (6) into under seat caddy (1).
 - a. Install BCM into under seat caddy. See service manual.
 - b. Install under seat caddy (1). See service manual.
7. See Figure 27. Remove OE security siren connector (2) from under seat caddy (1) docking point.
8. See Figure 28 or Figure 29. Connect jumper harness (3) to:
 - a. OE security siren connector (5).
 - b. Security siren connector (2).
9. Secure jumper harness connector with cable strap (4).
 - a. Secure jumper harness connector to OE main harness.
10. Install seat base assembly. See service manual.
11. Install main fuse. See service manual.
12. Install seat. See service manual.
 - a. After installing seat, pull up on seat to verify that it is secure.

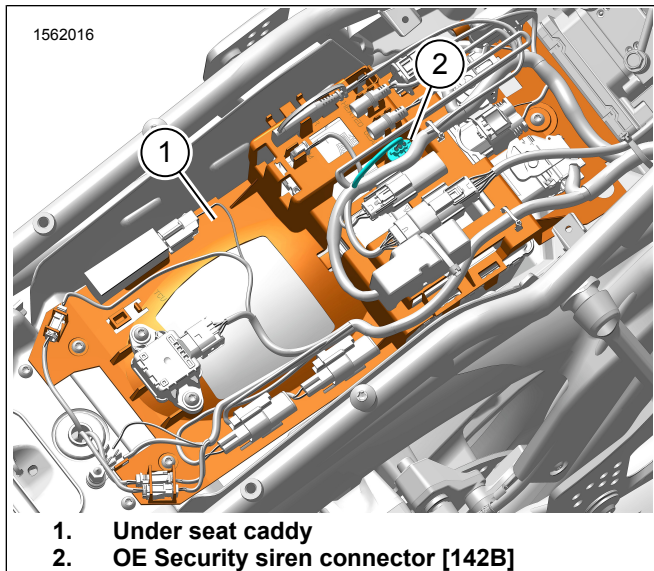

1. Under seat caddy
2. OE Security siren connector [142B]

Figure 27. OE Connector (Pan America shown)

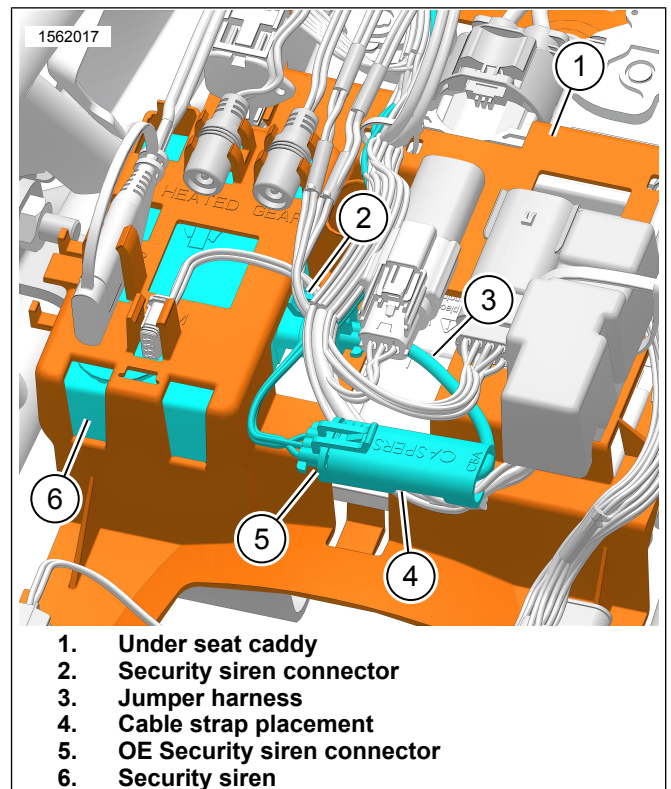

1. Under seat caddy
2. Security siren connector
3. Jumper harness
4. Cable strap placement
5. OE Security siren connector
6. Security siren

Figure 28. Pan America (RA1250/S/SE)

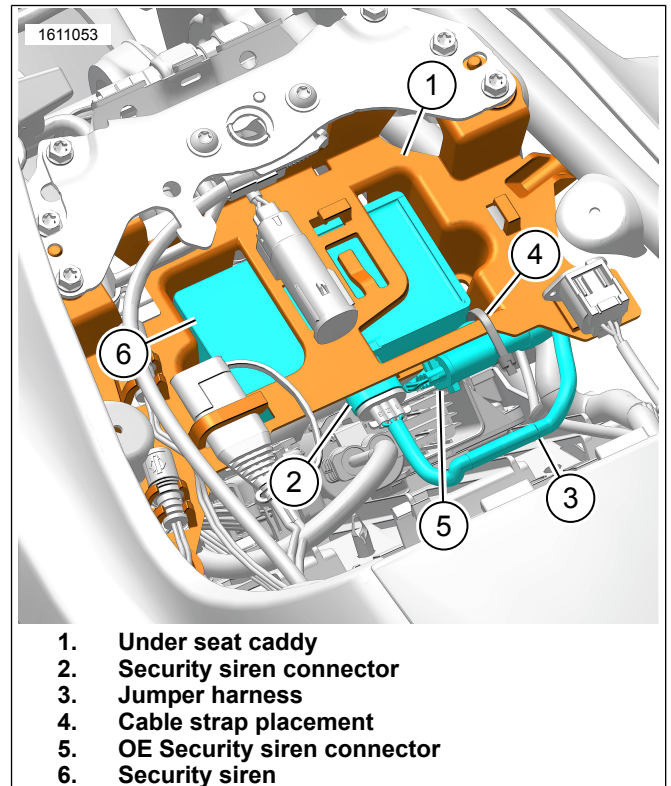

1. Under seat caddy
2. Security siren connector
3. Jumper harness
4. Cable strap placement
5. OE Security siren connector
6. Security siren

Figure 29. Sportster S (RH1250S)

2022-LATER NIGHTSTER MODELS

1. Remove main fuse. See service manual.

2. Open seat.
 - a. Insert key into seat lock.
 - b. Turn key to release seat latch.
 - c. Lift seat.
3. Remove top console. See service manual.
4. Remove top cover. See service manual.
5. Remove airbox cover. See service manual.
6. See Figure 30. Install security siren (1) into BCM caddy.
7. Remove OE security siren connector (3) from docking point (4).
8. Connect jumper harness (2) to:
 - a. OE security siren connector (3).
 - b. Security siren connector (1).
9. Secure jumper harness and connectors with cable straps.
10. Install airbox cover. See service manual.
11. Install top cover. See service manual.
12. Install top console. See service manual.
13. Close seat. See service manual.
 - a. After closing seat, pull up on seat to verify that it is secure.
14. Install main fuse. See service manual.

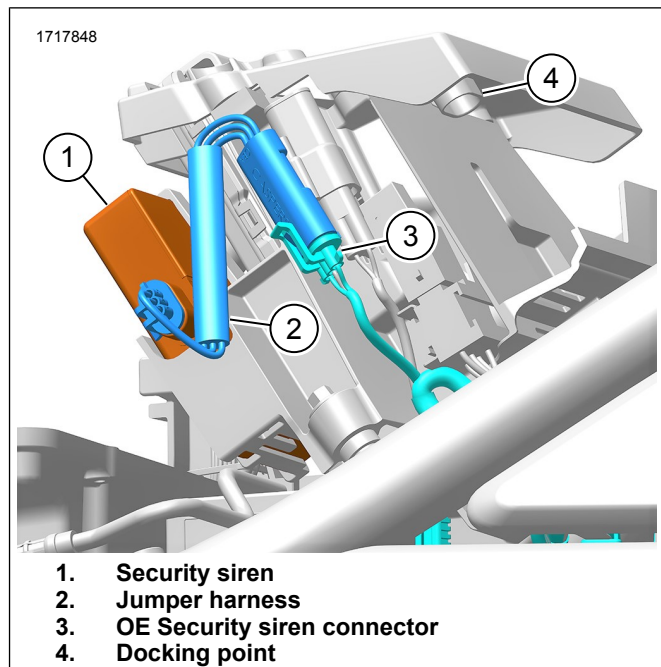

Figure 30. Nightster (RH975/S)

ALL MODELS

NOTE

Siren may not function properly when first installed. Nickel metal hydride (NiMH) rechargeable batteries discharge fairly rapidly when stored. They will lose as much as 1%-2% of their charge per day, and after a few months of storage at room temperature will be mostly discharged. If stored for a very long period without charging, they may need a few charging cycles to regain their full capacity.

To charge NiMH battery, operate vehicle for a minimum of four hours.

Siren Diagnostics

NOTE

Some models do not support chirpless mode. Reference owner's manual to verify support.

- If siren is armed and internal siren battery is dead, shorted, disconnected, or has been charging for a period longer than 24 hours, siren will respond with three chirps on arming instead of two.
- Internal siren battery may not charge if vehicle's charging system is producing less than 12.5 volts.
- If siren does not chirp two or three times on a valid arming command from security system, siren is either in chirpless mode, not connected, not working, or siren wiring was opened or shorted while siren was disarmed.
- If siren enters self-driven mode where it is powered from siren's internal 9 volt battery, turn signal lamps may or may not alternately flash. If security system activates siren, turn signal lamps will alternately flash. If siren has been armed and a security event occurs, and siren is in self-driven mode, siren will alarm for 20-30 seconds and then turn off for 5-10 seconds. This alarm cycle will be repeated ten times if siren is in self-driven mode.

Smart Siren Battery Replacement

Siren's internal 9-volt battery is rechargeable and does not need to be replaced on a regular basis. Battery life under normal conditions is approximately three to six years.

NOTE

*When battery replacement is needed, only a **nickel metal hydride (NiMH) 9 volt battery** should be used in the siren. These are widely available at local battery outlets.*

To Replace the Battery:

1. See **POWER DISCONNECT** in service manual and follow instructions to prevent security module from actuating siren.
2. Remove siren box from vehicle. See siren installation procedures for your model in this instruction sheet.
3. Open battery cover by inserting a flat-blade screwdriver into one of the slots on side of siren box. Press until one corner of cover pops up slightly.
4. Insert screwdriver into second slot, and press until cover pops open. Remove cover and gasket.
5. Remove old battery from siren box, and gently unfasten snap connector from battery. Save grease coating terminals.
6. Coat terminals of snap connector and **new NiMH** nine-volt battery completely with grease from old connection.

NOTE

If not enough lubricant remains to completely cover the terminals, Electrical Contact Lubricant (H-D Part No. 99861-02) is compatible, and is available from a Harley-Davidson dealer

7. Snap connector onto new battery, and install battery into siren box.
8. Set siren box on a work surface with battery opening facing up. Position gasket and battery cover onto siren box with rounded corners facing out.
9. Press cover down onto siren box and press tabs in with screwdriver until tabs snap into slots in box.
10. Install siren box into vehicle.
11. Dispose of old NiMH battery in accordance with local regulations.