



INSTRUCTIONS

J04923

2009-04-16



SILENCER BRAKE PEDAL PAD KIT (SMALL)

GENERAL

Kit Number

48990-10

Models

For model fitment information, see the P&A retail catalog or the Parts and Accessories section of www.harley-davidson.com (English only).

⚠ WARNING

Rider and passenger safety depend upon the correct installation of this kit. If the procedure is not within your capabilities or you do not have the correct tools, have a Harley-Davidson dealer perform the installation. Improper installation of this kit could result in death or serious injury. (00308b)

Kit Contents

See Figure 1 and Table 1.

INSTALLATION

1. Remove the previously installed brake pedal cover from the foot brake lever.
2. See Figure 1. Obtain the new brake pad (1), backing plate (2), screw (3) and washer (4) from the kit. Insert the backing plate into the back of the pad, and align the assembly over the foot brake lever (A).
3. Place the washer onto the screw threads. Insert the screw threads through the hole in the brake lever and backing plate, then thread into the brake pad.

⚠ WARNING

After repairing the brake system, test brakes at low speed. If brakes are not operating properly, testing at high speeds can cause loss of control, which could result in death or serious injury. (00289a)

4. Tighten the screw to 3.7 N·m (33 in-lbs).

SERVICE PARTS

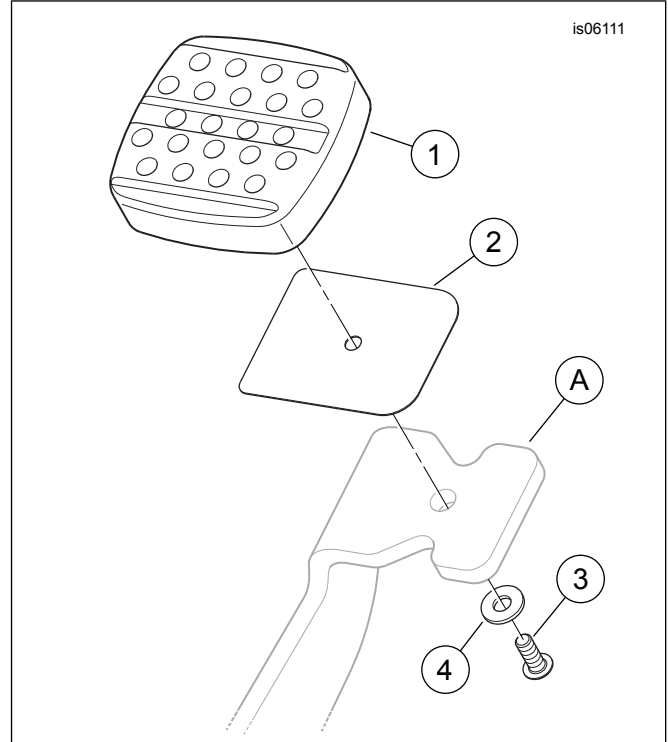

Figure 1. Service Parts, Silencer Brake Pedal Pad Kit

Table 1. Service Parts

| Item | Description (Quantity) | Part Number |
|--|--------------------------------|---------------------|
| 1 | Brake pedal pad, Silencer | Not sold separately |
| 2 | Backing plate, brake pedal pad | Not sold separately |
| 3 | Screw, hex socket, button head | 3026 |
| 4 | Washer, #10 | 6716 |
| Items mentioned in text, but not included in kit. | | |
| A | Foot brake lever | |

