



# INSTRUCTIONS

J00102

2013-11-01



## THREE-SLOT CHROME BRAKE PEDAL PAD AND COVER KIT

### GENERAL

#### Kit Numbers

42476-95, 42482-95

#### Models

For model fitment information, see the P&A retail catalog or the Parts and Accessories section of [www.harley-davidson.com](http://www.harley-davidson.com) (English only).

#### ▲ WARNING

Rider and passenger safety depend upon the correct installation of this kit. If the procedure is not within your capabilities or you do not have the correct tools, have a Harley-Davidson dealer perform the installation. Improper installation of this kit could result in death or serious injury. (00308b)

### INSTALLATION

1. Remove the locknut that secures the original equipment (OE) brake pedal pad. Discard the pad and locknut.
2. See Figure 1. Align and place the new brake pedal cover (4) over the rubber tread (5).
3. Insert bolt (3), with the rubber H-D logo properly aligned, through the cover and tread, and into the hole in the brake pedal.
4. Position flat washer (1) onto the exposed bolt threads. Thread acorn nut (2) onto the bolt threads. Tighten the nut to 12.2–13.6 N·m (9–10 ft-lbs).

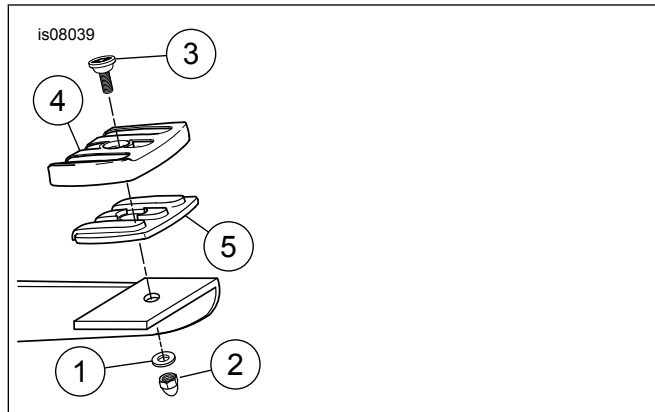

Figure 1. Service Parts

Table 1. Kit 42476-95 (Horizontal Slots)

| Item | Description (Quantity) | Part Number |
|------|------------------------|-------------|
| 1    | Flat washer            | 6423        |
| 2    | Acorn nut              | 7949        |
| 3    | Bolt (with logo)       | 42559-95    |

Table 1. Kit 42476-95 (Horizontal Slots)

| Item | Description (Quantity) | Part Number |
|------|------------------------|-------------|
| 4    | Brake pedal cover      | 44230-95    |
| 5    | Rubber tread           | 44231-95    |

Table 2. Kit 42482-95 (Vertical Slots-Shown)

| Item | Description (Quantity) | Part Number |
|------|------------------------|-------------|
| 1    | Flat washer            | 6423        |
| 2    | Acorn nut              | 7949        |
| 3    | Bolt (with logo)       | 44225-95    |
| 4    | Brake pedal cover      | 44223-95    |
| 5    | Rubber tread           | 44224-95    |