



# INSTRUCTIONS

J05492

2023-09-15



## LOW-PROFILE TOURING SEAT

### GENERAL

#### Kit Number

52000057, 52000248, 52000249

#### Models

For model fitment information, see the P&A retail catalog or the Parts and Accessories section of [www.harley-davidson.com](http://www.harley-davidson.com) (English only).

#### ⚠ WARNING

Rider and passenger safety depend upon the correct installation of this kit. If the procedure is not within your capabilities or you do not have the correct tools, have a Harley-Davidson dealer perform the installation. Improper installation of this kit could result in death or serious injury. (00308b)

#### Kit Contents

This kit contains one solo seat and two seat mounting nuts (Part No. 3633).

### INSTALLATION

#### NOTE

When a solo seat is installed without a passenger seat, passenger footpegs or footboards and passenger grab strap must be removed.

1. Remove seat. See service manual.
2. Remove grab strap and nuts.
3. See Figure 1. Remove two nuts (1). Leave the plastic stud plate retaining washers (2) in place.
4. If installing seat with a passenger pillion, refer to pillion instruction sheet to install pillion and grab strap.

#### ⚠ WARNING

After installing seat, pull upward on seat to be sure it is locked in position. While riding, a loose seat can shift causing loss of control, which could result in death or serious injury. (00070b)

5. See Figure 2. Slide the new solo seat (2) into position until front tab engages frame and rear of seat locates over mounting studs. Install seat mounting nuts (1) onto the studs.
6. If a pillion is not being installed, pull down flap at the rear of the seat to cover the mounting studs.

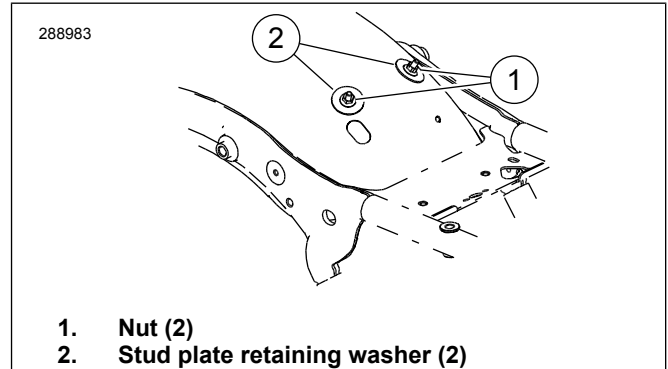

Figure 1. Remove Nuts

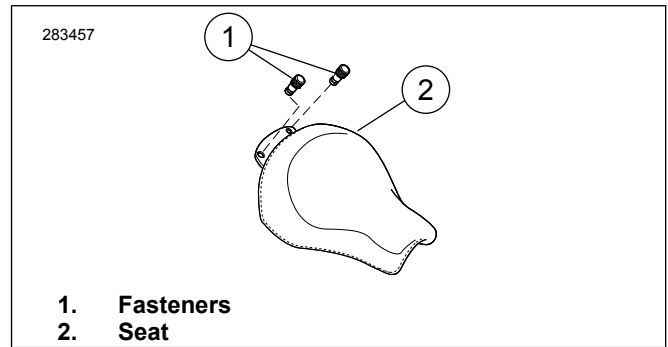

Figure 2. Solo Seat

