



INSTRUCTIONS

J04667

2008-08-08



BULLET FRONT TURN SIGNAL LENS KIT

GENERAL

Kit Number

69226-09, 69208-09

Models

For model fitment information, see the P&A Retail Catalog or the Parts and Accessories section of www.harley-davidson.com (English only).

⚠ WARNING

Rider and passenger safety depend upon the correct installation of this kit. If the procedure is not within your capabilities or you do not have the correct tools, have a Harley-Davidson dealer perform the installation. Improper installation of this kit could result in death or serious injury. (00308b)

NOTE

A service manual for your motorcycle is available from your Harley-Davidson Dealer.

Kit Contents

See Figure 1 and Table 1.

INSTALLATION

1. See Figure 1. Locate the removal notch (B) on the turn signal lens and carefully pry lens from housing (A). Discard lens.
2. Repeat for other lens.
3. Install new bulb (1) into the front turn signal assembly.
4. Install new lens (2 or 3) from kit by snapping into place.
5. Repeat for other turn signal.
6. Check turn signals for proper operation.

SERVICE PARTS

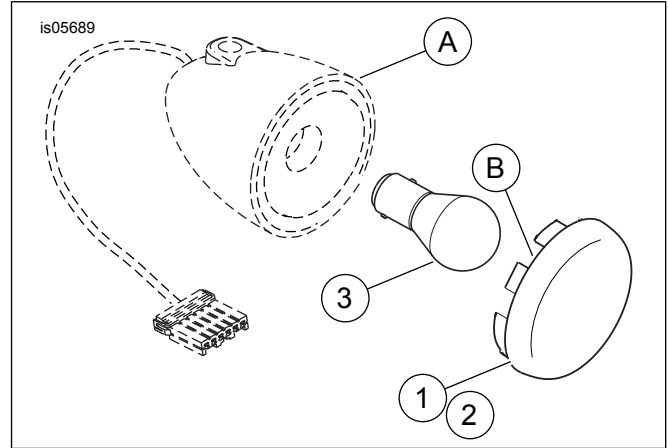

Figure 1. Service Parts: Bullet Front Turn Signal Lens

Table 1. Service Parts

Item	Description (Quantity)	Part Number
Kit 69226-09 - Clear		
1	Lens, clear (2)	69324-02
3	Bulb, amber (2)	69331-02
Kit 69208-09 - Smoked		
2	Lens, smoked (2)	69325-02
3	Bulb, amber (2)	69331-02
Items referenced, but not included in kit		
A	Bullet-style turn signal housing	
B	Notch	