



INSTRUCTIONS

J02936

2020-01-14



BRAKE PEDAL PAD KIT, LARGE

GENERAL INFORMATION

Table 1. General Information

Kits	Suggested Tools	Skill Level ⁽¹⁾	Time
42712-04, 50600417	Safety Glasses, Torque Wrench		1 hour
<i>(1) Tightening to torque value or other moderate tools and techniques required</i>			

KIT CONTENTS

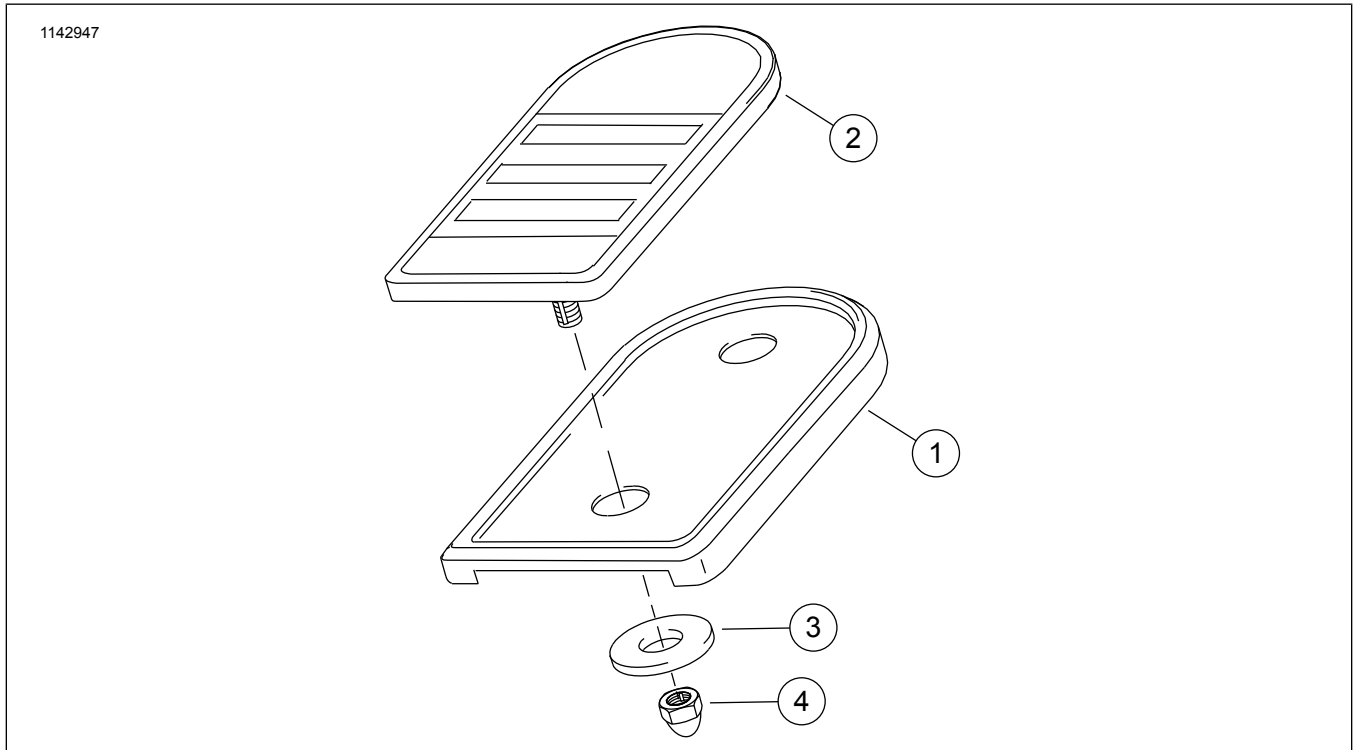

Figure 1. Kit Contents: Chrome Brake Pedal Pad Kit - Large Components

Table 2. Kit Contents: Chrome Brake Pedal Pad Kit - Large Components

<input checked="" type="checkbox"/>	Item	Qty	Description	Part No.	Notes
<input type="checkbox"/>	1	1	Cover,brake pedal, chrome	42410-04	
<input type="checkbox"/>		1	Cover,brake pedal, black (Kit 50600417)	50600245	
<input type="checkbox"/>	2	1	Pad, brake pedal	42444-04	
<input type="checkbox"/>	3	1	Shoulder washer, nylon Washer, flat, offset	6421	
<input type="checkbox"/>	4	1	Locknut, acorn, high crown	7946	



NOTE

Verify all contents are present in the kit before installing or removing items from vehicle.

GENERAL

Models

This kit is designed for installation on 1986 and later FLHT/C/CI/CUI, FLTR/I, FLHR/II/CI model motorcycles.

This kit can be used with Rider Footboard Kit (50631-04).

For model fitment information, see the P&A Retail Catalog or the Parts and Accessories section of www.harley-davidson.com (English only).

Verify that the most current version of the instruction sheet is used. It is available at: www.harley-davidson.com/isheets

Contact Harley-Davidson Customer Support Center at 1-800-258-2464 (U.S. only) or 1-414-343-4056.

Installation Requirements

▲ WARNING

Rider and passenger safety depend upon the correct installation of this kit. If the procedure is not within your capabilities or you do not have the correct tools, have a Harley-Davidson dealer perform the installation. Improper installation of this kit could result in death or serious injury. (00308b)

▲ WARNING

Brakes are a critical safety component. Contact a Harley-Davidson dealer for brake repair or replacement. Improperly serviced brakes can adversely affect brake performance, which could result in death or serious injury. (00054a)

REMOVE

1. Remove previously installed brake pedal cover (1) from motorcycle.

INSTALL

1. Position and slide **new** brake pedal cover (1) over brake pedal.
2. Align and install **new** brake pedal pad (2) with 5/16-18 stud and insert it through brake pedal cover (1) and brake pedal.
3. Install acorn locknut (4) and washer (3) on stud. Tighten.
Torque: 26 N·m (19 ft-lbs)