



# INSTRUCTIONS

94100033

2023-01-09



## OVERWATCH BAG

### GENERAL INFORMATION

Table 1. General Information

Kits	Suggested Tools	Skill Level <sup>(1)</sup>	Time
93300119, 93300120, 93300168	Safety Glasses		15 minutes

(1) Only simple tools and techniques required

### KIT CONTENTS

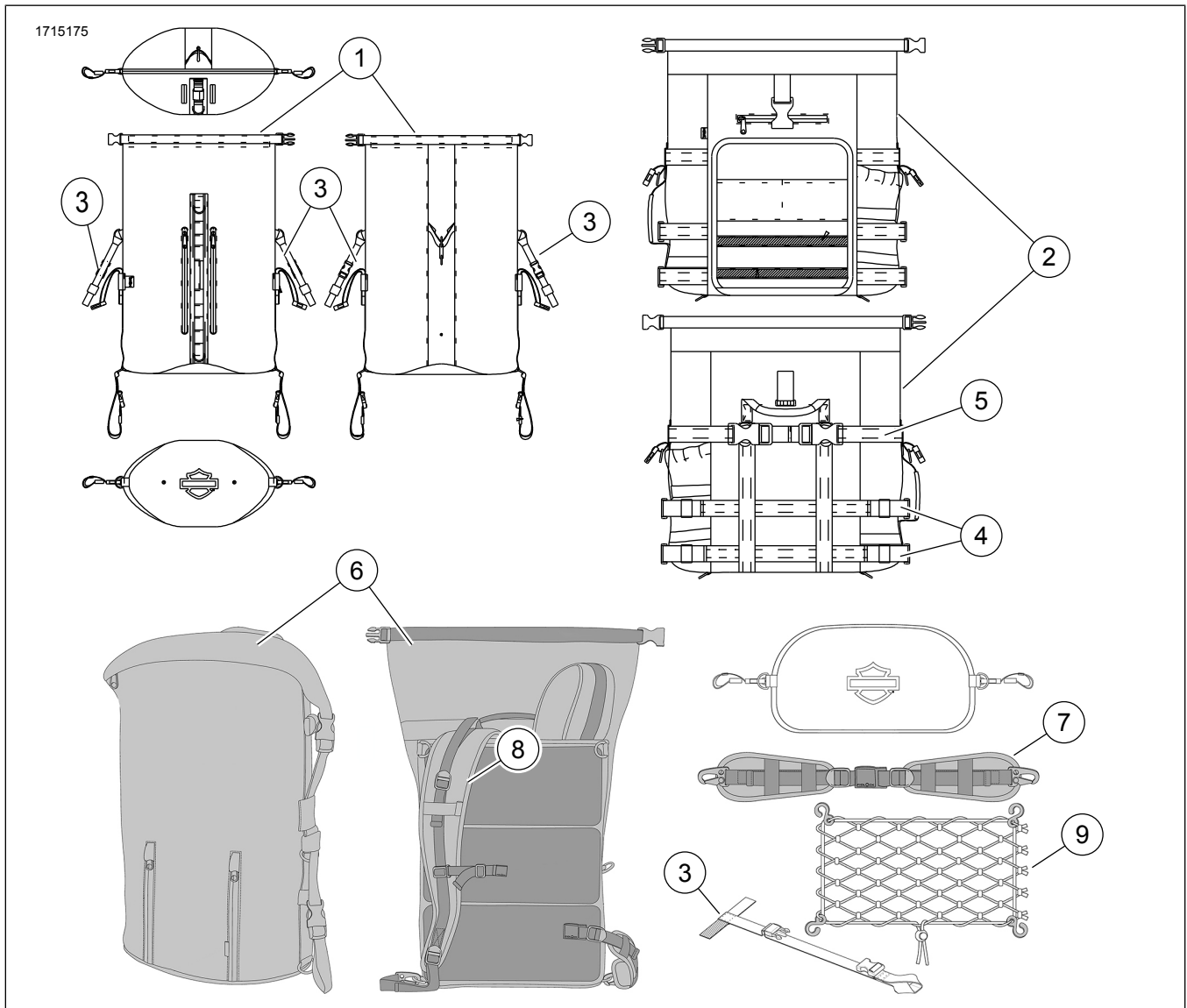

Figure 1. Kit Contents: Overwatch Bag Components

**Table 2. Kit Contents: Overwatch Bag Components**

<input checked="" type="checkbox"/>	Item	Qty	Description	Part No.	Notes
<input type="checkbox"/>	1	1	Bag, dry, Kit 93300119	Not sold separately	
<input type="checkbox"/>	2	1	Bag, sissybar, Kit 93300120	Not sold separately	
<input type="checkbox"/>	3	4	Strap, Kits 93300119, 9330168	93300138	
<input type="checkbox"/>	4	2	Strap, Kit 93300120	93300139	
<input type="checkbox"/>	5	1	Strap, Kit 93300120	93300140	
<input type="checkbox"/>	6	1	Bag, dry, Kit 93300168	Not sold separately	
<input type="checkbox"/>	7	1	Detachable waste belt, Kit 93300168	Not sold separately	
<input type="checkbox"/>	8	1	Shoulder strap, Kit 93300168	Not sold separately	
<input type="checkbox"/>	9	1	Cargo net, Kit 93300168	Not sold separately	

**NOTE**

Verify all contents are present in the kit before installing or removing items from vehicle.

**GENERAL**

**Models**

For model fitment information, see the P&A Retail Catalog or the Parts and Accessories section of [www.harley-davidson.com](http://www.harley-davidson.com) (English only).

Verify that the most current version of the instruction sheet is used. It is available at: [www.harley-davidson.com/isheets](http://www.harley-davidson.com/isheets)

Contact Harley-Davidson Customer Support Center at 1-800-258-2464 (U.S. only) or 1-414-343-4056.

**Installation Requirements**

**▲ WARNING**

Rider and passenger safety depend upon the correct installation of this kit. If the procedure is not within your capabilities or you do not have the correct tools, have a Harley-Davidson dealer perform the installation. Improper installation of this kit could result in death or serious injury. (00308b)

**INSTALL**

**▲ WARNING**

See **ACCESSORIES AND CARGO** section within the **SAFETY FIRST** section in your owner's manual. Improper cargo loading or accessory installation can cause component failure and adversely affect stability, handling and performance, which could result in death or serious injury. (00021c)

- Bag MUST be installed with the following:
  - a. See Figure 6 and Figure 7. Secure four straps with quick release buckles to luggage rack, passenger pillion, sissy bar or other vehicle structure.

- b. Figure 8 Secure at least two straps around sissybar.

- When installed on a luggage rack, do not exceed the load limit of the luggage rack or weight rating of bag, whichever is less.
- When installed on a passenger pillion, do not exceed 9 kg (20 lb) for Dry Bag and 11.3 kg (25 lb) Sissybar Bag.
- Verify that all straps are secured to prevent strap contact with rear wheel during motorcycle operation.
- Verify that bag, mounting straps and other components of luggage system do not cover or obstruct visibility of reflectors and lighting.
- Periodically recheck load.
- See owner's manual for recommended tire inflation pressure.

**▲ WARNING**

Do not exceed the motorcycle's Gross Vehicle Weight Rating (GVWR) or Gross Axle Weight Rating (GAWR). Exceeding these weight ratings can lead to component failure and adversely affect stability, handling and performance, which could result in death or serious injury. (00016f)

- GVWR is the total weight of the motorcycle, accessories, rider, passenger and cargo that can be safely carried.
- GAWR is the maximum amount of weight that can be safely carried on one axle.
- GVWR and GAWR are shown on the information plate, located on the frame downtube.

**Quick Release Buckles**

1. See Figure 2. Disconnect quick release buckles and clasps.

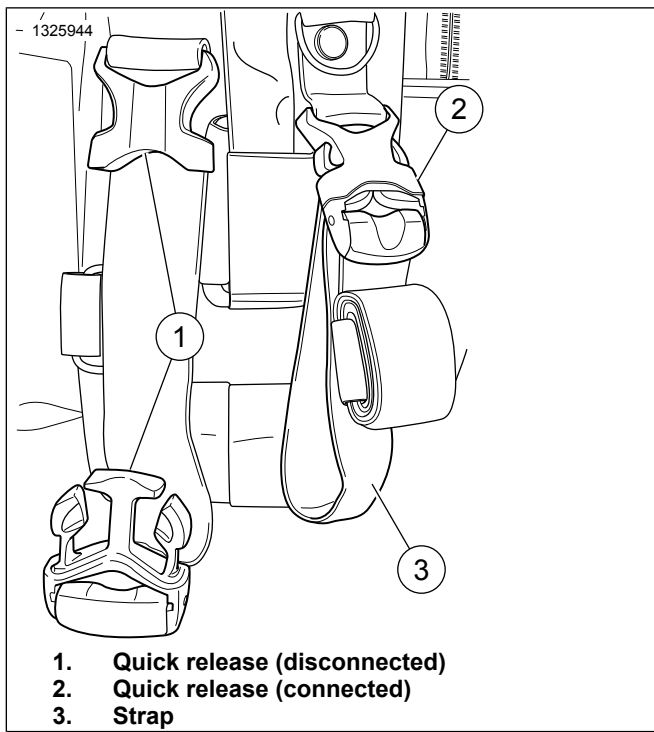

**Figure 2. Quick Release Buckle**

2. Secure straps to suitable vehicle structure.
3. Connect quick release buckles.
4. Pull straps tight to secure bag to vehicle.
5. See Figure 3. Close clasp to secure strap tightness.

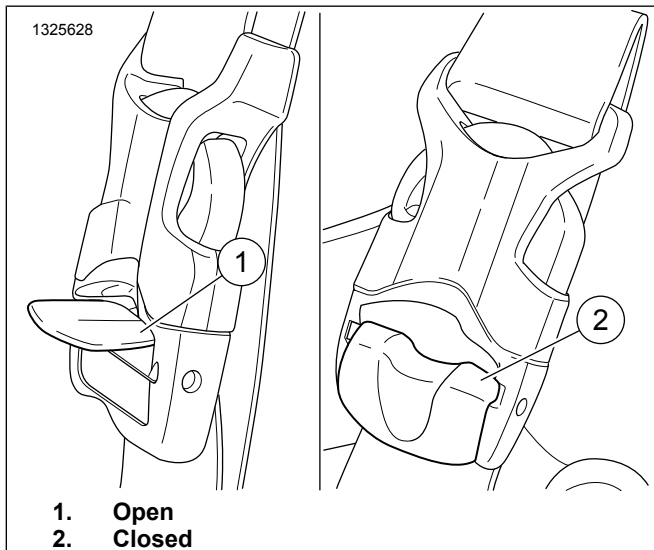

**Figure 3. Open/Close Clasp**

6. Check that bag is securely fastened to vehicle.
7. See Figure 4. Roll up and secure any excess strap material using hook-and-loop tabs to prevent straps from contacting the rear wheel or scratching or scuffing painted surfaces.

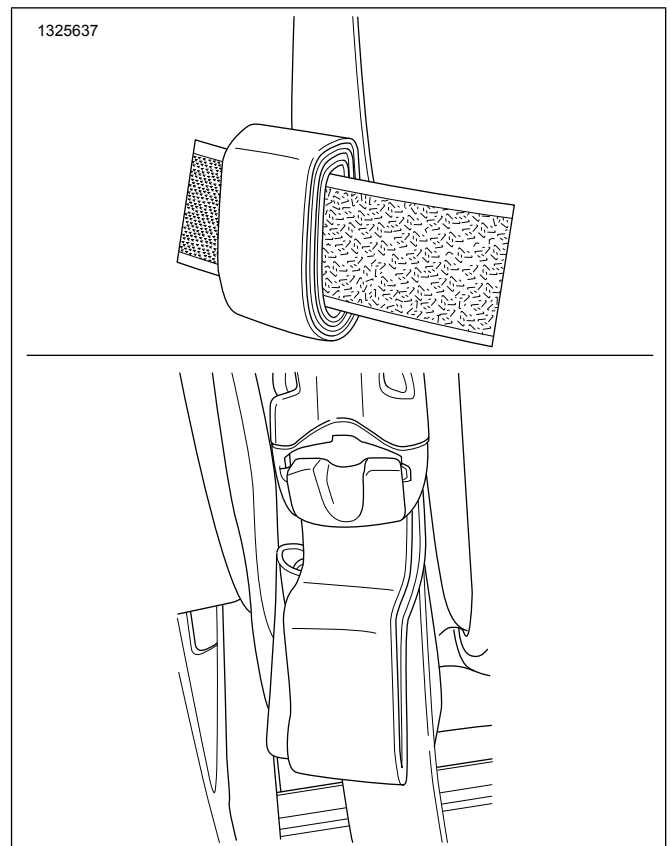

**Figure 4. Excess Strap Material**

### **Overwatch Dry Bag (Kits 93300119, 93300168)**

**NOTE**

- A passenger pillion or luggage rack is required to mount bag.
- Before attaching dry bag (93300168) to vehicle, store shoulder strap and waist belt in pocket of bag as shown in Figure 1.

1. Figure 5 Attach quick release buckle straps (3) on bag (1) by looping strap through D-rings.
2. Figure 6 Position bag on passenger pillion.
3. Quick Release Buckles Attach the four quick release buckle straps.

**NOTE**

See Figure 6 and Figure 7. Secure four straps with quick release buckles to luggage rack, passenger pillion, sissy bar or other vehicle structure.

4. Figure 7 Position bag on luggage rack.
5. Quick Release Buckles Attach the four quick release buckle straps.

**NOTE**

See Figure 6 and Figure 7. Secure four straps with quick release buckles to luggage rack, passenger pillion, sissy bar or other vehicle structure.

- a. Figure 7 For smaller pillions and luggage racks, bottom quick release buckle straps can be criss-crossed to ensure mounting straps can be fully tightened to secure luggage to vehicle.

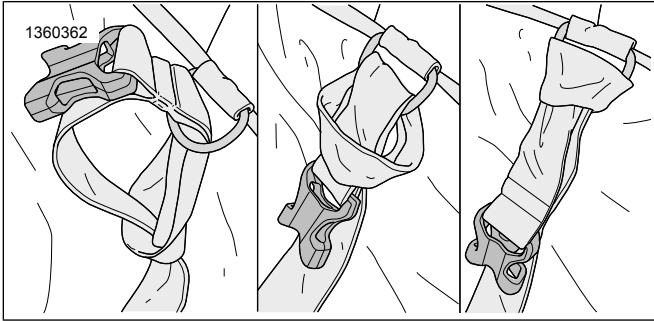

**Figure 5. Quick Release Buckle Strap (93300138)**

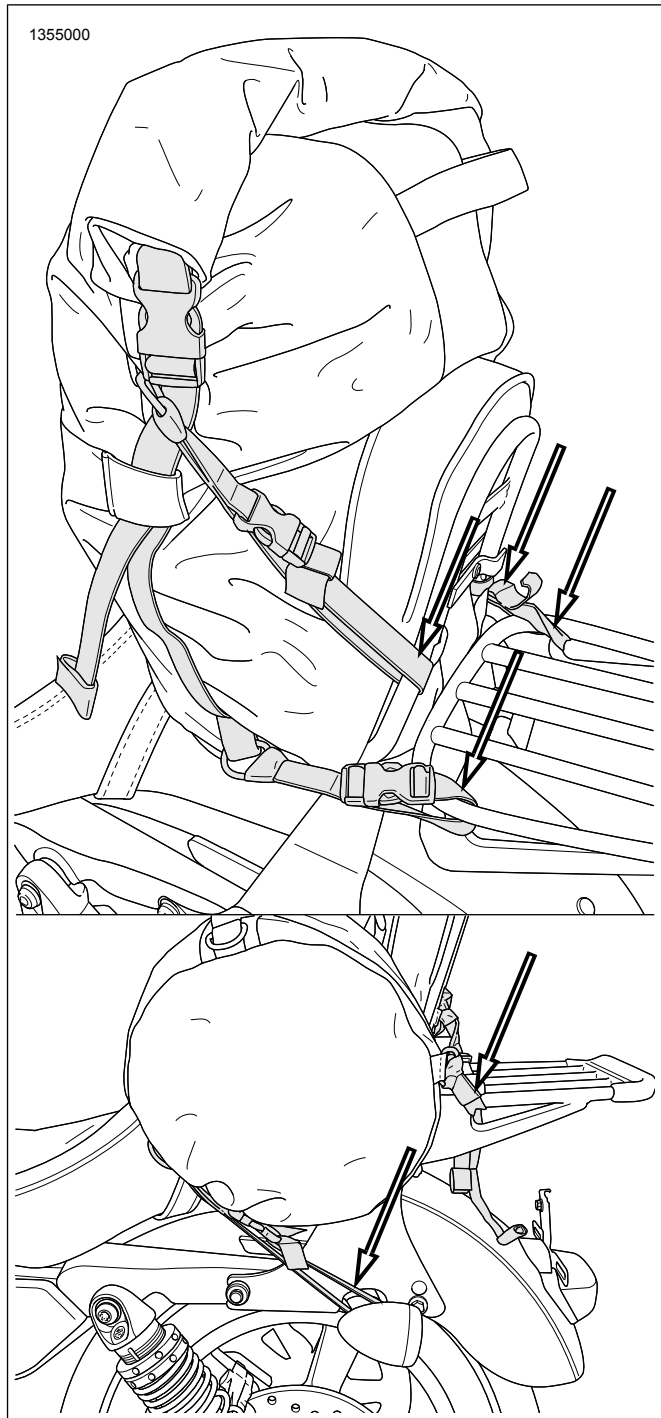

**Figure 6. Attachment to Pillion**

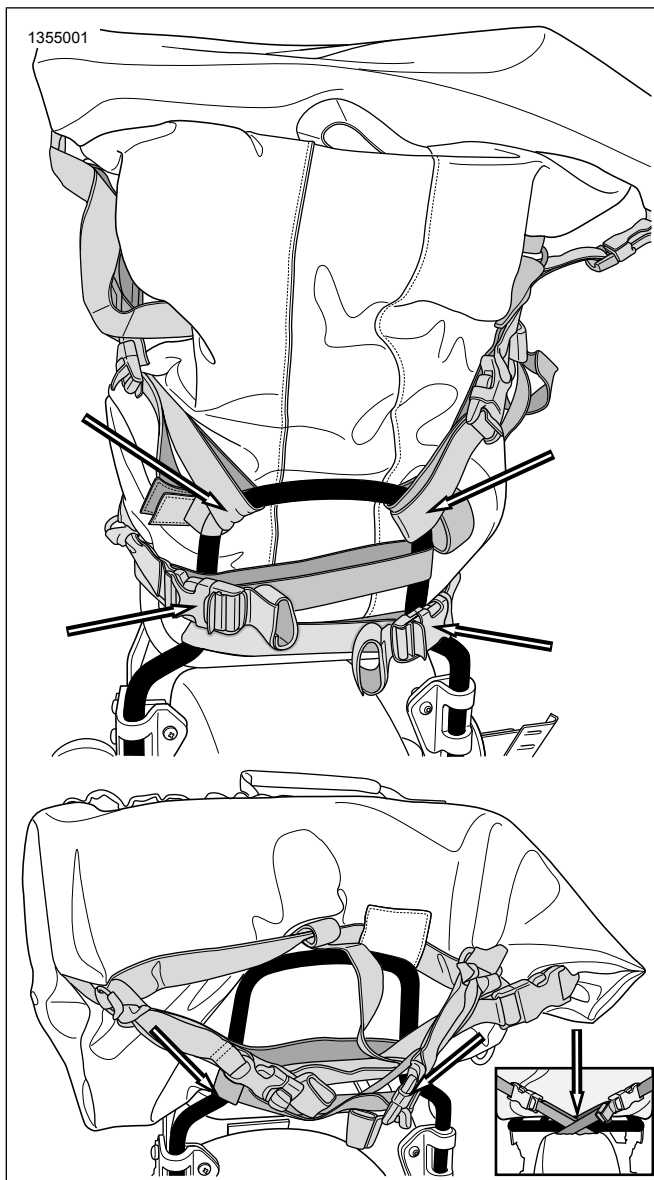

Figure 7. Attachment to Luggage Rack

## Overwatch Large Sissybar Bag

1. Figure 8 Position bag on luggage rack.
2. At minimum, attach the two bottom quick release buckle straps around sissybar.

### NOTE

*Depending on sissybar configuration, top quick release buckle strap may not fit around sissybar.*

3. If able, attach top quick release clasp buckle around sissybar.

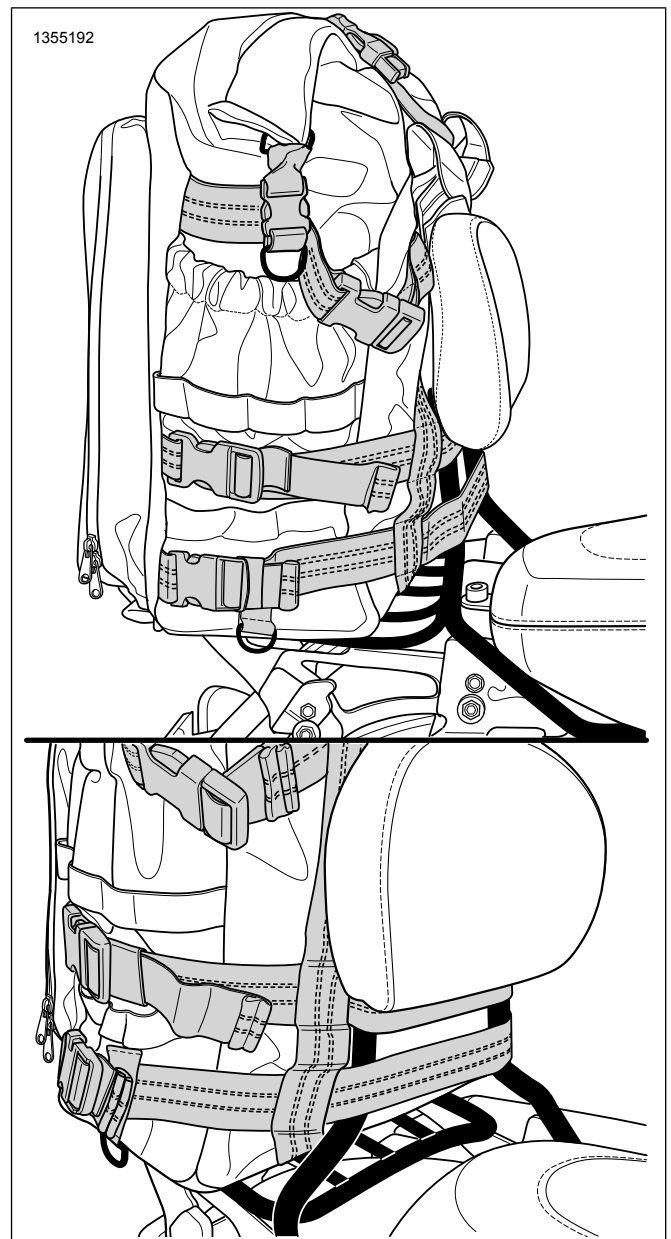

Figure 8. Attachment to Sissybar

## CARE AND MAINTENANCE INSTRUCTIONS

1. Use a lint free cloth to wipe off any dust or dirt.
2. Thoroughly clean outer surface with warm water and a mild detergent.
3. Do not use artificial means to dry material quickly.
4. Contains one or more of the following materials:
  - a. Polyester
  - b. Polypropylene
  - c. Polyethylene
  - d. Polyvinyl chloride