



INSTRUCTIONS

94100199

2021-08-02



DETACHABLE WINDSHIELD AND QUICK-CLAMP DOCKING KIT

GENERAL INFORMATION

Table 1. General Information

Kits	Suggested Tools	Skill Level ⁽¹⁾
57400459	Safety Glasses, Torque Wrench	

(1) Tightening to torque value or other moderate tools and techniques required

KIT CONTENTS

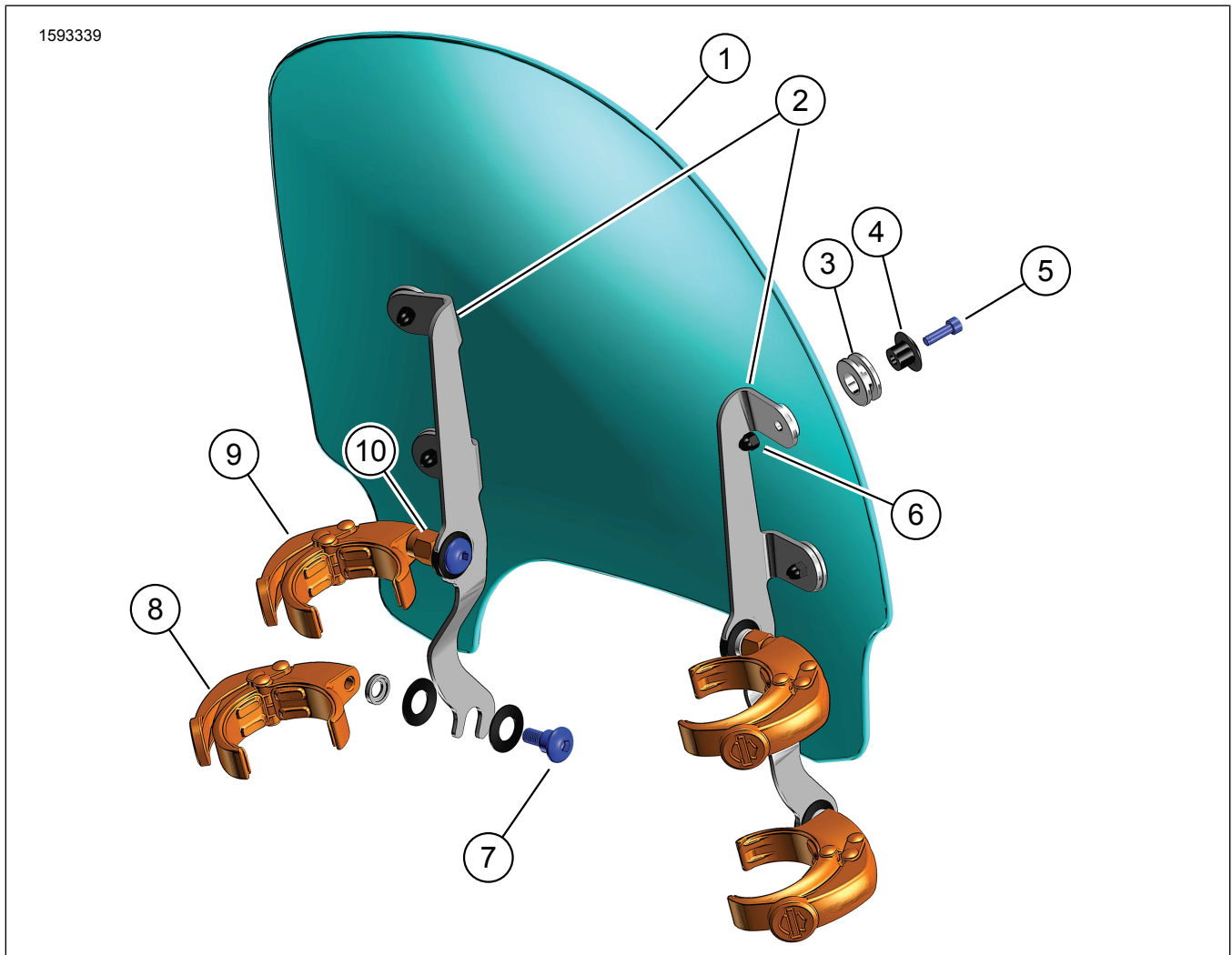

Figure 1. Kit Contents: Detachable Windshield and Quick-Clamp Docking Kit

Table 2. Kit Contents: Detachable Windshield and Quick-Clamp Docking Kit

<input checked="" type="checkbox"/>	Verify that all contents are present in the kit before installing or removing items from vehicle.				
Item	Qty	Description	Part No.	Notes	
<input type="checkbox"/>	1	1	Windshield, screen	57400461	
<input type="checkbox"/>	2	1	Windshield bracket, right	57400457	
<input type="checkbox"/>		1	Windshield bracket, left	57400458	
<input type="checkbox"/>	3	4	Grommet	11564	
<input type="checkbox"/>	4	4	Mount, windshield, top front, black	57400178	
<input type="checkbox"/>	5	4	Screw	10200218	6.8–10.8 N·m (5–8 ft-lbs)
<input type="checkbox"/>	6	4	Nut, M5 acorn, black	10400081	
<input type="checkbox"/>	7	4	Hardware kit	12600357	6.8 N·m (60 in-lbs)
<input type="checkbox"/>	8	2	Windshield clamp, 56mm	57400476	
<input type="checkbox"/>	9	2	Windshield clamp, 54mm	57400475	
<input type="checkbox"/>	10	2	Windshield clamp standoff	57400483	14.9 N·m (11 ft-lbs) LOCTITE 243 MEDIUM (BLUE)

GENERAL

Models

For model fitment information, see the Parts and Accessories (P&A) Retail Catalog or the Parts and Accessories section of www.harley-davidson.com.

Verify that the most current version of the instruction sheet is used. It is available at: h-d.com/isheets

Contact Harley-Davidson Customer Support Center at 1-800-258-2464 (U.S. only) or 1-414-343-4056.

Installation Requirements

⚠ WARNING

Rider and passenger safety depend upon the correct installation of this kit. If the procedure is not within your capabilities or you do not have the correct tools, have a Harley-Davidson dealer perform the installation. Improper installation of this kit could result in death or serious injury. (00308b)

PREPARE

Assemble Clamps to Windshield

NOTE

Cover front fender and front of fuel tank with clean shop towels to prevent scratching. Damage to finish could result.

1. Figure 2 Remove windshield sub-assembly from packaging.
 - a. Place face down on a clean, soft surface with mount brackets facing upward.

2. Figure 3 Remove both clamp (5) and hardware kits from packaging.

- a. Separate similar parts in preparation for assembly.

⚠ WARNING

The cupped side of the Belleville (cone) washers must face each other and sandwich the windshield mount brackets at each mount point. Failure to orient washers correctly can reduce windshield's ability to break away in a collision, which could result in death or serious injury. (00422b)

3. Pre-assemble clamp assemblies (5) and hardware stacks.
4. One clamp at a time, with clamp (5) facing upward and outboard of windshield bracket (2), tighten shoulder bolts (1) enough to hold clamp orientation to windshield during mounting of windshield to vehicle. Bolts will be fully tightened later.

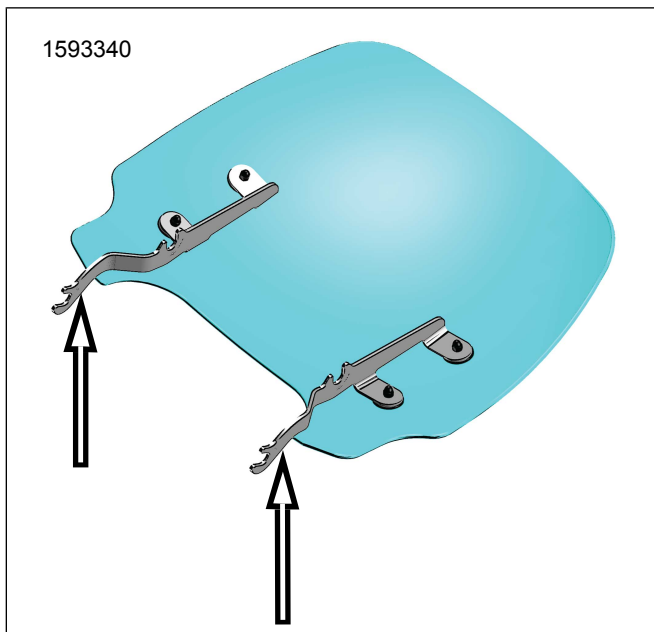

Figure 2. Windshield Mounting Brackets

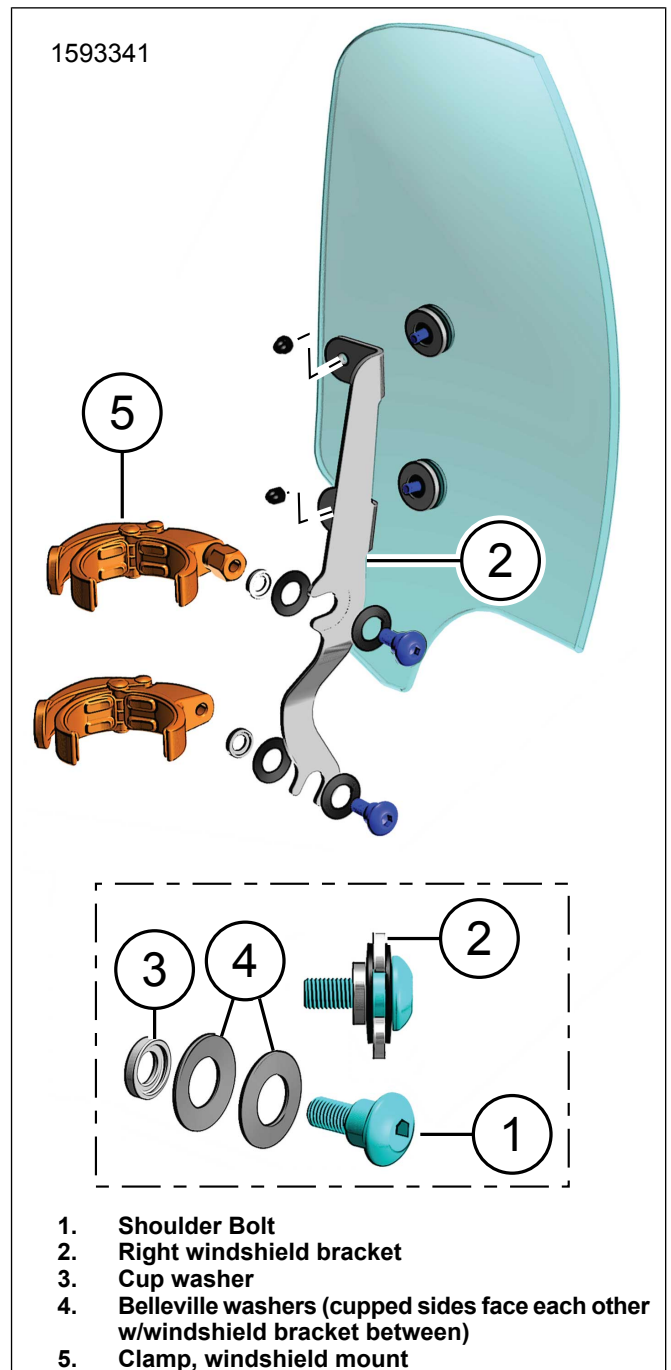

Figure 3. Windshield Mounting Clamps

Relocate Front Turn Signals

1. Figure 4 Loosen screw (1) on front turn signal (2).
2. Move front turn signal (2) approximately 35mm (1 3/8 in) (4) down fork tube (3).
3. Tighten screw (1).
Torque: 3–5 N·m (27–44 in-lbs)
4. Repeat steps on opposite side.

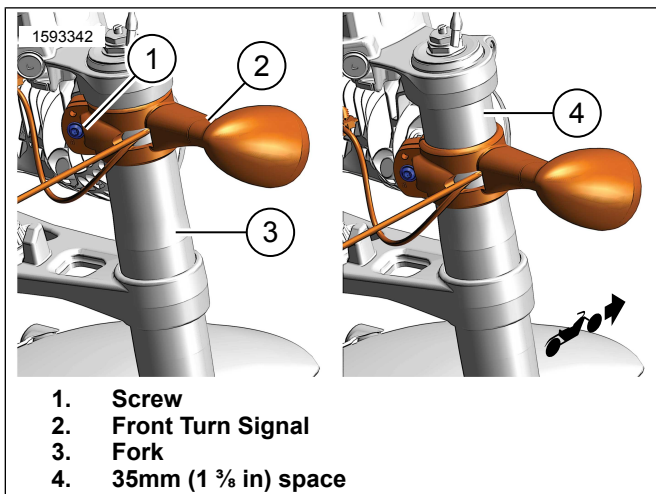

Figure 4. Relocate Turn Signal Brackets

INSTALL

NOTE

Polycarbonate windshield is fairly flexible and can be bent to spread clamps away from headlamp to ease installation to vehicle. Take care not to scratch headlamp housing with clamps while positioning windshield to fork sliders.

NOTE

Keep front wheel straight to prevent brackets from scratching fuel tank.

1. Make sure all four clamps are in "open" position.
2. Bring windshield (with clamp side away from you) to front of vehicle.
3. Straddle front fender, center windshield around headlamp and seat clamps onto fork sliders.

NOTE

Do not tighten shoulder bolts beyond recommended torque. Over-torquing may cause clamp to twist on fork slider, yielding clamp jaw. A yielded clamp may not carry a preload on fork slider and cause windshield to come loose during use.

4. Starting at bottom (either side) with shoulder bolts just a little more than finger tight, close each clamp.
 - a. Take note that clamps self-align to fork sliders and to each other.

NOTICE

Do not exceed recommended torque when installing mounting screws. Damage to windshield can result. (00385a)

5. With windshield clamps now clamped to fork sliders, make sure that shoulder portion of shoulder bolts are fully seated in each windshield bracket location. Tighten.

Torque: 6.8 N·m (60 in-lbs)

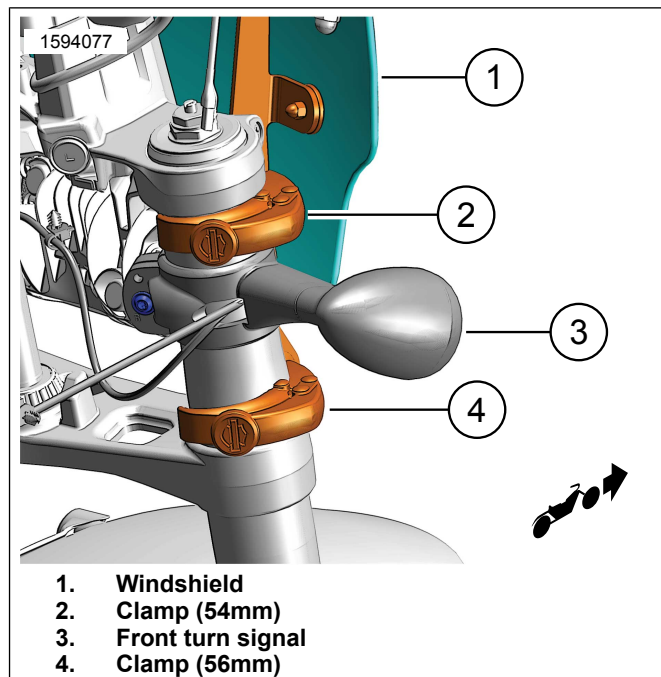

Figure 5. Windshield Installed

⚠ WARNING

Improper installation of accessories or loading of cargo can affect motorcycle stability and handling, which could result in death or serious injury. (00455b)

⚠ WARNING

Failure to provide adequate clearance between stationary and moving parts can cause loss of control, which could result in death or serious injury. (00378a)

NOTE

Inspect windshield upon completion of installation. Be sure windshield mounting does not restrict full left or full right movement of front fork assembly. If restriction does occur, adjust windshield as needed until proper clearance is obtained. Have experienced Harley-Davidson service personnel correct any problems before riding with this accessory installed.

NOTE

Check mounting hardware periodically. Never ride with loose mounts. A loose mounting causes extra stress on all other mounts, as well as windshield itself, and could result in premature failure of components.

Windshield Removal

To remove windshield, open the four clamps, in any sequence, and reverse preceding installation procedures. Take care to not scratch headlamp housing or fuel tank as noted during installation.

When storing windshield, place in a location where windshield clamps will receive greatest protection. Keep away from locations where windshield may be impacted or dropped. Do not stack anything on top of assembly.

Prior to installation after any storage period, inspect clamps and hardware for fastener preload and cleanliness. Each clamp should have a pair of rubber gaskets in clamp saddle that mates to fork slider, and should cycle open and close freely.

MAINTENANCE

NOTE

Sunlight reflections off of inside curvature of a windshield can, at certain times of day, cause extreme heat build-up on Vehicle instruments. Exercise care in parking. Park facing sun, place an opaque object over instruments, or adjust windshield to avoid reflections.

NOTICE

Polycarbonate windshields/wind deflectors require proper attention and care to maintain. Failure to maintain polycarbonate properly can result in damage to the windshield/wind deflector. (00483e)

NOTICE

Use only Harley-Davidson recommended products on Harley-Davidson windshields. Do not use harsh chemicals or rain sheeting products, which can cause windshield surface damage, such as dulling or hazing. (00231c)

Do not clean polycarbonate in hot sun or high temperature. Powdered, abrasive or alkaline cleanser will damage windshield. Never scrape windshield with a razor blade or other sharp instruments because permanent damage will result.

NOTE

Covering windshield with a clean, wet cloth for about 15 minutes before washing will make dried bug removal easier.