



INSTRUCTIONS

J05837

2013-10-31



HORN BRACKET ADAPTER KIT

GENERAL

Kit Number

69000058

Models

For model fitment information, see the P&A Retail Catalog or the Parts and Accessories section of www.harley-davidson.com (English only).

Additional Parts Required

Separate purchase and installation of additional parts or accessories may be required for proper installation of this kit on your model motorcycle. See the P&A Retail Catalog or the Parts and Accessories section of www.harley-davidson.com (English only) for a list of required parts or accessories for your model.

⚠ WARNING

Rider and passenger safety depend upon the correct installation of this kit. If the procedure is not within your capabilities or you do not have the correct tools, have a Harley-Davidson dealer perform the installation. Improper installation of this kit could result in death or serious injury. (00308b)

Kit Contents

See Figure 1 and Table 1.

There are no service parts available with this kit.

REMOVAL

1. See Figure 1. Remove screw (D) and detach horn assembly (E) from the frame. Save screw for later installation.

INSTALLATION

1. See Figure 1. Follow the instruction included with the engine guard kit and install the engine guard (A) with the following exception: Install the horn adapter bracket (1) to the rear of the frame.
2. Install the horn assembly to the horn bracket. Secure with screw (D). Tighten screw to 17.6–20.3 N·m (13–15 ft-lbs).

SERVICE PARTS

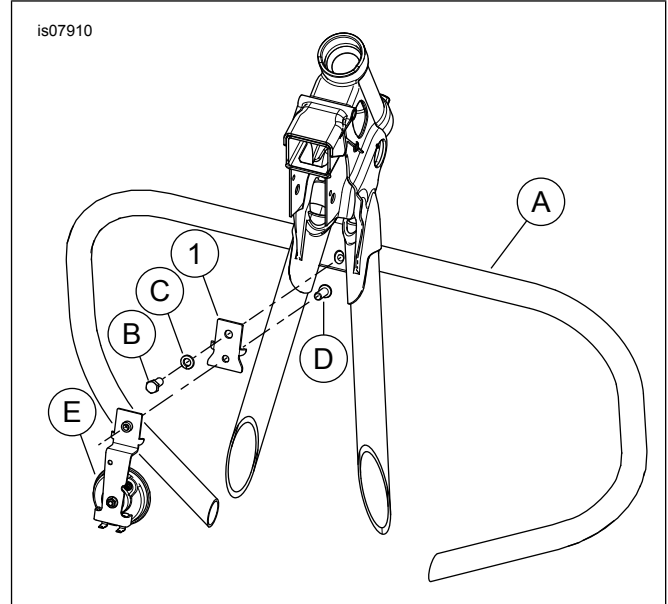

Figure 1. Service Parts: Horn Bracket Adapter Kit

Table 1. Service Parts

Item	Description (Quantity)	Part Number
1	Adapter bracket, horn	Not Sold Separately
Items mentioned in text, but not included in kit.		
A	Engine guard	
B	Screw	
C	Lockwasher	
D	Screw	
E	Horn assembly	