



INSTRUCTIONS

94100247

2022-02-22



ADVERSARY FOOTPEGS - RIDER

GENERAL INFORMATION

Table 1. General Information

Kits	Suggested Tools	Skill Level ⁽¹⁾
50502252, 50502253, 50502254, 50502255	Safety Glasses	
<i>(1) Only simple tools and techniques required</i>		

KIT CONTENTS

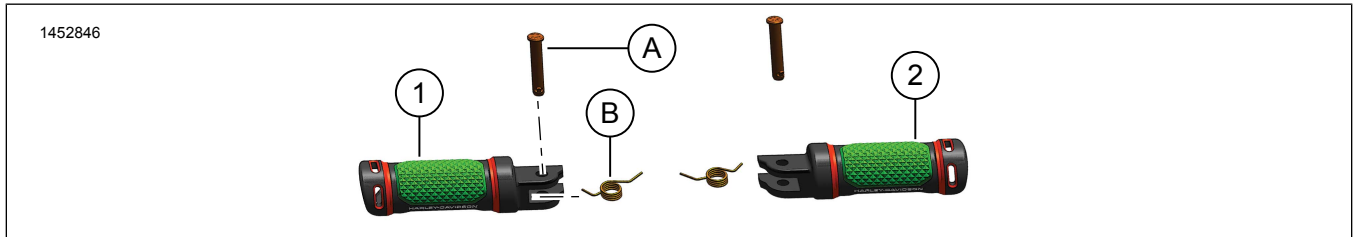

Figure 1. Kit Contents: Adversary Footpegs - Rider

Table 2. Kit Contents: Adversary Footpegs - Rider

Verify that all contents are present in the kit before installing or removing items from vehicle.					
<input checked="" type="checkbox"/>	Item	Qty	Description	Part No.	Notes
<input type="checkbox"/>	1	1	Footpeg, left, grey, small	50502376	
<input type="checkbox"/>			Footpeg, left, grey, large	50502387	
<input type="checkbox"/>			Footpeg, left, black, small	50502375	
<input type="checkbox"/>			Footpeg, left, black, large	50502386	
<input type="checkbox"/>	2	1	Footpeg, right, grey, small	50502374	
<input type="checkbox"/>			Footpeg, right, grey, large	50502385	
<input type="checkbox"/>			Footpeg, right, black, small	50502373	
<input type="checkbox"/>			Footpeg, right, black, large	50502384	
Items mentioned in text, but not included in kit					
<input checked="" type="checkbox"/>	A	2	Original Equipment (OE) Clevis pin		
<input checked="" type="checkbox"/>	B	2	OE Return spring		

GENERAL

Contact Harley-Davidson Customer Support Center at 1-800-258-2464 (U.S. only) or 1-414-343-4056.

Models

For model fitment information, see the Parts and Accessories (P&A) Retail Catalog or the Parts and Accessories section of www.harley-davidson.com.

Verify that the most current version of the instruction sheet is used. It is available at: h-d.com/isheets

Installation Requirements

⚠ WARNING

Rider and passenger safety depend upon the correct installation of this kit. If the procedure is not within your capabilities or you do not have the correct tools, have a Harley-Davidson dealer perform the installation. Improper installation of this kit could result in death or serious injury. (00308b)

REMOVE

1. Remove rider footpeg clevis pin (A).
 - a. Figure 2 Locate locking tab.
 - b. Push locking tab inward.
 - c. Using a small screwdriver, push upward and remove clevis pin.

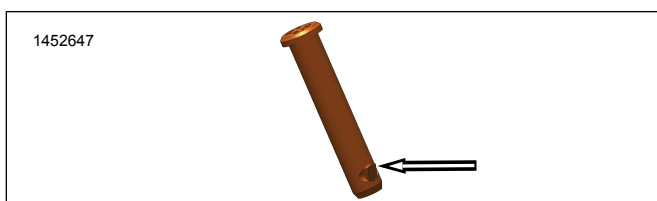

Figure 2. Clevis Pin Locking Tab

⚠ WARNING

Wear safety glasses or goggles when removing or installing spring. Spring tension can cause spring, attached components and/or hand tools to fly out which could result in death or serious injury. (00477c)

2. Remove OE rider footpeg.
 - a. Cover footpeg assembly return spring (B) area with a shop towel.
 - b. See Figure 3 or Figure 4. Pulling footpeg assembly outward, remove assembly from bracket.
 - c. Set aside return spring for future use.

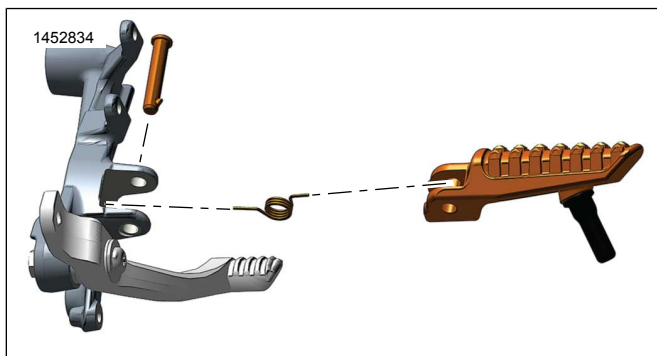

Figure 3. Footpeg - Rider - Right

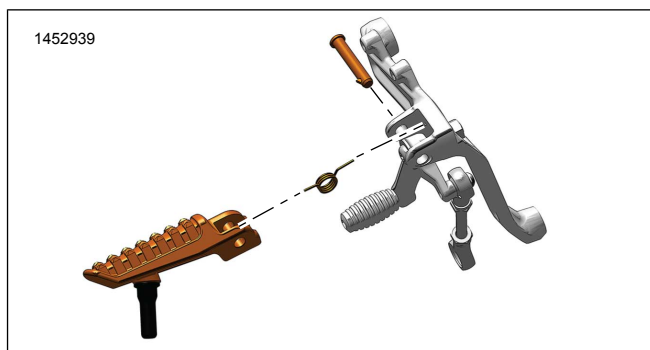

Figure 4. Footpeg - Rider - Left

INSTALL

1. Locate **new** footpeg assembly (1 or 2).
2. See Figure 5 or Figure 6. Position return spring (B) in to footpeg assembly.
3. Align return spring with bracket hole.



Figure 5. Return Spring Orientation - Right

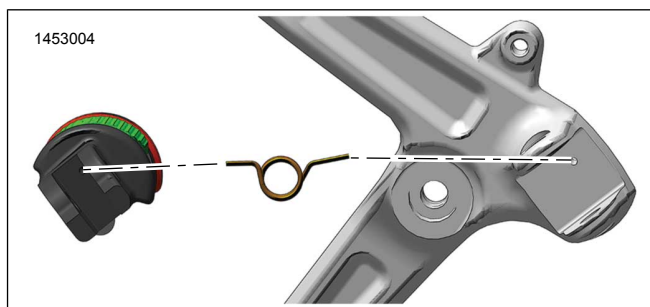

Figure 6. Return Spring Orientation - Left

4. Insert footpeg assembly in to bracket.
5. Position footpeg assembly to align with clevis pin hole.
6. From upper side of bracket, install clevis pin (A).
 - a. Verify clevis pin locking tab is fully seated.

COMPLETE

1. Verify operation.
 - a. Move footpeg assembly up, return spring should return assembly back in to place.