



# INSTRUCTIONS

J04148

2015-06-30



## XL SEAT KITS

### GENERAL

#### Kit Number

51736-07, 51737-07, 51738-07, 51739-07, 51747-07, 51749-07 and 52000024.

#### Models

For model fitment information, see the P&A Retail Catalog or the Parts and Accessories section of [www.harley-davidson.com](http://www.harley-davidson.com) (English only).

#### ⚠ WARNING

Rider and passenger safety depend upon the correct installation of this kit. If the procedure is not within your capabilities or you do not have the correct tools, have a Harley-Davidson dealer perform the installation. Improper installation of this kit could result in death or serious injury. (00308b)

#### ⚠ WARNING

Do not install these seat kits on motorcycles that are not equipped with an appropriate grab strap and passenger footpegs. If footpegs and grab strap are not installed, passenger could fall from moving motorcycle or grab onto operator, causing loss of control and death or serious injury. (00410b)

### Installation Requirements

On models without passenger footpegs, install Passenger Footpeg Kit 50500270 for 2014 and later models. Install Passenger Footpeg Kit 50203-04 for 2004 through 2013 models.

Installation of kits 52000209, 52000211, 52000259 on XL1200X, XL1200V, XL1200N, XL883N models require purchase of guide washer (part number 7487).

### Kit Contents

See Figure 3 and Table 1.

#### NOTICE

Detach passenger seat strap before removing seat. Failure to do so can result in damage to rear fender paint. (00225a)

### REMOVAL

Remove the seat according to the directions given in the Owners Manual.

All models except 2010 and later XL1200X, XL1200V, XL1200N, XL883N save the seat mounting screw (part number 2952A) to install the new seat.

2010 and later XL1200X, XL1200V, XL1200N, XL883N discard the seat mounting screw.



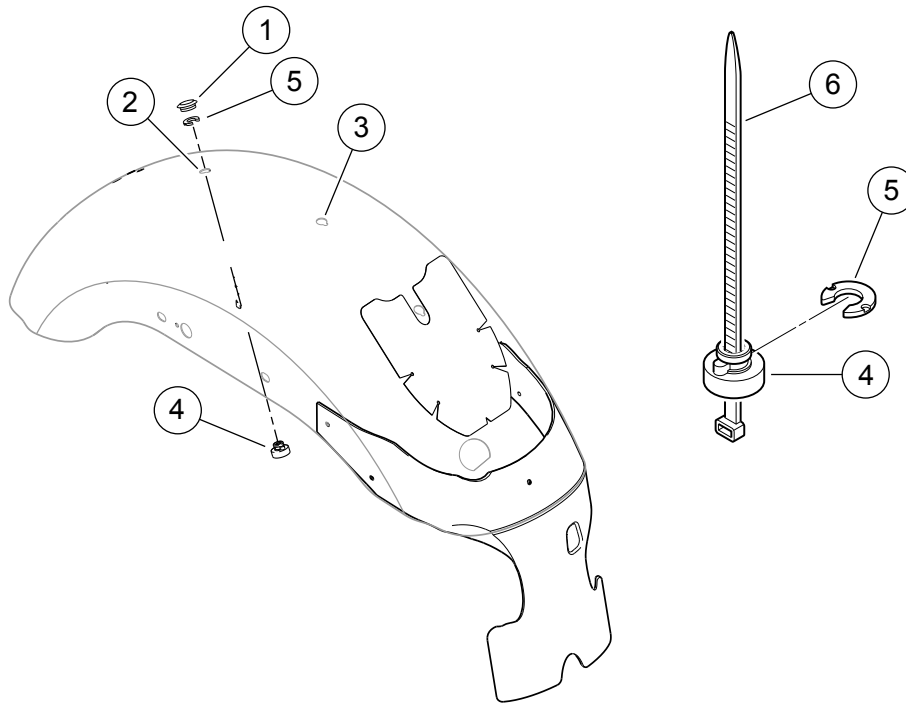

1. Fender plug
2. Rear fender hole plug location
3. Middle fender hole plug location

4. Seat retention nut
5. Retention washer
6. Cable strap

Figure 1. Fender Hole Locations



1. Tongue
2. Keyhole

Figure 2. Underside of 2-up seat

## INSTALLATION

### NOTE

If installing the seat with a sissybar/backrest pad present, remove the backrest pad prior to seat installation. This will prevent damage to the pad and/or seat. Install backrest pad after the seat is installed.

1. **Models equipped with solo seats:**For XL883 and XL883L models: see Figure 1.

- a. Remove the plastic plug (1) from the rear hole location in the fender (2). Save the plastic plug for installation.

- b. Move the seat retention nut (4) and lockwasher (5) from the middle location to the rear location, where the plug was just removed. As shown in the inset, a cable strap (6) can be used as an installation aid. Place the retention nut (5) over the cable strap so that the wide end of the nut rests on the eye of the cable strap. Thread the cable strap up under the fender, and through the fender hole. Pull up on the cable strap to hold the nut snug against the underside of the fender.
- c. With the rib of the retention nut (4) seated into the notch in the fender hole, slide the retention washer (5) into place from the rear. This will lock the retention nut in place.
- d. Install the plastic plug in the fender hole in the middle location.
- e. On XL1200N, XL883N, XL1200V and XL1200X models, remove screw in rearward fender hole and save for reuse.

### NOTE

The foam cushioning of the seat needs to be compressed as the seat is slid forward to engage the post on the frame when the seat is dropped into place. When properly installed, the front tongue on the underside of the seat should fit snugly in the groove at the fuel tank rear mounting location and the keyhole on the underside of the seat will lock the seat to the post on the frame.

2. **All models:** See Figure 2.
  - a. Angle the front of the new seat into place so the tongue (1) engages the slot at the rear fuel tank mounting location.
  - b. Push the seat forward and rotate the rear of the seat downward until the seat contacts the frame. Flex the seat slightly in the middle and slide the seat towards the rear so that the keyhole slot (2) on the seat bottom engages with the center seat post on the frame.
3. See Figure 3. Pull up on the center of the seat to verify that it is locked into place. (There will be a small amount of play, but the seat should only come up about a half an inch and then will be held firmly in place by the post on the underside of the seat.) If the seat is not firmly in place, repeat Step 2 until the seat is firmly in place. Reference the Owners Manual for further instruction on seat placement if needed.
4. Install the seat mounting (4) screw, and fasten the seat mounting bracket (3) to the top of the rear fender.
5. On XL1200N, XL883N, XL1200V and XL1200X models, place guide washer over rear seat mounting hole in fender before installing rear fender hole screw. Optional purchase of Quick release hardware (part number 51676-97A) may be used in lieu of existing screw 3085.
6. Tighten the mounting bracket screw securely to the fender.

**⚠ WARNING**

**After installing seat, pull upward on seat to be sure it is locked in position. While riding, a loose seat can shift causing loss of control, which could result in death or serious injury. (00070b)**

7. Pull up on the front and rear of the seat again to verify that it is properly secured.

## SERVICE PARTS

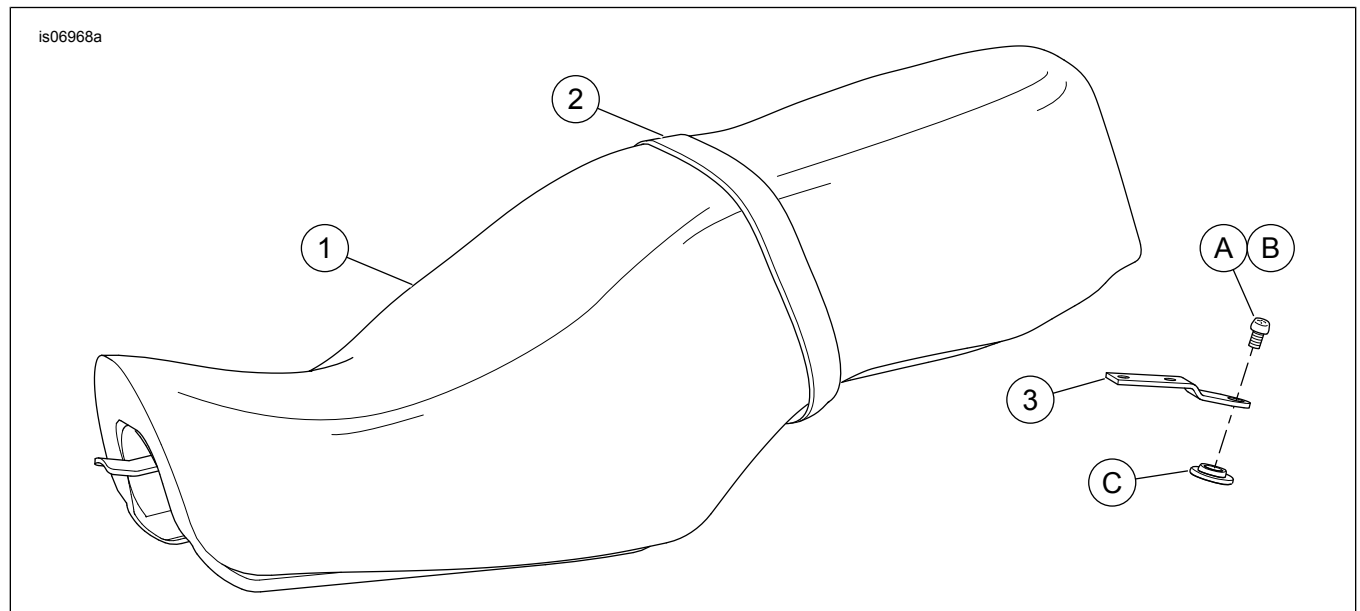

Figure 3. Service Parts: XL Seat

Table 1. Service Parts Table

Item	Description (Quantity)	Part Number	Item	Description (Quantity)	Part Number
1	Seat	Not sold separately	3	Mounting bracket	51652-97
2	Grabstrap		<b>Items mentioned in text, but not included in kit:</b>		
	Kits 51736-07 and 51739-07	51508-04	A	Seat mounting screw	2952A
	Kits 51747-07 and 51749-07	51184-00	B	Seat mounting screw	3085
	Kit 51737-07 and 51738-07	52293-04	C	Guide Washer	7487
	Kit 52000024	52400008			