



# INSTRUCTIONS

J06510

2024-01-25



## SOFTAIL STANDARD SIZED BACKREST PAD KITS

### GENERAL INFORMATION

Table 1. General Information

Kits	Suggested Tools	Skill Level <sup>(1)</sup>
52300557, 52300560, 52300733	Safety glasses, Torque wrench	
<i>(1) Tightening to torque value or other moderate tools and techniques required</i>		

### KIT CONTENTS

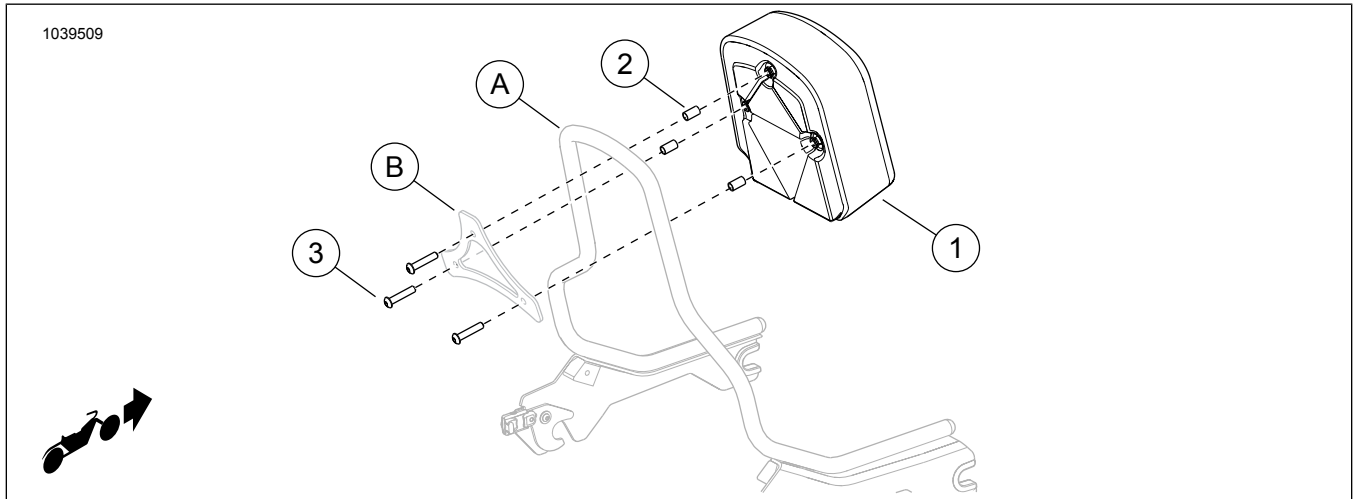

Figure 1. Kit Contents: Standard Sized Backrest Pad (Softail)

Table 2. Kit Contents: Standard Sized Backrest Pad Kit (Softail)

<input checked="" type="checkbox"/> Verify that all contents are present in the kit before installing or removing items from vehicle.					
<input type="checkbox"/>	Item	Qty	Description	Part No.	Notes
<input type="checkbox"/>	1	1	Backrest pad	Not sold separately	
<input type="checkbox"/>	2	3	Spacer	51593-05	
<input type="checkbox"/>	3	3	Screw	94554-97	
<b>Items mentioned in text, but not included in kit</b>					
<input checked="" type="checkbox"/>	A	1	Detachable sissy bar upright		
<input checked="" type="checkbox"/>	B	1	Mounting bracket		

### GENERAL

Contact Harley-Davidson Customer Support Center at 1-800-258-2464 (U.S. only) or 1-414-343-4056.

### Models

For model fitment information, see the Parts and Accessories (P&A) Retail Catalog or the Parts and Accessories section of [www.harley-davidson.com](http://www.harley-davidson.com).

Verify that the most current version of the instruction sheet is used. It is available at: [h-d.com/isheets](http://h-d.com/isheets)



## Installation Requirements

### ⚠ WARNING

Rider and passenger safety depend upon the correct installation of this kit. If the procedure is not within your capabilities or you do not have the correct tools, have a Harley-Davidson dealer perform the installation. Improper installation of this kit could result in death or serious injury. (00308b)

## INSTALL

1. Figure 1 If necessary, cut plastic rain seal away from two pre-cut holes in backrest (2) to prevent plastic from catching in the threads.
2. Place mounting bracket (B) against spacers (2), so that holes of mounting bracket align with spacers.
3. Insert one screw (3) from kit through one hole in bracket (B) and spacer (2).

### NOTE

*To avoid misalignment and cross threading of screws, start all three screws into backrest before tightening.*

- a. Carefully thread screw 4-5 turns into mating hole in backrest pad (1).
4. Repeat step 3 for remaining two screws (3). **DO NOT tighten a screw until all three screws have been started.**
  5. Once all three screws (3) have been carefully started into the three holes of backrest pad (1), tighten screws.

Torque: 6.2 N·m (55 **in-lbs**)