



INSTRUCTIONS

J06435

2019-01-15



SOFTAIL CUSTOM SOLO SEAT KITS

GENERAL

Kit Number

52000291, 52000292, 52000293, 52000302, 52000303, 52000304, 52000352, 52000389, 52000391, 52000429, 52000430

Models

For model fitment information, see the P&A Retail Catalog or the Parts and Accessories section of www.harley-davidson.com (English only).

Kit Contents

See Table 1.

INSTALLATION

▲ WARNING

Rider and passenger safety depend upon the correct installation of this kit. If the procedure is not within your capabilities or you do not have the correct tools, have a Harley-Davidson dealer perform the installation. Improper installation of this kit could result in death or serious injury. (00308b)

NOTE

When a solo seat is installed without a passenger seat, the passenger foot pegs or foot boards and the passenger grab strap must be removed.

When removing or installing the seat, do not scratch painted surfaces (fender, tank, and so on) with metal tab on seat.

1. Remove seat. See Owner's Manual.
2. See Figure 2. On the dual post mount fender (C), remove the plastic cap (F) from the front seat mount hole and install it in the rear seat mount hole.
3. Install the new seat, inserting the tongue at front of seat into the channel in the frame. See Owner's Manual.

4.

NOTE

If installing a pillion seat, install the grab strap before proceeding to the next step. See Owner's Manual.

Install thumbscrew (A) onto seat mount (B) or mounting nuts (D) onto mounting screws (E).

Torque: 1.7–3.4 N·m (1.3–2.5 ft-lbs)

5. After installing seat, pull up on the seat to verify that it is secure.

SERVICE PARTS

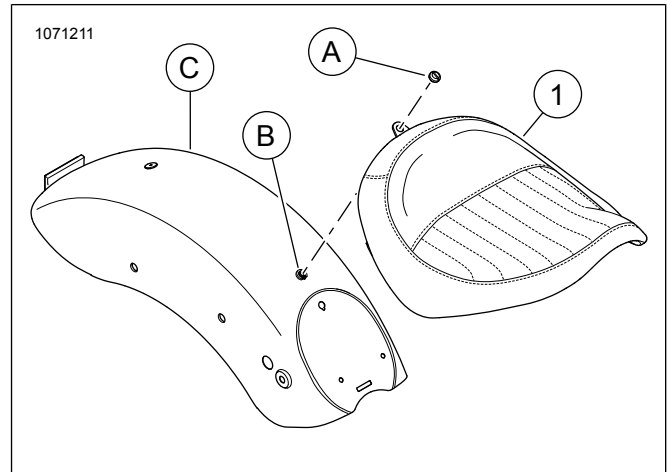

Figure 1. Service Parts: Single post mount

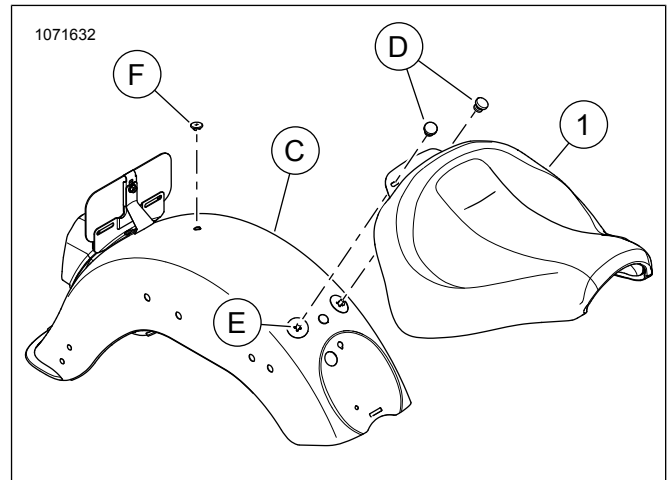

Figure 2. Service Parts: Dual post mount

Table 1. Service Parts: Softail Custom Solo Seat Kit

Item	Description (Quantity)	Part Number
1	Solo seat	Not Sold Separately
Items mentioned in text, but not included in kit:		
A	Thumbscrew	
B	Seat mount nut	
C	Rear fender	



Table 1. Service Parts: Softail Custom Solo Seat Kit

Item	Description (Quantity)	Part Number
D	Mounting nut	
E	Mounting screw	
F	Plastic cap	