



INSTRUCTIONS

J06689

2023-03-01



SCREAMIN' EAGLE TIMER COVER - MILWAUKEE EIGHT

GENERAL INFORMATION

Table 1. General Information

Kits	Suggested Tools	Skill Level ⁽¹⁾
25600117	Safety Glasses, Torque Wrench, Screwdriver	
<i>(1) Only simple tools and techniques required</i>		

KIT CONTENTS

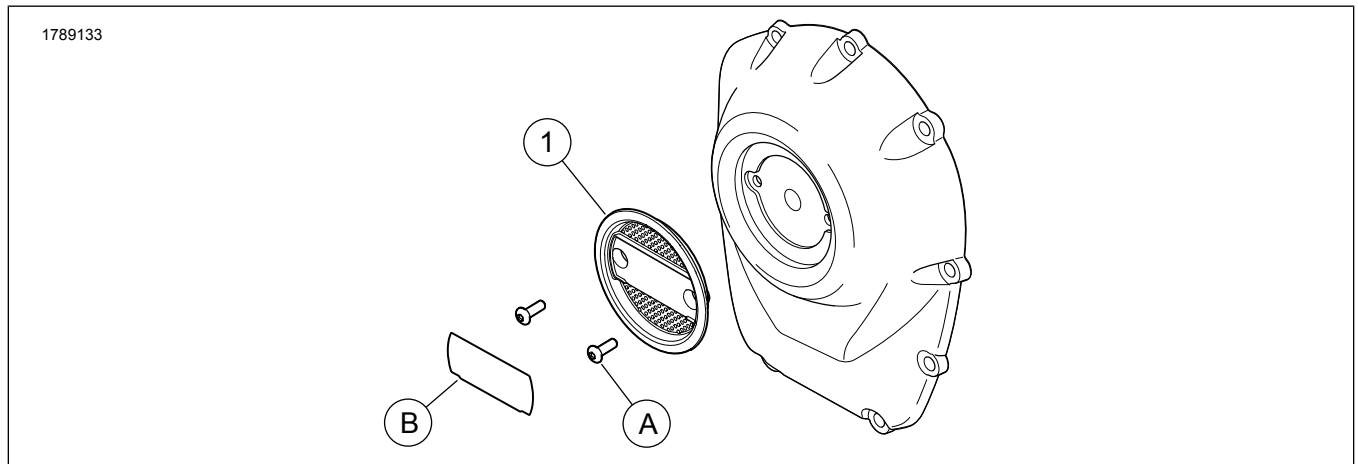

Figure 1. Kit Contents: Screamin' Eagle Timer Cover - Milwaukee Eight

Table 2. Kit Contents: Screamin' Eagle Timer Cover - Milwaukee Eight

Verify that all contents are present in the kit before installing or removing items from vehicle.					
<input checked="" type="checkbox"/>	Item	Qty	Description	Part No.	Notes
<input type="checkbox"/>	1	1	Timer cover	Not sold separately	
Items mentioned in text, but not included in kit:					
<input type="checkbox"/>	A	2	Screw (OE)	68120-00	
<input type="checkbox"/>	B	1	107 Stage I insert	25600118	Timer cover inserts are sold separately.
<input type="checkbox"/>		1	107 Stage II insert	25600119	
<input type="checkbox"/>		1	114 Stage I insert	25600132	
<input type="checkbox"/>		1	114 Stage II insert	25600120	
<input type="checkbox"/>		1	114 Stage III insert	25600121	
<input type="checkbox"/>		1	114 Stage IV insert	25600122	
<input type="checkbox"/>		1	117 Stage II insert	25600123	
<input type="checkbox"/>		1	117 Stage III insert	25600124	
<input type="checkbox"/>		1	117 Stage IV insert	25600125	
<input type="checkbox"/>		1	119 Stage III insert	25600153	
<input type="checkbox"/>		1	122 Stage III insert	25600154	
<input type="checkbox"/>		1	128 Stage IV insert	25600127	
<input type="checkbox"/>		1	131 Stage IV insert	25600129	
<input type="checkbox"/>		1	135 Stage IV insert	25600162	

GENERAL

Models

For model fitment information, see the Parts and Accessories (P&A) Retail Catalog or the Parts and Accessories section of www.harley-davidson.com.

Verify that the most current version of the instruction sheet is used. It is available at: h-d.com/isheets

Contact Harley-Davidson Customer Support Center at 1-800-258-2464 (U.S. only) or 1-414-343-4056.

Installation Requirements

⚠ WARNING

Rider and passenger safety depend upon the correct installation of this kit. If the procedure is not within your capabilities or you do not have the correct tools, have a Harley-Davidson dealer perform the installation. Improper installation of this kit could result in death or serious injury. (00308b)

NOTE

This instruction sheet references service manual information. A service manual for the year and model motorcycle is required for this installation and is available from:

- A Harley-Davidson dealer.
- H-D Service Information Portal, a subscription-based access available for most 2001 and newer models. For more information see *Frequently ask questions about subscriptions*.

INSTALL

1. Figure 1 Remove Original Equipment (OE) screws (A) and timer cover.
2. Install **new** timer cover (1).
3. Install OE screws (A). Tighten.
Torque: 2.8–3.9 N·m (25–35 in-lbs)

Timer Cover Insert

NOTE

See Table 2. *Timer cover inserts are sold separately.*

1. Clean insert surface area with a mixture of 50 to 70% isopropyl alcohol and 30 to 50% distilled water. Allow to dry thoroughly.

2. Figure 1 Peel liner from adhesive backing of timer cover insert (B).
3. Position insert over timer cover (1) without touching adhesive on timer cover insert surface.
4. Line up insert with recess timer cover.
5. Press timer cover insert firmly against the cover all around, and hold pressure for 30 seconds.
6. After releasing pressure, avoid direct contact with the insert for about 20 minutes.

NOTE

Allow at least 24 hours after applying the insert before exposing the area to vigorous washing, strong water spray or extreme weather. The adhesive bond will increase to maximum strength after about 72 hours at normal room temperatures.

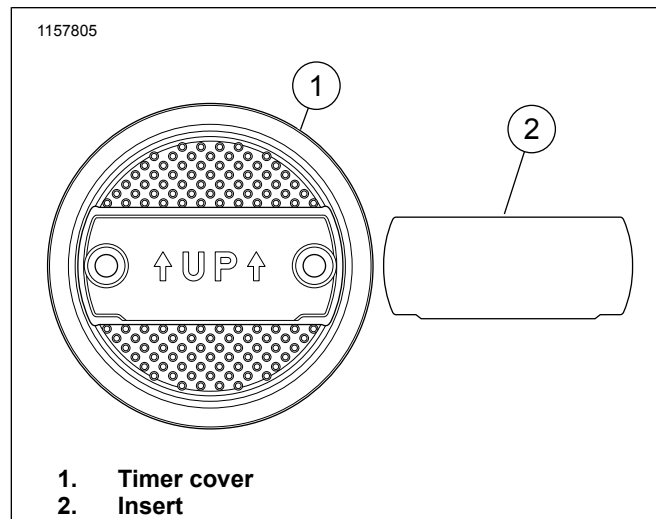

Figure 2. Assembly Orientation

Insert Replacement

To remove an existing timer cover insert, carefully insert a screwdriver (or similar tool) between the insert and timer cover at the bottom edge. Then pry the insert from the cover, being careful to not damage the cover during removal.

SPECIAL CARE INSTRUCTIONS

NOTE

To prevent damage to the chrome surface, do not use any detergents, chemical solvents, polishes or abrasive cleaning agents.

To keep surface in best condition, lightly wipe with a MICROFIBER DETAILING CLOTH (94663-02) using clear water or a mild Harley-Davidson cleaner such as:

- SUNWASH® BIKE SOAP (Part No. 93600129)
- BUG REMOVER (Part No. 93600122)
- GLOSS DETAILER (Part No. 93600123)