



INSTRUCTIONS

94100247

2023-01-09



ADVERSARY FOOTPEGS - RIDER

GENERAL INFORMATION

Table 1. General Information

Kits	Suggested Tools	Skill Level ⁽¹⁾
50502252, 50502253, 50502254, 50502255	Safety glasses, Torque wrench	
<i>(1) Tightening to torque value or other moderate tools and techniques required</i>		

KIT CONTENTS

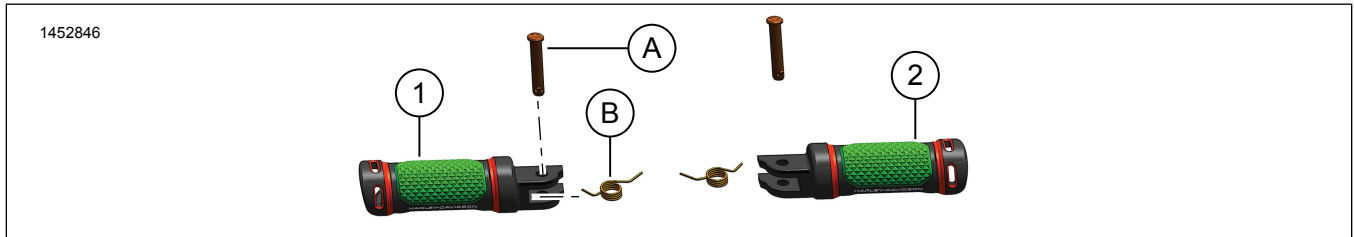

Figure 1. Kit Contents: Adversary Footpegs - Rider

Table 2. Kit Contents: Adversary Footpegs - Rider

Verify that all contents are present in the kit before installing or removing items from vehicle.					
<input checked="" type="checkbox"/>	Item	Qty	Description	Part No.	Notes
<input type="checkbox"/>	1	1	Footpeg, left, grey, small	50502376	
<input type="checkbox"/>			Footpeg, left, grey, large	50502387	
<input type="checkbox"/>			Footpeg, left, black, small	50502375	
<input type="checkbox"/>			Footpeg, left, black, large	50502386	
<input type="checkbox"/>	2	1	Footpeg, right, grey, small	50502374	
<input type="checkbox"/>			Footpeg, right, grey, large	50502385	
<input type="checkbox"/>			Footpeg, right, black, small	50502373	
<input type="checkbox"/>			Footpeg, right, black, large	50502384	
<input type="checkbox"/>	3	2	Wear peg (not shown)	50500628	
Items mentioned in text, but not included in kit					
<input checked="" type="checkbox"/>	A	2	Original Equipment (OE) Clevis pin		
<input checked="" type="checkbox"/>	B	2	OE Return spring		

GENERAL

Models

For model fitment information, see the Parts and Accessories (P&A) Retail Catalog or the Parts and Accessories section of www.harley-davidson.com.

Verify that the most current version of the instruction sheet is used. It is available at: h-d.com/isheets

Contact Harley-Davidson Customer Support Center at 1-800-258-2464 (U.S. only) or 1-414-343-4056.

Installation Requirements

⚠ WARNING

Rider and passenger safety depend upon the correct installation of this kit. If the procedure is not within your capabilities or you do not have the correct tools, have a Harley-Davidson dealer perform the installation. Improper installation of this kit could result in death or serious injury. (00308b)

REMOVE

1. Remove rider footpeg clevis pin (A).
 - a. Figure 2 Locate locking tab.
 - b. Push locking tab inward.
 - c. Using a small screwdriver, push upward and remove clevis pin.

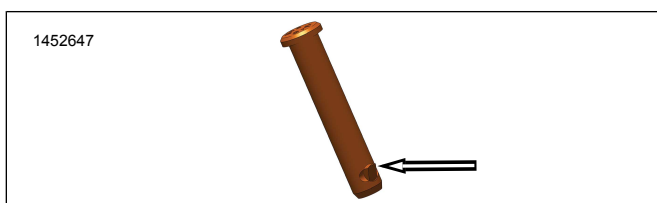

Figure 2. Clevis Pin Locking Tab

⚠ WARNING

Wear safety glasses or goggles when removing or installing spring. Spring tension can cause spring, attached components and/or hand tools to fly out which could result in death or serious injury. (00477c)

2. Remove OE rider footpeg.
 - a. Cover footpeg assembly return spring (B) area with a shop towel.
 - b. See Figure 3 or Figure 4. Pulling footpeg assembly outward, remove assembly from bracket.
 - c. Set aside return spring for future use.

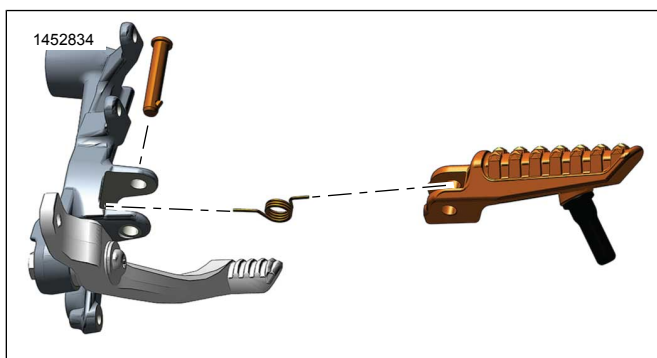

Figure 3. Footpeg - Rider - Right

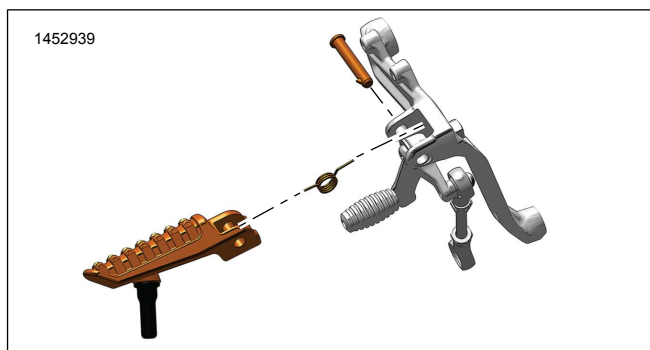

Figure 4. Footpeg - Rider - Left

INSTALL

1. Locate **new** footpeg assembly (1 or 2).
2. See Figure 5 or Figure 6. Position return spring (B) in to footpeg assembly.
3. Align return spring with bracket hole.

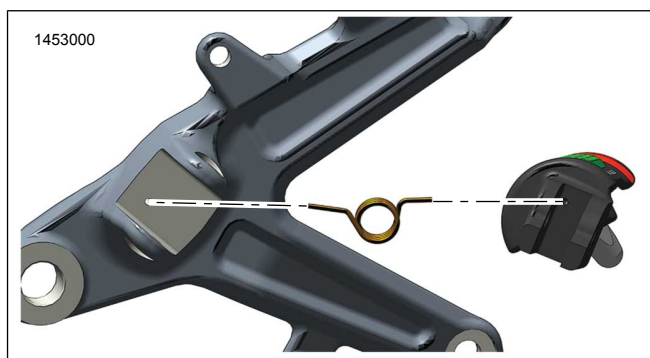

Figure 5. Return Spring Orientation - Right

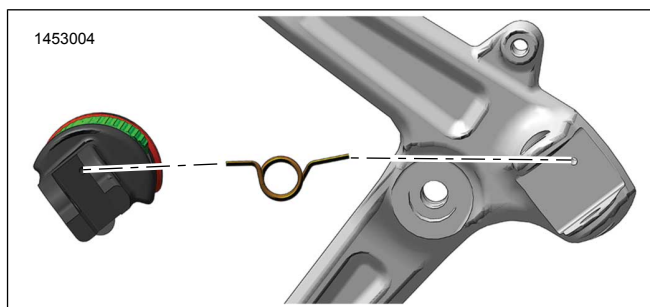

Figure 6. Return Spring Orientation - Left

4. Insert footpeg assembly in to bracket.
5. Position footpeg assembly to align with clevis pin hole.
6. From upper side of bracket, install clevis pin (A).
 - a. Verify clevis pin locking tab is fully seated.

Wear Peg Replacement

1. When servicing wear peg, remove existing wear tip from footpeg.

2. Apply two or three drops of threadlocker to threads of **new** wear peg.

Consumable: LOCTITE 243 MEDIUM STRENGTH
THREADLOCKER AND SEALANT (BLUE) (99642-97)

3. Install **new** wear peg to footpeg.

Torque: 3.38–4.74 N·m (30–42 **in-lbs**)

COMPLETE

1. Verify operation.
 - a. Move footpeg assembly up, return spring should return assembly back in to place.