



INSTRUCTIONS

J06660

2019-08-21



LIVEWIRE SPEED SCREEN BLADE CARBON FIBER

GENERAL INFORMATION

Table 1. General Information

Kits	Suggested Tools	Skill Level ⁽¹⁾	Time
57400400	Safety Glasses, Torque Wrench		1 hour
<i>(1) Tightening to torque value or other moderate tools and techniques required</i>			

KIT CONTENTS

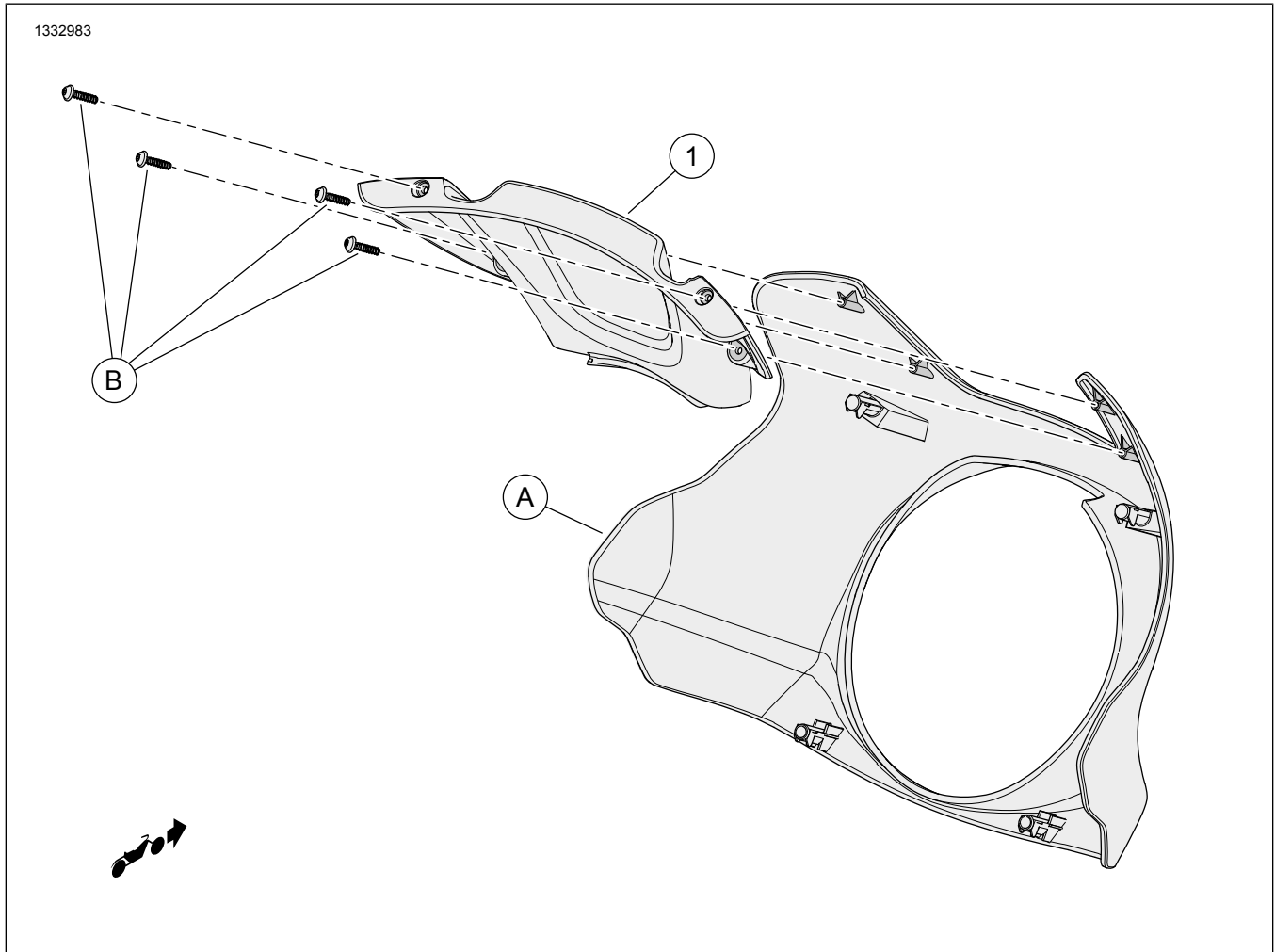

Figure 1. Kit Contents: Speed Screen Components



Table 2. Kit Contents: Speed Screen Components

<input checked="" type="checkbox"/>	Item	Qty	Description	Part No.	Notes
<input type="checkbox"/>	1		Speed screen, carbon fiber	Not sold separately	
Items mentioned in text, but not included in kit					
<input checked="" type="checkbox"/>	A	1	Original Equipment (OE) Fairing		
<input checked="" type="checkbox"/>	B	4	OE screw	10200721	Torque 0.5-0.65 Nm (4-6 in-lbs)

NOTE

Verify all contents are present in the kit before installing or removing items from vehicle.

GENERAL

Models

For model fitment information, see the P&A Retail Catalog or the Parts and Accessories section of www.harley-davidson.com (English only).

Verify that the most current version of the instruction sheet is used. It is available at: www.harley-davidson.com/isheets

Contact Harley-Davidson Customer Support Center at 1-800-258-2464 (U.S. only) or 1-414-343-4056.

Installation Requirements

▲ WARNING

Rider and passenger safety depend upon the correct installation of this kit. If the procedure is not within your capabilities or you do not have the correct tools, have a Harley-Davidson dealer perform the installation. Improper installation of this kit could result in death or serious injury. (00308b)

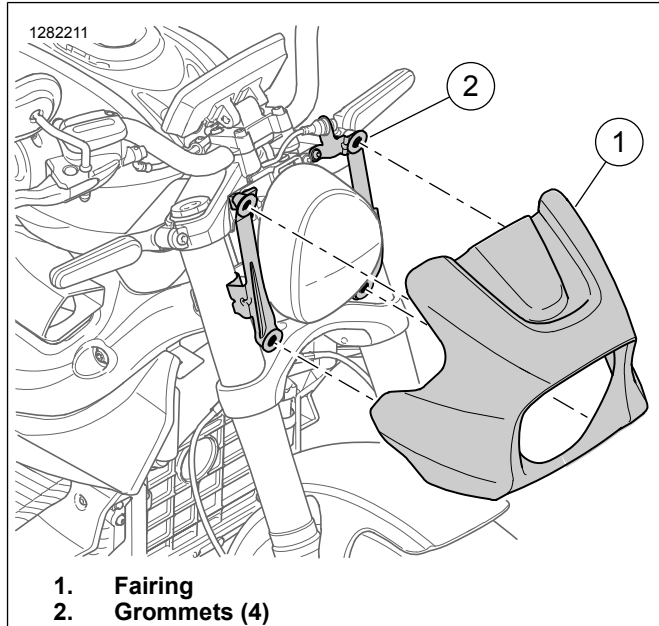

Figure 2. Front Fairing

REMOVE

1. Figure 2 Remove outer fairing (1) from grommets (2).
 - a. Pull fairing (1) by pulling directly forward on outer edge towards front of vehicle.
2. Figure 1 Remove OE screws (B).
3. Remove OE wind screen (1).

INSTALL

1. Install **new** carbon fiber speed screen (1) to fairing (A) using OE screws (B).
2. Secure screws (B). tighten.
Torque: 0.5–0.65 N·m (4–6 **in-lbs**)
3. Figure 2 Install outer fairing (1).
 - a. Align fairing (1) with grommets (2).
 - b. Install fairing (1) on grommets (2).