



INSTRUCTIONS

J06511

2019-08-21



BRAKE PEDAL PAD KIT

Table 1. General Information

Kits	Suggested Tools	Skill Level ⁽¹⁾	Time
Pedal Kits: 50600266, 50600267, 50600268, 50600269, 50600346, 50600347 Trim Kits: 50600290, 50600291, 50600292, 50600293, 50600294, 50600295, 50600296, 50600297, 50600365, 50600366, 50600367, 50600368	Safety Glasses, Torque Wrench		1 hour

(1) Tightening to torque value or other moderate tools and techniques required

KIT CONTENTS

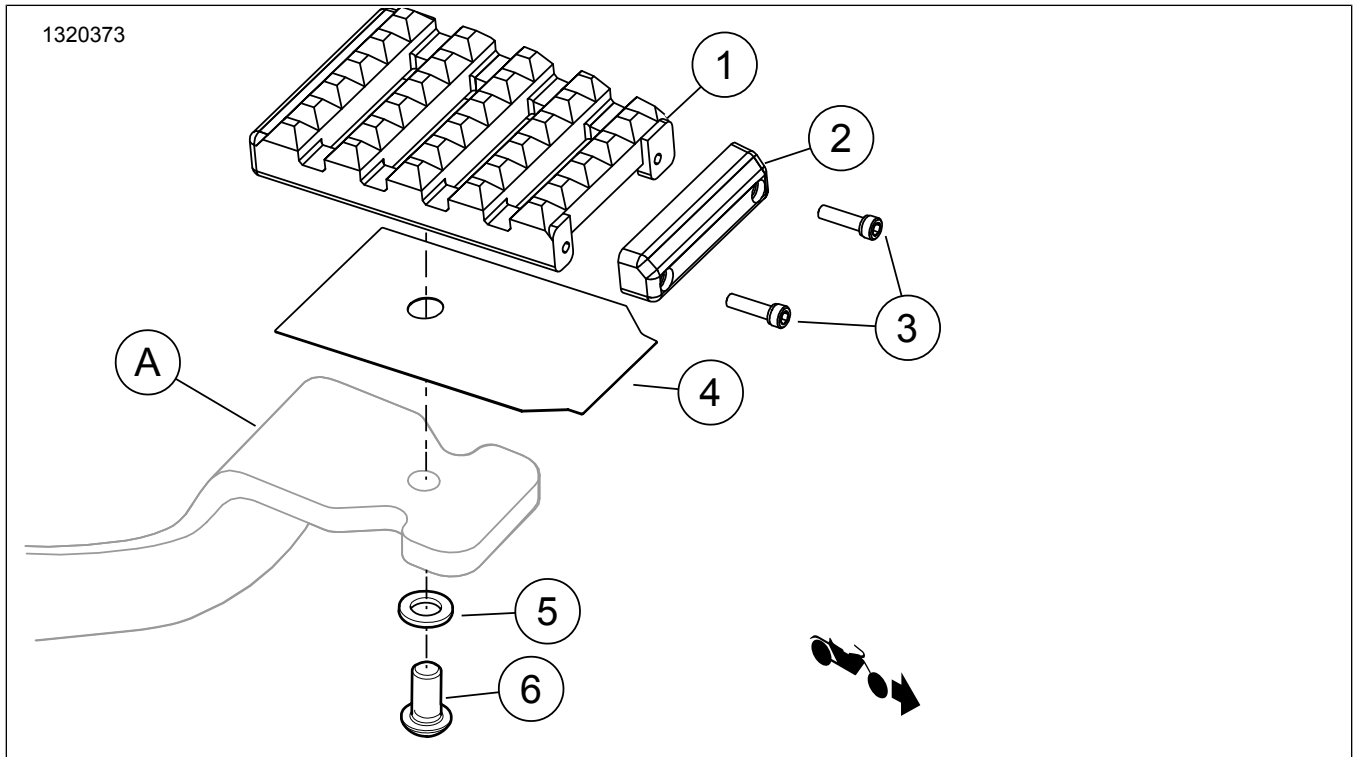

Figure 1. Kit Contents: Brake Pedal Pad Components



Table 2. Kit Contents: Brake Pedal Pad Components

<input checked="" type="checkbox"/>	Item	Qty	Description	Part No.	Notes
<input type="checkbox"/>	1	1	Brake pedal pad, large, Kits 50600266, 50600268, 50600346, 50600347, 50600365, 50600366, 50600367, 50600368	Not sold separately	
<input type="checkbox"/>			Brake pedal pad, small, Kits 50600267, 50600269	Not sold separately	
<input type="checkbox"/>	2	1	Trim, brake pedal pad, large, Kits 50600266, 50600268, 50600346, 50600347, 50600365, 50600366, 50600367, 50600368	Not sold separately	
<input type="checkbox"/>			Trim, brake pedal pad, small, Kits 50600267, 50600269	Not sold separately	
<input type="checkbox"/>	3	2	Screw, button head, Kits 50600266, 50600267, 50600268, 50600269	50600323	Torque: 1.7 - 2.3 Nm (15 - 20 in-lbs)
<input type="checkbox"/>			Screw, button head, Kits 50600346, 50600347	10200662	Torque: 1.7 - 2.3 Nm (15 - 20 in-lbs)
<input type="checkbox"/>	4	1	Insert, brake pedal pad, large, Kits 50600266, 50600268, 50600346, 50600347	Not sold separately	
<input type="checkbox"/>			Insert, brake pedal pad, small, Kits 50600267, 50600269	Not sold separately	
<input type="checkbox"/>	5	1	Washer, Kits 50600266, 50600267, 50600268, 50600269	12408	
<input type="checkbox"/>			Washer, Kits 50600346, 50600347	6333	
<input type="checkbox"/>	6	1	Screw, socket head, Kits 50600266, 50600267, 50600268, 50600269, 50600346, 50600347	10200663	Torque: 26 Nm (19 ft-lbs)
Items mentioned in text, but not included in kit.					
<input checked="" type="checkbox"/>	A		Foot brake lever		

NOTE

Verify all contents are present in the kit before installing or removing items from vehicle.

GENERAL

Models

For model fitment information, see the P&A Retail Catalog or the Parts and Accessories section of www.harley-davidson.com (English only).

Verify that the most current version of the instruction sheet is used. It is available at: www.harley-davidson.com/isheets

Contact Harley-Davidson Customer Support Center at 1-800-258-2464 (U.S. only) or 1-414-343-4056.

Installation Requirements

▲ WARNING

Rider and passenger safety depend upon the correct installation of this kit. If the procedure is not within your capabilities or you do not have the correct tools, have a Harley-Davidson dealer perform the installation. Improper installation of this kit could result in death or serious injury. (00308b)

REMOVE

1. Remove previously installed brake pedal cover from foot brake lever (A).

INSTALL

1. See Figure 1. Align and slide **new** brake pedal pad (1) and insert (4) over the end of foot brake lever (A).
2. Assemble plain washer (5) and screw (6).
3. Thread screw (6) through hole in foot brake lever (A) and into back of brake pedal pad (1). Tighten.
Torque: 26 N·m (19 ft-lbs)

REPLACE TRIM or WEAR PEG

1. See Figure 1. Remove screws (3).
2. Replace trim or wear peg (2) as applicable.
3. Apply one drop of threadlocker to screws (3).
Consumable: LOCTITE 243 MEDIUM STRENGTH THREADLOCKER AND SEALANT (BLUE) (99642-97)
4. Install screws (3). Tighten.
Torque: 1.7–2.3 N·m (15–20 in-lbs)