



# INSTRUCTIONS

J01471

2013-11-01



## FLHT/FLTR BADLANDER CUSTOM SEAT

### GENERAL

#### Kit Number

52265-01A

#### Models

For model fitment information, see the P&A retail catalog or the Parts and Accessories section of [www.harley-davidson.com](http://www.harley-davidson.com) (English only).

#### ▲ WARNING

Rider and passenger safety depend upon the correct installation of this kit. If the procedure is not within your capabilities or you do not have the correct tools, have a Harley-Davidson dealer perform the installation. Improper installation of this kit could result in death or serious injury. (00308b)

#### NOTE

This instruction sheet references Service Manual information. A Service Manual for your model motorcycle is required for this installation and is available from a Harley-Davidson Dealer.

#### Kit Contents

Table 1. Kit Contents

Item	Description	Part Number
1	Grab strap	51779-98
2	Seat (not shown)	Not sold separately

### INSTALLATION

#### NOTE

When performing the following installation procedures, be cautious not to scratch painted surfaces (fender, tank, etc.) with metal seat tabs or tools.

1. See Figure 1. Remove left and right saddlebags from motorcycle, saving all hardware for installation. **For FLTR vehicles**, see Figure 1. Remove existing grab strap from left side of vehicle by removing bolt (with flat washer) and forward saddlebag mounting bracket from chrome frame tube cover, noting mounting orientation of grab strap, saddlebag mounting bracket and hardware for installation. Remove existing grab strap from right side of vehicle in the same manner, noting mounting orientation of grab strap, saddlebag mounting bracket and hardware for installation. **For FLHT/C/U vehicles**, remove forward saddlebag mounting brackets. Save all hardware for installation.
2. Secure new grab strap to left side of vehicle by reassembling forward saddlebag mounting bracket and bolt to vehicle in same orientation from which they were removed. Tighten bolt finger tight.

3. **For FLHT/C/U and FLTR vehicles**, remove screw from rear of seat. Remove seat, saving screw. Also remove passenger grab rail if so equipped. Install locknuts on studs.

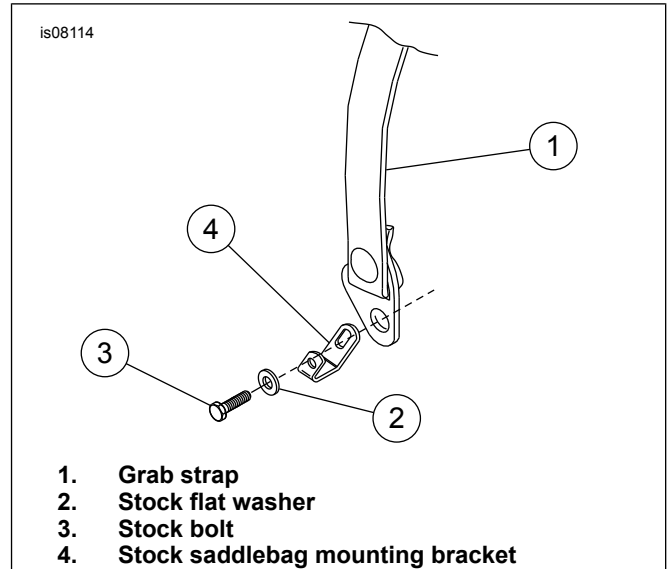

Figure 1. Vehicle Grab Strap Mounting Orientation

4. Install new seat from kit onto motorcycle, making certain that bracket on front of seat fully engages into seat mounting tab on frame.
5. Secure seat onto rear fender using screw saved in step 3.

#### ▲ WARNING

After installing seat, pull upward on seat to be sure it is locked in position. While riding, a loose seat can shift causing loss of control, which could result in death or serious injury. (00070b)

6. Secure new grab strap to right side of vehicle by reassembling forward saddlebag mounting bracket and bolt to vehicle in same orientation from which they were removed. Tighten bolt finger tight.
7. Reposition saddlebags (left and right) into place and secure.
8. With saddlebags in position, tighten forward saddlebag mounting bolts to 10 ft-lbs (13.6 Nm).

