



INSTRUCTIONS

94100110

2022-02-22



ADVERSARY SHIFT PEG

GENERAL INFORMATION

Table 1. General Information

Kits	Suggested Tools	Skill Level ⁽¹⁾
33600321, 33600322	Safety Glasses, Torque Wrench	
<i>(1) Tightening to torque value or other moderate tools and techniques required</i>		

KIT CONTENTS

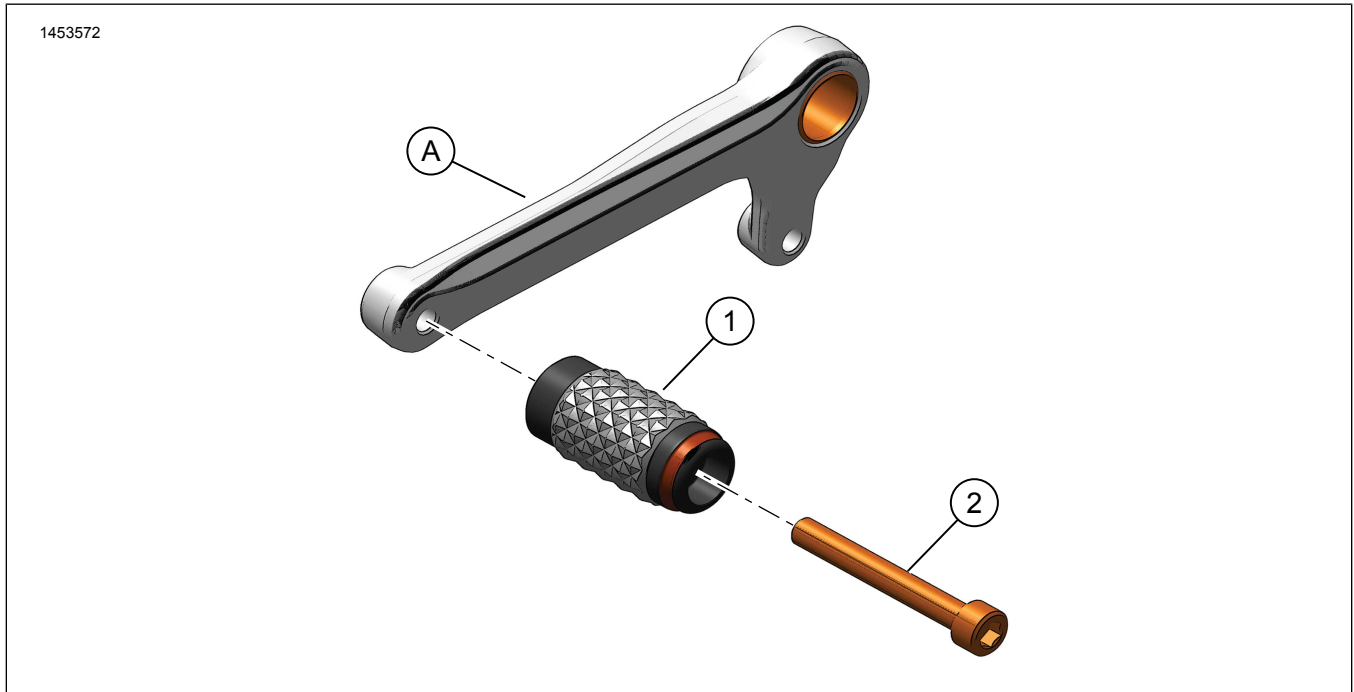

Figure 1. Kit Contents: Shift Peg

Table 2. Kit Contents: Shift Peg Kit

Verify that all contents are present in the kit before installing or removing items from vehicle.					
<input checked="" type="checkbox"/>	Item	Qty	Description	Part No.	Notes
<input type="checkbox"/>	1	1	Shift peg - Black Shift peg - Gray	Not sold separately	
<input type="checkbox"/>	2	1	Screw - M6x45	10201070	10.5–12 N·m (93–106 in-lbs)
Items mentioned in text, but not included in kit					
<input checked="" type="checkbox"/>	A	1	Original Equipment (OE) Shift lever		

GENERAL

Models

For model fitment information, see the Parts and Accessories (P&A) Retail Catalog or the Parts and Accessories section of www.harley-davidson.com.

Verify that the most current version of the instruction sheet is used. It is available at: h-d.com/isheets

Contact Harley-Davidson Customer Support Center at 1-800-258-2464 (U.S. only) or 1-414-343-4056.

Installation Requirements

⚠ WARNING

Rider and passenger safety depend upon the correct installation of this kit. If the procedure is not within your capabilities or you do not have the correct tools, have a Harley-Davidson dealer perform the installation. Improper installation of this kit could result in death or serious injury. (00308b)

REMOVE

1. Figure 2 Remove OE shift peg.

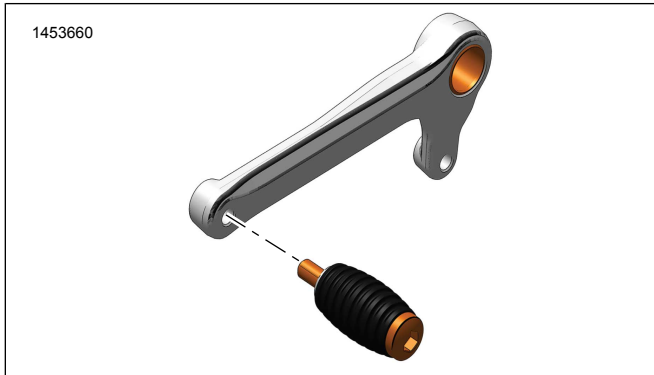

Figure 2. OE Shift Peg

INSTALL

1. Install **new** shift peg (1, 2).
 - a. Holding the shift lever (A) in place.
 - b. Align the **new** shift peg (1) and screw (2) with shift lever.
 - c. Install peg assembly. Tighten.
Torque: 10.5–12 N·m (93–106 **in-lbs**)
2. Position vehicle to neutral.