



INSTRUCTIONS

J06808

2019-08-21



RIDE FREE FOOTBOARD PASSENGER

Table 1. General Information

Kits	Suggested Tools	Skill Level ⁽¹⁾	Time
50501399, 50501402	Safety Glasses, Flat-Bladed Tool, Dish soap		1 hour

(1) Only simple tools and techniques required

KIT CONTENTS

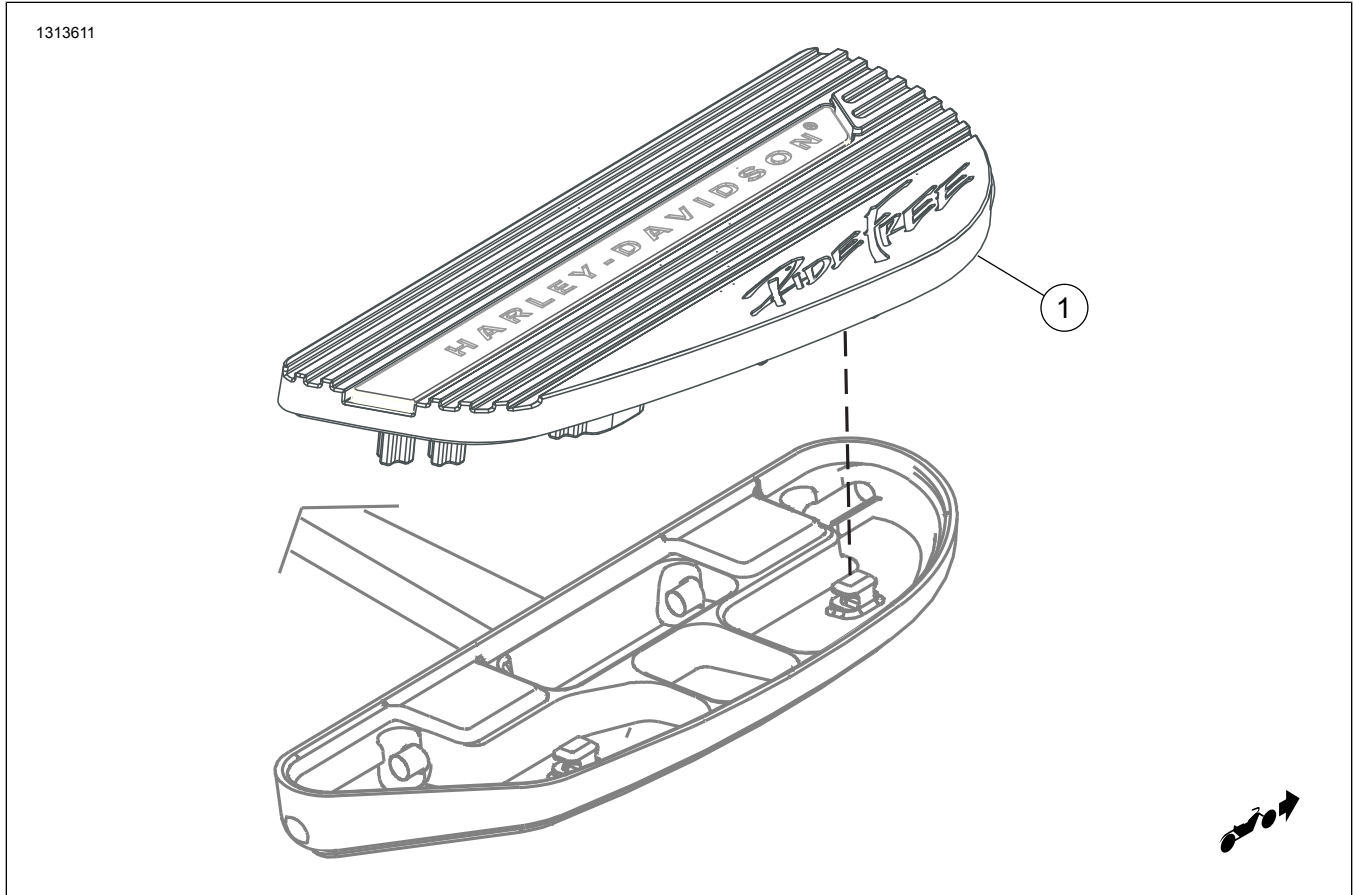

Figure 1. Kit Contents: Footboard Insert Components (Right side shown)

Table 2. Kit Contents: Footboard Insert Components

<input checked="" type="checkbox"/>	Item	Qty	Description	Part No.	Notes
<input type="checkbox"/>	1	2	Footboard, passenger	Not sold separately	

NOTE

Verify all contents are present in the kit before installing or removing items from vehicle.

GENERAL

Models

For model fitment information, please see the P&A Retail Catalog or the Parts and Accessories section of www.harley-davidson.com (English only).

Ensure you are using the most current version of the instruction sheet which is available at: www.harley-davidson.com/isheets

Contact Harley-Davidson Customer Support Center at 1-800-258-2464 (U.S. only) or 1-414-343-4056.

Installation Requirements

This kit contains two foot board inserts.

There are no service parts available with this kit.

⚠ WARNING

Rider and passenger safety depend upon the correct installation of this kit. If the procedure is not within your capabilities or you do not have the correct tools, have a Harley-Davidson dealer perform the installation. Improper installation of this kit could result in death or serious injury. (00308b)

INSTALLATION

If passenger footboards are not currently installed:

1. Install footboard support bracket per bracket instruction sheet.
2. Install appropriate footboard pan per pan instruction sheet.

If passenger footboards of different shape are installed:

1. Remove footboard pan per pan instruction sheet.
2. Install appropriate footboard pan per pan instruction sheet.

If passenger footboards of correct shape are installed:

1. Place passenger footboard in the “down” position.

2. *NOTE*

Take steps to avoid scratching the footboard pan.

Carefully raise an outside “corner” of the insert off the footboard pan with a suitable flat-bladed tool.

3. Continue around the edge of the footboard, using a second flat-bladed tool if necessary to pry up and remove the old insert.
4. Repeat the above steps for the remaining footboard insert.

All applications:

1. *NOTE*

Medallion of Ride Free inserts should be toward rear of bike.

Center the two footboard pivot pins.

2. Apply liquid dishwashing soap to the dowel pins and pivot pin holes on the new footboard insert.
3. Apply liquid dishwashing soap to the nubs on the footboard pan.
4. Push footboard insert firmly into footboard pan so that the insert securely seats on pivot pins and nubs.
5. Repeat previous steps for the other footboard.