



INSTRUCTIONS

94100642

2024-02-07



HEEL/TOE SHIFT LEVER KIT

GENERAL INFORMATION

Table 1. General Information

Kits	Suggested Tools	Skill Level ⁽¹⁾
33600076A	Safety glasses, Torque wrench, Loctite 243 medium (blue)	
(1) Tightening to torque value or other moderate tools and techniques required		

KIT CONTENTS

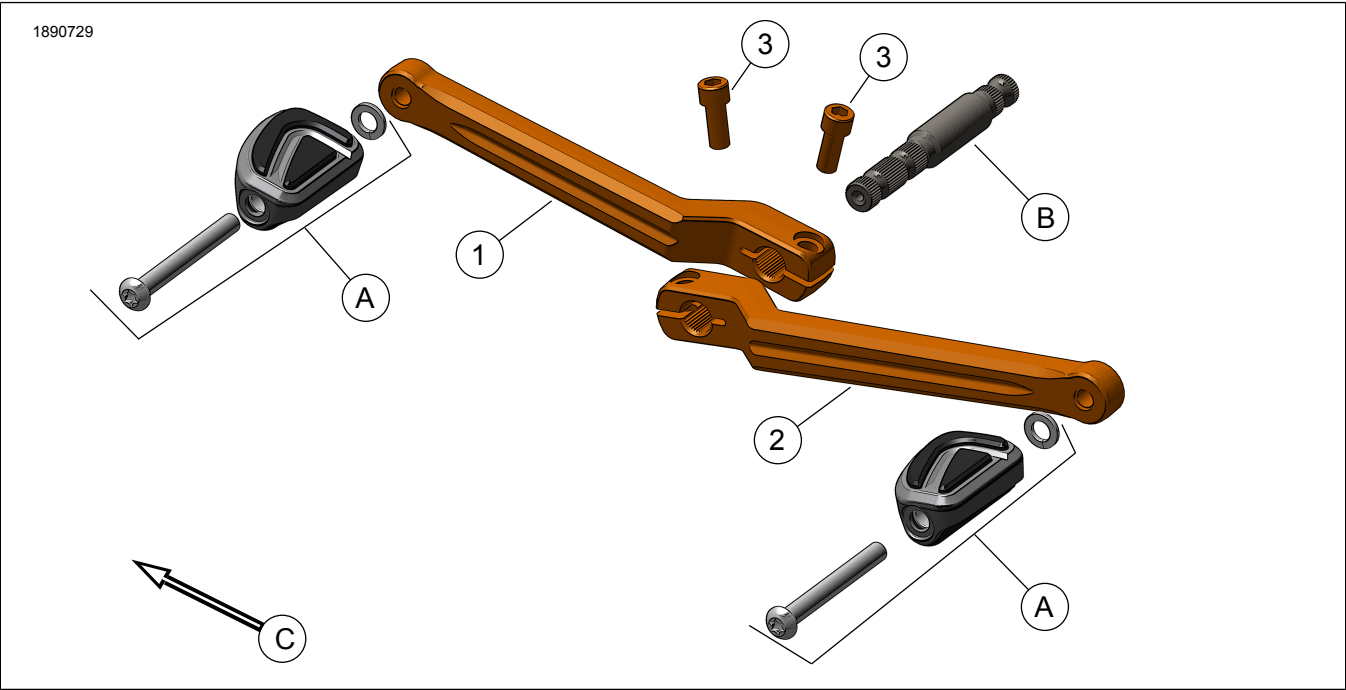

Figure 1. Kit Contents: Heel/Toe Shift Lever Kit

Table 2. Kit Contents: Heel/Toe Shift Lever Kit

Verify that all contents are present in the kit before installing or removing items from vehicle.					
<input checked="" type="checkbox"/>	Item	Qty	Description	Part No.	Notes
<input type="checkbox"/>	1	1	Toe shifter lever (short)	33600060B	
<input type="checkbox"/>	2	1	Heel shift lever (long)	33600061B	
<input type="checkbox"/>	3	2	Hex socket head cap screw	3275	
Items mentioned in text, but not included in kit					
<input checked="" type="checkbox"/>	A	2	Shifter Peg		
<input checked="" type="checkbox"/>	B	1	Shifter Shaft		
<input checked="" type="checkbox"/>	C	1	Front of Vehicle		

GENERAL

Models

For model fitment information, see the Parts and Accessories (P&A) Retail Catalog or the Parts and Accessories section of www.harley-davidson.com.

Verify that the most current version of the instruction sheet is used. It is available at: h-d.com/isheets

Contact Harley-Davidson Customer Support Center at 1-800-258-2464 (U.S. only) or 1-414-343-4056.

Installation Requirements

⚠ WARNING

Rider and passenger safety depend upon the correct installation of this kit. If the procedure is not within your capabilities or you do not have the correct tools, have a Harley-Davidson dealer perform the installation. Improper installation of this kit could result in death or serious injury. (00308b)

REMOVE

NOTE

- *Figure 1 Before removing the original shift levers, note the orientation. You may want to replace them at the same position and angle.*
- *Original Equipment (OE) shift levers are installed from the top or bottom, depending on the model motorcycle.*

1. Remove OE shifter pegs (A). Retain.
2. Remove socket head screws (3).
3. Remove OE shift levers.

INSTALL

NOTE

Figure 1 When toe and heel levers are positioned correctly, the socket head cap screws are installed from the top of both levers.

1. Position toe shifter lever (1), shorter front lever, at desired angle and so the counterbored screw hole is facing up.
2. Slide toe shifter lever onto splined shifter shaft (B).
3. Align screw hole with notch on shaft.
4. Position heel shifter lever (2), longer rear lever, at desired angle and so the counterbored screw hole is facing up.
5. Slide heel shifter lever onto splined shifter shaft (B), aligning screw hole with notch on shaft.
6. Apply threadlocker to socket head screws (3).
Consumable: LOCTITE 243 MEDIUM STRENGTH THREADLOCKER AND SEALANT (BLUE) (99642-97)

NOTE

For proper installation, ensure that the toe and heel shifter are completely installed on shifter shaft and applied torque meets but does not exceed given range.

7. Insert screws into counterbored holes. Tighten.
Torque: 24.4–30 N·m (18–22 ft-lbs)
8. Apply threadlocker onto shifter peg screw threads if using OE pegs.
Consumable: LOCTITE 243 MEDIUM STRENGTH THREADLOCKER AND SEALANT (BLUE) (99642-97)
9. Install shifter pegs onto **new** shift levers.
 - a. If accessory shifter peg, tighten per shifter peg installation requirements.
 - b. If OE shifter peg, tighten.
Torque: 16.3–19 N·m (12–14 ft-lbs)
10. Check for proper operation and clearance.