



INSTRUCTIONS

J00574

2006-06-05



SOFTAIL DEUCE CUSTOM SEAT KITS

GENERAL

Kit Numbers

See Table 1.

Models

These kits fit 2000 and later FXSTD (Softail® Deuce®) models.

Kit Contents

See Figure 1 and Table 2 for complete kit contents.

See Table 1 for the grab strap part number associated with each seat kit.

Table 1. Kit Numbers and Grab Strap Usage

| Kit Number | Grab Strap | Kit Number | Grab Strap |
|------------|------------|------------|------------|
| 51064-02 | 51233-02 | 52366-02* | 51235-02 |
| 51065-02 | 51233-02 | 52367-02* | 51235-02 |
| 51066-02 | 51233-02 | 52368-02* | 51235-02 |
| 51067-02 | 51233-02 | 52550-03 | 51233-02 |
| 51303-07 | 51233-02 | 52582-03 | 51235-02 |
| 51400-04* | 51233-02 | 52944-04 | 51233-02 |
| 51405-04* | 51233-02 | 53288-02 | 51233-02 |
| 51406-05* | 51233-02 | 53289-02* | 51235-02 |
| 51408-04* | 51233-02 | 54020-04 | 51246-04 |
| 51409-04* | 51233-02 | 54021-04 | 51246-04 |
| 51411-04* | 51233-02 | 54022-04 | 51246-04 |
| 51660-05 | 51233-02 | 54023-04 | 51246-04 |
| 51661-05 | 51233-02 | 54024-04 | 51246-04 |
| 52044-06 | 51233-02 | 54025-04 | 51246-04 |
| 52045-06 | 51233-02 | 54062-04 | 51233-02 |
| 52365-02* | 51235-02 | | |

NOTE

Kit numbers with an asterisk (*) do not fit with Backrest Kits 51114-00 or 51144-02. Refer to Instruction Sheet J01539 for details.

⚠ WARNING

Rider and passenger safety depend upon the correct installation of this kit. If the procedure is not within your capabilities or you do not have the correct tools, have a Harley-Davidson dealer perform the installation. Improper installation of this kit could result in death or serious injury. (00308b)

INSTALLATION

NOTE

When performing the following procedures, avoid scratching painted surfaces (fender, tank, etc.) with tools or metal seat tabs.

1. See Figure 1 and Table 2. Unscrew the captive thumbscrew fastening the back of the original equipment (O.E.) seat to the vehicle.
2. Pull the seat slightly to the rear to disengage the tang at the front of the seat from the motorcycle frame.
3. Lift the front of the seat while pulling the seat carefully forward to remove the seat from the vehicle.
4. Remove the O.E. grab strap and attaching hardware. Save the hardware for later use.
5. Install the **new** grab strap (1) to the rear fender (C) using the O.E. screw (A) and washer (B).
6. Slide the rear of the **new** seat (2) through the grab strap.
7. Rest the seat on the frame backbone.
8. Slide the seat toward the front of the motorcycle until the front tang locks into the channel in the frame.
9. Secure the seat to the fender with the knurled knob (3) and neoprene™ washer (4) from the kit.

NOTE

Ambient temperature should be **at least** 60° F (16° C) for proper adhesion of the emblem to the knob.

⚠ WARNING

After installing seat, pull upward on seat to be sure it is locked in position. While riding, a loose seat can shift causing loss of control, which could result in death or serious injury. (00070b)

10. Remove the liner from the adhesive backing of the Bar & Shield emblem (5). Rotate the emblem for best appearance, and apply the emblem to the center recess on the knurled knob. Apply even pressure to the emblem for one minute to ensure proper adhesion.



SERVICE PARTS

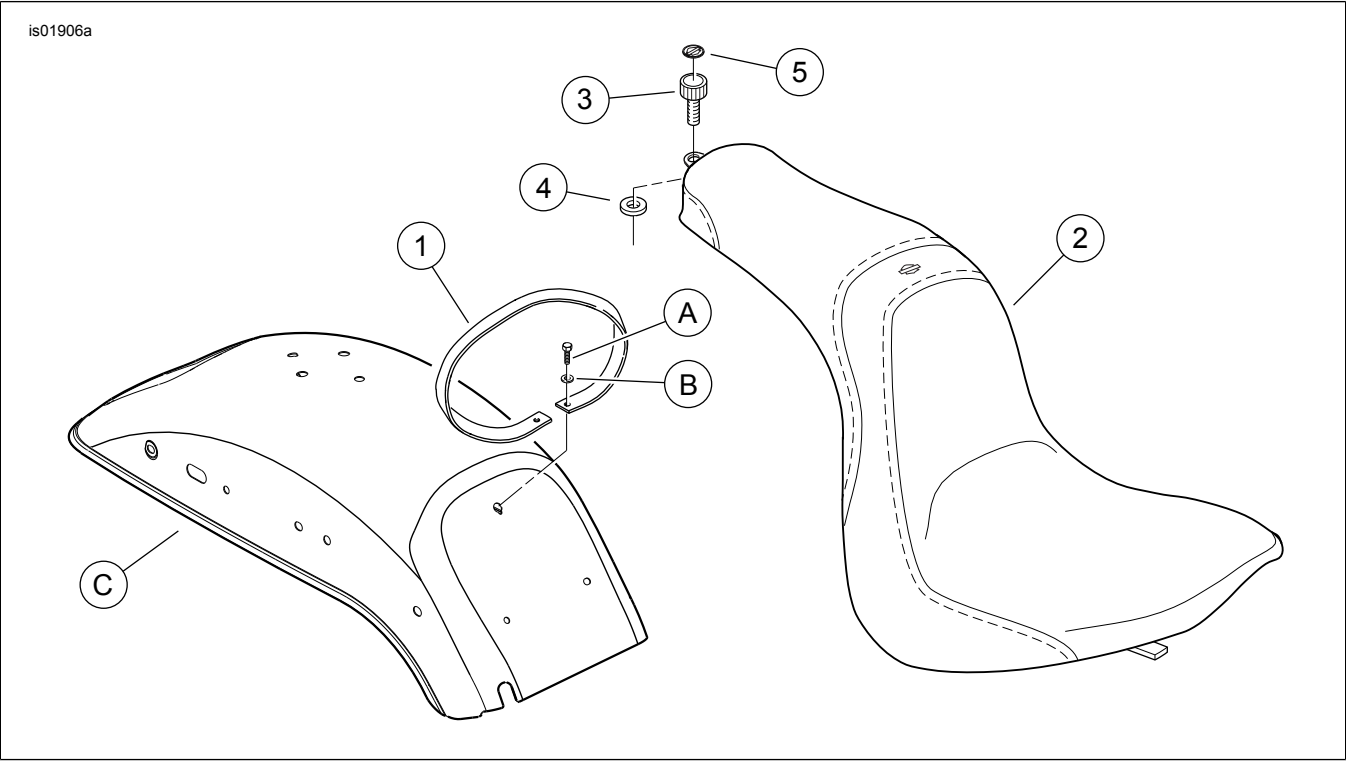

Figure 1. Service Parts: Softail Deuce Custom Seats

Table 2. Service Parts Table

| Item | Description (Quantity) | Part Number |
|---|---|---------------------|
| 1 | Grab strap | See Table 1 |
| 2 | Seat (plain pattern shown) | Not sold separately |
| 3 | Knurled knob, 1/4-20 | 3649 |
| 4 | Washer, neoprene™ | 6205 |
| 5 | Emblem, Bar & Shield | 14628-96 |
| 6 | Leather dressing | Not sold separately |
| Items mentioned in text, but not included in kit: | | |
| A | Original equipment grab strap attaching screw | |
| B | Original equipment flat washer | |
| C | Rear fender | |