



INSTRUCTIONS

94100155

2024-12-16



SADDLEBAG SPEAKER HARNESS INSTALL KIT (PN 76000979)

GENERAL

NOTE

The newly installed audio system and speakers will not play audio unless it is configured using the Harley-Davidson audio app or by an authorized Harley-Davidson dealership.

Table 1.

Harley-Davidson Audio Powered by Rockford Fosgate®	
Kit	QR Code
76000979	N/A

NOTE

The various generations of speakers, amplifiers and wiring for Harley-Davidson vehicles were not designed or tested to work together. Please consult your dealership to ensure optimal performance and compatibility.

Models

For model fitment information, see the P&A retail catalog or the Parts and Accessories section of www.harley-davidson.com (English only).

Ensure you are using the most current version of the instruction sheet which is available at: h-d.com/isheets

Contact Harley-Davidson Customer Support Center at 1-800-258-2464 (U.S. only) or 1-414-343-4056.

Installation Requirements

Download Harley-Davidson audio app.

Use this kit in conjunction with other **Harley-Davidson Audio powered by Rockford Fosgate®** kits.

This harness is for use **ONLY** on **2014 and later** Harley-Davidson audio systems.

These items are available at your Harley-Davidson dealership.

- **2014 and Later FLHTKSE, FLTRUSE and Touring:** Separate purchase of Harley-Davidson Primary Amplifier and Dongle Kit (Part No. 76000997) is required for this installation.
- **2014 and Later FLHTKSE, FLTRUSE and Touring:** Separate purchase of Harley-Davidson Primary Amplifier Installation Kit (Part No. 76000974 or 76001045) is required for this installation.
- **2014 and Later FLHTKSE, FLTRUSE and Touring:** Separate purchase of Harley-Davidson Secondary Amplifier Kit (Part No. 76000975) may be required for this installation. This depends if there are six speakers or more and how the amplifier channels are assigned.

- **2014 and Later FLHTKSE, FLTRUSE and Touring:** Separate purchase of Harley-Davidson Stage 1 or 2 Speaker Kit (Part No. 76000986 or 76000987) may be required for this installation.

⚠ WARNING

Rider and passenger safety depend upon the correct installation of this kit. Use the appropriate service manual procedures. If the procedure is not within your capabilities or you do not have the correct tools, have a Harley-Davidson dealer perform the installation. Improper installation of this kit could result in death or serious injury. (00333b)

Installation by a technician at a Harley-Davidson dealership is recommended.

Kit Contents

See Figure 15 and Table 2.

PREPARE

⚠ WARNING

To prevent accidental vehicle start-up, which could cause death or serious injury, remove main fuse before proceeding. (00251b)

NOTE

This instruction sheet references service manual information. A service manual for this year/model motorcycle is required for this installation. One is available from a Harley-Davidson dealer.

1. Remove left and right saddlebags (excludes Tri-Glide).
2. Remove left and right side covers.
3. Remove main fuse.

NOTE

Models with security: Disable security system.

4. Remove seat.

RIGHT SADDLEBAG

NOTE

Drilling may vary by the number of speakers and amplifiers that are being installed. **DO NOT** drill any holes until the exact speaker installation is understood.

If only a primary amplifier is present in the left saddlebag, then drill only one 3/4-inch opening as defined in **Harness Install Without Secondary Amplifier**.

If a secondary amplifier is present, then proceed to **Harness Install With Secondary Amplifier** and drill 2 holes using a hole saw.

Openings may already be present in the right saddlebag if a secondary amplifier was installed prior to this installation. In that case the template will not be used.

1. Figure 1 Position template (2) on right saddlebag (1).
 - a. Use tape to secure template.

2. **NOTE**
Take extreme caution not to damage the painted surface.

Modify right saddlebag.

- a. Center punch drill locations.
- b. **Grommet hole:** If only a primary amplifier is present and used, then use 19mm (3/4-in) drill bit.
- c. **Internal harness hole: ONLY, if a secondary amplifier is present and used, then use 63.5 mm (2 1/2-in) hole saw.**
- d. De-burr hole by lightly sanding the surface.

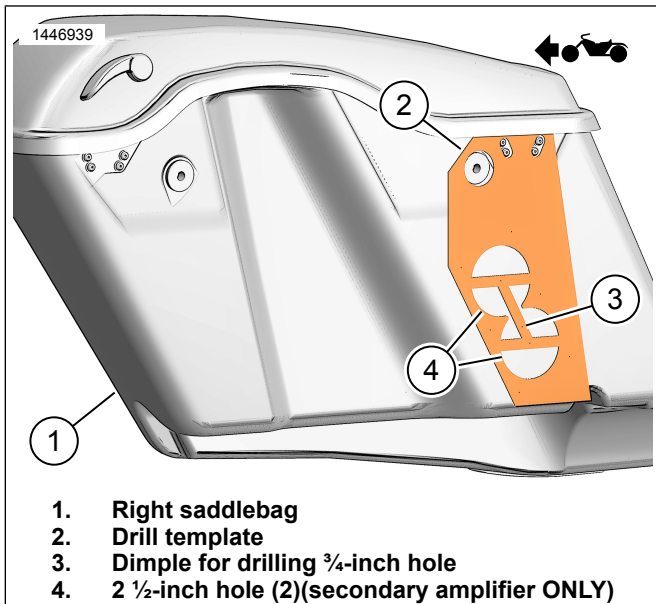

Figure 1. Right Saddlebag Template

HARNESS INSTALL WITHOUT SECONDARY AMPLIFIER

NOTE

Remove amplifier cover from left saddlebag to access speaker connector under amplifier near the amplifier connector. The amplifier may be removed from the bracket for easier access.

1. **NOTE**
Amplifier may have to be removed from mounting bracket.

Connect speaker wire harness to amplifier in left saddlebag.

- a. Figure 2 Locate wire harness 69202532 (2).
 - b. Figure 3 Disconnect speaker connector (1) from internal harness connector (2).
 - c. Connect wire harness connector (2) to speaker connector (1).
2. Figure 4 Install left speaker wire harness.
 - a. Route wire harness (1) as shown.
 - b. Peel adhesive tape on harness wire conduit.
 - c. Adhere harness wire conduit as shown.
 3. Figure 5 Install right speaker wire harness.
 - a. Figure 2 Locate wire harness 69202533 (3).
 - b. Route wire harness (2) as shown.
 - c. Start with top harness wire conduit and work your way toward the grommet that passes through the saddlebag.

NOTE

Check harness placement **BEFORE** peeling tape backers and applying conduit to saddlebag. Harness length will be **EXTREMELY** difficult to adjust once multiple conduit pieces have been adhered in place.

- d. Peel adhesive tape on harness wire conduit.
 - e. Adhere harness wire conduit as shown.
 - f. Route wire harness (2) through grommet hole.
 - g. Install grommet (3) on wire harness (2).
 - h. Adjust grommet (3) as needed and install in saddlebag.
4. Figure 2 Locate wire harness 69202531 (4).
 - a. Connect 4-way of 69202531 (4) to primary amplifier harness connector [351A] under right side cover.
 5. Figure 5 Connect harnesses (1 and 2.)
 6. Secure harnesses with cable straps.
 - a. Make sure there is sufficient wire length to so saddlebag can be removed and that the wire harness does not prevent any dynamic movement and has adequate clearance to all moving parts of vehicle.

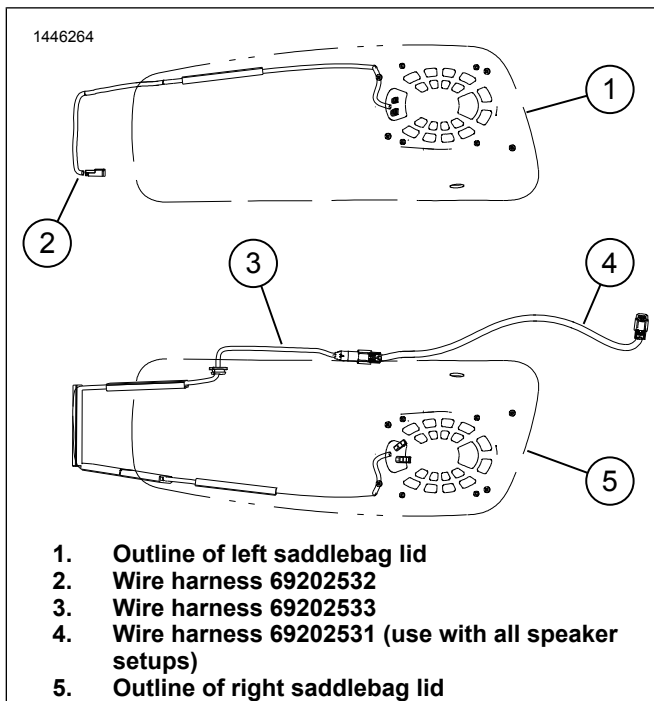

Figure 2. Wire Harness Setup and Routing

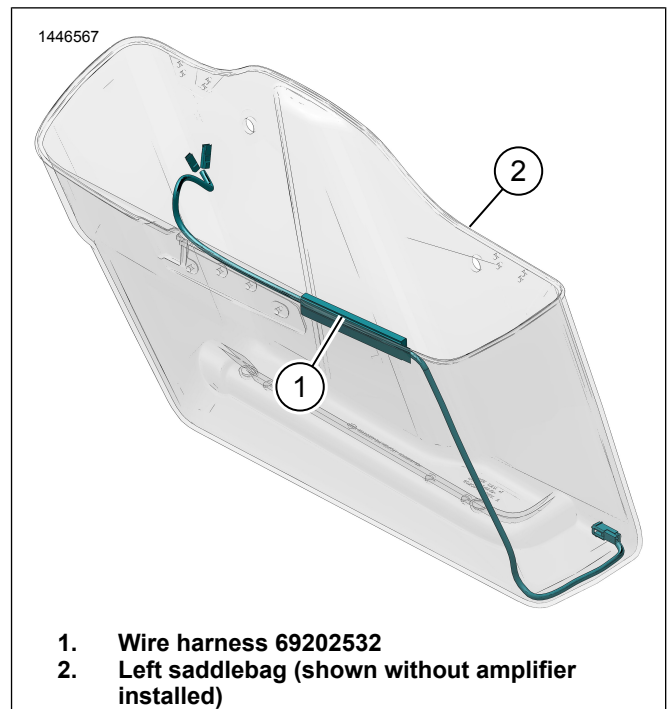

Figure 4. Left Saddlebag Harness Routing

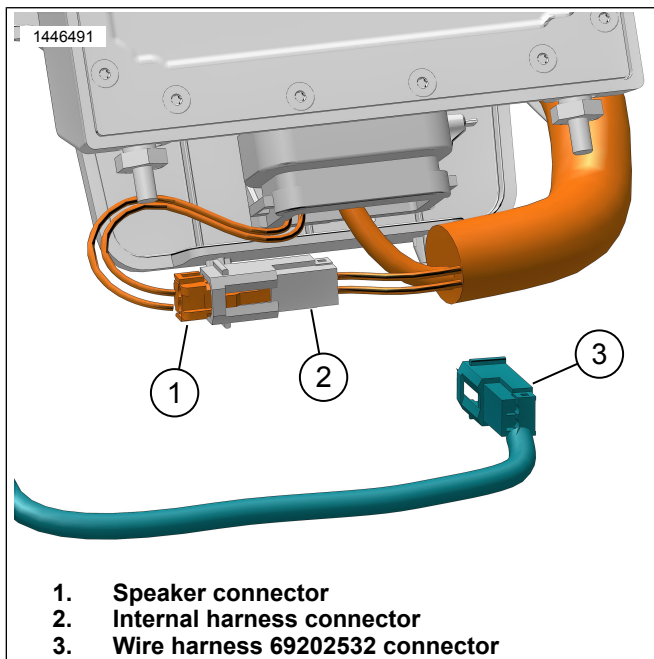

Figure 3. Left Saddlebag Speaker Connection

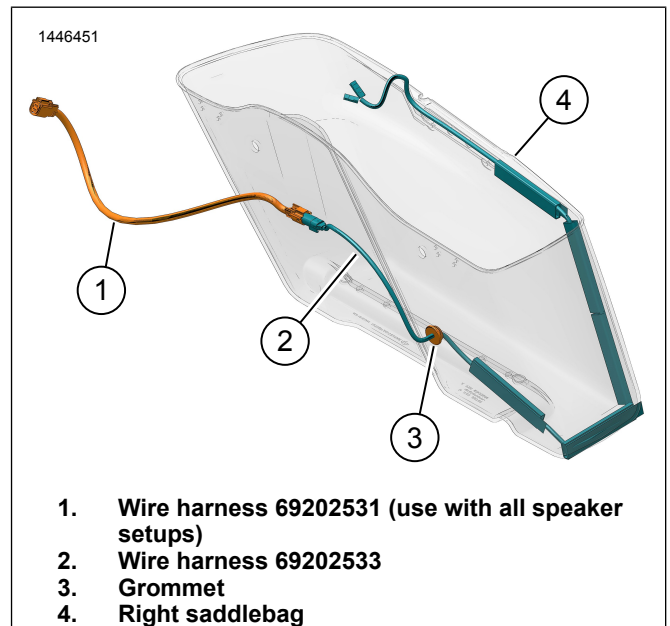

Figure 5. Right Saddlebag Harness Routing (Without Amplifier)

HARNESS INSTALL WITH SECONDARY AMPLIFIER

NOTE

If Tour-Pak speakers or fairing lower speakers were connected to the primary amplifier prior to this installation, they must be disconnected from the primary amplifier harness at [351]. They will be re-connected to the secondary amplifier harness at [352A_2] and [352A_2].

Remove amplifier cover from left saddlebag to access speaker connector under amplifier near the amplifier connector. The amplifier may be removed from the bracket for easier access.

NOTE

If the secondary amplifier has not yet been installed, see instructions in that kit to drill 2 ½-inch holes in the right saddlebag with a hole saw. Figure 1

1. Connect speaker wire harness to amplifier in left saddlebag.
 - a. Figure 6 Locate wire harness 69202532 (2).
 - b. Figure 3 Disconnect speaker connector (1) from internal harness connector (2).
 - c. Connect wire harness connector (2) to speaker connector (1).
2. Figure 8 Install left speaker wire harness.
 - a. Route wire harness (1) as shown.
 - b. Peel adhesive tape on harness wire conduit.
 - c. Adhere harness wire conduit as shown.
 - d. Reinstall amplifier and cover (if removed) in left saddlebag.
Torque: 13.5 N·m (119 in-lbs)
3. Connect speaker wire harness to amplifier in right saddlebag.
 - a. Figure 6 Locate wire harness 69202532 (3).
 - b. Figure 7 Connect wire harness connector (2) to speaker connector (1).
4. Figure 9 Install right speaker wire harness.
 - a. Route wire harness (3) as shown.
 - b. Peel adhesive tape on harness wire conduit.
 - c. Adhere harness wire conduit as shown.
5. Figure 6 Locate wire harnesses 69202563 (4) and 69202531 (5).
6. Figure 9 Connect harnesses 69202531 (1) and 69202563 (2) together.
 - a. Connect 4-way end of 69202531 (1) to primary amplifier harness connector [351A] under right side cover.
7. Connect harness 69202563 (2) to saddlebag.
8. Secure harnesses with cable straps.
9. Install amplifiers and covers, if removed.
 - a. Tighten cover screws.
Torque: 13.5 N·m (119 in-lbs) *Amplifier cover screw*

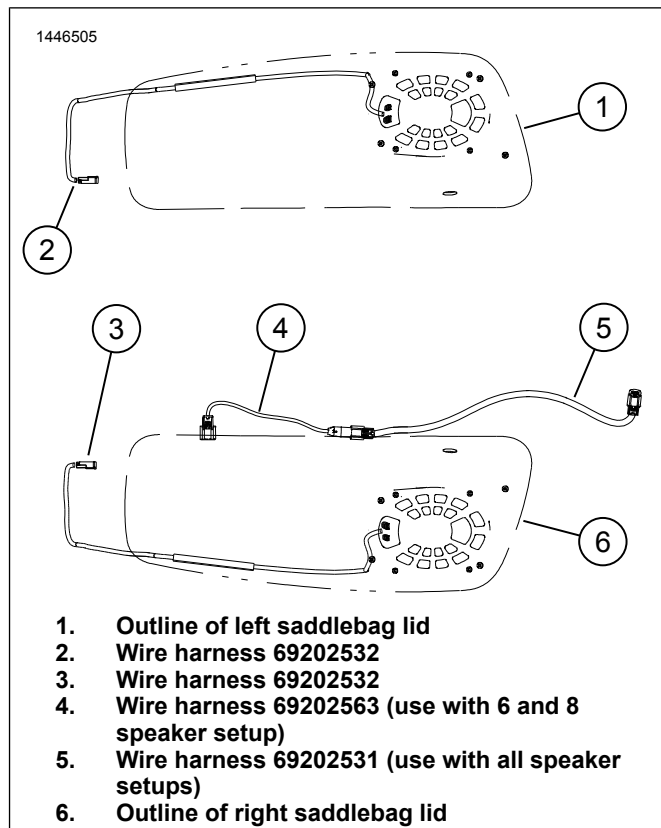

Figure 6. Wire Harness Setup and Routing

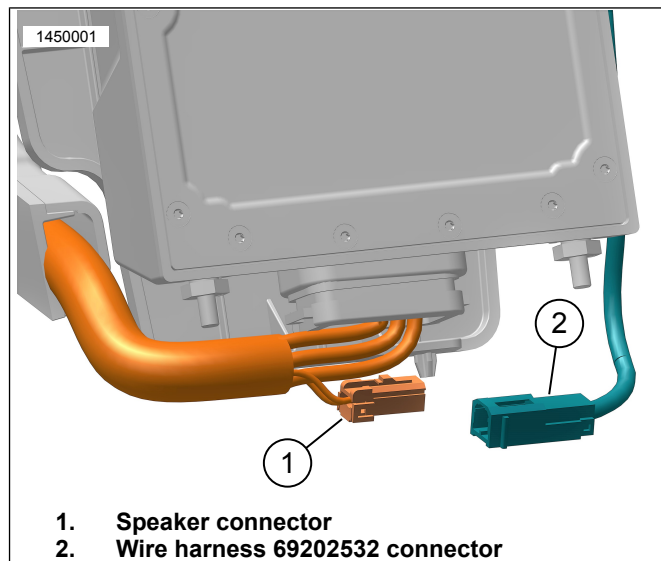
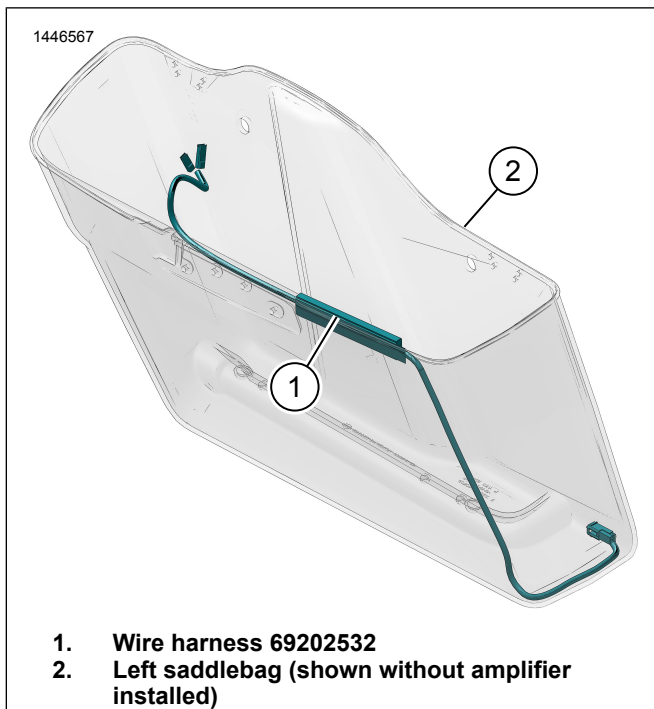
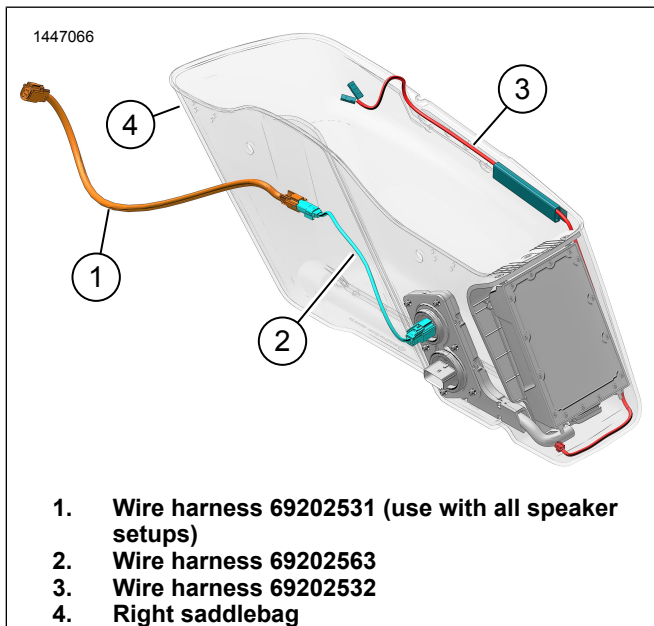

Figure 7. Left Saddlebag Speaker Connection, Right is Similar



1. Wire harness 69202532
2. Left saddlebag (shown without amplifier installed)

Figure 8. Left Saddlebag Harness Routing



1. Wire harness 69202531 (use with all speaker setups)
2. Wire harness 69202563
3. Wire harness 69202532
4. Right saddlebag

Figure 9. Right Saddlebag Harness Routing (With Amplifier)

SPEAKER HARDWARE

1. Figure 15 Use speaker hardware screws and grommets (8, 9, 10) to install speakers.
2. See speaker kit for instructions and torque values.

COMPLETE

NOTE

To prevent possible damage to the sound system, verify that the ignition is OFF before installing the main fuse.

1. Install main fuse.

2. NOTE

Before installing outer fairing, check that speakers are operating correctly. Understand that buzzing, squeaks and rattles may be heard until outer fairing is installed.

Turn ignition ON, but do not start the vehicle.

3. Make sure that all speakers are working and front/rear fader function is operating correctly. If not, check speaker wiring.
4. Install seat.
5. Install left and right side covers.
6. Install left and right saddlebags (excludes Tri-Glide).

APP SETUP

1. Figure 10 Accessing your audio system.
 - a. Pair device (1) to system.
 - b. Access app menus (2) to setup vehicle sound system.

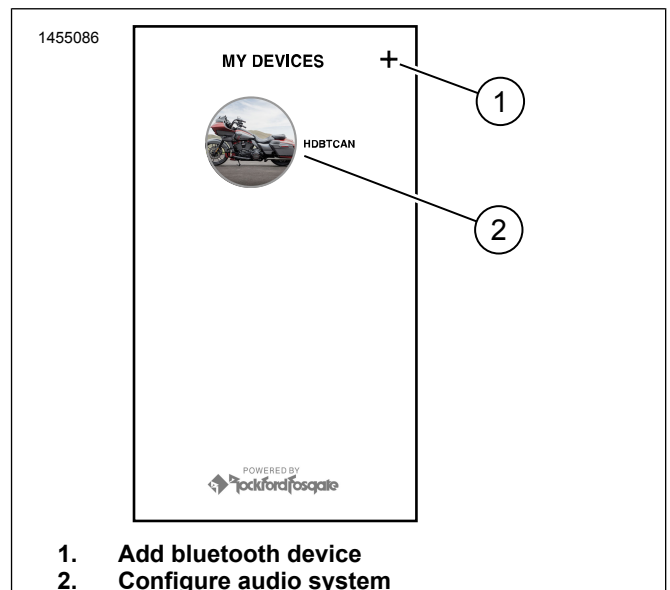

1. Add bluetooth device
2. Configure audio system

Figure 10. System Access

2. Figure 11 Main menu screen.
 - a. Main menu icon (1).
 - b. Reset or change security personal identification number (PIN) (2).
 - c. Edit and rename your system (3).
 - d. Customize main menu with your bike picture (4).
 - e. Bluetooth connection indicator. Slash through symbol indicates: Not Connected (5).

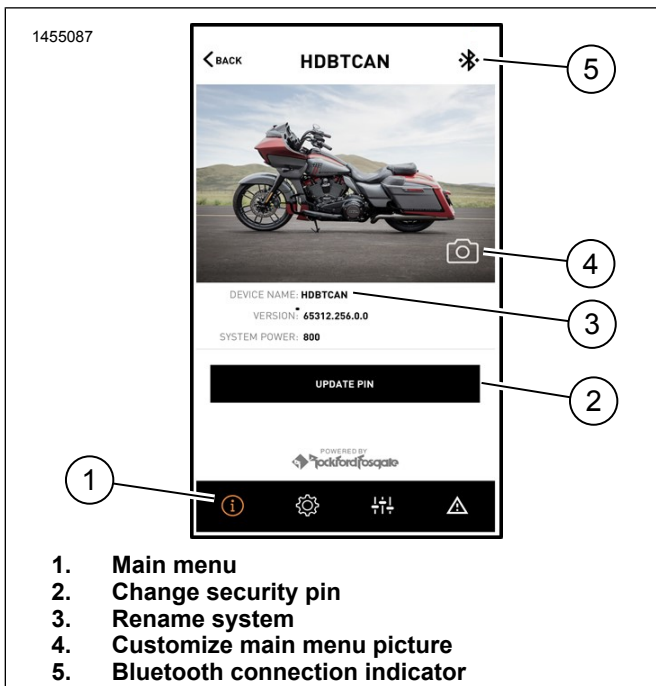

Figure 11. Main Menu

3. Figure 12 Setup menu screen.

- Setup menu icon (1).
- Use to scan QR code (2) on iSheet.
- Manual setup for Stage 1 or 2 speakers, speaker location and white noise to assign speaker locations.

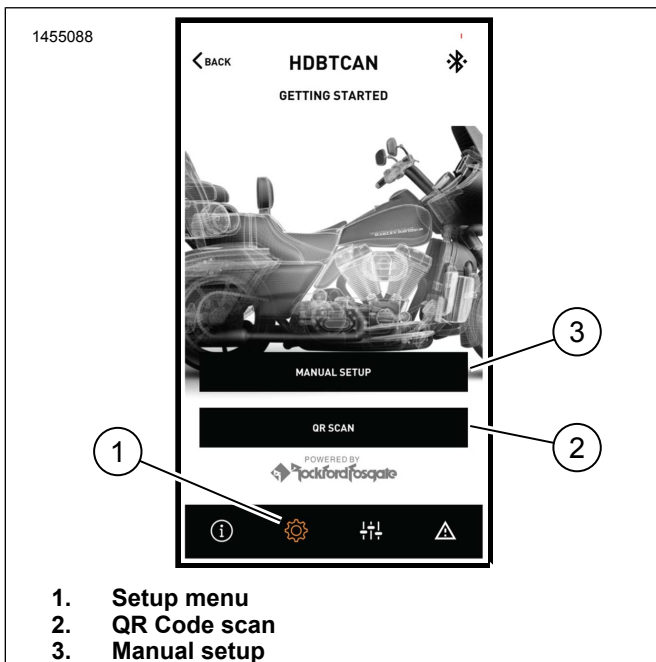

Figure 12. Setup Menu

4. Figure 13 Equalizer setup screen.

- Equalizer setup icon (1)
- Tune 7-Band equalizer (2) frequencies.
- Custom or preset equalizer selections (3).

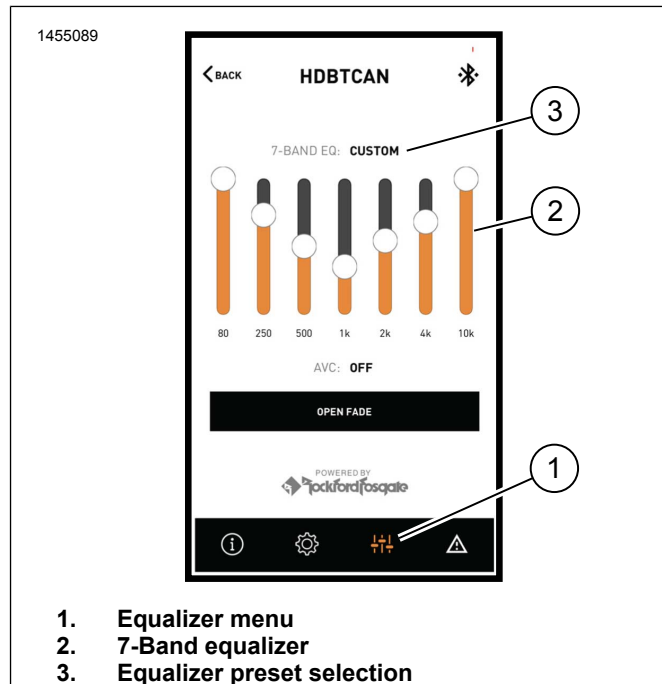

Figure 13. Equalizer Menu

5. Figure 14 Diagnostic menu screen.

- Diagnostic menu icon (1) displays sound system status.
- Open the speaker testing screen (2).
- Refreshes speaker and amplifier status (3) after component repair.
- Select speaker for white noise (4) test and functionality.
- Return to diagnostic menu screen (5).

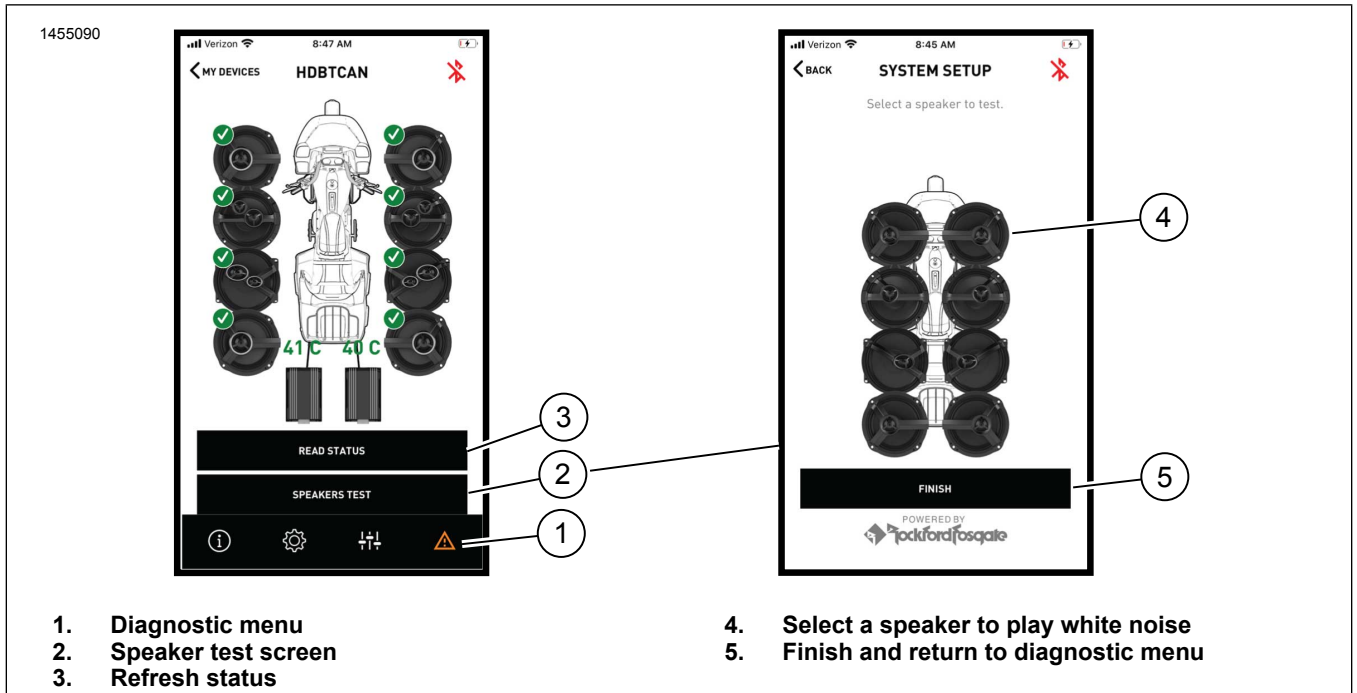

Figure 14. Diagnostic Menu

SERVICE PARTS

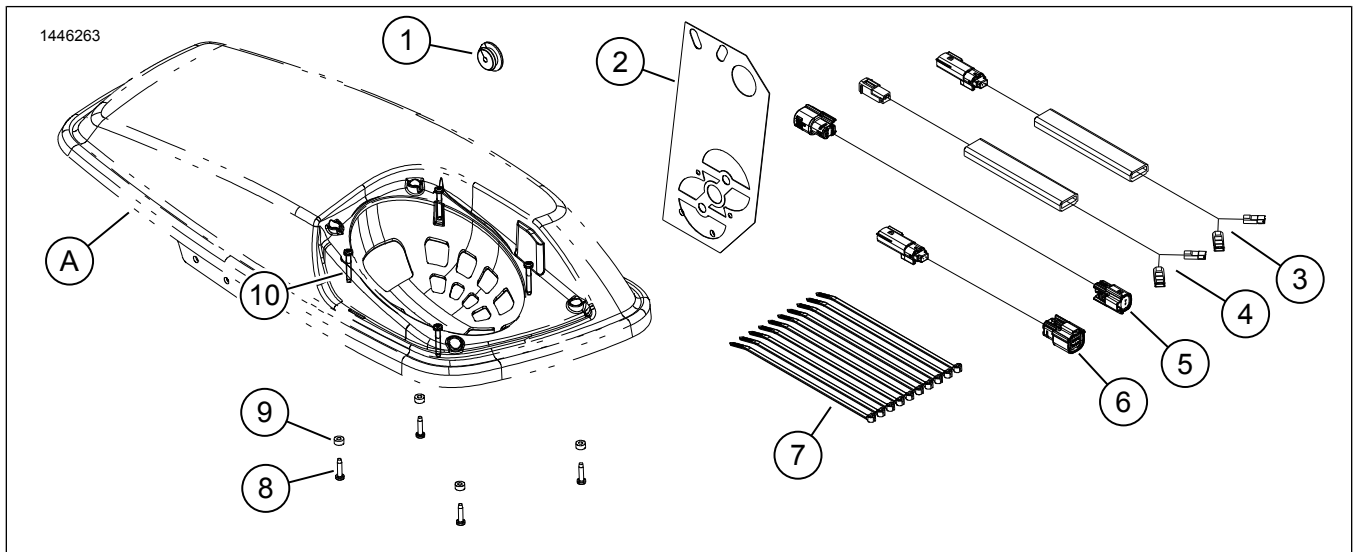

Figure 15. Service Parts, Fairing Lower Speakers

Table 2. Service Parts

Item	Description (Quantity)	Part Number
1	Grommet	12100167
2	Drill template	Not sold separately
3	Internal speaker wire harness, right saddlebag (use with 4 speaker system only)	Not sold separately
4	Internal speaker wire harness, left saddlebag (2)	Not sold separately
5	Jumper wire harness, long (use with all speaker setup)	Not sold separately
6	Jumper wire harness, short (use with 6 and 8 speaker setup)	Not sold separately
7	Cable strap (10)	10006
8	Screw, short (8)	10200351
9	Washer, rubber (8)	10300066
10	Screw, long (8)	10200095
Items mentioned in the instruction but not included in kit.		
A	Saddlebag lid	