



# INSTRUCTIONS

J05760

2024-12-20



## QUICK-RELEASE SISSY BAR UPRIGHT KIT

### GENERAL INFORMATION

Table 1. General Information

Kits	Suggested Tools	Skill Level <sup>(1)</sup>
52300324A, 52300415	Safety Glasses, Torque Wrench	
<i>(1) Tightening to torque value or other moderate tools and techniques required</i>		

### KIT CONTENTS

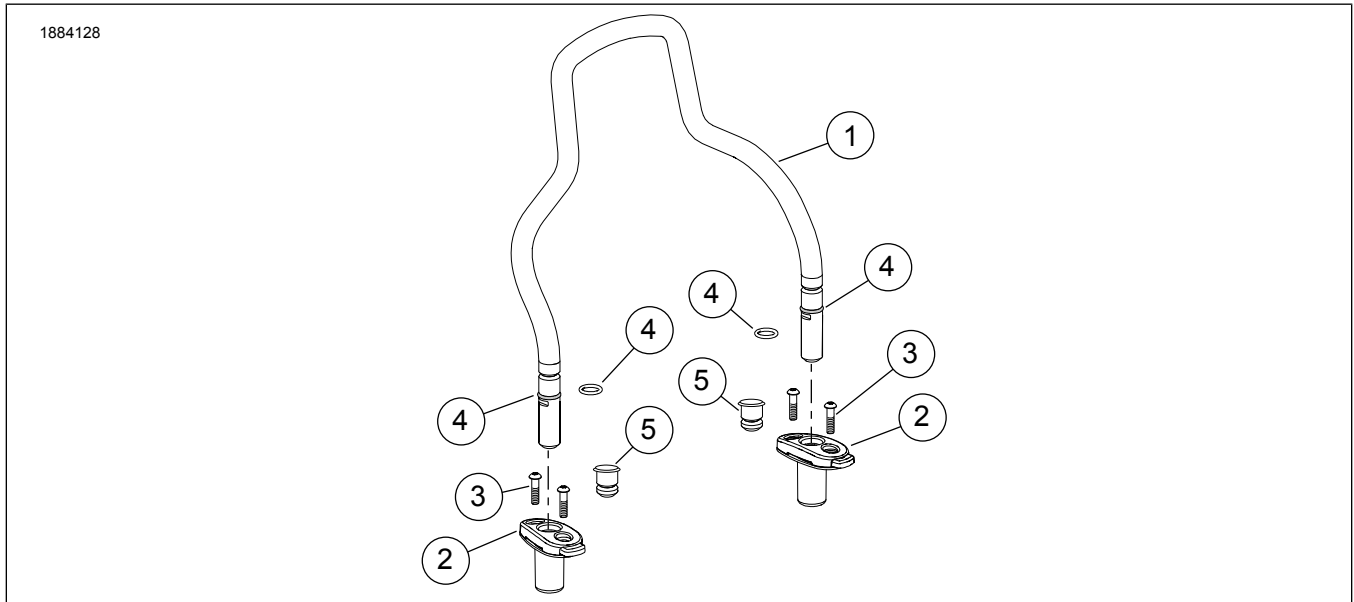

Figure 1. Kit Contents: Quick-Release Sissy Bar Upright Kit

Table 2. Kit Contents: Quick-Release Sissy Bar Upright Kit

<input checked="" type="checkbox"/>	Verify that all contents are present in the kit before installing or removing items from vehicle.				
Item	Qty	Description	Part No.	Notes	
<input type="checkbox"/>	1	Upright, backrest, chrome	Not sold separately		
<input type="checkbox"/>	1	Upright, backrest, black	Not sold separately		
<input type="checkbox"/>	2	Backrest dock assembly, chrome	52300326A		
<input type="checkbox"/>	2	Backrest dock assembly, black	52300419		
<input type="checkbox"/>	3	Screw	94595-98		
<input type="checkbox"/>	4	O-ring service kit	Not sold separately	Includes small and large diameter O-rings	
<input type="checkbox"/>	5	Plug, chrome	12100080		
<input type="checkbox"/>	2	Plug, black	12100098		

### GENERAL

#### NOTE

This instruction sheet **may have a Supplemental Video** to assist installer in clarifying a certain part of the assembly. A linked video would be located at the end of this instruction sheet.

### Models

For model fitment information, see the Parts and Accessories (P&A) Retail Catalog or the Parts and Accessories section of [www.harley-davidson.com](http://www.harley-davidson.com).

Verify that the most current version of the instruction sheet is used. It is available at: [h-d.com/isheets](http://h-d.com/isheets)

Contact Harley-Davidson Customer Support Center at 1-800-258-2464 (U.S. only) or 1-414-343-4056.

## Installation Requirements

### ⚠ WARNING

Rider and passenger safety depend upon the correct installation of this kit. If the procedure is not within your capabilities or you do not have the correct tools, have a Harley-Davidson dealer perform the installation. Improper installation of this kit could result in death or serious injury. (00308b)

This item is available from a Harley-Davidson dealer.

- Electrical Contact Lube (Part No. 11300004) or equivalent, is required for proper installation of this kit.

## REMOVE

1. Figure 2 Remove trim covers (2) from body (1).
  - a. To prevent damage to paint, use plastic prying tool or equivalent.

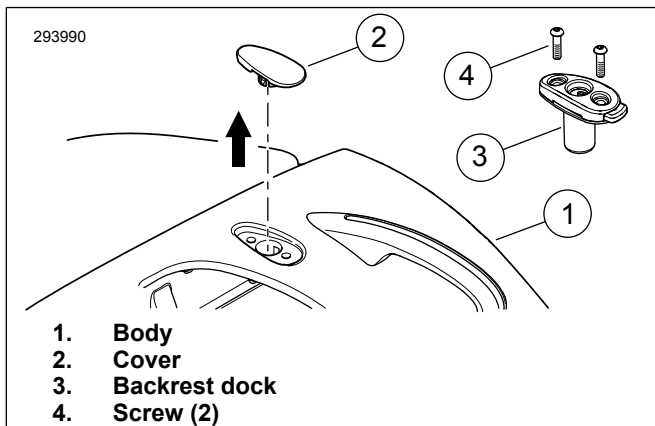

Figure 2. Trim Cover

## INSTALL

1. Figure 2 Install backrest docks (3) to body (1).
2. Install two screws (4) for each dock. Tighten.  
Torque: 13.6 N·m (120 in-lbs)
3. Figure 3 Align and install upright.
  - a. Press release button (1) on backrest dock while inserting one leg of upright.
  - b. Press release button (1) on other backrest dock while inserting opposite leg of upright.
4. While holding both legs of upright, firmly press upright further into backrest docks.
  - a. Release buttons must return to original, extended position to complete installation.

5. Figure 1 If fit of upright in docks is not snug, remove installed O-rings and replace with larger diameter O-rings. Repeat steps 3 and 4.
  - a. A small amount of electrical contact lube can be applied to surface of each O-ring to aid in installation.

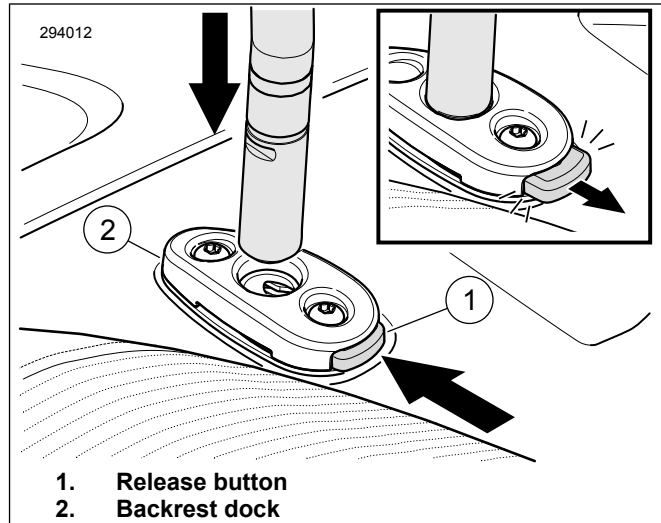

Figure 3. Release Button Locked Position

## PLUG

### NOTE

Plugs do not require or use O-rings.

1. Figure 1 When upright (1) is removed, install plugs (5).
2. Follow steps 3-5 for installing or removing upright. **INSTALL**