



INSTRUCTIONS

94100161

2025-01-06



STAGE I & II SPEAKER KIT - TWIN COOLED FAIRING LOWER (PN 76000988 AND 76000989)

GENERAL



These speakers are designed to fit in the fairing lowers of the Twin-Cooled™ models (except Tri-Glide).

NOTE

The QR code can only be scanned in the Harley-Davidson audio app.

The newly installed audio system and speakers will not play audio unless it is configured using the Harley-Davidson audio app or by an authorized Harley-Davidson dealership.

Table 1.

Harley-Davidson Audio Powered by Rockford Fosgate®	
Kit	QR Code
76000988 (Stage I)	
76000989 (Stage II)	

NOTE

The various generations of speakers, amplifiers and wiring for Harley-Davidson vehicles were not designed or tested to work together. Please consult your dealership to ensure optimal performance and compatibility.

The Harley-Davidson Audio Powered by Rockford Fosgate speakers are acoustically optimized to work together with speakers of the same stage level (I or II). The speaker's output signals are assigned by the APP including location and stage level. If speaker output assignments, stage numbers and locations, are incorrectly configured, damage will not occur, but diminished performance should be expected.

Models

NOTE

These speakers are for use ONLY on 2014 and later Harley-Davidson audio systems. Using these speakers on

2006-2013 Harley-Davidson audio systems **WILL permanently damage these speakers.** Using these speakers on 2005 or earlier Harley-Davidson audio systems **WILL permanently damage those systems.**

For model fitment information, see the P&A retail catalog or the Parts and Accessories section of www.harley-davidson.com (English only).

Ensure you are using the most current version of the instruction sheet which is available at: h-d.com/isheets

Contact Harley-Davidson Customer Support Center at 1-800-258-2464 (U.S. only) or 1-414-343-4056.

Installation Requirements

Download Harley-Davidson audio app.

These items are available at your Harley-Davidson dealership.

- **2014 and Later FLTRUSE and Touring:** Separate purchase of Harley-Davidson Primary Amplifier and Dongle Kit (Part No. 76000997) is required for this installation.
- **2014 and Later FLTRUSE and Touring:** Separate purchase of Harley-Davidson Primary Amplifier Installation Kit (Part No. 76000974 or 76001045) is required for this installation.
- **2014 and Later FLTRUSE and Touring:** Separate purchase of Harley-Davidson Secondary Amplifier Installation Kit (Part No. 76000975) may be required for this installation. This depends if there are six or more speakers and how the amplifier channels are assigned.
- **2014 and Later FLTRUSE and Touring:** Separate purchase of Harley-Davidson Twin-Cooled Fairing Lower Speaker Harness Install Kit (Part No. 76000991) is required for this installation.

▲ WARNING

Rider and passenger safety depend upon the correct installation of this kit. Use the appropriate service manual procedures. If the procedure is not within your capabilities or you do not have the correct tools, have a Harley-Davidson dealer perform the installation. Improper installation of this kit could result in death or serious injury. (00333b)

Installation by a technician at a Harley-Davidson dealership is recommended.

Kit Contents

See Figure 9 and Table 2

PREPARE

⚠ WARNING

To prevent accidental vehicle start-up, which could cause death or serious injury, remove main fuse before proceeding. (00251b)

NOTE

This instruction sheet references service manual information. A service manual for this year/model motorcycle is required for this installation. One is available from a Harley-Davidson dealer.

1. Remove left saddlebag.
2. Remove left side cover.

3. NOTE

Models with security: Disable security system.

Remove main fuse.

REMOVE

1. Figure 1 Remove and discard fairing lower enclosure covers (1, 2).

- a. Enclosure is held in place by three clips.

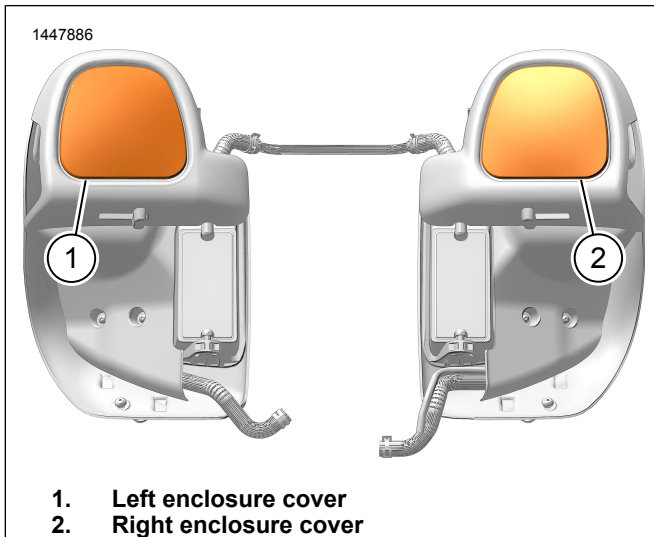

Figure 1. Fairing Lower Enclosure Cover

INSTALL

NOTE

Figure 9 The **new** speaker grilles are side-specific. The Bar and Shield logos are oriented toward the inboard.

- Verify proper orientation of the Bar & Shield emblem before proceeding.

1. Figure 9 Install speaker enclosure assembly (2, 7 or 3, 6).
 - a. Figure 3 Orient speaker enclosure assembly.
 - b. Figure 2 Connect speaker terminals (2).

NOTE

Different size spade contacts prevent improper assembly.

- c. Install speaker enclosure assembly (1).
2. Repeat procedure for opposite side.

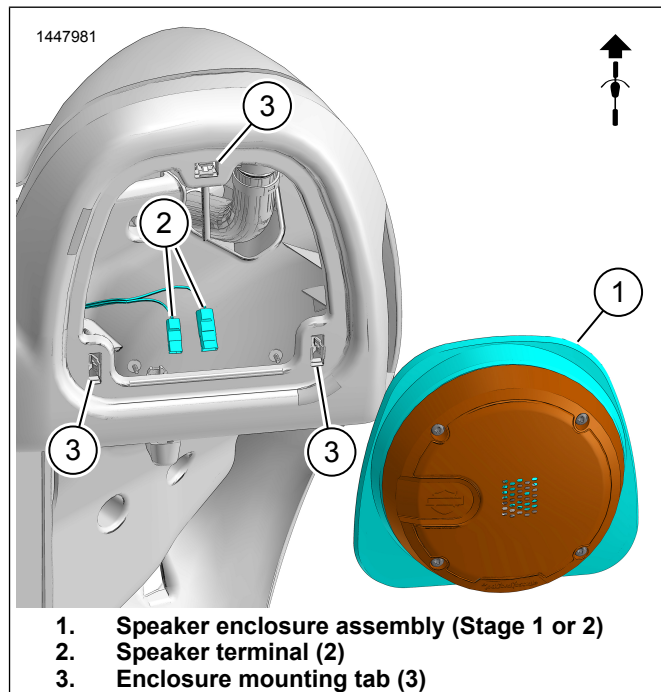

Figure 2. Fairing Lower Speaker Install

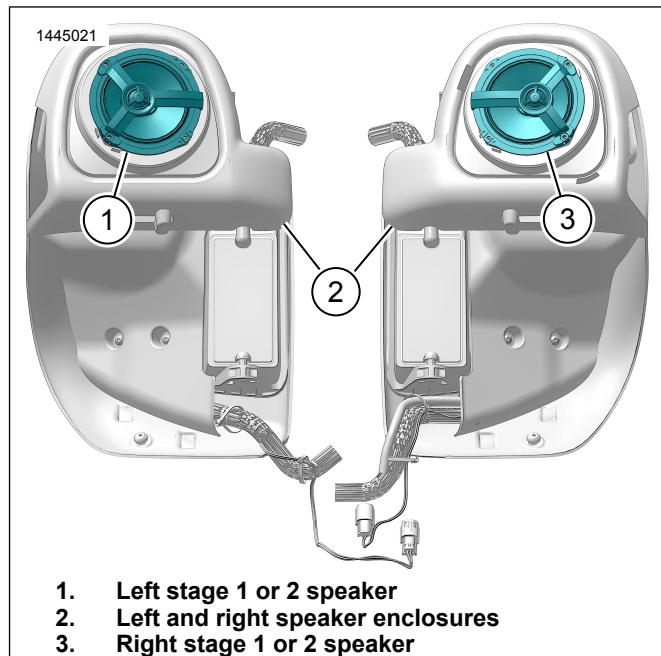

Figure 3. Twin Cooled Speaker Orientation

COMPLETE

NOTE

To prevent possible damage to the sound system, verify that the ignition is OFF before installing the main fuse.

1. Install main fuse.
2. Turn the ignition ON, but do not start the motorcycle.
3. Make sure that all speakers are working and front/rear fader function is operating correctly. If not, check speaker wiring.
4. Install left side cover.
5. Install left saddlebag.

APP SETUP

1. Figure 4 Accessing your audio system.
 - a. Pair device (1) to system.
 - b. Access app menus (2) to setup vehicle sound system.

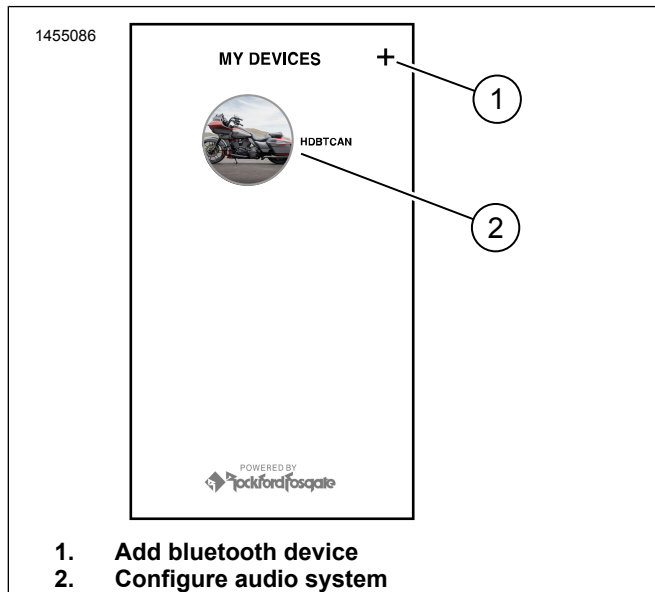
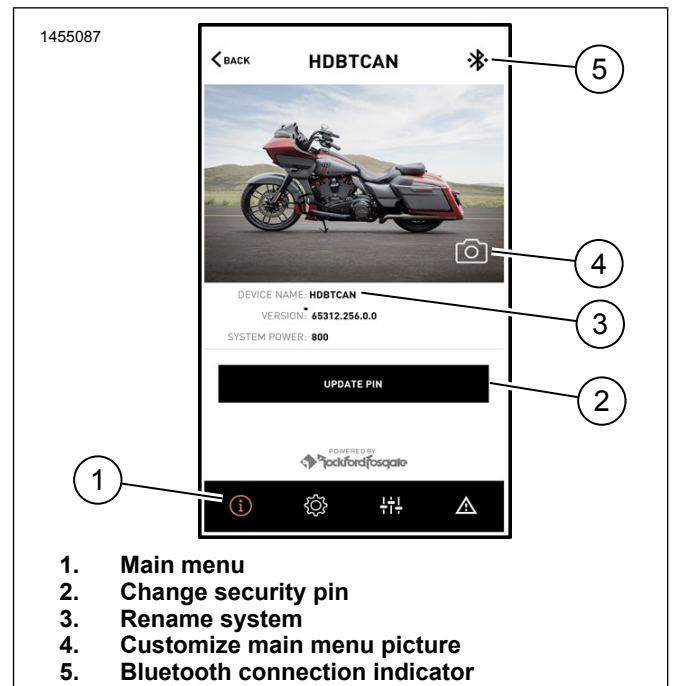

Figure 4. System Access

2. Figure 5 Main menu screen.
 - a. Main menu icon (1).
 - b. Reset or change security personal identification number (PIN) (2).
 - c. Edit and rename your system (3).
 - d. Customize main menu with your bike picture (4).
 - e. Bluetooth connection indicator. Slash through symbol indicates: Not Connected (5).



1. **Main menu**
2. **Change security pin**
3. **Rename system**
4. **Customize main menu picture**
5. **Bluetooth connection indicator**

Figure 5. Main Menu

3. Figure 6 Setup menu screen.
 - a. Setup menu icon (1).
 - b. Use to scan QR code (2) on iSheet.
 - c. Manual setup for Stage 1 or 2 speakers, speaker location and white noise to assign speaker locations.

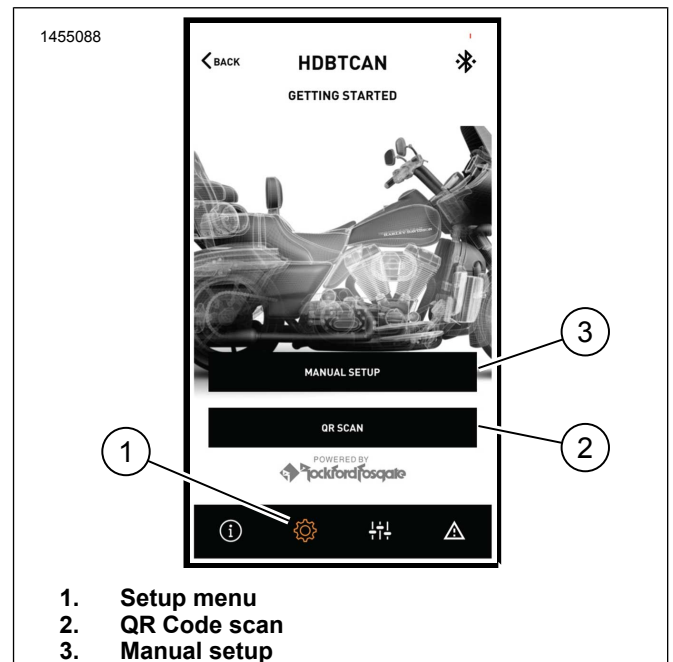

1. **Setup menu**
2. **QR Code scan**
3. **Manual setup**

Figure 6. Setup Menu

4. Figure 7 Equalizer setup screen.
 - a. Equalizer setup icon (1)
 - b. Tune 7-Band equalizer (2) frequencies.

c. Custom or preset equalizer selections (3).

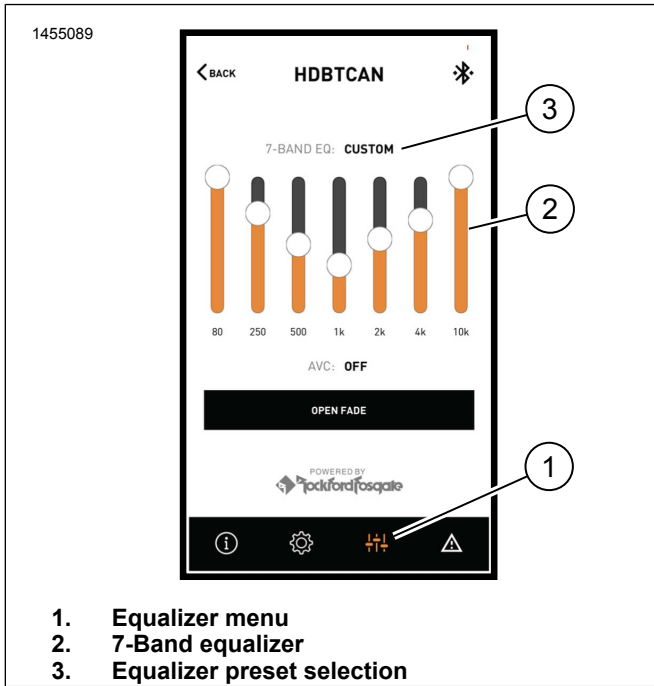

Figure 7. Equalizer Menu

5. Figure 8 Diagnostic menu screen.

- Diagnostic menu icon (1) displays sound system status.
- Open the speaker testing screen (2).
- Refreshes speaker and amplifier status (3) after component repair.
- Select speaker for white noise (4) test and functionality.
- Return to diagnostic menu screen (5).

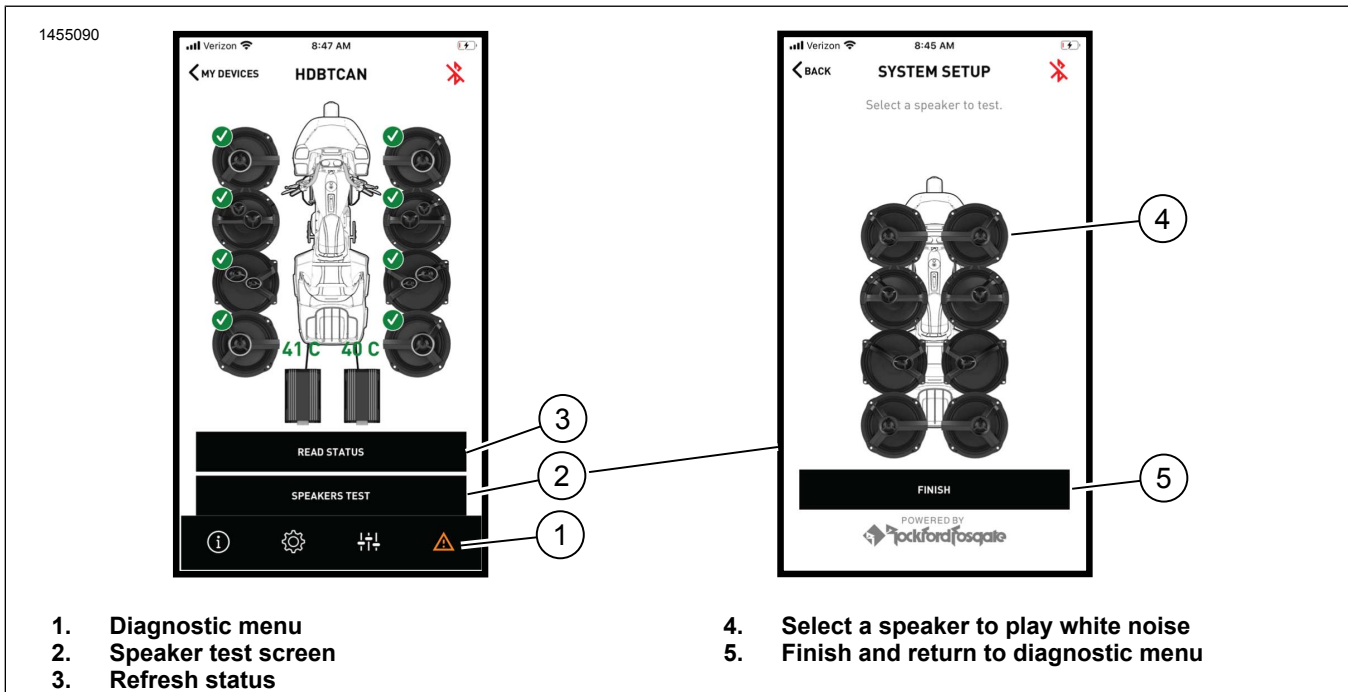

Figure 8. Diagnostic Menu

SERVICE PARTS

1443929

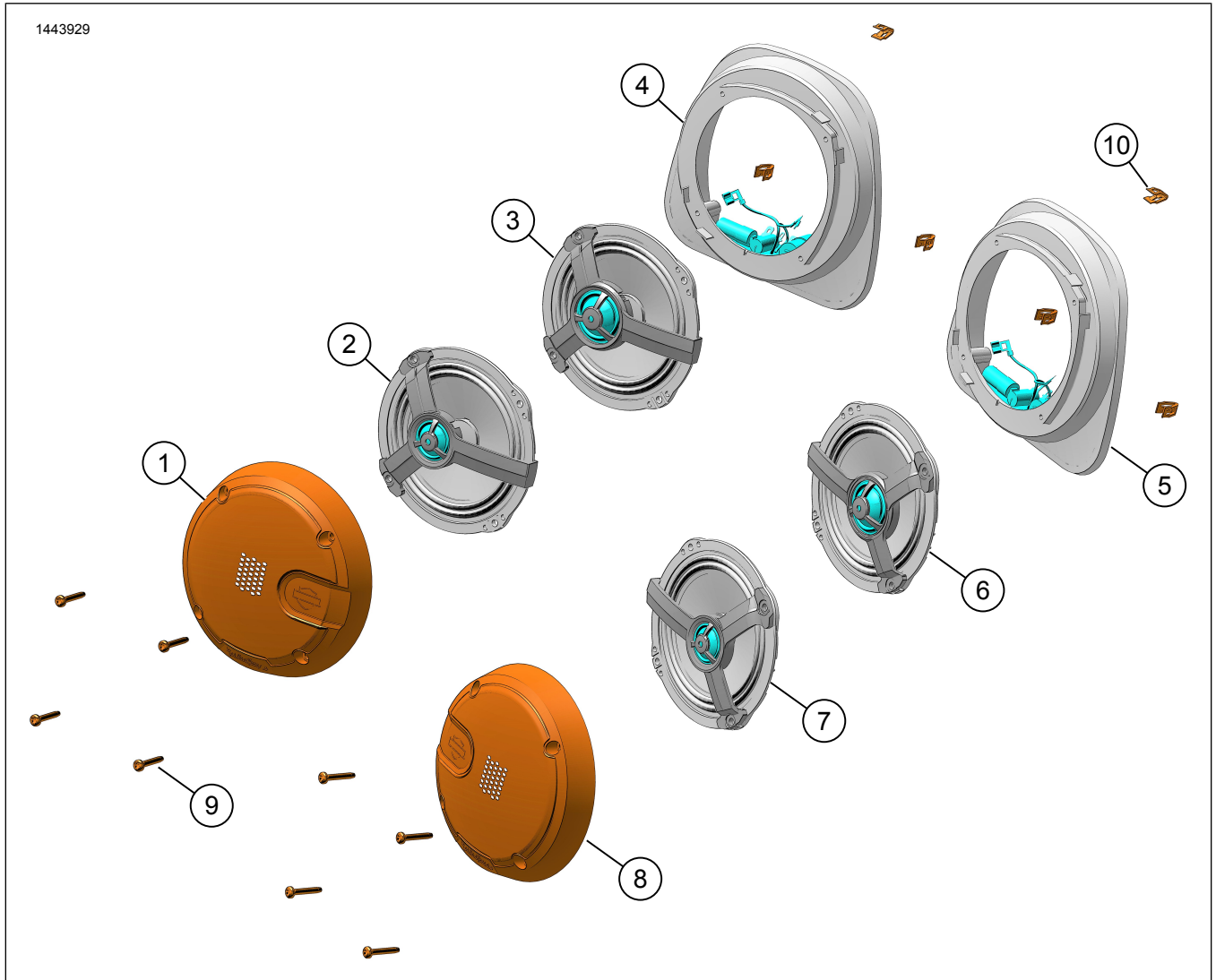

Figure 9. Service Parts, Fairing Lower Speakers

Table 2. Service Parts

Item	Description (Quantity)	Part Number	Kit Number
1	Speaker grille, left, stage 1	76001032	76000988
	Speaker grille, left, stage 2	76001034	76000989
2	Speaker, left, stage 1	76001002	76000988
3	Speaker, left, stage 2	76001003	76000989
4	Speaker enclosure, left, stage 1	76001047	76000988
	Speaker enclosure, left, stage 2	76001048	76000989
5	Speaker enclosure, right, stage 2	76001048	76000989
	Speaker enclosure, right, stage 1	76001047	76000988
6	Speaker, right, stage 2	76001015	76000989
7	Speaker, right, stage 1	76001014	76000988
8	Speaker grille, right, stage 1	76001033	76000988
	Speaker grille, right, stage 2	76001035	76000989
9	Screw, self-tapping, button head (8)	10201097	76000988, 76000989
10	Enclosure clip (6)	12200025	76000988, 76000989