



INSTRUCTIONS

94100468

2025-01-23



COOLFLOW FAN

GENERAL INFORMATION

Table 1. General Information

Kits	Suggested Tools	Skill Level ⁽¹⁾
26800242	Safety Glasses, Torque Wrench, Digital Technician II (DT II)	
(1) DTII and dealer installation required		

KIT CONTENTS

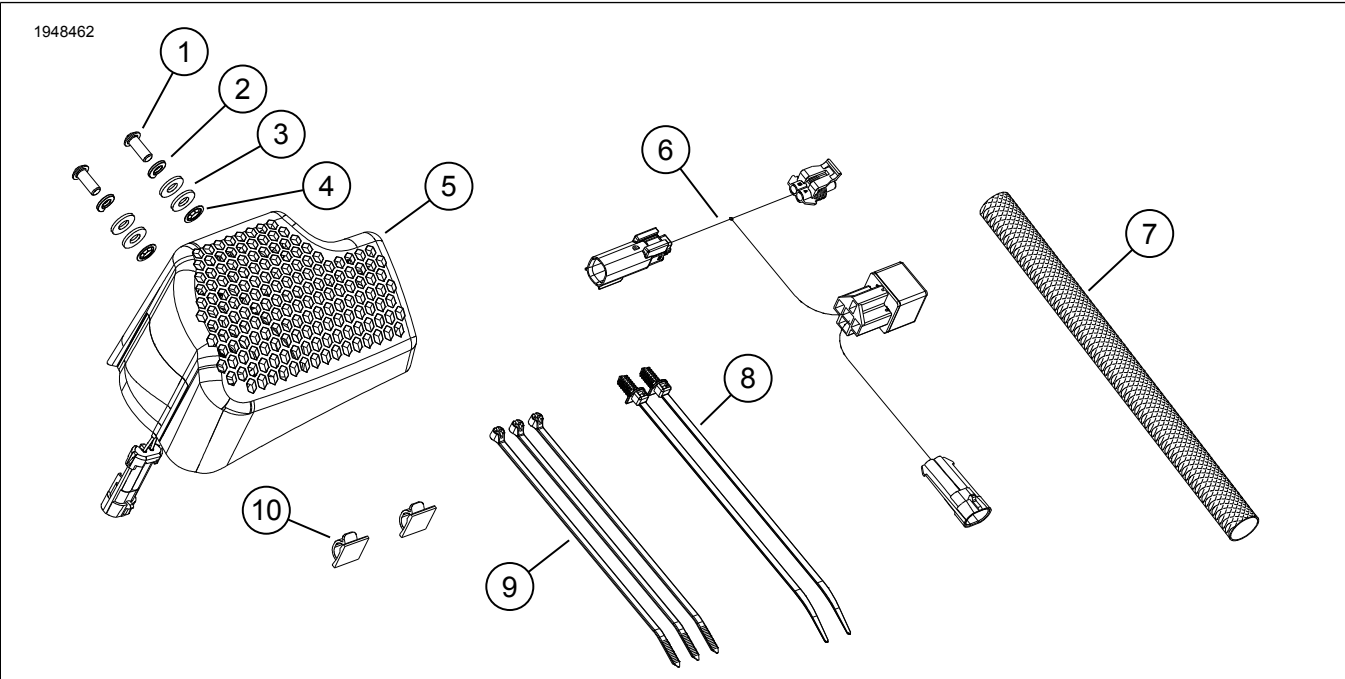

Figure 1. Kit Contents: CoolFlow Fan

Table 2. Kit Contents: CoolFlow Fan

<input checked="" type="checkbox"/>	Verify that all contents are present in the kit before installing or removing items from vehicle.				
	Item	Qty	Description	Part No.	Notes
<input type="checkbox"/>	1	2	Screw	4365	
<input type="checkbox"/>	2	2	Lock washer	7036	
<input type="checkbox"/>	3	4	Flat washer	6703	
<input type="checkbox"/>	4	2	Retaining clip, push-on	12200333	
<input type="checkbox"/>	5	1	Fan assembly	Not sold separately	
<input type="checkbox"/>	6	1	Wire harness	69203452	
<input type="checkbox"/>	7	1	Cover, oil line	62700220	
<input type="checkbox"/>	8	2	Cable strap, anchored	10287	
<input type="checkbox"/>	9	2	Cable strap	10006	
<input type="checkbox"/>	10	2	Clip	10120	

GENERAL

Instruction sheet is also available electronically. To verify you are using the most current version available, do one of the following:

- Go to h-d.com/isheets
- Scan QR code in upper left corner of the instruction sheet

NOTE

This instruction sheet **may have a Supplemental Video** to assist installer in clarifying a certain part of the assembly. A linked video would be located at the end of this instruction sheet.

Models

For model fitment information, see the Parts and Accessories (P&A) Retail Catalog or the Parts and Accessories section of www.harley-davidson.com.

Contact Harley-Davidson Customer Support Center at 1-800-258-2464 (U.S. only) or 1-414-343-4056.

Installation Requirements

⚠ WARNING

Rider and passenger safety depend upon the correct installation of this kit. Use the appropriate service manual procedures. If the procedure is not within your capabilities or you do not have the correct tools, have a Harley-Davidson dealer perform the installation. Improper installation of this kit could result in death or serious injury. (00333b)

⚠ WARNING

When installing any electrical accessory, be certain not to exceed the maximum amperage rating of the fuse or circuit breaker protecting the affected circuit being modified. Exceeding the maximum amperage can lead to electrical failures, which could result in death or serious injury. (00310a)

⚠ WARNING

To prevent accidental vehicle start-up, which could cause death or serious injury, remove main fuse before proceeding. (00251b)

NOTE

This instruction sheet references service manual information. A service manual for the year and model motorcycle is required for this installation and is available from:

- A Harley-Davidson dealer.
- H-D Service Information Portal, a subscription-based access available for most 2001 and newer models. For more information see *Frequently ask questions about subscriptions*.

These items are available at your local Harley-Davidson dealership.

Center-Cooled Vehicles:

- Separate purchase of 12 Way to 4 Way Electrical Jumper Harness (Part No. 69203486) is required.

2017 and later Road King/Special:

- Separate purchase of Toggle Switch (Part No. 71400122) is required.
- Separate purchase of Switch Label (Part No. 14001100) is required.
- Separate purchase of Toggle Switch Nut (Part No. 74408-08A) is required.
- Separate purchase of "Y" Harness (Part No. 69201571) is required, if multiple accessories are being installed.

2017 and later Trike models:

- Separate purchase of "Y" Harness (Part No. 69201571) is required, if multiple accessories are being installed.

2017-2024: NON Center-Cooled Vehicles with Fixed and Fork Mounted Fairing

- Separate purchase of Momentary Fan Switch (Part No. 71400121) is required.
- Separate purchase of Dash Panel Switchpack (69200173A) is required.
- Separate purchase of two Dash Panel Dummy Plugs (Part No. 7140031) is required.
- Separate purchase of "Y" Harness (Part No. 69201571) is required, if multiple accessories are being installed.

2017-2024: All NON Center-Cooled Vehicles

- Separate purchase of Jumper Wire Harness (Part No. 69203453) is required.

PREPARE

1. Remove seat. See service manual.
2. Remove left and right saddlebags. See service manual.
3. Remove left and right side covers. See service manual.
4. Remove main fuse. See service manual.
5. Remove top caddy. See service manual.
6. Remove battery. See service manual.

NOTE

- When repositioned, right spark plug wire boots (3) on coil pack should be facing toward left side of vehicle.
 - See Figure 7. There are holes in frame to support the use of Christmas tree cable straps (12) to help properly route a wire harness or secure spark plug wires.
 - When routing spark plug wires (2) make sure there is enough clearance between the frame and engine assembly.
7. **NON Center-Cooled Vehicles:** See Figure 7. Position right side spark plug wire boots.
 - a. Remove cable straps from wires and frame.
 - b. Rotate top spark plug boot (3) toward left side of vehicle.
 - c. Rotate bottom spark plug boot (3) toward left side of vehicle.
 - d. Route wires. Install cable straps (2) as needed.

INSTALL

1. See Figure 2. Locate mounting holes (1) in right side of frame cross member.

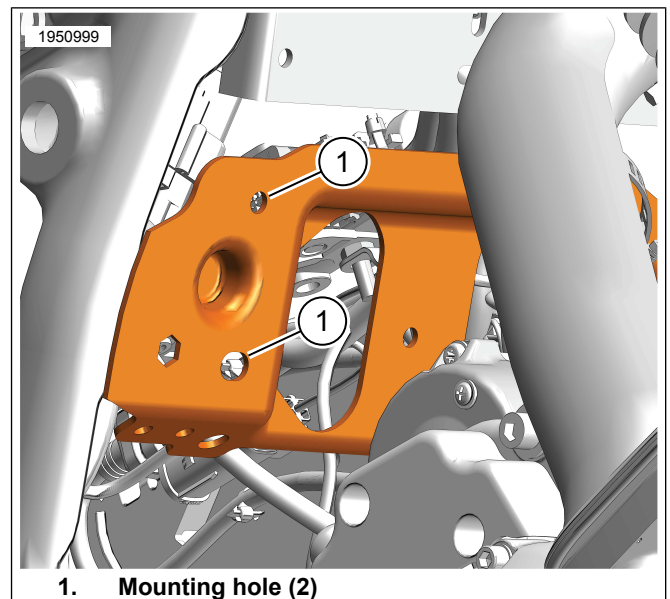

Figure 2. Frame Cross Member

2. See Figure 3. Install CoolFlow Fan assembly.
 - a. From within battery tray area, install screw (6), lockwasher (5), and flat washer (4) through frame cross member (7).
 - b. From powertrain area, install flat washer (3) and retaining clip (2).
 - c. Repeat hardware installation in other mounting hole.
 - d. Position fan (1) assembly to frame cross member (7).
 - e. Install screws (6) to fan (1). Tighten.
Torque: 16 N·m (12 ft-lbs)

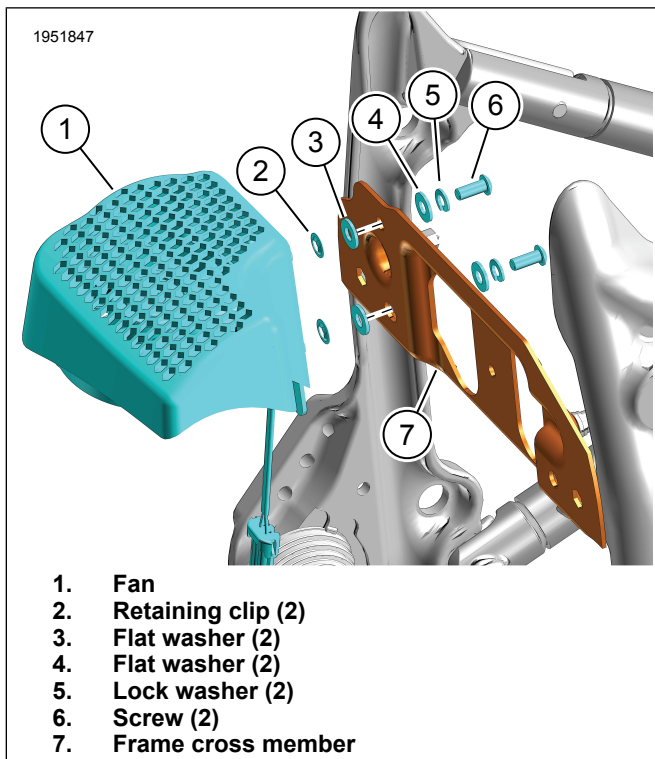

Figure 3. Install Fan to Cross Member

Center-Cooled Vehicles

NOTE

Install optional "Y" Harness (Part No. 69201571) if more than one accessory must be connected between vehicle P&A connector and fan relay harness connector.

1. Install Wire Harness (Part No. 69203486). Refer to Installation Requirements.
 - a. See Figure 6. Locate 12-way P&A [325A] (1) under the seat and remove cap plug.
 - b. See Figure 5. Connect Jumper Harness (Part No. 69203486) 12 Way [325B] to vehicle's P&A [325A].
 - c. Route two grey 4-way [325B-2] and [325B-3] under the right-side cover area.
 - d. Remove cap plug on red marked [325B-3]

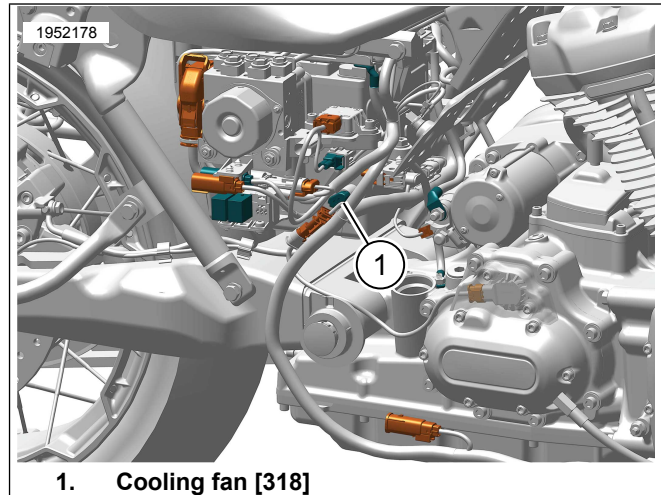

Figure 4. Fan Connector for Center-Cooled Vehicles

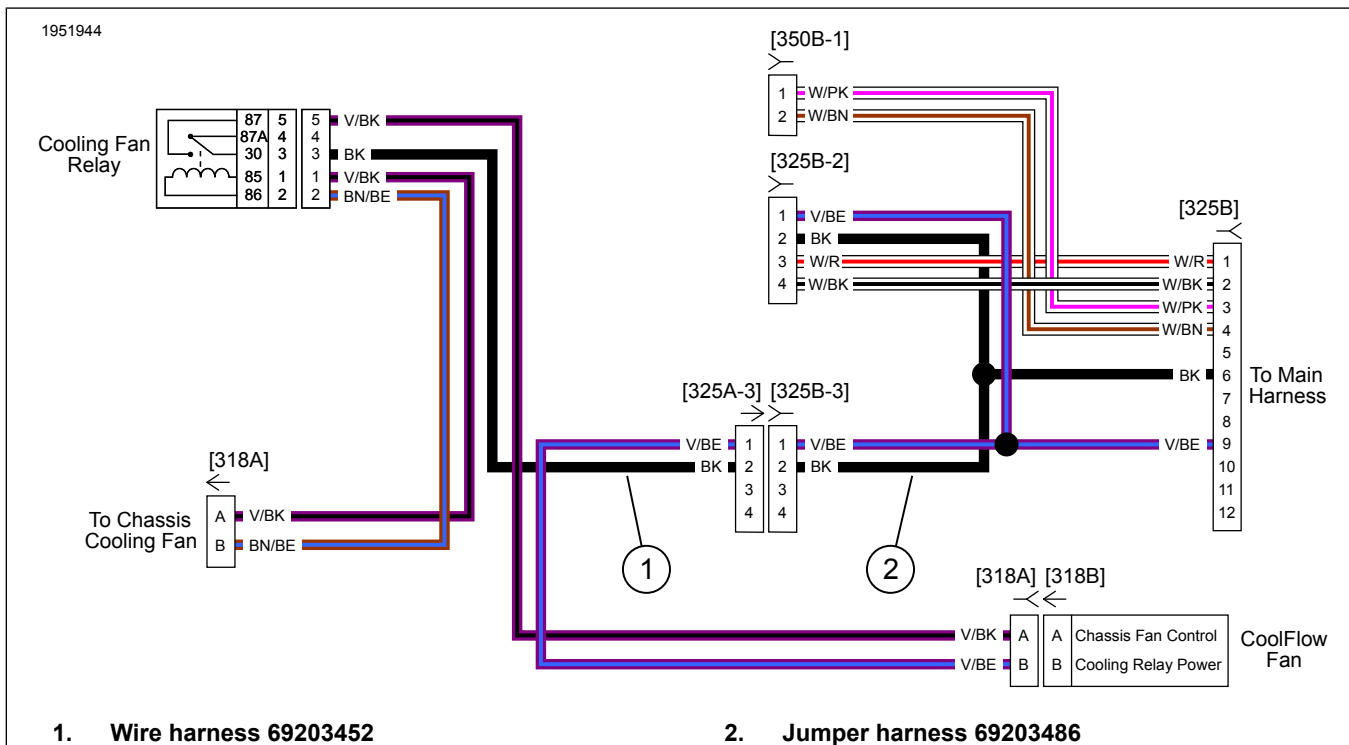

Figure 5. Wire Schematic for Center-Cooled Vehicles

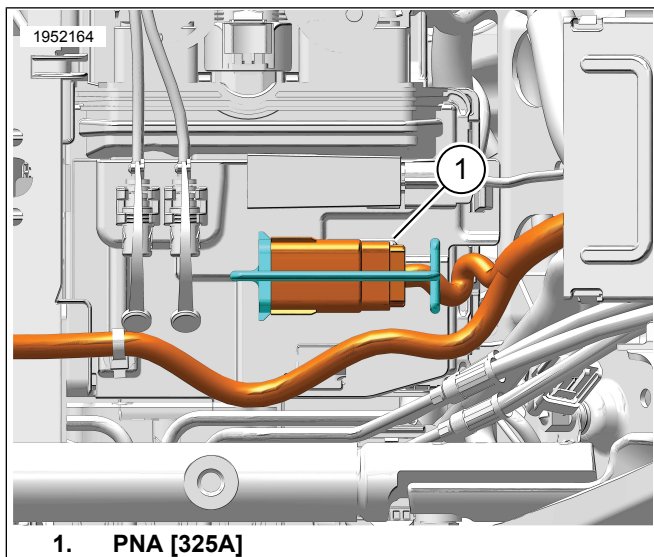

Figure 6. Vehicle's PNA Connector for Center-Cooled Vehicles

NON Center-Cooled Vehicles

1. See Figure 8. Install rear oil line hose cover.

NOTE

Install optional "Y" Harness (Part No. 69201571) if more than one accessory must be connected between vehicle P&A connector and fan relay harness connector.

- a. Position plug wire(s), if needed.
 - b. Release upper oil line hose spring clamp (1) and remove upper oil line hose only from head.
 - c. Remove oil line hose spring clamp (1) from hose.
 - d. Insert cover over rear oil line hose (2). Position cover 1 in (25.4 mm) from upper spring clamp on rear oil line hose.
 - e. Install spring clamp onto oil line hose and install oil line hose onto head.
 - f. With spring clamp loose, rotate hose for maximum clearance between fan housing and oil line hose cover (3).
2. Connect kit's Wire Harness (Part No. 69203452) to Jumper Harness (Part No. 69203453).
 - a. See Figure 10. Locate 3-way P&A [325B] (1) under right side cover and disconnect.

- b. See Figure 9. Connect Jumper Harness (Part No. 69203453) 3-way [325A-2] to vehicle's P&A [325B].
- c. See Figure 4. Locate chassis cooling fan [318].
- d. See Figure 5. Connect [318B] to [318A].
- e. Connect grey 4-pin [325A-3] to [325B-3].
- f. Connect 2-pin [318C] to CoolFlow Fan [318D].
- g. Secure harnesses with cable straps provided in the area between the battery box and the frame.

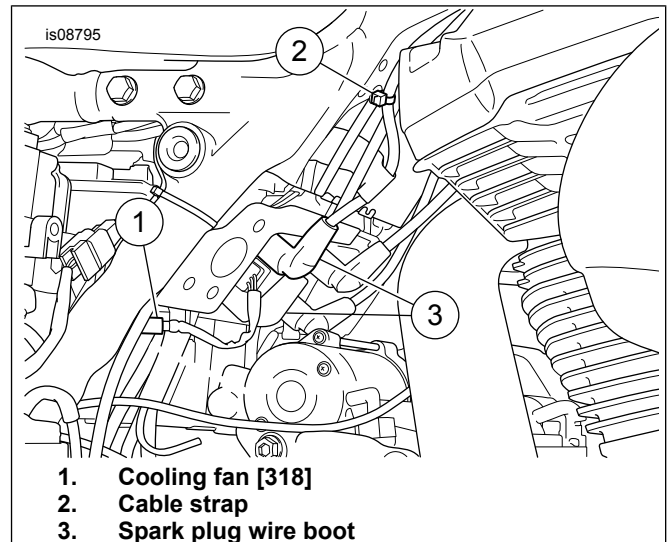

Figure 7. Fan Connector for NON Center-Cooled Vehicles

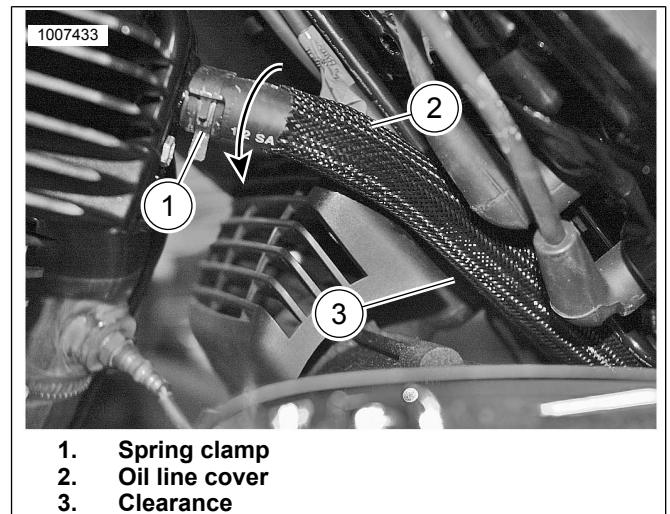

Figure 8. Rear Oil Line Cover

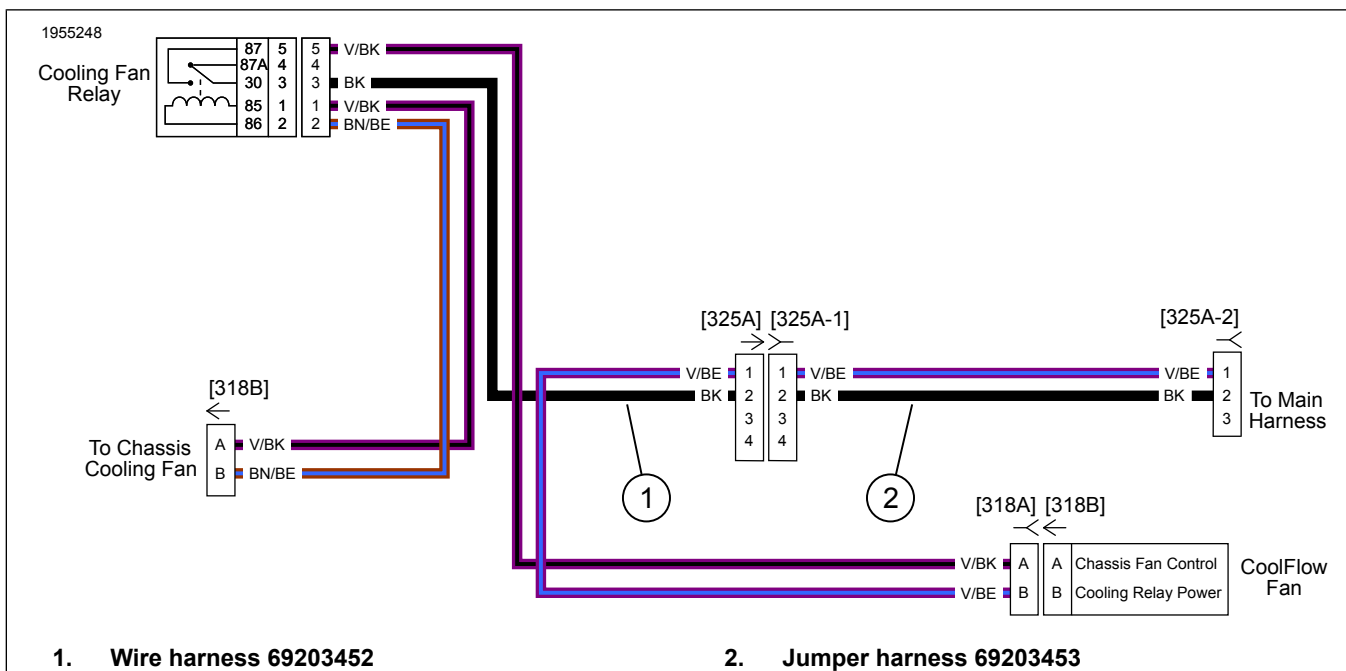

Figure 9. Wire Schematic for NON Center-Cooled Vehicles

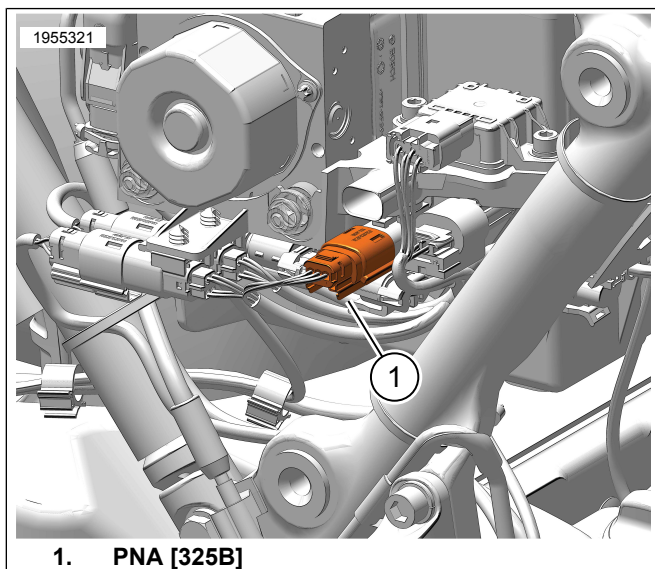

Figure 10. Vehicle's PNA Connector for NON Center-Cooled Vehicles

Switch for Non-Fairing Models

- Install toggle switch. Refer to Installation Requirements.
 - Remove plug from headlamp nacelle.
 - Remove adhesive backing from switch label (2).
 - Install switch label (2) with fan icon located at top.
 - Install toggle switch (1) and nut (3).
 - Plug harness, located under headlamp nacelle, to switch.
- FLRT:** Connector [205] is located under fuel tank in wire caddy.

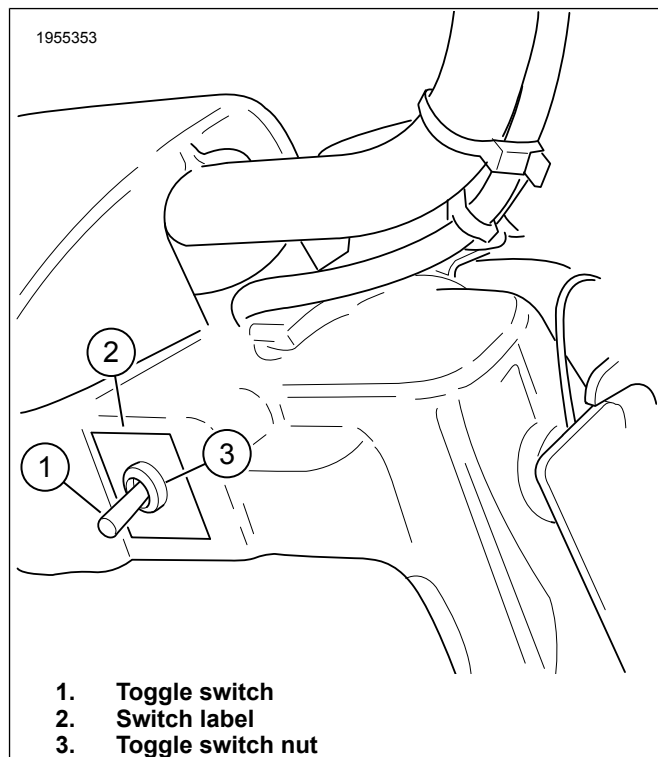

Figure 11. Non-Fairing Switch Location

Switch for Fixed and Fork Mounted Models

- Install fan switch. Refer to Installation Requirements.
 - If equipped, remove left hole plug and discard. See service manual.
 - If already installed, remove left switch module. See service manual.
 - Install fan switch in far right location in switch module.

- d. Add switch blanks in switch module, as needed.
2. Install switch module. See service manual.

CONFIGURE

Center-Cooled Vehicles

1. Configure using the Infotainment Control Unit (IFCU):
 - a. Place vehicle in Accessory mode. See owner's manual.
 - b. Navigate to Systems Settings > vehicle Function Setup.
 - c. Enable CoolFlow Fan.
 - d. Turn vehicle off and wait one minute.
 - e. Turn vehicle to IGN or Accessory mode. See owner's manual.
 - f. Open vehicle functions (1) from Left Hand Control Module (LHCM).
 - g. Turn CoolFlow Fan on/off, lamps should correspond to vehicle function indication.

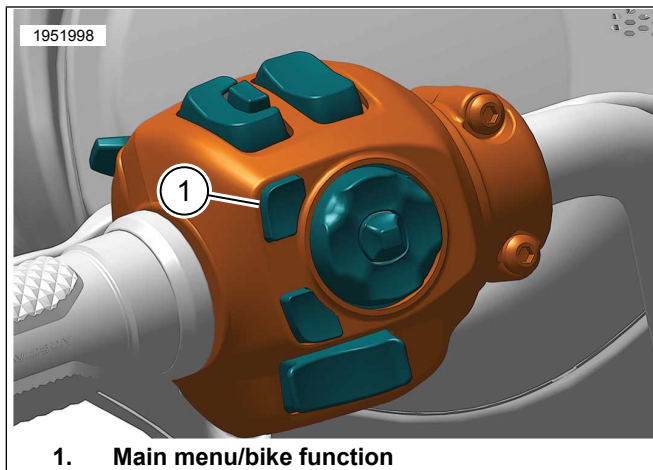

Figure 12. Vehicle Function

NON Center-Cooled Vehicles

1. Enable fan using DT II
Special Tool: DIGITAL TECHNICIAN II (HD-48650)

OPERATION

1. ON Setting:
 - a. Fan is ON when engine is running.
 - b. Fan is OFF when engine is not running.

2. AUTO Setting: Fan operates based on a combination of vehicle speed, engine temperature and ambient air temperature.

- a. Fan runs at speeds below 64 km/h (40 mph) when engine temperature is above 35 °C (95 °F) and ambient air temperature is above 15 °C (59 °F).
- b. Fan runs at speeds below 64 km/h (40 mph) when engine temperature is above 215 °C (419 °F) and ambient air temperature is below 15 °C (59 °F).
- c. Fan turns off if vehicle speed exceeds 72 km/h (45 mph) or if engine temperature goes below this temperature 202 °C (395 °F).

COMPLETE

1. Install battery. See service manual.
2. Install top caddy. See service manual.
3. Install main fuse. See service manual.
4. Install left and right side covers. See service manual.
5. Install left and right saddlebags. See service manual.
6. Install seat. After installing seat, pull up on seat to verify that it is secure. See service manual.