



INSTRUCTIONS

J06432

2025-01-23



RIDER BACKREST KIT

GENERAL INFORMATION

Table 1. General Information

Kits	Suggested Tools	Skill Level ⁽¹⁾
52300409, 52300745	Safety Glasses	
<i>(1) Only simple tools and techniques required</i>		

KIT CONTENTS

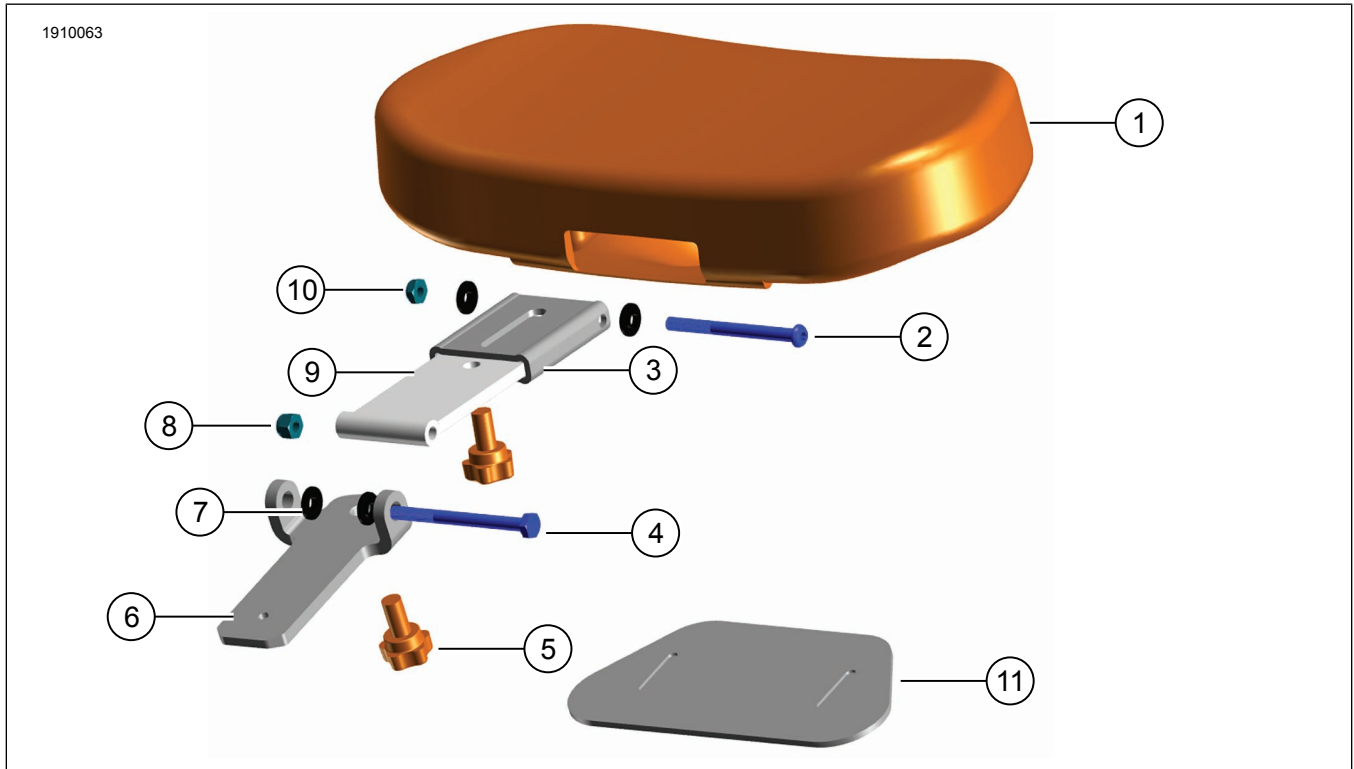

Figure 1. Kit Contents: Backrest - Rider

Table 2. Kit Contents: Rider Backrest Kits

<input checked="" type="checkbox"/>	Verify that all contents are present in the kit before installing or removing items from vehicle.				
<input type="checkbox"/>	Item	Qty	Description	Part No.	Notes
<input type="checkbox"/>	1	1	Backrest assembly	Not sold separately	
<input type="checkbox"/>	2	1	Screw, button head	Not sold separately	
<input type="checkbox"/>	3	1	Pivot head backrest	Not sold separately	
<input type="checkbox"/>	4	1	Grade 8 Hex cap screw, black	Not sold separately	
<input type="checkbox"/>	5	2	Adjustment knob	51868-06A	
<input type="checkbox"/>	6	1	Lower mount bracket	Not sold separately	
<input type="checkbox"/>	7	4	Shoulder washer, nylon	Not sold separately	
<input type="checkbox"/>	8	1	Lock nut, stainless steel, black oxide	Not sold separately	
<input type="checkbox"/>	9	1	Upper mount bracket	Not sold separately	
<input type="checkbox"/>	10	1	Lock nut, stainless steel	Not sold separately	
<input type="checkbox"/>	11	1	Adjuster knob cover	50700055	

GENERAL

Models

For model fitment information, see the Parts and Accessories (P&A) Retail Catalog or the Parts and Accessories section of www.harley-davidson.com.

Verify that the most current version of the instruction sheet is used. It is available at: h-d.com/isheets

Contact Harley-Davidson Customer Support Center at 1-800-258-2464 (U.S. only) or 1-414-343-4056.

Installation Requirements

▲ WARNING

Rider and passenger safety depend upon the correct installation of this kit. Use the appropriate service manual procedures. If the procedure is not within your capabilities or you do not have the correct tools, have a Harley-Davidson dealer perform the installation. Improper installation of this kit could result in death or serious injury. (00333b)

NOTE

This instruction sheet references service manual information. A service manual for the year and model motorcycle is required for this installation and is available from:

- A Harley-Davidson dealer.
- H-D Service Information Portal, a subscription-based access available for most 2001 and newer models. For more information see *Frequently ask questions about subscriptions.*

REMOVE

1. Remove seat. See service manual.

2. Remove one side of grab strap. See Service manual.

INSTALL

1. Figure 2 Feed grab strap through adjuster knob cover.
2. Attach grab strap to vehicle.
3. Install seat. After installing seat, pull up on seat to verify that it is secure. See service manual.

NOTE

Rider backrest receptacle can be accessed by separating rider and passenger seat sections by hand.

4. With rider backrest folded forward, insert lower mount bracket into receptacle in seat.

NOTE

A click should be heard when backrest is in the correct position.

5. Press rider backrest assembly down until fully seated.

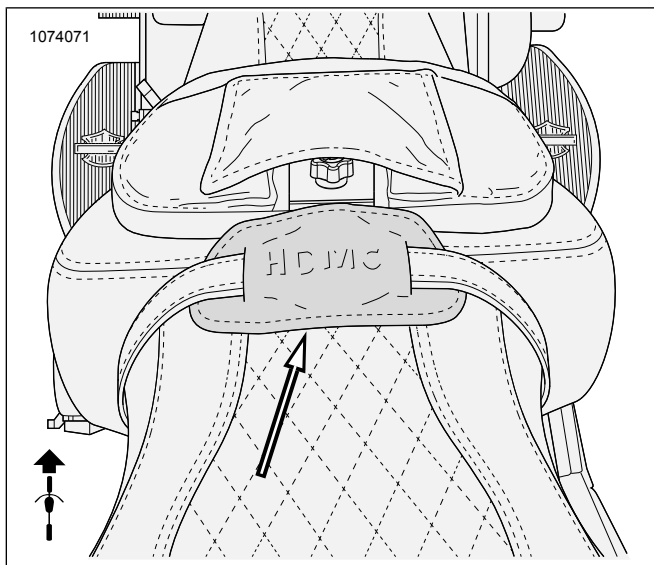

Figure 2. Adjuster Knob Cover Installed

ADJUSTMENT

1. Raise backrest and adjust as needed for rider comfort.

NOTE

Figure 3

- Height adjustment knob is loosened to allow sliding up or down of backrest, then tightened to lock in place.
- Forward lean adjustment knob is turned clockwise or counter-clockwise to tilt backrest forward or backward.

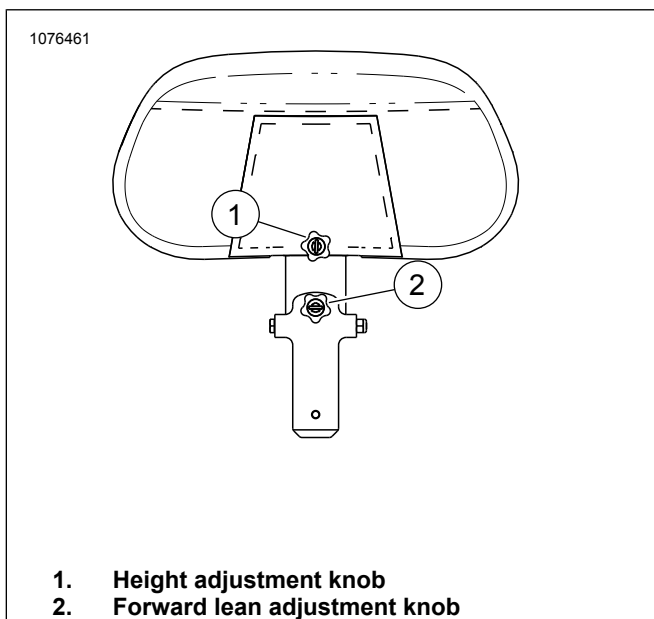

1. Height adjustment knob
2. Forward lean adjustment knob

Figure 3. Rider Backrest Adjustment Knobs