



INSTRUCTIONS

94100488

2025-01-23



ANTI-VIBRATION MODULE

GENERAL INFORMATION

Table 1. General Information

Kits	Suggested Tools	Skill Level ⁽¹⁾
76001342, 76001343, 76001492, 76001493	Safety Glasses, Torque Wrench	
<i>(1) Tightening to torque value or other moderate tools and techniques required</i>		

KIT CONTENTS

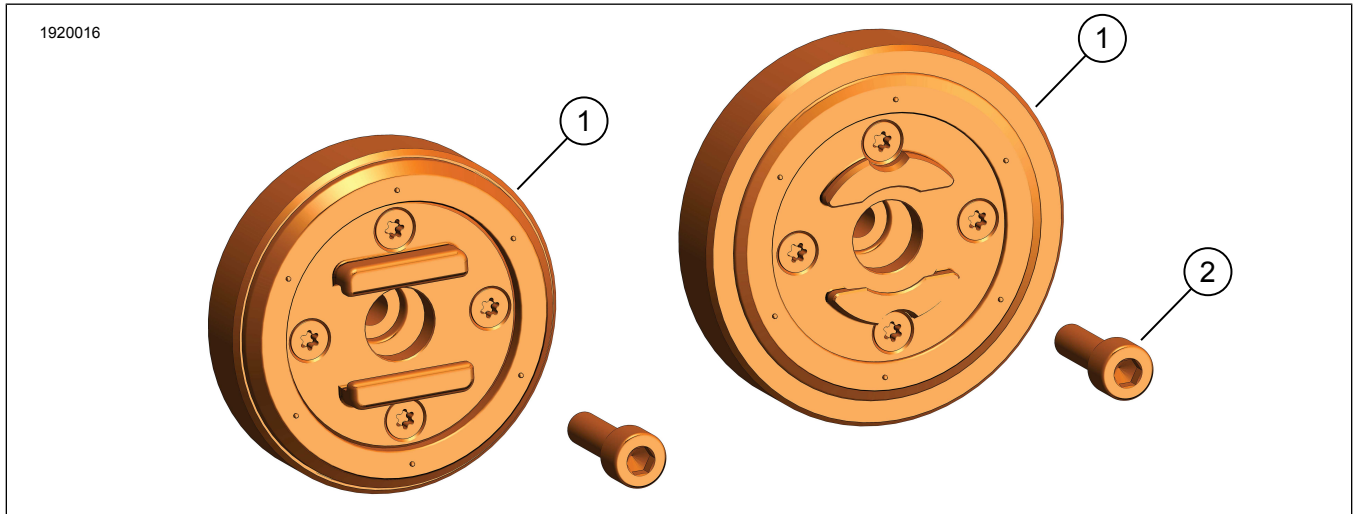

Figure 1. Kit Contents: Anti-Vibration Module

Table 2. Kit Contents: Anti-Vibration Module Kit

Verify that all contents are present in the kit before installing or removing items from vehicle.					
<input checked="" type="checkbox"/>	Item	Qty	Description	Part No.	Notes
<input type="checkbox"/>	1	1	Anti-vibration module	Not sold separately	
<input type="checkbox"/>			Anti-vibration module (SPC+)	Not sold separately	
<input type="checkbox"/>	2	1	Screw	Not sold separately	

GENERAL

Models

For model fitment information, see the Parts and Accessories (P&A) Retail Catalog or the Parts and Accessories section of www.harley-davidson.com.

Verify that the most current version of the instruction sheet is used. It is available at: h-d.com/isheets

Contact Harley-Davidson Customer Support Center at 1-800-258-2464 (U.S. only) or 1-414-343-4056.

Installation Requirements

⚠ WARNING

Rider and passenger safety depend upon the correct installation of this kit. If the procedure is not within your capabilities or you do not have the correct tools, have a Harley-Davidson dealer perform the installation. Improper installation of this kit could result in death or serious injury. (00308b)

REMOVE

1. Figure 2 Remove screw (1) and phone interface (2) from phone mount.

INSTALL

1. Figure 2 Install anti-vibration module (4).
2. Adjust phone position as desired.
3. Install **new** screw (3). Tighten.
Torque: 5 N·m (44 **in-lbs**)

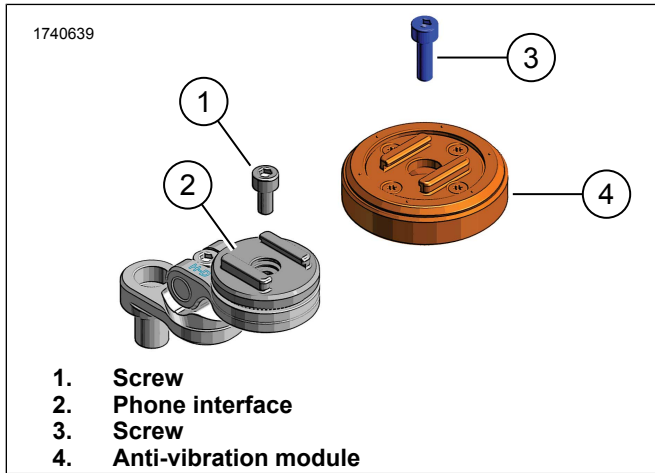

Figure 2. Install Anti-Vibration Module

COMPLETE

⚠ WARNING

Be sure that steering is smooth and free without interference. Interference with steering could result in loss of vehicle control and death or serious injury. (00371a)

1. Turn handlebar lock to lock installation to verify that the phone carrier and phone do not interfere with fairings, gas tank, cables, lines, hoses, wiring or other equipment.
2. Make sure that the phone does not obscure visibility of speedometer, hand controls, indicator lights or mirrors.