



# INSTRUCTIONS

J06377

2025-01-30



## ENGINE GUARD KITS

### GENERAL INFORMATION

Table 1. General Information

Kits	Suggested Tools	Skill Level <sup>(1)</sup>
49000138, 49000139, 49000140, 49000141	Safety glasses, Torque wrench	
<i>(1) Tightening to torque value or other moderate tools and techniques required</i>		

### KIT CONTENTS

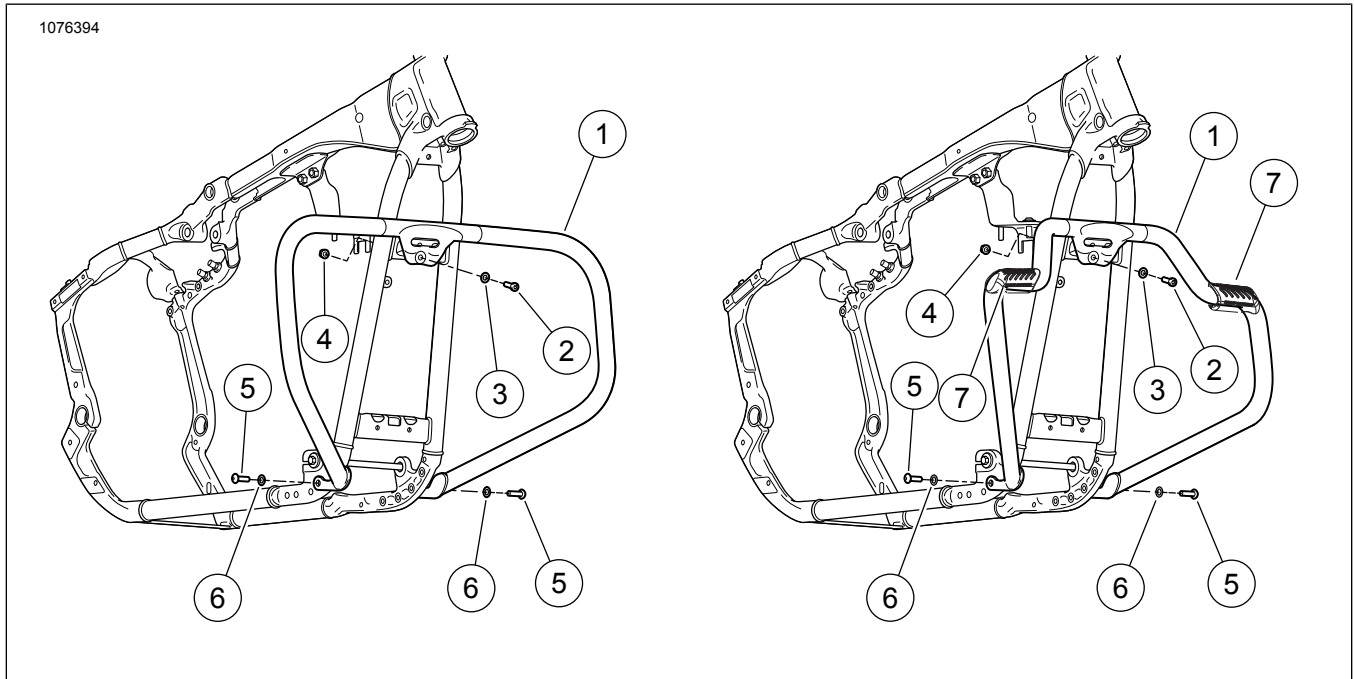

Figure 1. Kit Contents: Engine Guard Kit

Table 2. Kit Contents: Engine Guard Kit

Verify that all contents are present in the kit before installing or removing items from vehicle.					
✓	Item	Qty	Description	Part No.	Notes
<input type="checkbox"/>	1	1	Engine guard	Not sold separately	
<input type="checkbox"/>	2	1	Screw, socket head, 5/16-24 in	856A	
<input type="checkbox"/>	3	1	Plain washer, 5/16 in ID	6702	
<input type="checkbox"/>	4	1	Nut, flanged, 5/16-24 in	7593	
<input type="checkbox"/>	5	2	Screw, pan head, TORX, 3/8-16 x 1-1/4 in	4188	
<input type="checkbox"/>	6	2	Plain washer, 3/8 in ID	6812	
<input type="checkbox"/>	7	2	Kit, foot pad, engine guard	49000034	Kits: 49000140, 49000141 only



## GENERAL

Instruction sheet is also available electronically. To verify you are using the most current version available, do one of the following:

- Go to [h-d.com/isheets](http://h-d.com/isheets)
- Scan QR code in upper left corner of the instruction sheet

### NOTE

This instruction sheet **may have a Supplemental Video** to assist installer in clarifying a certain part of the assembly. A linked video would be located at the end of this instruction sheet.

## Models

For model fitment information, see the Parts and Accessories (P&A) Retail Catalog or the Parts and Accessories section of [www.harley-davidson.com](http://www.harley-davidson.com).

Contact Harley-Davidson Customer Support Center at 1-800-258-2464 (U.S. only) or 1-414-343-4056.

## Installation Requirements

These items are available at your local Harley-Davidson dealership.

- **2022 and later Low Rider ST (FXLRST):** Separate purchase of Flat-Out Bar Adapter Kit (Part No. 47200927) is required for this installation.

### ▲ WARNING

Rider and passenger safety depend upon the correct installation of this kit. If the procedure is not within your capabilities or you do not have the correct tools, have a Harley-Davidson dealer perform the installation. Improper installation of this kit could result in death or serious injury. (00308b)

## INSTALL

### ▲ WARNING

If Equipped: Front and/or rear guards are not intended to provide protection from bodily injury in a collision with another vehicle or any other object. (00022d)

1. See Figure 2. Check position of clutch clip (4).
  - a. Move slip to location above where engine guard will be located, if necessary.
  - b. Rotate so clutch cable is not at front of frame tube.
2. Remove plastic plugs from frame mounting holes, if present.
3. See Figure 3. On right side of motorcycle, attach engine guard (1) to lower frame with screw (2) and washer (3) from kit. Tighten finger-tight.
  - a. Repeat this step for left side.

4. See Figure 4. Hold engine guard (1) in place, lining up hole in top center mounting flange of guard with hole in cross brace located between front downtubes just below steering head.
5. Install a flat washer (3) onto screw threads and insert screw (4) through holes from front.
  - a. Thread hex nut (2) onto screw. Tighten finger-tight.
6. Tighten top screw.  
Torque: 41 N·m (30 ft-lbs)
7. Tighten right side screw. Repeat for left side.  
Torque: 44.8 N·m (33 ft-lbs)

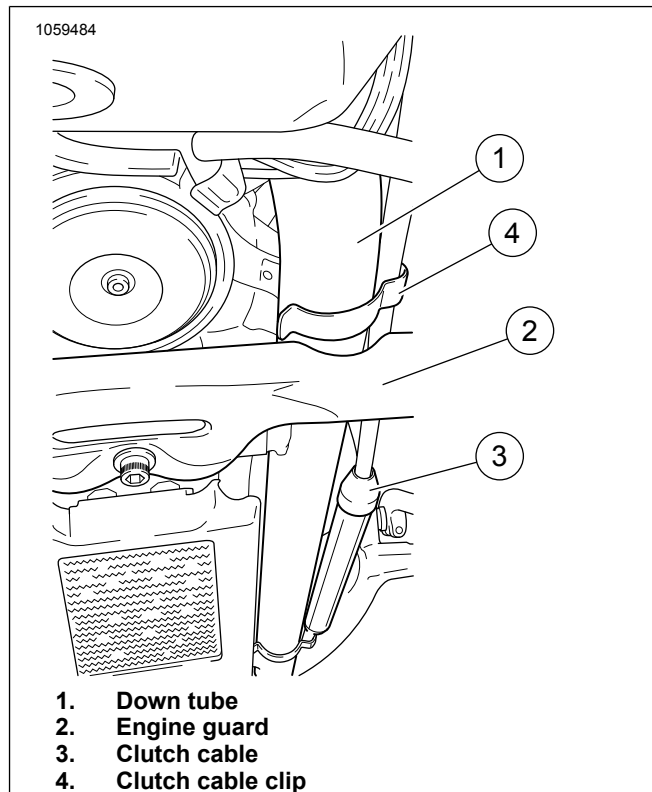

Figure 2. Clutch Cable Routing

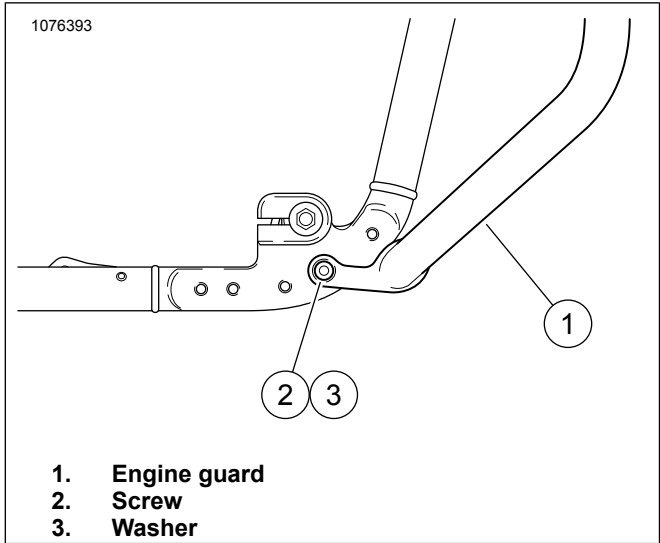

Figure 3. Engine Guard Lower Mounting (Right Side View)

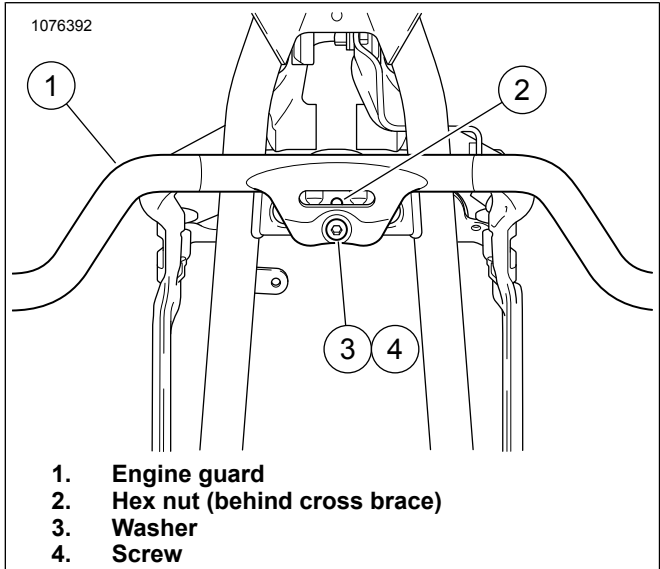

Figure 4. Engine Guard Mounting Flange (Top Center)