



INSTRUCTIONS

94100025

2025-02-25



ENGINE GUARD FOOTPEG BILLET MOUNTING KIT

GENERAL

Instruction sheet is also available electronically. To verify you are using the most current version available, do one of the following:

- Go to h-d.com/isheets
- Scan QR code in upper left corner of the instruction sheet

NOTE

This instruction sheet **may have a Supplemental Video** to assist installer in clarifying a certain part of the assembly. A linked video would be located at the end of this instruction sheet.

Kit Number

50957-02C, 54234-10A

Models

For model fitment information, see the P&A Retail Catalog or the Parts and accessories section of www.harley-davidson.com

Additional Parts Required

This kit requires installing a set of footpegs, sold separately and available from a Harley-Davidson dealer.

Kit Contents

See Figure 1 and Table 1.

INSTALLATION

1. See Figure 1. Position footpeg mount (3) and clamp (1) on engine guard.
2. Position footpeg mount (3) to allow footpeg to fasten on inboard side of engine guard.
3. Attach screws (4) to fasten footpeg mount in a comfortable location on engine guard.
4. Hand tighten each screw.
5. Alternate between screws when tightening. Tighten.
Torque: 19 N·m (14 ft·lbs)
6. Install footpeg, sold separately.
 - a. Position spring washer (2) inside footpeg mount with square edge toward the inside of the mount.
 - b. Secure with clevis pin (5) and retaining ring (6).
7. Repeat steps 1-6 on the other side of the motorcycle.

SERVICE PARTS

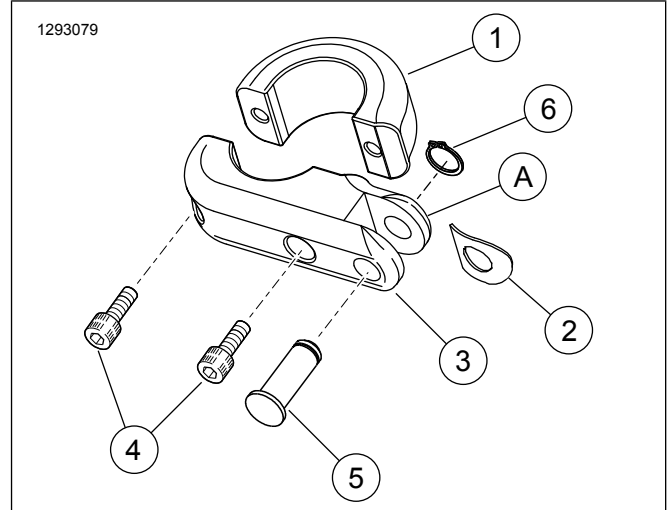

Figure 1. Service Parts: Engine-Guard Footpeg Billet Mounting Kit

Table 1. Service Parts Table

Kit	Item	Description (Quantity)	Part Number
50957-02C	1	Clamp, chrome (2)	51009-02A
	2	Spring washer (2)	50912-72
	3	Billet footpeg mount, chrome (2)	50501293
	4	Socket head screw (4)	4617
	5	Pin, clevis (2)	45041-01A
	6	Retaining ring (2)	11304
54234-10A	1	Clamp, black (2)	50500017
	2	Spring washer (2)	50912-72
	3	Billet footpeg mount, black (2)	50501292
	4	Socket head screw (4)	4617
	5	Pin, clevis (2)	50500501
	6	Retaining ring (2)	11304
Items mentioned in text, but not included in kit:			
	A	Position this part of the bracket toward the motorcycle	
NOTE			
Orient clamp (1) so angled edge of clamp (1) is on same side as angled edge of foot peg mount (3).			