



INSTRUCTIONS

-J02396

REV. 4-10-2002

Kit Number 92018-03

100th ANNIVERSARY LEATHER SOFTAIL DEUCE SADDLEBAG KIT

General

This saddlebag kit is designed to fit 2000 and later Softail Deuce (FXSTD) model motorcycles.

See Service Parts Pages for kit contents.

NOTE

A Service Manual for your vehicle is available at your Harley-Davidson Dealer.

WARNING

Additional weight can affect motorcycle stability, handling characteristics, and safe operating speed. Do not exceed 10 lbs. (4.5Kg) maximum load in each saddlebag. Evenly distribute weight between each saddlebag. Improper loading can adversely affect vehicle handling which could result in death or serious injury.

WARNING

Federal Motor Vehicle Safety Standard (FMVSS) 108 requires all motorcycles to be equipped with side reflectors. The mounted saddlebags will cover the factory installed reflectors on some vehicles. Install, or have Dealer install, the reflectors supplied with this kit. Loss of visibility to other motorists could result in an accident and death or serious injury.

Installation

1. Remove seat.

WARNING

To avoid accidental start-up of motorcycle, and possible personal injury, disconnect the battery cables (negative cable first) before performing any of the following procedures. If the positive cable should contact ground with the negative cable installed, the resulting sparks may cause a battery explosion resulting in death or serious injury.

2. Disconnect battery cables, negative cable first.

Install Turn Signal Relocation Kit (Part Number 90395-00)

3. See Figure 1. Insert phillips head screwdriver into middle hole of license plate light assembly. Push screwdriver in to disengage clip while gently pulling lamp out. See Figure 2. Disconnect tail/stop light wiring (4-place Multilock) at stop/tail lamp connector.

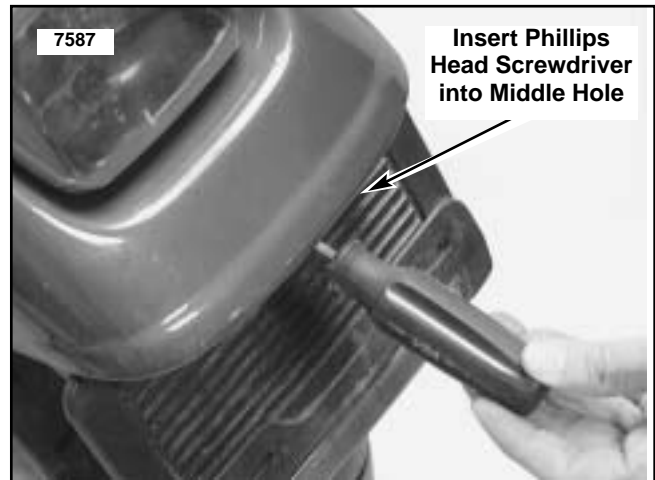

Figure 1. Remove Tail/Stop Light Assembly

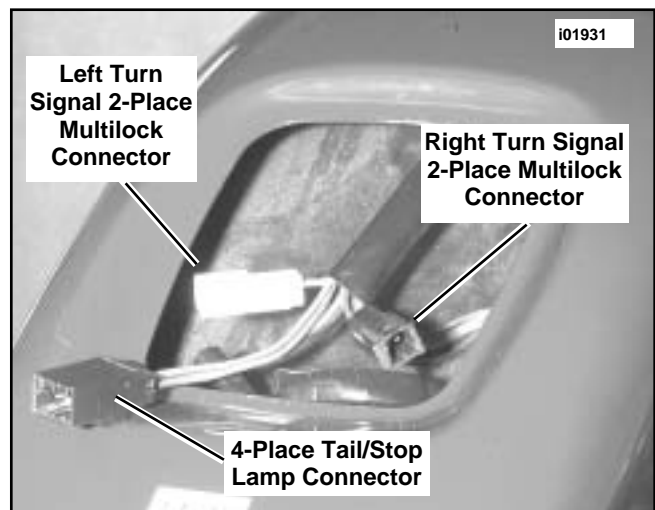
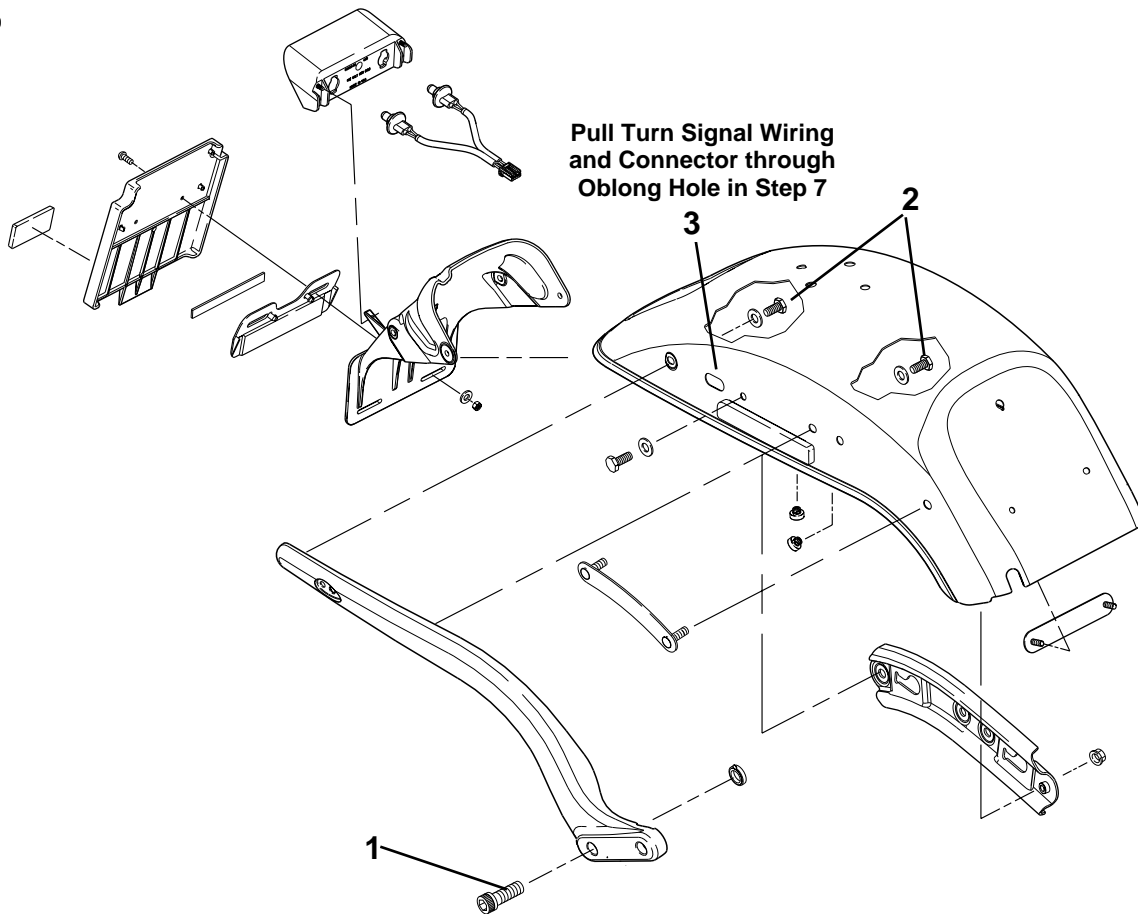

Figure 2. Disconnect Turn Signal Wires

4. See Figure 2. Disconnect left (White, 2-place Multilock) and right (Black, 2-place Multilock) turn signals by depressing button on socket terminal side of connector and pulling apart pin and socket halves.
5. See Figure 3. Remove two fender support front socket head screws. Save hardware for re-installation.
6. See Figure 3. Remove fender support capscrew (under fender) near end of fender support. While supporting the fender support, remove the capscrew at approximate midpoint of the support.
7. See Figure 3. Carefully remove fender support and signal lamp assembly with wiring through holes in fender. Save capscrews and washers for installation.
8. Perform procedures 5 through 7 for the opposite side fender support and signal lamp assembly.



Pull Turn Signal Wiring and Connector through Oblong Hole in Step 7

- 1 Fender support socket head screws (removed in Step 5, reinstalled in Step 18)**
- 2 Fender support cap screws (removed in Step 6, reinstalled in Step 19)**
- 3 Oblong hole to pull turn signal wiring and connector through in Step 7 and re-route wiring through in Step 17**

Figure 3. Rear Fender Support and License Plate Bracket Assembly (right view shown)

NOTE

At this point, the turn signal (2-place Multilock) connector must be removed from the turn signal wire in order to remove the signal and signal mount from the fender support. The connector is re-installed after routing wire through relocation mount and installing signal/relocation mount to fender support. Snap-On Pick Tool part number TT600-3 is recommended for this procedure however, the sharp end of a safety pin will work with some practice.

9. To remove wire (with socket terminal) from left connector, perform the following:
 - a. See Figure 4. Bend back the latch slightly and free one side of secondary lock, then repeat the step to release the other side. Rotate the secondary lock outward (open) on hinge to access terminals in chambers of connector housing.
 - b. With the flat edge against the terminal, insert the Pick Tool (Snap-On TT600-3) into the cavity until it stops. Pivot the end of the pick away from the terminal and gently tug on wire to pull terminal from chamber. Do not tug on the wire until the tang is released or the terminal will be difficult to remove. A "click" is heard if the tang is engaged but then inadvertently released. Repeat the step without releasing the tang. Repeat a and b for the second wire.

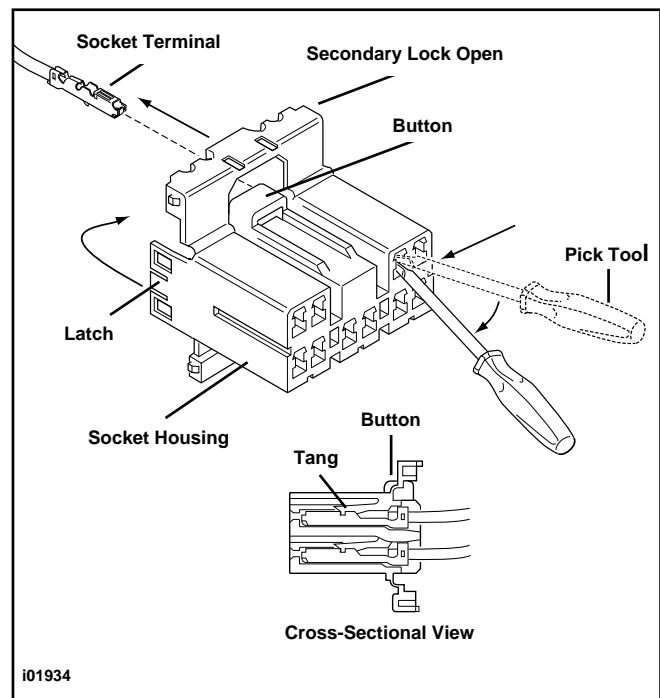

Figure 4. Remove Wiring from Connector (Typical)

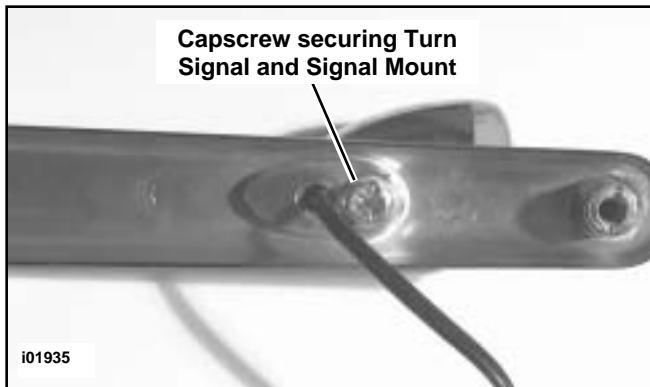

Figure 5. Remove Turn Signal and Signal Mount from Fender Support

10. See Figure 5. Remove turn signal and signal mount from fender support by removing capscrew shown. Gently pull wiring through fender support and mount. Discard mount and capscrew.

11. Repeat Steps 9 and 10 for the opposite side.

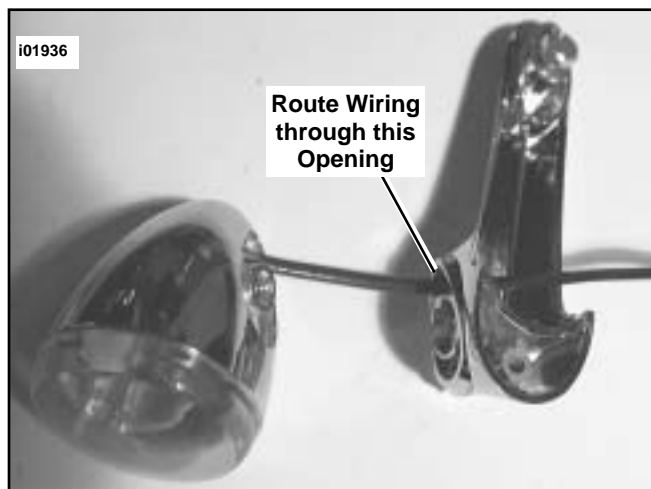

Figure 6. Route Signal Wiring through Relocation Mount

12. See Figure 6. Obtain left turn signal relocation mount and route wiring from turn signal through mount as shown.

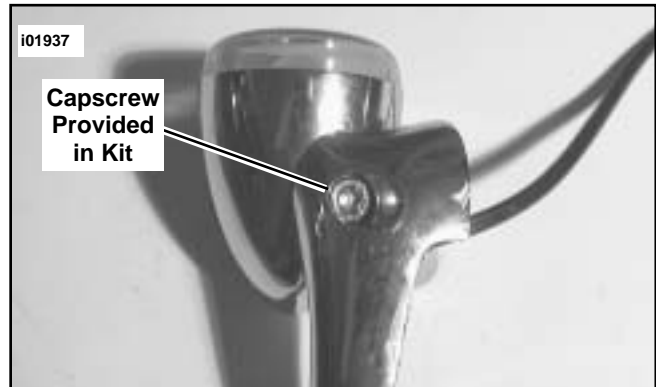

Figure 7. Install Turn Signal to Relocation Mount

13. See Figure 7. Using socket head capscrew provided in kit, install turn signal to relocation mount. Tighten screw securely.

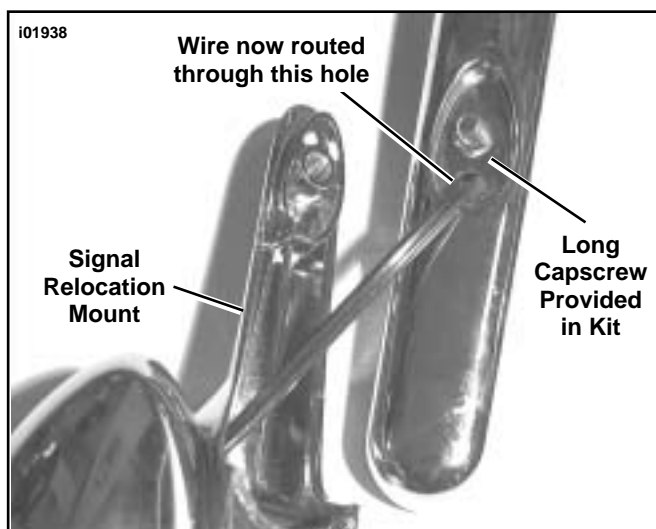

Figure 8. Route Wiring and install Signal Relocation Mount to Fender Support

NOTE
In the next step, the function of the holes in the fender support are reversed from original installation. The signal wiring is routed through the hole originally used by the capscrew for mounting the signal; the hole originally used for wiring will be used for installing signal relocation capscrew.

14. See Figure 8. Route wires through left fender support as shown and using long capscrew and washer provided in kit, install signal relocation mount to fender support. Tighten capscrew securely.

15. Perform Steps 12 through 14 for the right side.

NOTE

At this time, the signal wiring is re-installed to the connectors removed in Step 9.

16. Install wire (with socket terminal) to connector by performing the following:

NOTE

For wire location purposes, when facing the secondary lock side and with button up, the black wire inserts into the left side of the connector; purple wire into the right side of the connector. The left turn signal utilizes the White 2-place connector; the right turn signal uses the Black 2-place connector.

- a. See Figure 9. From the secondary lock side of the connector, insert the terminal into its respective chamber until it snaps in place. For proper fit, the slot on the terminal must face the tang (up) in the chamber.
 - b. Gently tug on wire end to verify that the terminal is locked in place and will not back out of chamber.
 - c. Rotate the hinged secondary lock inward until tabs fully engage latches on both sides of connector.
 - d. Perform procedures a through d for the opposite connector.
17. See Figure 3. While holding left side fender support/signal assembly, route wiring with connector through oblong hole in fender and back to original location near tail/stop lamp assembly.
 18. See Figure 3. Reinstall socket head capscrews removed in Step 3 at front of fender support. Finger tighten.
 19. Reinstall original capscrews and washers through fender at midpoint and near end of fender support. Make sure fender support does not bind or pinch turn signal wiring. Tighten capscrews to 12-15 ft-lbs (16.3-20.3 Nm).
 20. Return to socket head capscrews at front and tighten to 14-16 ft-lbs (19.0-21.7 Nm).
 21. Insert turn signal connector (White, 2-place) into left turn harness connector (White, 2-place) until it snaps.
 22. Perform procedures 17 through 21 for the right fender support assembly, however in Step 21, the right turn signal connectors are black.
 23. See Figure 10. Connect tail/stop lamp connector (White, 4-place) to harness connector (Black, 4-place).
 24. See Figure 11. Align lamp with cutout in fender as shown. Insert upper spring into place and with index finger, push upward slightly on lower spring while firmly pressing assembly toward fender. Assembly is secure when upper and lower springs "click".

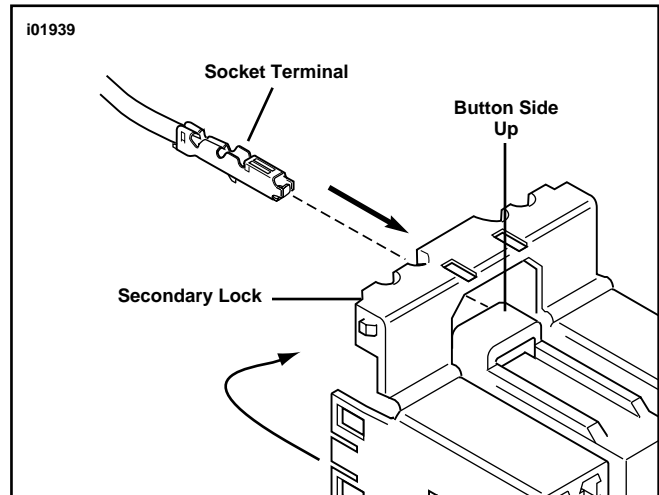

Figure 9. Install Wire to Connector

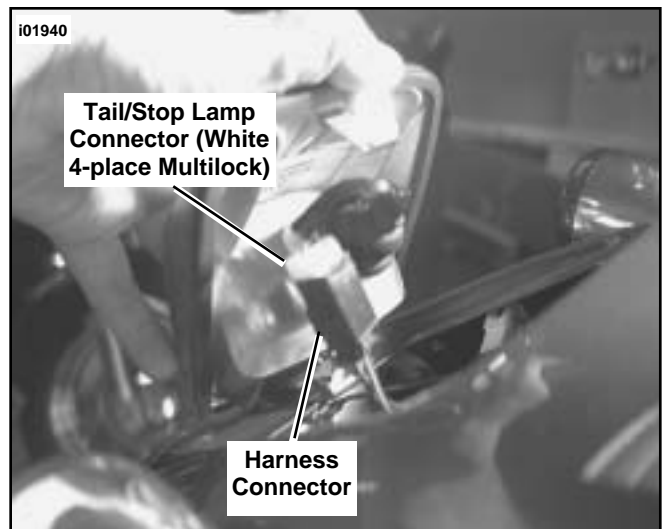

Figure 10. Connect Tail/Stop Lamp to Harness



Figure 11. Install Tail/Stop Lamp Assembly

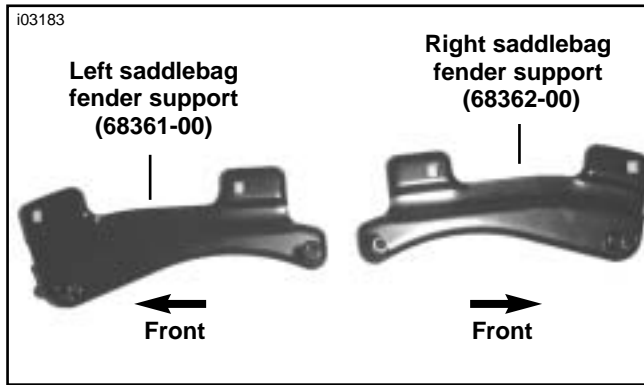

Figure 12. Identify Left and Right Supports

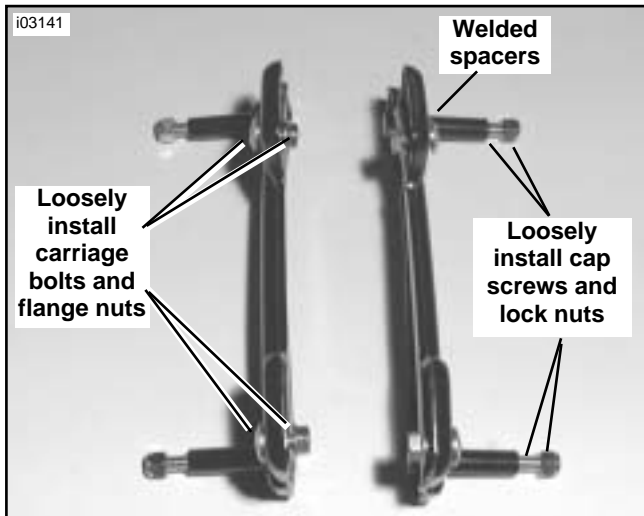

Figure 13. Saddlebag Fender Supports

Install Saddlebag Support Kit (Part Number 68360-00)

1. See Figures 12 and 13. Identify the left and right saddlebag supports. Loosely install two carriage-style mounting bolts (Part Number 5418) and two flange nuts (Part Number 7601) from this kit to each saddlebag support with bolt heads facing the outer, saddlebag side of the support assemblies. Finger tighten.
2. Loosely install two 3/8-16X3-in. hex-head cap screws (Part Number 4205) and two 3/8-16 nylon-insert hex lock nuts (Part Number 7778) to each support through the fender support welded-on spacers from inside to outside. Finger tighten.

NOTE

Figure 14 and lower portion of Figure 15 are provided for illustration purposes only. It is not necessary to remove fender for the following procedures.

3. See Figure 14. Locate the rounded sections of the stock fender-reinforcement cutouts, on the bracket mounted under the fender, that capture the rounded head of the support bolts when attaching saddlebag supports.

NOTE

For steps 4 through 6, elevate the motorcycle to allow the rear wheel to drop to the bottom of shock-absorber travel. This provides clearance between the rear tire and fender.

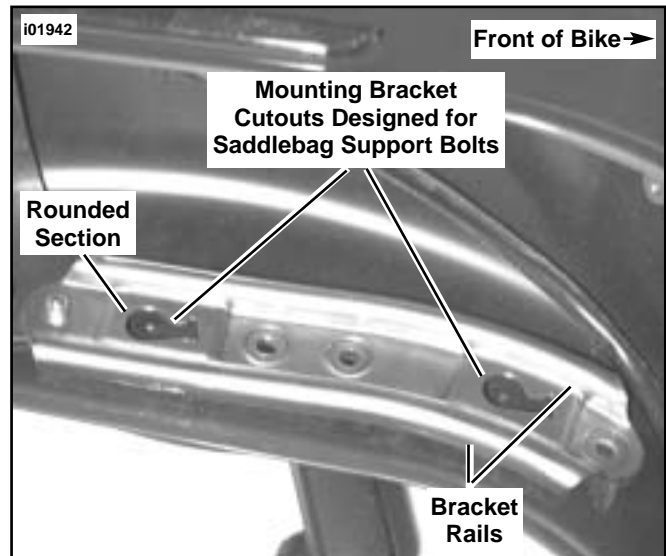

Figure 14. Bracket installed under Fender. (Left Side Shown from Inside Fender)

4. See Figures 14 and 15. Slide support (right side, shown in upper portion of Figure, left side shown from underneath in lower portion of Figure) up and under fender as shown. While aligning the rails on the support to the rails on the mounting bracket, engage rounded head of mounting bolt with rounded portion of bracket cutouts. See the lower portion of Figure 15. Consider these techniques to assist installation:

- Move the support back and forth while pulling toward the fender to feel the rail alignment and feel the bolt heads engage the bracket.
- Push on the nuts to help engage the bolt heads into the bracket cutouts.
- Pre-install the mounting bolts into the mounting-bracket cutouts, install the fender support onto the mounting bolts, then install the flange nuts onto the bolts.

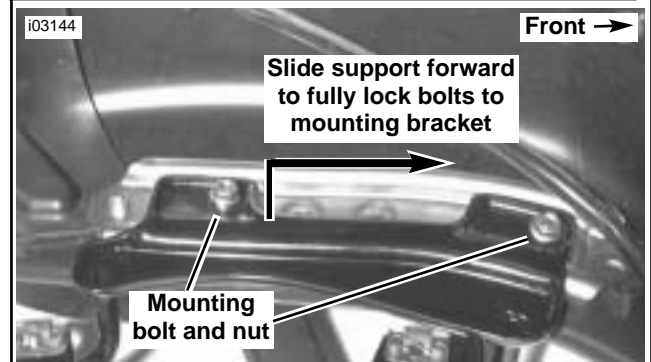
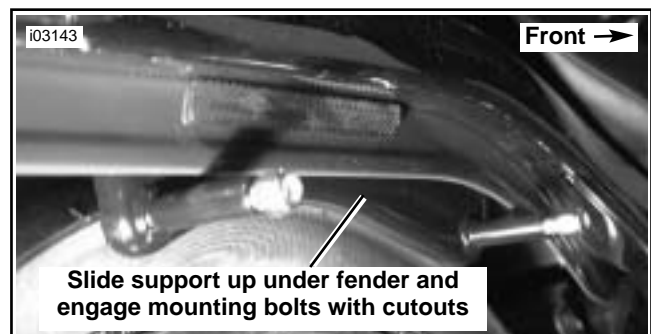

Figure 15. Slide Support Fully Forward (Left Shown)

5. When rails are aligned and both bolts are fully engaged within the cutouts, slide the saddlebag support as far forward as possible to lock each of the support bolts into position.
6. Torque the support hardware to 27 ft-lbs (36.6 Nm)
7. Repeat steps 3 through 6 for the remaining saddlebag fender support.
8. Starting with the left side, remove the lock nuts from bolts previously installed in step 2. These were installed to hold the 3/8-16 bolts in place in the fender-support spacers.
9. See Figure 16. With the horizontal ledge of the left saddlebag-support plate (Part Number 68364-00) facing outward (away from motorcycle), install the plate with washer (Part Number 6701) and lock nut. Use a wrench to keep bolt heads from turning. Torque the lock nuts to 27 ft-lbs (36.6 Nm).
10. On the right side, remove the lock nuts from the bolts previously installed in step 2.
11. See Figure 17. While aligning the right saddlebag support plate (Part Number 68363-00) oriented as shown, with three pressed-in nuts towards fender, install the plate with bolts, then fasten a washer (Part Number 6701) and lock nut to each bolt. Use a wrench to keep bolts heads from turning. Torque the lock nuts to 27 ft-lbs (36.6 Nm).
12. See Figure 18. Install the rear support bar (Part Number 68367-00), from this kit, to span from the inside of one saddlebag support plate, over the license-plate bracket (between the bracket and fender), to the other support plate. The holes in the support-bar plates must align with the holes in both left- and right-side saddlebag-support plates.
13. Fasten the left saddlebag-support plate and left support-bar plate using a washer (Part Number 6701) and bolt (Part Number 2879W), and washer (Part Number 6701) and lock nut (Part Number 7778). Snug the nut, but do not tighten fully at this time.
14. Repeat step 13 for the right side.
15. Adjust the support bar to run parallel with the rear fender and the top of the license-plate bracket. Torque the nuts to 27 ft-lbs (36.6 Nm).

CAUTION

All carriage bolts, two per side, must be fully engaged forward into the keyhole slots in the vehicle, and tightened securely. If the carriage bolts are not fully engaged, the saddlebags may become loose, rattle, and cause damage to the vehicle, saddlebags, or personal property.

WARNING

All saddlebag support-plate bolts, fastening support plates to saddlebag fender supports, must be tightened securely with the threaded portion of the bolt protruding beyond the nylon locking area of the locknut. If support-plate bolts are not tightened securely, the saddlebag support may become loose, which could result in loss of control of the vehicle and death or serious injury.

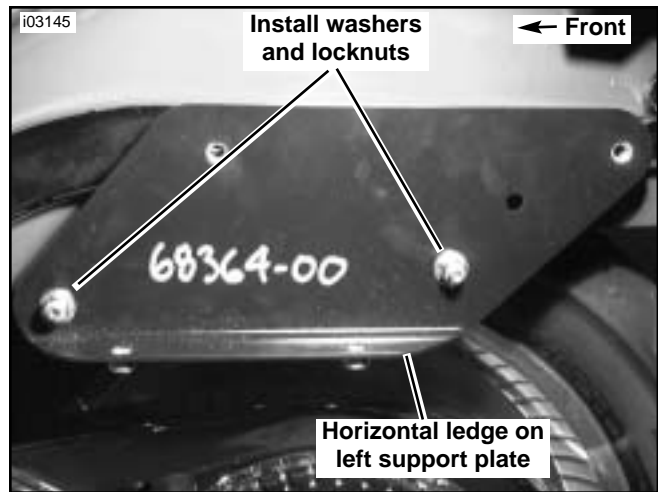

Figure 16. Left Saddlebag Support-Plate Installation

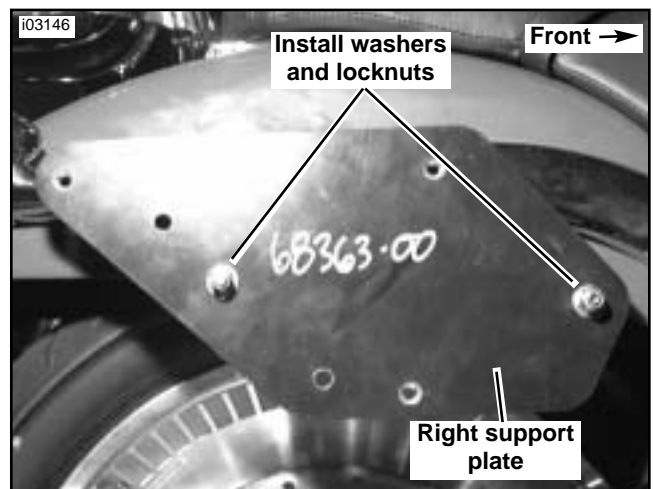

Figure 17. Install Right Saddlebag Support Plate

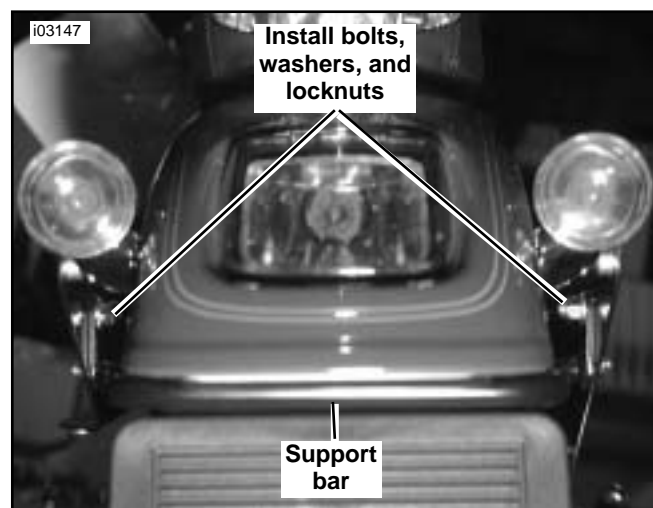

Figure 18. Rear Support-Bar Installation

Install Leather Saddlebags (Part Number 90404-00)

1. See Figure 19. Align the saddlebag mounting slots, on the left saddlebag (Part Number 90405-00) from this kit, with the pressed-in nuts on the saddlebag-support plate. Align the two slots on the inside of the saddlebag with the vertical portion of the saddlebag plastic back, and two slots with the horizontal ledge.
2. Install a hex cap screw (Part Number 2851) and a hardened washer (Part Number 6519) on each of the four mounting locations. Finger-tighten all four cap screws first to insure proper thread engagement, then snug all four, starting with the two on the horizontal ledge.
3. Tighten all four cap screws, being careful not to deform the plastic. Torque the screws to 15 ft-lbs (20.3 Nm) maximum.
4. See Figure 20. Repeat steps 1 through 3 for the right-side saddlebag. The right-side saddlebag has only three mounting locations, all on the vertical portion of the saddlebag plastic back. Finger-tighten all three cap screws first, then snug all three. Torque the screws, being careful not to deform the plastic, to 15 ft-lbs (20.3 Nm) maximum.

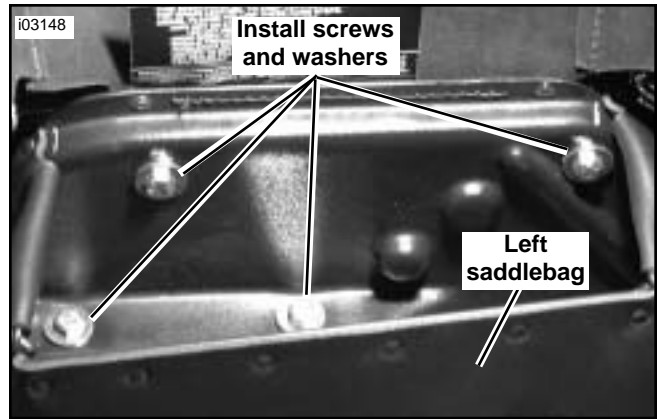

Figure 19. Install Left Saddlebag to Support Plate

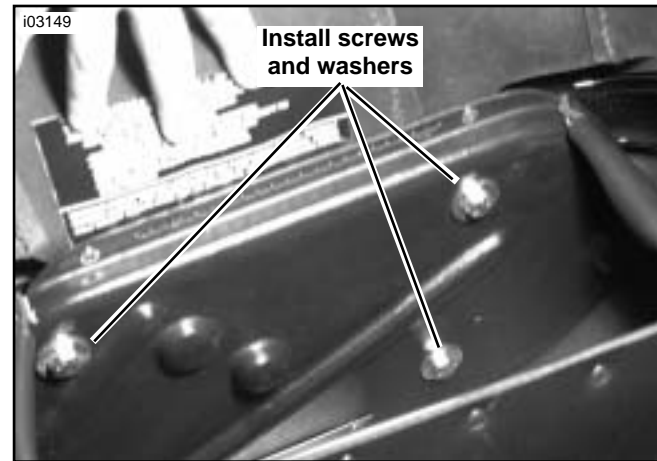

Figure 20. Fasten Right Saddlebag to the Support Plate

Install Reflectors

NOTE

In the next step, red reflectors are provided to meet Domestic requirements. For International installations, do not install reflectors on saddlebags.

WARNING

Federal Motor Vehicle Safety Standard (FMVSS) 108 requires all motorcycles to be equipped with side reflectors. The mounted saddlebags will cover the factory installed reflectors on some vehicles. Install, or have Dealer install, the reflectors supplied with the saddlebags. Loss of visibility to other motorists could result in an accident and death or serious injury.

1. See Figure 21. Locate the area at the corner section of the saddlebag where threads intersect. Install the reflector approximately 1 inch toward the front of the vehicle from the back corner and approximately 1/2 inch down from the top of the corner.
2. Use isopropyl alcohol to thoroughly clean the area in which reflector is to be installed. Let dry completely. Remove the adhesive backing and install the reflector. Apply pressure to the reflector for one minute. Repeat for the remaining saddlebag. Let adhesive cure for 24 hours.

WARNING

Always connect the positive battery cable first. If the positive cable should contact ground with the negative cable installed, the resulting sparks may cause a battery explosion resulting in death or serious injury.

3. Connect the battery cables, positive cable first.
4. Install the seat.

WARNING

After installing seat, pull upward on front of seat to be sure it is locked in position. If seat is loose, it could shift position during vehicle operation and startle the rider causing loss of control of vehicle and death or serious injury.

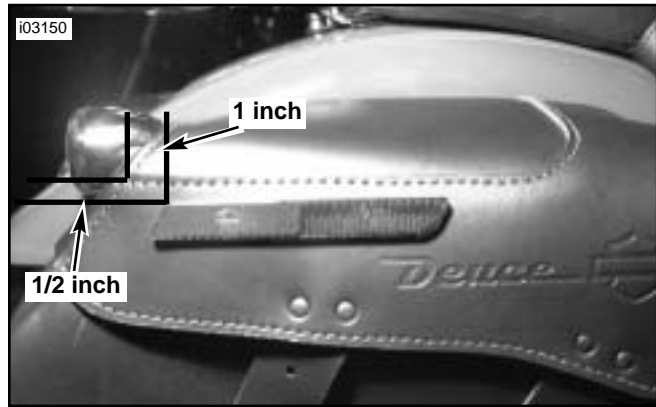

Figure 21. Reflector Installation

Special Care Instructions

The 100th Anniversary Medallion is chrome plated, with paint filled accents and a special hologram surface on the Harley-Davidson "Bar and Shield".

CAUTION

To prevent damage to the medallion surface, do not use any detergents, chemical solvents, polishes or abrasive cleaning agents.

To keep this surface in best condition, lightly wipe with a Harley-Davidson Micro Fiber cloth, part number 94663-02, using clear water or a mild Harley-Davidson cleaner such as:

- Sunwash (part number 94659-98),
- Bug Remover (part number 94657-98) or
- Harley Gloss (part number 94627-98).

NOTE

These cleaners are available separately or as part of the Harley Care Starter Kit, part number 94671-99 from your Harley Davidson Dealer.



Service Parts

Part No. 92018-03

Date 4/02

100th Anniv. Deuce Leather Saddlebag Kit

i03153.tif

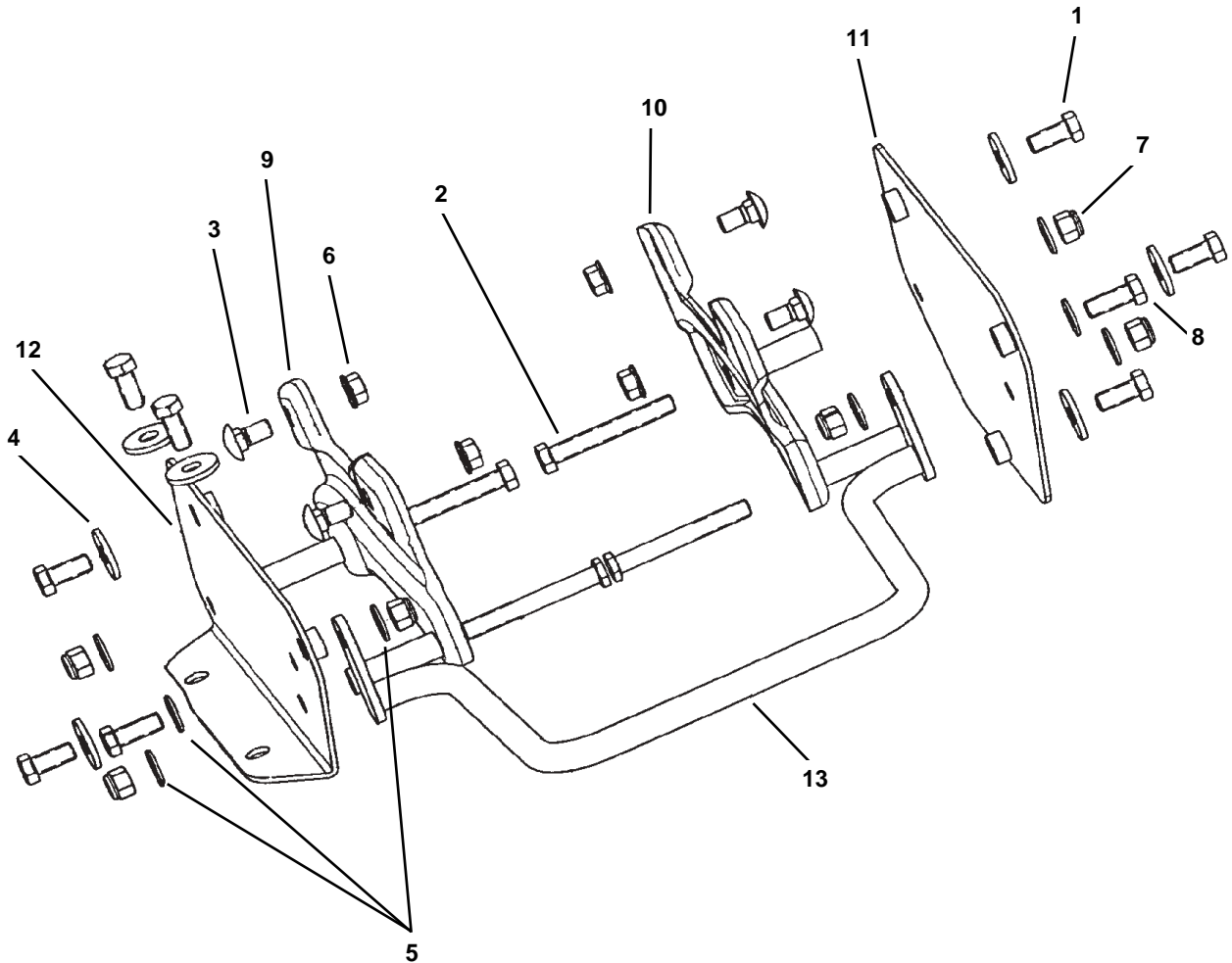

Saddlebag Support Kit (Part Number 68360-00)

Item	Description (Qty.)	Part No.	Item	Description (Qty.)	Part No.
1	Screw, hex cap 3/8-16X.88" (7)	2851	8	Screw, hex cap 3/8-16x1" (2)	2879W
2	Screw, hex cap 3/8-16x3" (4)	4205	9	Fender support, saddlebag (left)	68361-00
3	Bolt, round head carriage (4)	5418	10	Fender support, saddlebag (right)	68362-00
4	Washer, hardened (7)	6519	11	Support plate, saddlebag (right)	68363-00
5	Washer, 3/8" plain Type A (8)	6701	12	Support plate, saddlebag (left)	68364-00
6	Nut, flange 3/8-16 (4)	7601	13	Rear Support bar	68367-00
7	Nut, lock 3/8-16 w/nylon insert (6)	7778			



Service Parts

Part No. 92018-03

Date 4/02

100th Anniv. Deuce Leather Saddlebag Kit

i03151

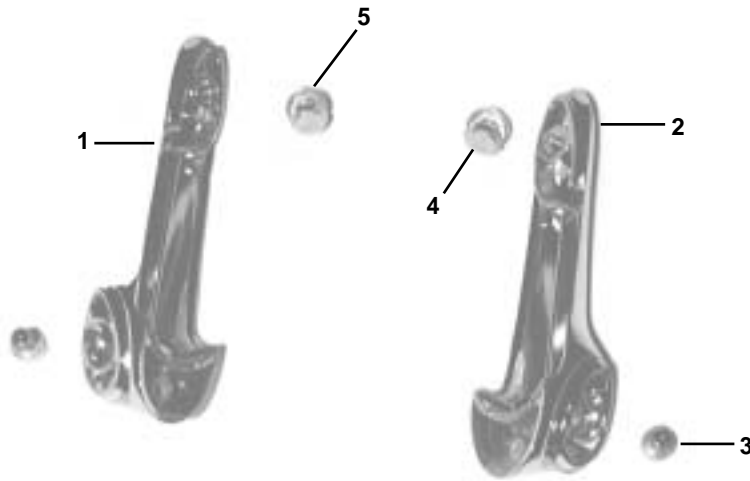

Directional Relocation Kit (Part Number 90395-00)

Item	Description (Qty.)	Part No.
1	Standoff, directional relocation (left)	not sold
2	Standoff, directional relocation (right)	not sold
3	Screw, hex socket head cap (2)	3531A
4	Screw, hex cap (2)	3929
5	Washer, plain Type A (2)	6702

i03152

Right Saddlebag shown

Rear View

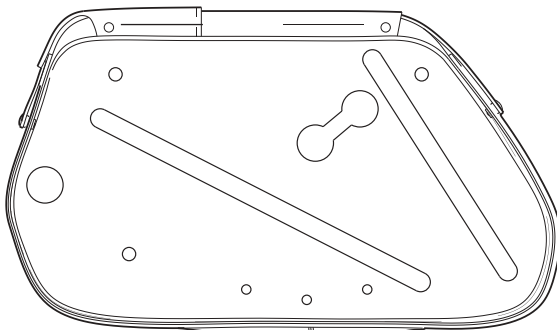

Front View

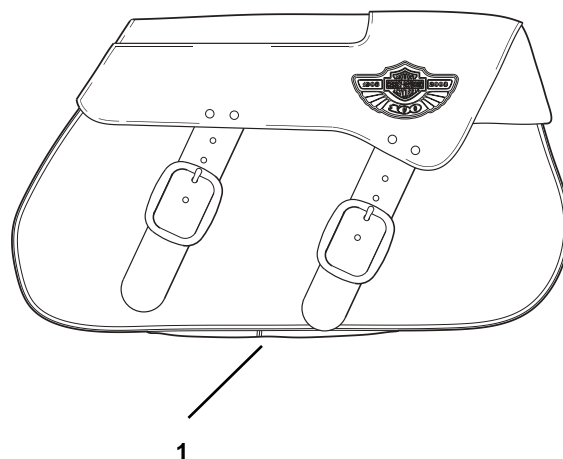

Leather Saddlebag Kit (Part Number 90404-00)

Item	Description (Qty.)	Part No.
1	Leather saddlebag left (not shown)	92019-03
2	Leather saddlebag right	92020-03
3	Reflector, red right (not shown)	59287-92
4	Reflector, red left (not shown)	59288-92
5	Leather care kit (not shown)	not sold