



INSTRUCTIONS

-J02623

REV. 11-03-2003

Kit Number 69604-03

HEADLAMP DOOR (TRIM RING) KIT

General

This kit fits 1983 and later Touring models (except Tour Glide and Road Glide), and 1986 and later FLST, FLSTC, FLSTN and FLSTF models equipped with the Chrome Headlight Nacelle Kit, H-D Part Number 67907-96.

These parts are the same as those used as original equipment on 2003 and later FLHR models, including 2003 FLHRSEI².

See the Service Parts illustration for a list of the kit contents.

Installation

1. See the Service Parts illustration. Remove the Phillips screw securing the original headlamp door and set aside.
2. Pull the bottom of the headlamp door away from the nacelle, then lift upward to disengage the top spring from the slot in the headlamp assembly.
3. See Figure 1. If not already in place, fit the new spring (2) into the new headlamp door (1), directly opposite the mounting hole. Fit the two ends of the spring into the large diameter lip on the back of the headlamp door, with the tab facing as shown in Figure 1 (toward the mounting hole).

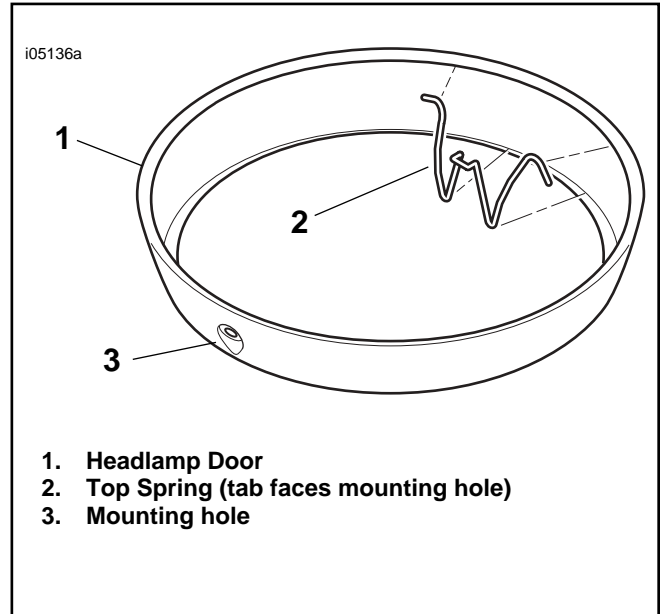

Figure 1. Top Spring Installation

4. With the headlamp door under the nacelle center trim strip, insert the spring tab into the slot in the headlamp assembly. Press downward slightly, and move the bottom of the headlamp door toward the nacelle.
5. Insert the Phillips screw removed in Step 1, and tighten securely.



Service Parts

Part Number 69604-03

Date 11/03

Headlamp Door

Item	Description/Qty	Part Number
1	Door, Headlamp	Not sold separately
2	Top Spring	67720-03A
3*	Original equipment screw	
4*	Nacelle	

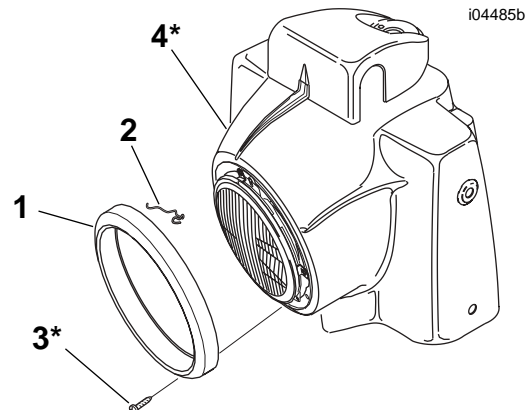

*Items marked with an asterisk are stock (original equipment) items.