



# INSTRUCTIONS

-J03048

REV. 11-20-2003

Kit Number 52714-04

## CHROME PASSENGER FOOTBOARD SUPPORT KIT

### General

This Chrome Passenger Footboard Support Kit fits all 1996 and later Touring model motorcycles. It is a direct replacement for the standard equipment passenger footboard supports or footpeg brackets.

Models not already so equipped will also require passenger footboards, available separately at any Harley-Davidson dealer.

Ask your Harley-Davidson dealer about the selection of operator and passenger footboards and inserts that are available for these models. These items can be easily installed at the same time as this kit.

See the Service Parts illustration on Page 2 of these instructions for kit contents.

### Removing Passenger Footpegs

1. Remove and discard the socket screw and lock washer attaching the existing footpeg bracket to the rear swing arm bracket. Proceed to Step 5.

### Removing Passenger Footboard Supports

1. **For standard footboard 50613-91:** See the Service Parts illustration. Tilt the footboard to the "up" position. Remove the underside chrome footboard covers if so equipped.

From the bottom of the footboard, use a small flat-blade screwdriver to push the rubber beads on the pad up through the holes in the footboard pan. Remove the pad.

**For swept-wing (FLHRS- and FLHTCSE-style) footboards:** With the passenger footboard in the "down" position, carefully raise an outside "corner" of the stock footboard insert off the footboard pan with a suitable flat-bladed tool, taking care to avoid scratching the chrome footboard pan.

Continue around the edge of the footboard, using a second flat-bladed tool if necessary to pry up and remove the old insert.

2. Using a brass drift and rubber mallet, tap one pivot pin (6) out of the pivot hole into the center pocket of the footboard pan, remove the pin and set it aside. Repeat for the second pin.
3. Remove the footboard from the support bracket (1). Remove and discard the steel ball (5) and spring (4) from the hole in the bracket.
4. Remove and discard the socket head screw (2) and lock washer (3) attaching the footboard support bracket to the rear swing arm bracket. Proceed to Step 5.

### Installing the New Footboard Supports

#### NOTE

*Three holes are available in the rear fork brackets for footboard support mounting. Depending on model and year, the footboards can be installed in any of two or three positions for passenger comfort. A plastic plug, inserted in the upper hole at the factory, can be removed.*

5. See the Service Parts illustration. Position a new chrome footboard support (1) against the swing arm bracket at the desired height. The left and right supports are identical.

With the locating peg on the footboard support in the next lower hole, fasten the support with a hex socket screw (2) and lockwasher (3) from the kit. Tighten the screw to 15-18 ft-lbs (20-24 Nm).

6. Place the new spring (4) into the retaining hole in the footboard support. Rest the detent ball (5) on top of the spring.

#### NOTE

*Install swept-wing (FLHRS- and FLHTCSE-style) footboards with the Bar-and Shield logo toward the front.*

7. Position the new or previously removed passenger footboard pan onto the support, in the down position, being careful not to unseat the ball.
8. Align the pivot pin holes, and install the new pivot pins (6) from the outboard side. Using a brass drift and rubber mallet, tap the pins inward until centered in the lugs of the support bracket.

Check to ensure that the ball is seated in the detent on the underside of the footboard pan.

9. **For standard footboard 50613-91:** Apply liquid dishwashing soap to the rubber beads on the underside of the pad to ease installation. Place the pad into position on the footboard pan. From the bottom of the footboard, use needle nose pliers to pull the rubber beads down through the holes in the footboard.

Press the rubber protrusions into the footboard cavities. Make sure the pin ends are seated in the recesses of the rubber pad, and also that the rubber extensions (at the extreme outer edges of the pad) are seated in the outside pin holes in the footboard.

**For swept-wing (FLHRS- and FLHTCSE-style) footboards:** Apply liquid dishwashing soap to the rubber nipples, dowels and pivot pin holes on the insert.

Place the insert into position on the footboard pan. Firmly grasp the hinge side of the footboard and press with both hands to insert the dowels into the mating holes in the footboard pan.

10. Pivot the footboard up and down to verify proper action. Repeat all steps for the other side.
9. **For HDI applications:** Tilt the passenger footboard to the "up" position. Remove the backing paper from the adhesive side of one of the bumpers (7).

Center the bumper on the outboard surface of the footboard support, lining up the top of the center notch with the center depressed area on the support (see the Service Parts illustration). Press the bumper into place.

Wrap the tabs around the front and rear of the support, avoiding the pivot pin holes, and press into place.

Repeat for the opposite side.



# Service Parts

Part No. 52714-04

Date 11/03

Chrome Passenger Footboard Supports

i02458a

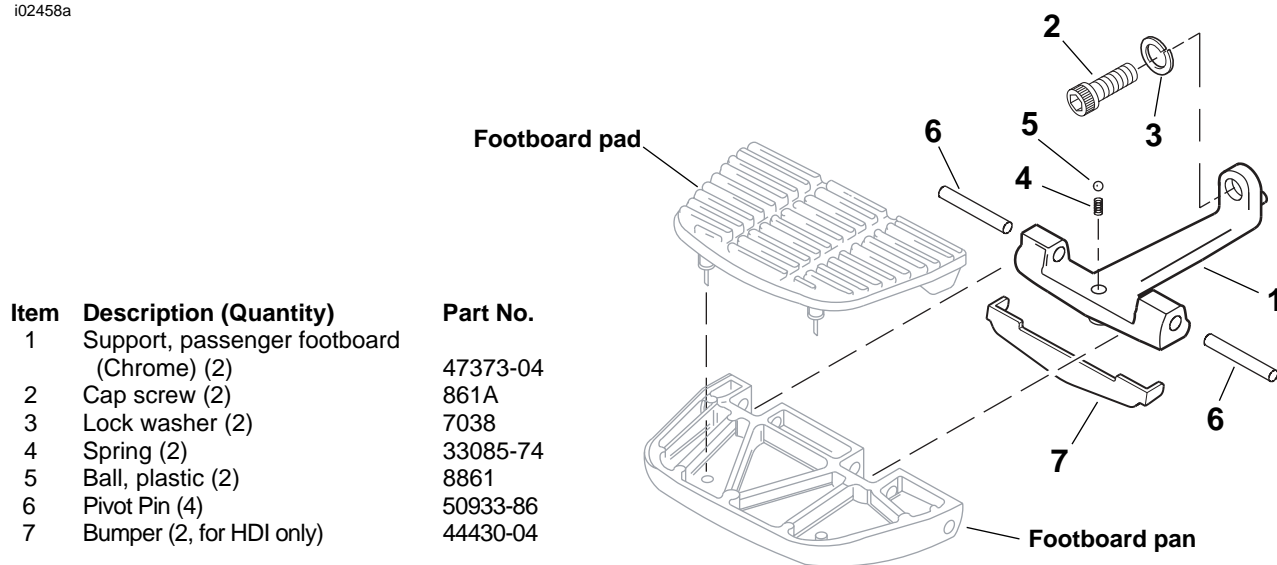

Item	Description (Quantity)	Part No.
1	Support, passenger footboard (Chrome) (2)	47373-04
2	Cap screw (2)	861A
3	Lock washer (2)	7038
4	Spring (2)	33085-74
5	Ball, plastic (2)	8861
6	Pivot Pin (4)	50933-86
7	Bumper (2, for HDI only)	44430-04