



INSTRUCTIONS

-J01890

REV. 02-28-2005

Kit Number 91370-00, 91412-04

SPORTSTER SADDLEBAG KIT

General

These saddlebags are designed to fit 1994 and later Sportster Model Motorcycles, except XL1200 Sport models with gas reservoir shock absorbers and 883R models.

See the Service Parts pages for a list of the kit contents.

NOTE

Installation of this Saddlebag Kit on Sportster Models equipped with Detachable Docking Hardware requires the separate purchase of a Hardware Kit. 1994-2003 models must purchase hardware kit 91385-00 and 2004 and later models must purchase hardware kit 91405-04. These kits are available for purchase at your Harley-Davidson Dealer.

WARNING

Additional weight can affect motorcycle stability, handling characteristics, and safe operating speed. Do not exceed 7 lbs. (3.18Kg) maximum load in each saddlebag. Evenly distribute weight between each saddlebag. Improper loading can cause vehicle handling problems leading to death or serious injury.

Initial Installation Steps

NOTE

A Service Manual for your vehicle is available at your Harley-Davidson Dealer.

1. Remove the seat following Service Manual procedure.

WARNING

To prevent accidental vehicle start-up, which could cause death or serious injury, disconnect negative (-) battery cable before proceeding. (00048a)

WARNING

Disconnect negative (-) battery cable first. If positive (+) cable should contact ground with negative (-) cable connected, the resulting sparks can cause a battery explosion, which could result in death or serious injury. (00049a)

2. Disconnect battery cables, negative cable first.

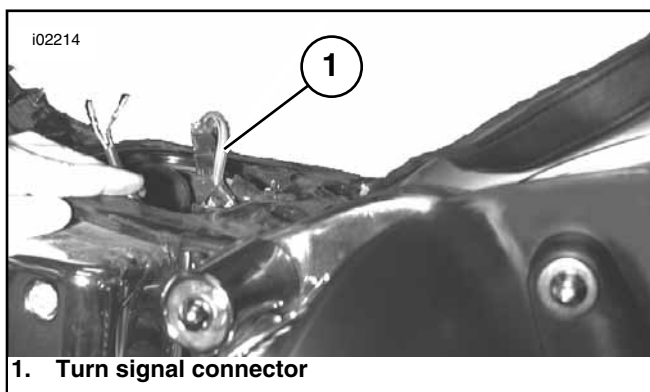

1. Turn signal connector

Figure 1. 8-Place AMP Connector (1999 and Later Models)

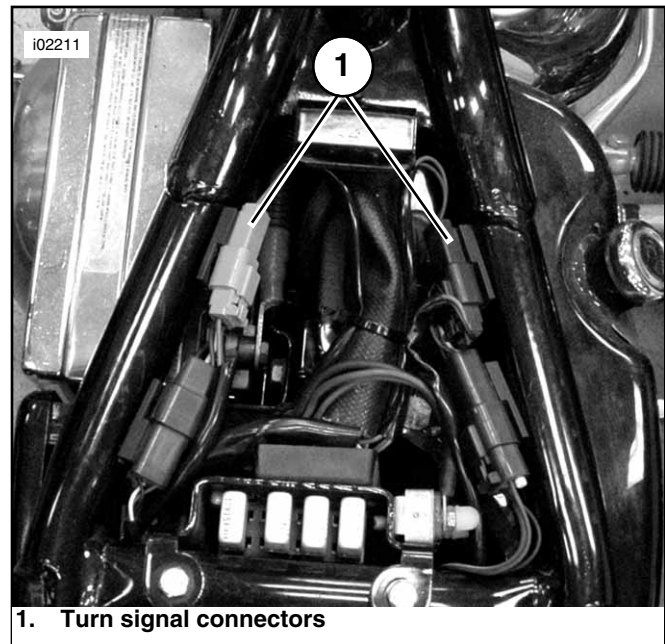

1. Turn signal connectors

Figure 2. 2-Place Deutsche Connectors (1994-1996 Models)

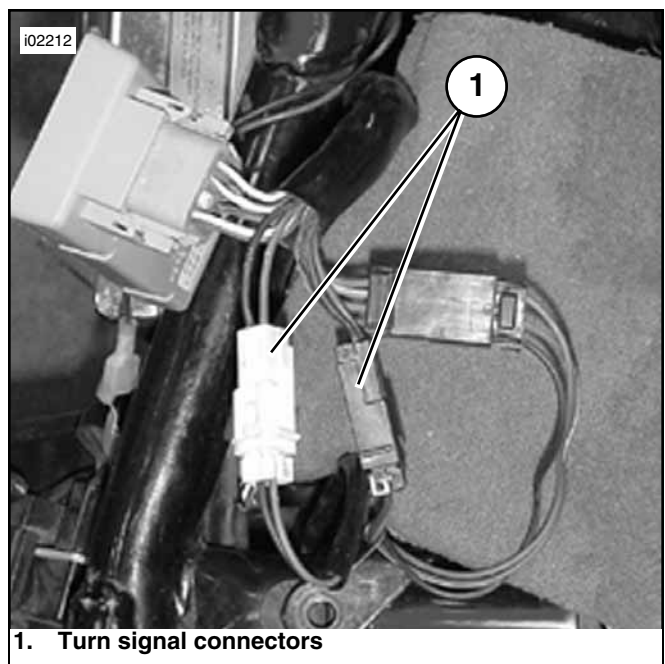

1. Turn signal connectors

Figure 3. 2-Place AMP Connectors (1997 and 1998 Models)

Remove Turn Signal

3. See Figures 1, 2 and 3. Refer to the Appendix covering Amp and Deutsche Electrical Connectors in the applicable Service Manual and locate left and right signal wiring at turn signal connector (1) under seat.

Unplug the connector and, following instructions in Service Manual, remove terminals from connector.

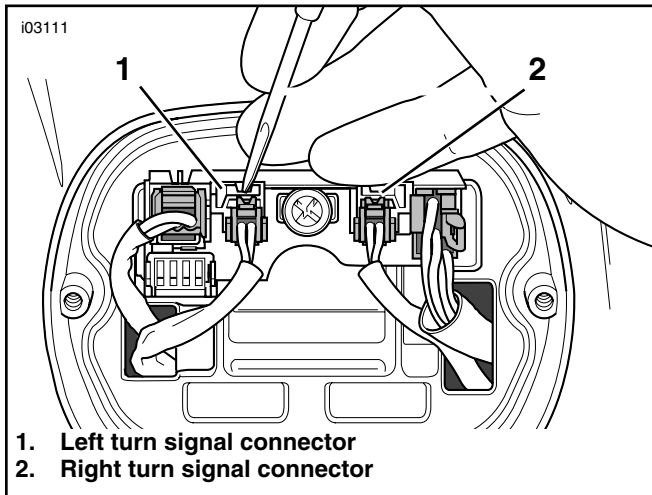

Figure 4. Disconnect Turn Signals at Tail/Stop Lamp (2000 Shown)

4. **1994-1998 models:** Pull turn signal wires through clips (if present) under fender.

1999 and later models: Perform the following:

- Remove two screws securing tail/stop lamp lens assembly and remove lens assembly.
- See Figure 4. Disconnect left (1) and right (2) turn signal (two places) connectors from sockets. Cut wires at connector as close to terminal end as possible. Discard connectors and terminals.
- Gently pull wiring for both turn signals out (from tail/stop lamp assembly and from clip under rear of fender).
- Reattach tail/stop lamp lens using two screws removed in Step a.

5. See Figure 5. Remove the rear turn signals as follows:

Remove the signal lamp assembly by removing the bolt (1) inside of the rear fender. Remove the lamp housing (2) from the bracket and pull the wiring through the bracket. Repeat for the opposite side. Discard the lamp brackets (3).

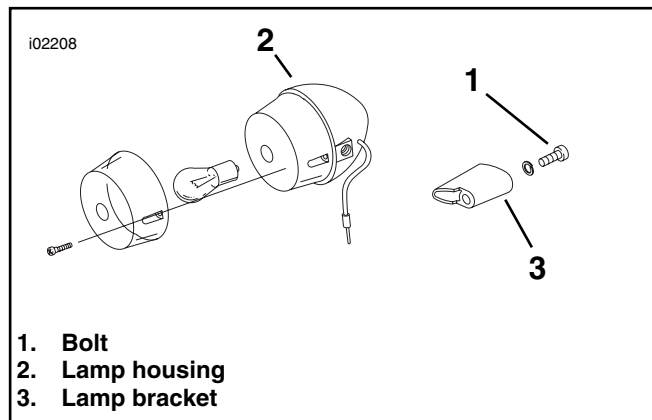

Figure 5. Rear Turn Signal Mounting Hardware

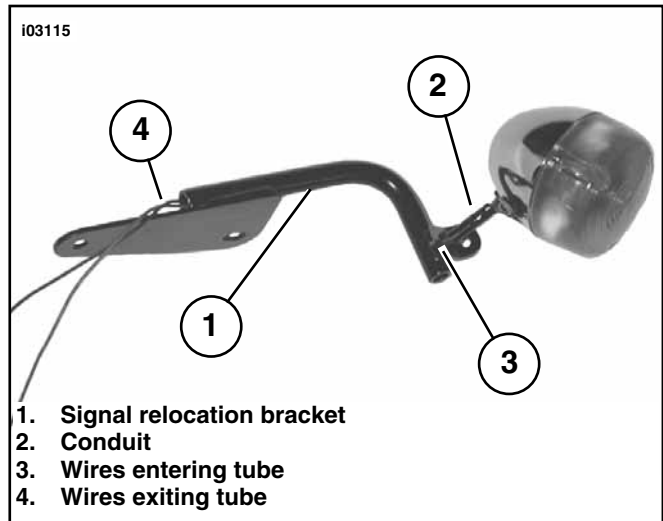

Figure 6. Install Wiring and Conduit into Bracket

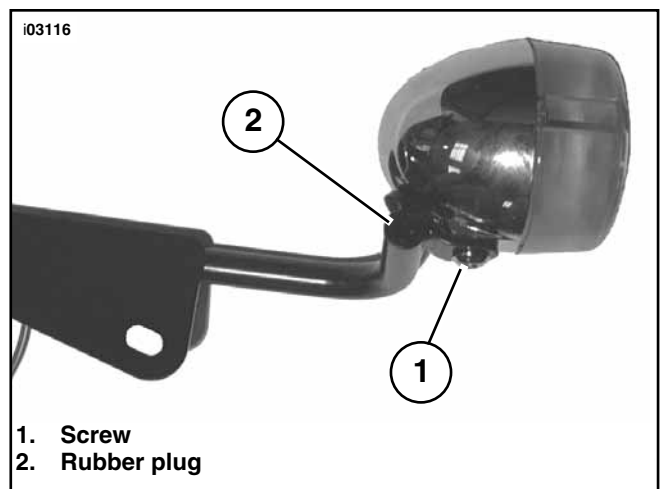

Figure 7. Installing 3 inch Signal Lamps (Standard Style)

Attach Turn Signal to Bracket

6. If installing 3 inch (Standard Style) Signal Lamps, proceed to step 7.

If installing 2-3/8 inch (Deuce Style) Signal Lamps, proceed to step 8.

7. **Standard Style Signal Lamps** See Figure 6. Obtain left signal lamp housing removed in previous step and left turn signal relocation bracket (1)(Part Number 90139-00). Remove conduit (2) and cut wiring 12 inches from entrance to lamp housing. Moisten wires with wet paper towel or rag and insert wires through relocation bracket (3) as shown until wires exit from opposite end of tube (4). Slide conduit down to protect wiring at wire entrance of relocation bracket.

See Figure 7. Apply LOCTITE 243 (Blue) to screw (1) (Part Number 3538). Using screw and lock washer (Part Number 7042), attach lamp to signal relocation bracket as shown. Tighten securely. Repeat step 7 for the opposite signal.

8. **Deuce Style Signal Lamps:** See Figure 6. Obtain left signal lamp housing and left turn signal relocation bracket (Part Number 90139-00). Cut wiring 12 inches from entrance to lamp housing. Moisten wires with wet paper towels or rag and insert wires through relocation bracket as shown until wires exit from opposite end of tube.

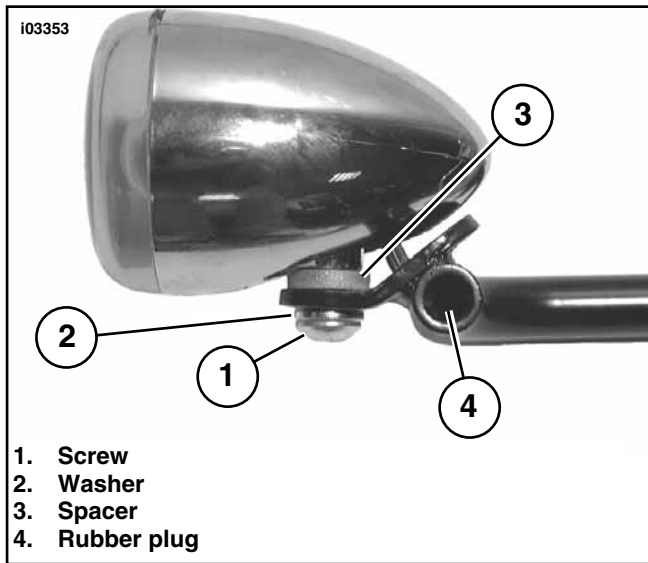

Figure 8. Installing 2-3/8 inch Signal Lamps (Deuce Style)

See Figure 8. Apply LOCTITE 243 (Blue) to screw (Part Number 4092). Using screw (1), lock washer (2) (Part Number 7042) and spacer (3) (Part Number 65849-01), attach lamp to signal relocation bar as shown. Spacer should be installed between signal and signal relocation bracket. Tighten securely. Repeat step 8 for the opposite side. Install rubber plug (4) over opening.

9. See Figure 6. Install small black rubber plug (2) (Part Number 53644-00) to cover opening of tube on bracket. Repeat for other side.
10. Obtain Wiring Harness (Part Number 70468-00) from kit. Pull the two wires out of the conduit. Terminals are attached to both ends of the wires to support all models.

NOTE

Before removing terminals you do not need, temporarily attach the correct terminals to the turn signal connector under the seat.

Note the yellow tape on the wires.

1994-1996 models: Remove the terminals farthest away from the yellow tape.

1997 and later models: Remove the terminals closest to the yellow tape.

NOTE

Cutting one of the wires slightly shorter before installing connectors will "stagger" the location of the butt splices and make sliding conduit over wiring much easier.

11. See Figure 9. Obtain two sealed butt connectors (1) (Part Number 70585-93) from kit. Following instructions in Service Manual under "Installing Sealed Butt Connectors", match wire colors and splice wiring from turn signal to harness. Install butt connectors in a staggered pattern so conduit will tightly fit over wires. Slide conduit (2) from harness over butt splices and approximately 2" into bracket tube.
12. See Figure 10. Obtain three adhesive backed wire harness retaining clips (1)(Part Number 10102). Remove adhesive and install clips under fender strut (2) at locations as shown.

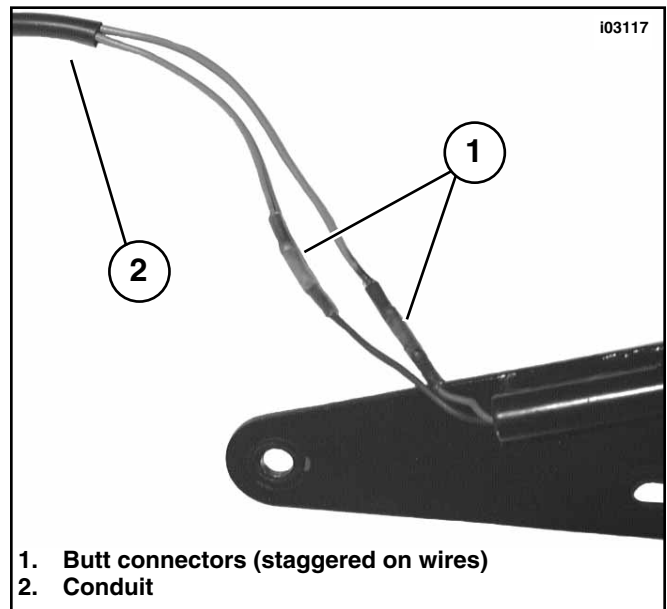

Figure 9. Install Wiring Harness

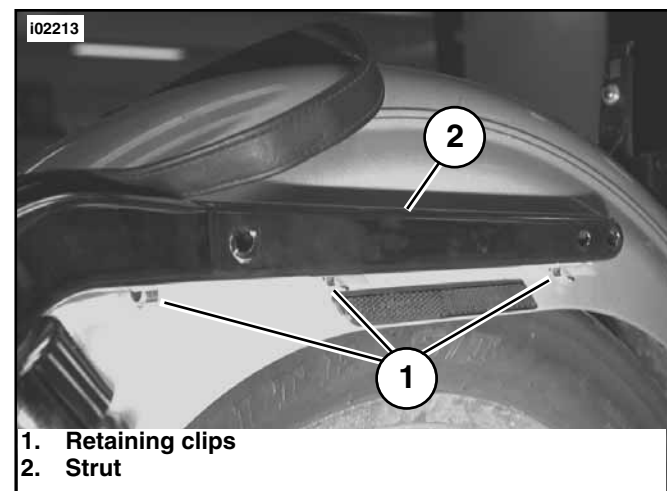

Figure 10. Install Wire Harness Retaining Clips

NOTE

Repeat Steps 6 through 12 for the right turn signal. Set both turn signals aside.

Install Support on Saddlebag

NOTE

To protect the finish on the saddlebag, lay it on a towel or other soft covering on your workbench.

13. See Figure 11. Obtain left saddlebag, four small grommets (1) (Part Number 90148-00) and one large grommet (2) (Part Number 11447). Install the large grommet in the upper hole and four small grommets in the four remaining holes in the saddlebag assembly as shown.
14. Install one large spacer (2) (Part Number 90149-00A) into the upper grommet and four small spacers (1) (Part Number 90186-00A) into the small grommets as shown.

NOTE

On 1994-2003 model motorcycles equipped with detachable docking points, you will need an additional hardware kit (part number 91385-00). This kit includes 4.25 inch screws (replacing 4.0 inch screws), 2.6 inch long hex spacers (replacing 2.1 inch

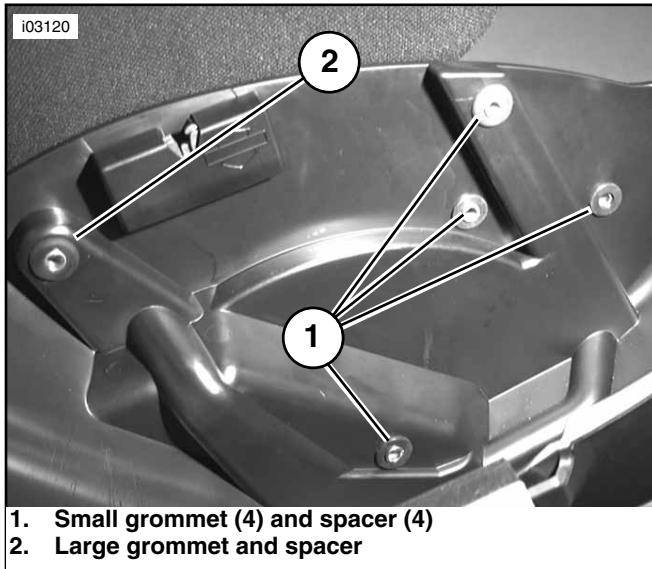

1. Small grommet (4) and spacer (4)
2. Large grommet and spacer

Figure 11. Install Grommets and Spacers

long hex spacers), and 0.5 inch long spacers to be installed between the saddlebag support and strut cover.

On 2004 and later model motorcycles equipped with detachable docking points, you will need an additional hardware kit (part number 91405-04). This kit includes 4.75 inch screws (replaces 4.0 inch screws), 2.85 inch long hex spacer (replaces 2.1 inch long hex spacer) and 0.75 inch long spacer to be installed between the saddlebag support and strut cover.

15. Starting at (1) in Figure 13, place a washer (Part Number 6254) on screw (Part Number 4288). Partially insert screw from inside the saddlebag. Locate a second washer (part number 6254) from the hardware kit. Use a dab of silicone or a piece of tape and position the washer on the screw. The silicone or tape will secure the washer to the saddlebag in preparation for later steps when the bag assembly is attached to the vehicle.
16. See Figure 12. Obtain left hand support (1) with channel (2) and turn signal support (3) attached.
17. See Figure 13. Position support (1) on saddlebag (2) and push screw all the way through channel (3).
18. Obtain screw (Part Number 4219), washer (Part Number 6254) and flange nut (Part Number 7531) and secure bottom attachment bracket (4, Figure 13) of saddlebag to support.
19. Obtain screw (Part Number 4118), washer (Part Number 6416), and hex spacer (Part Number 91394-00). Place washer on screw and insert from inside of the saddlebag (5, Figure 13). Temporarily hold in place by screwing on hex spacer.
20. See Figure 14. Obtain left turn signal (1) assembled previously. Insert screws (not shown) (Part Number 4219) and washers (not shown) (Part Number 6254) from inside saddlebag, through support (2), and through left turn signal bracket. Secure with flange nuts (3) (Part Number 7531).
21. Repeat Steps 13 through 20 for attaching the support to the right-hand saddle bag.

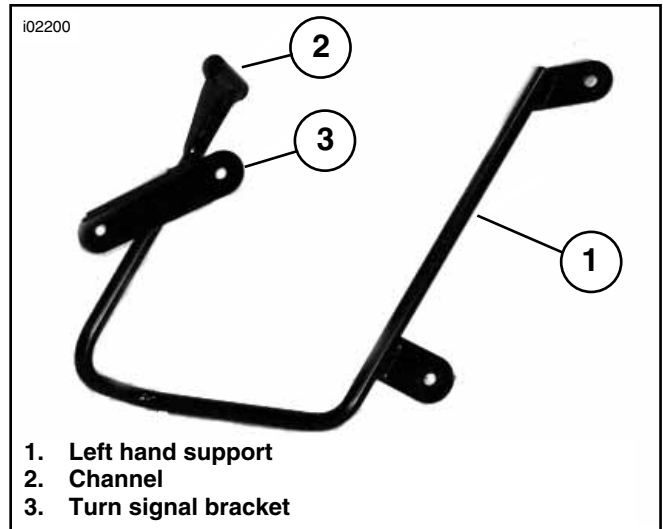

1. Left hand support
2. Channel
3. Turn signal bracket

Figure 12. Left Hand Support

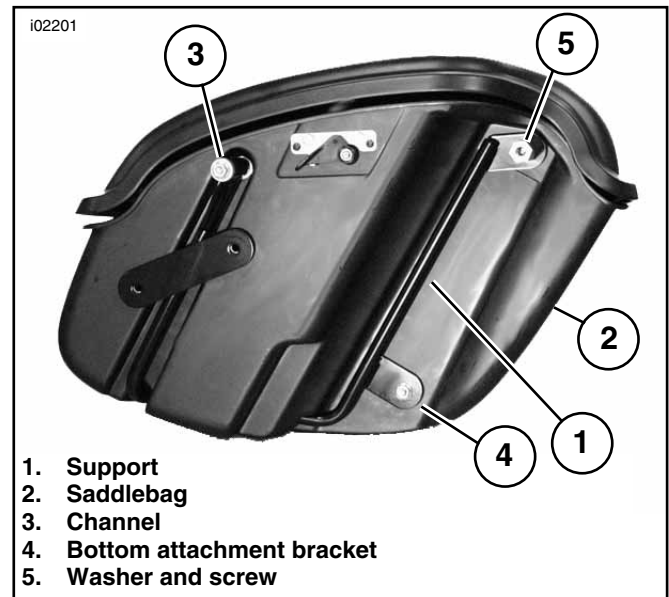

1. Support
2. Saddlebag
3. Channel
4. Bottom attachment bracket
5. Washer and screw

Figure 13. Support on Saddlebag

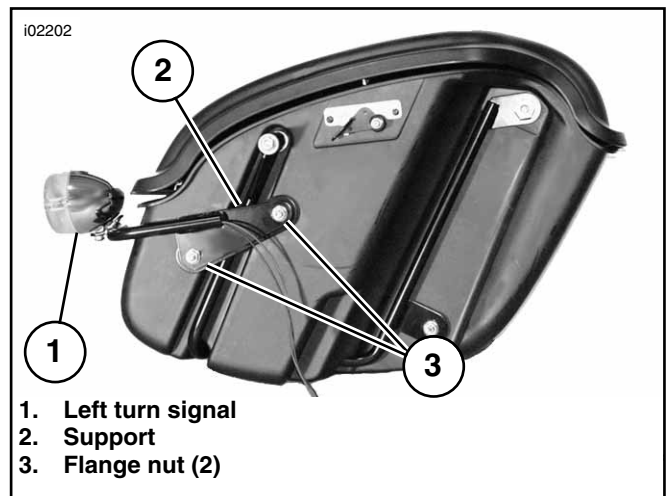

1. Left turn signal
2. Support
3. Flange nut (2)

Figure 14. Attach Turn Signal to Support

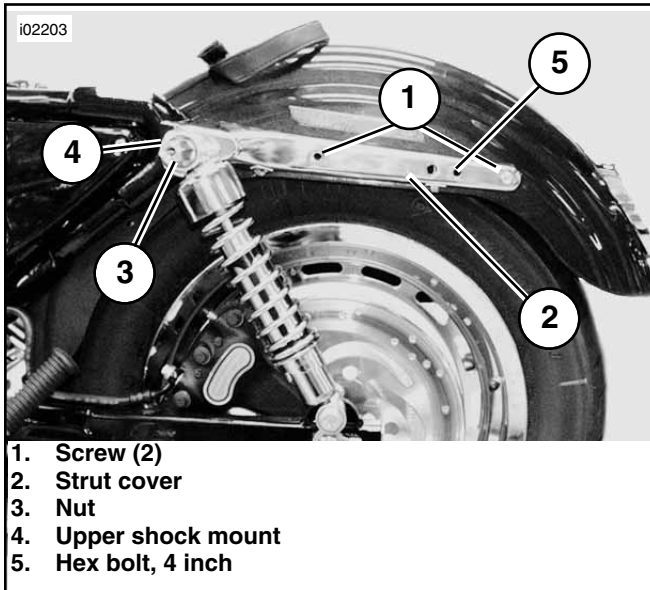

Figure 15. Removing Remaining Strut Hardware (2000 Shown)

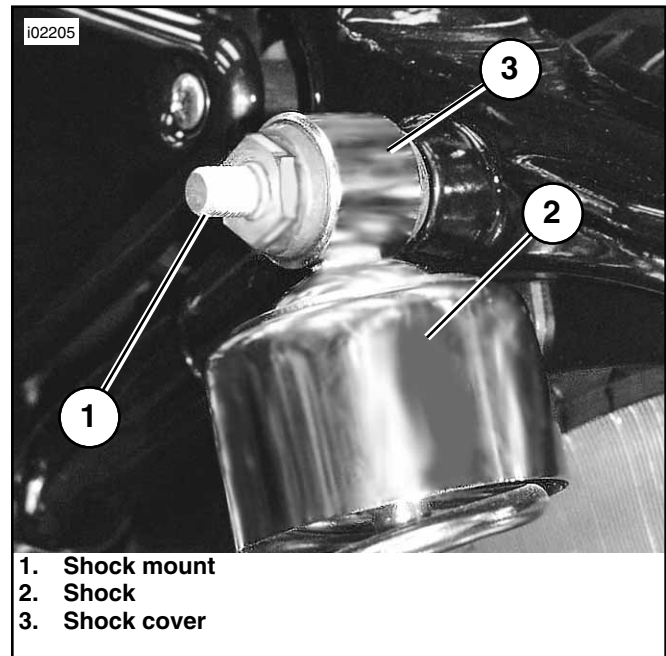

Figure 17. Reattach Shock

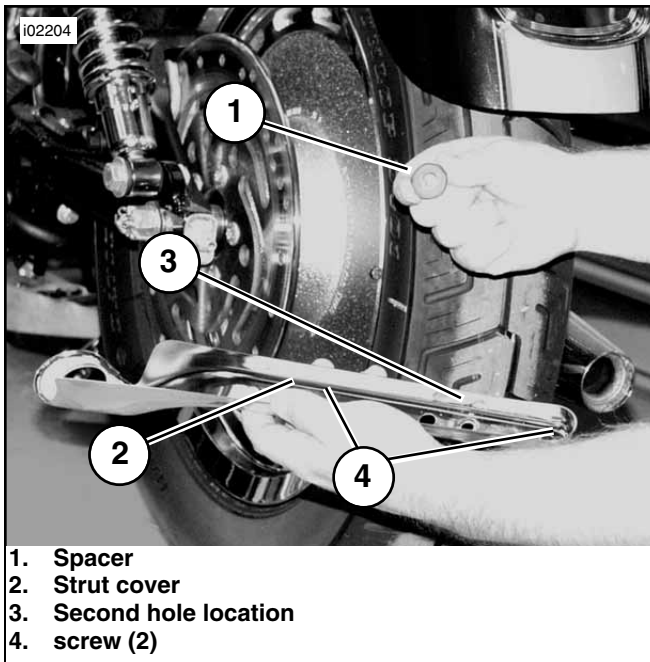

Figure 16. Place Spacer Inside Strut Cover

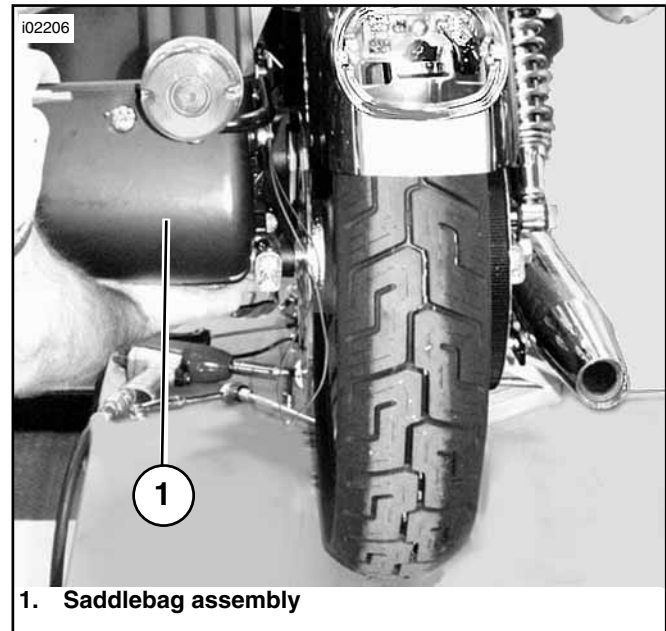

Figure 18. Position Saddlebag on Motorcycle

Install Saddlebag on Motorcycle

NOTE

When performing Steps 22 through 32, completely perform procedures for one side before continuing to the opposite side. This will ensure fender will remain supported during installation.

22. Raise the rear wheel off the ground and support the vehicle securely. Remove the left and right lower shock bolts so the rear wheel can be lowered to create clearance when installing the saddlebag mounting bolts.
23. See Figure 15. Remove remaining screws (1) (from inside fender) securing strut cover (2) to fender. **1994-1999 models:** Remove nut (3) holding upper shock mount (4). **2000 and later models:** Remove screw and cover from top of shock. Remove strut cover.

24. See Figure 16. Obtain spacer (1) (Part Number 5792) and strut cover (2). Install spacer on the inside of the strut cover on the second hole from rear of strut (3). Hold in place with a dab of silicone or piece of tape. Reattach cover to strut using two screws (4) removed in Step 22
25. See Figure 17. **1994-1999 models:** Apply Loctite 243 (blue) to the shock mount bolt. Remove hex spacer temporarily attached to saddlebag in Step 19 and screw it onto shock mount (1). Tighten to 21-35 ft-lbs (28-47 Nm).

2000 and later models: Put shock cover (3) and shock mount (1) (Part Number 47237-00) on top of shock (2). Apply Loctite 243 (blue) to shock mount. Tighten to 21-35 ft-lbs (28-47 Nm). Obtain hex spacer temporarily attached to saddlebag assembly in Step 19 and screw it onto shock mount. Tighten to 21-35 ft-lbs (28-47 Nm).

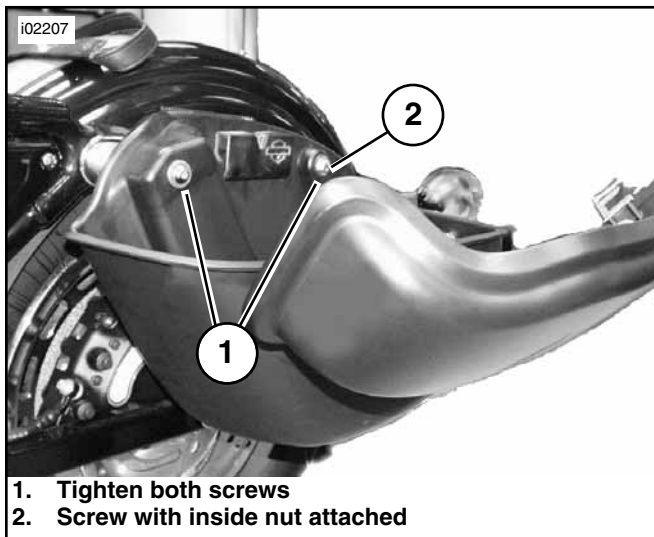

Figure 19. Saddlebag Attached to Motorcycle

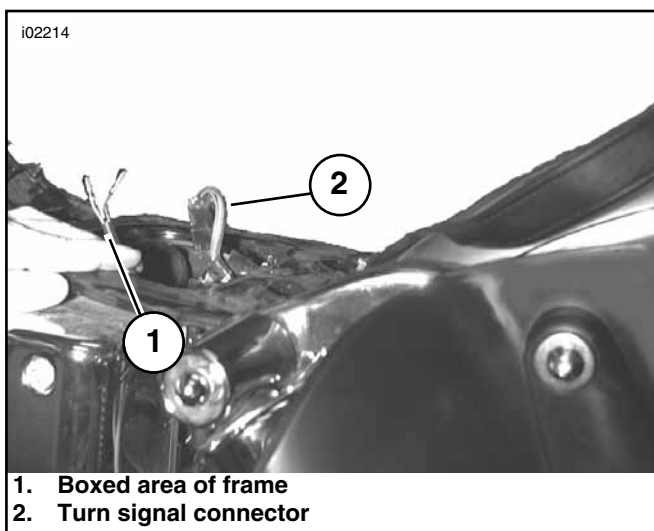

Figure 20. Route Wiring to Connector [7]
(2000 Shown)

26. See Figure 15. Remove the 4 inch hex bolt (5) (part number 4288) temporarily attached to the saddlebag in step 15. Insert bolt from the inside of the fender through the frame and fender strut in second hole from rear of strut as shown in Figure 15.
27. Add a drop of Loctite 243 to threads of bolt that is inserted through the saddlebag at the front location.
28. See Figure 18. Position saddlebag assembly onto motorcycle.

29. See Figure 19. Tighten both screws (1) to 27-29 ft-lbs (36.6-39.3 Nm) torque to attach saddlebag assembly to motorcycle. Use nut (not shown) (Part Number 8093) held inside saddlebag to attach screw (2). Use Loctite on threads. Torque to 23-25 ft-lbs (31.2 - 33.8 Nm). Slip vinyl cap (part number 91573-04) onto the exposed threads.
30. Route wiring harness from turn signal along bottom of strut and insert into retaining clips installed in Step 11. Bend clip tabs to hold wiring harness in place.
31. See Figure 20. Continue routing wiring harness under front of strut in front of fender and through middle boxed area of frame (1) to connector (2).
32. Following instructions in Service Manual, install pin terminals to respective cavities in turn signal connector [7].

Final Installation Steps

⚠ WARNING

Connect positive (+) battery cable first. If positive (+) cable should contact ground with negative (-) cable connected, the resulting sparks can cause a battery explosion, which could result in death or serious injury. (00069a)

33. Connect battery cables, positive cable first.
34. Install seat.

⚠ WARNING

After installing seat, pull upward on front of seat to be sure it is in locked position. While riding, a loose seat can shift causing loss of control, which could result in death or serious injury. (00070a)

⚠ WARNING

Be sure that all lights and switches operate properly before operating motorcycle. Low visibility of rider can result in death or serious injury. (00316a)

35. Check turn signals for proper operation.

⚠ WARNING

Keep tail lamp visible at all times. Do not place objects on license plate bracket blocking tail lamp visibility. Low visibility of rider can result in death or serious injury. (00123a)

36. Check tail lamp for proper operation.



Service Parts

Part No. 91370-00

Date 02/05

Sportster Saddlebag Kit

i02209

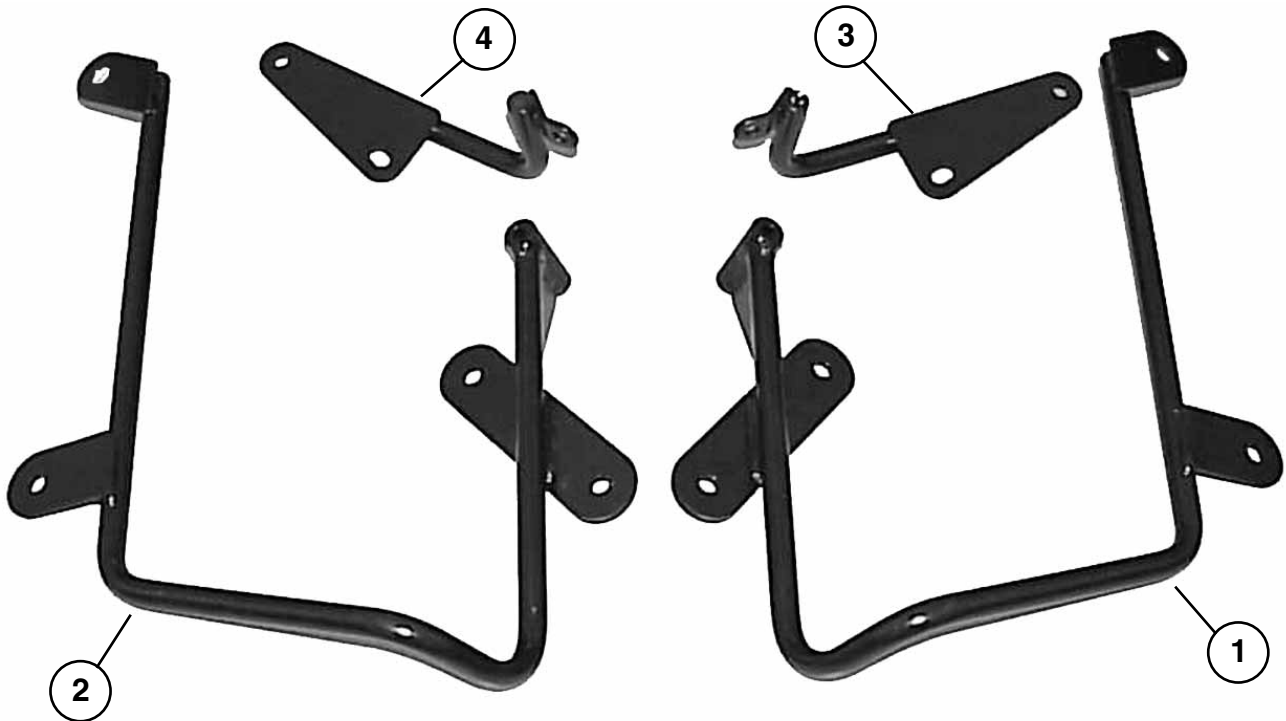

Mounting Bracket Kit 91383-00

Item	Description/Qty.	Part Number
1	Bracket, mounting right hand	91376-00
2	Bracket, mounting left hand	91377-00
3	Bracket, turn signal mounting right	90138-00
4	Bracket, turn signal mounting left	90139-00



Service Parts

Part No. 91370-00

Date 02/05

Sportster Saddlebag Kit

i02210a

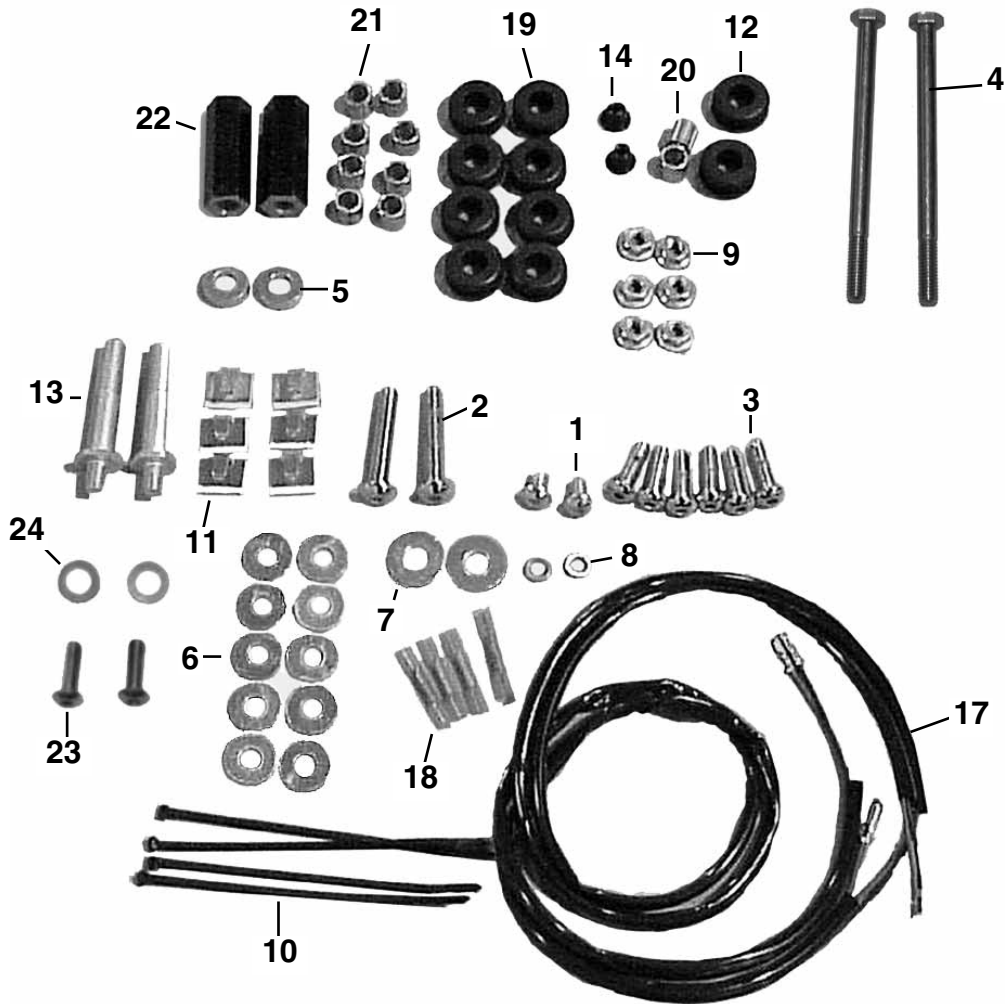

Hardware Kit (91457-00B)

Item	Description/Qty.	Part Number	Item	Description/Qty.	Part Number
1	Screw hex socket button (2)	3538	14	Polyurethane hole plug (2)	53644-00
2	Screw, button socket head (2)	4118	15	Vinyl cap, thread cover, <i>not shown</i> (2)	91573-04
3	Screw, hex socket button head (6)	4219	16	Hex nut, (2) <i>not shown</i>	8093
4	Screw, hex head (2)	4288	17	Harness, turn signal wire (2)	70468-00
5	Spacer (2)	5792	18	Connector, sealed butt (4)	70585-93
6	Washer, plain (10)	6254	19	Grommet (8)	90148-00
7	Washer, plain (2)	6416	20	Spacer (2)	90149-00A
8	Lockwasher, hi collar (2)	7042	21	Spacer (8)	90186-00A
9	Nut, flange locking (6)	7531	22	Spacer, hex	91394-00
10	Cable strap (4)	10065	23	Screw, 5/16x18x1 (2)	4092
11	Clip, adhesive (6)	10102	24	Spacer, .150 inch thick (2)	65849-01
12	Grommet (2)	11447	—	Loctite 243 (.5 ml) (not shown)	94635-98
13	Stud, shock mount (2)	47237-00			



Service Parts

Part No. 91370-00

Date 02/05

Sportster Saddlebag Kit

i05247

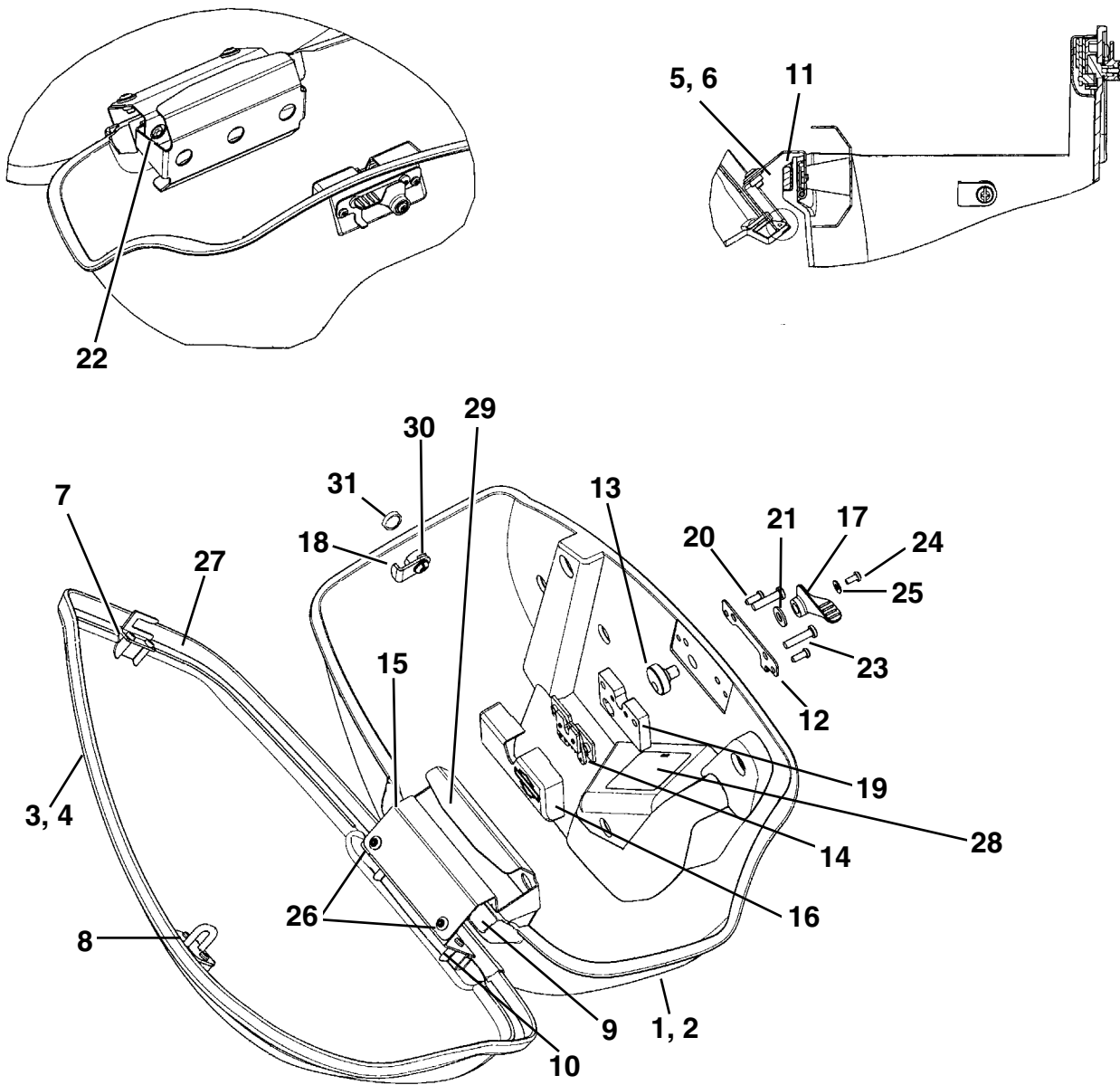

Saddlebag (Left) Part Number 91382-00

Saddlebag (Right) Part Number 91381-00

Item	Description/Qty.	Part Number	Item	Description/Qty.	Part Number
1	Saddlebag bottom, right hand	91371-00	16	Cover, latch	91391-00
2	Saddlebag bottom, left hand	91372-00	17	Lever, latch	91386-00
3	Saddlebag lid, right hand	91373-00	18	Lock assembly (set of 2)	91455-00
4	Saddlebag lid, left hand	91374-00	19	Cam block	91389-00
5	Reflector, red right hand	59287-92	20	Screw, #10-16x1/2 self tap (9)	5233
	Reflector, amber right hand	59289-92	21	Washer, non metallic	91387-00
6	Reflector, red left hand	59288-92	22	Nut, keps #10-32 (3)	7629
	Reflector, amber left hand	59290-92	23	Screw, M6-6Hx25 (2)	1396
7	Plate, cam lock	91454-00	24	Screw, #8-32	3656
8	Keeper, latch	91392-00	25	Washer, flat #8	6182W
9	Medallion, H-D	90167-00	26	Screw, button head 1/4-20x1/2 (2)	4365
10	Plate, lid hinge mount	90158-00	27	Gasket, lid	90174-00
11	Plate, base hinge mount	90188-00	28	Label saddlebag	90248-00
12	Plate, latch backing	90159-00	29	Plate, hinge cover	91375-00
13	Cam, latch lever	91390-00	30	Screw, button head 1/4-20x1/4	1397
14	Latch assembly	90166-00	31	Gasket, lock (2)	90290-02
15	Hinge assembly	90151-00			