



# INSTRUCTIONS

-J00346

REV. 1-9-98

*Kit Numbers 59345-97, 59346-97, 59027-98, 59027-99*

## FLSTS MUD FLAP KIT

### General

This kit is designed for installation on:

- 1997 and later FLSTS models
- 1986 and later FLSTC (rear fender only)
- 1990 and later FLSTF (rear fender only)

Each kit contains:

QTY	DESCRIPTION
1	Mud flap
2	Panhead screws
3	Buttonhead screws
1	Reinforcement plate
1	#10 fender washer
2	#10 flat washers
3	Locknuts
1	Fender template

### Installation

#### For installation on rear fender with marker light:

1. Cut out Rear Fender Template.
2. Use a paper punch to punch out holes marked **A** and **C**. Holes **A** are the locations of the marker light screws, and hole **C** is the location of the marker light wiring. Cut along centerline of template from top down to hole **C**.
3. Remove light lens by carefully pressing down on top center of light to disengage tab.
4. Remove the two screws, washers, and nuts that hold the marker light assembly in place and carefully pull the light assembly away from the fender. Disconnect the wire connector and remove the light assembly.
5. Slip template over marker light wires, align holes marked **A** with marker light holes, and align lower edge of template with lower edge of fender. Tape template in place.
6. Prick punch holes marked **B** at indicated centers on template.
7. Carefully, and as accurately as possible, drill holes marked **B** in two steps. First drill holes with a 1/16" drill, then finish holes with a 7/32" drill.
8. See Service Parts illustration. Place the mud flap and reinforcement inside fender and secure outer holes with buttonhead screws (3), washers (6), and locknuts (7) contained in kit. The mud flap is split to fit around light assembly wires.
9. Using the longer panhead screws provided in the kit, install fender tip light and check that light is operational.

#### For installation on rear fender without marker light:

1. Using a high quality masking tape, mask the lower three inches of the middle of the fender for the purpose of drawing a centerline on the fender.
2. Using a machinist's square, locate the centerline of the fender by measuring in from each side of the fender flats. Mark the centerline on the masking tape.
3. Cut out Rear Fender Template.
4. Align centerline of template with centerline drawn on fender. Align lower edge of template with lower edge of fender. Tape template in place.
5. Prick punch holes marked **B** and **C** at indicated centers on template.
6. Carefully, and as accurately as possible, drill holes marked **B** and **C** in two steps. First drill holes with a 1/16" drill, then finish holes with a 7/32" drill.
7. See Service Parts illustration. Place the mud flap and reinforcement inside fender and secure with buttonhead screws (3), washers (5 and 6), and locknuts (7) contained in kit.

#### For installation on front fender (FLSTS only):

1. Using a high quality masking tape, mask the lower three inches of the middle of the fender for the purpose of drawing a centerline on the fender.
2. Using a machinist's square, locate the centerline of the fender by measuring in from each side of the fender flats. Mark the centerline on the masking tape.
3. Cut out Front Fender Template.
4. Align centerline of template with centerline drawn on fender. Align lower edge of template with lower edge of fender. Tape template in place.
5. Prick punch holes at indicated centers on template.
6. Carefully, and as accurately as possible, drill holes marked in two steps. First drill holes with a 1/16" drill, then finish holes with a 7/32" drill.
7. See Service Parts illustration. Place the mud flap and reinforcement inside fender and secure with buttonhead screws (3), washers (5 and 6), and locknuts (7) contained in kit.



# Service Parts

Part No. 59345-97

Date 1/97

## FLSTS Mud Flap

sp59345

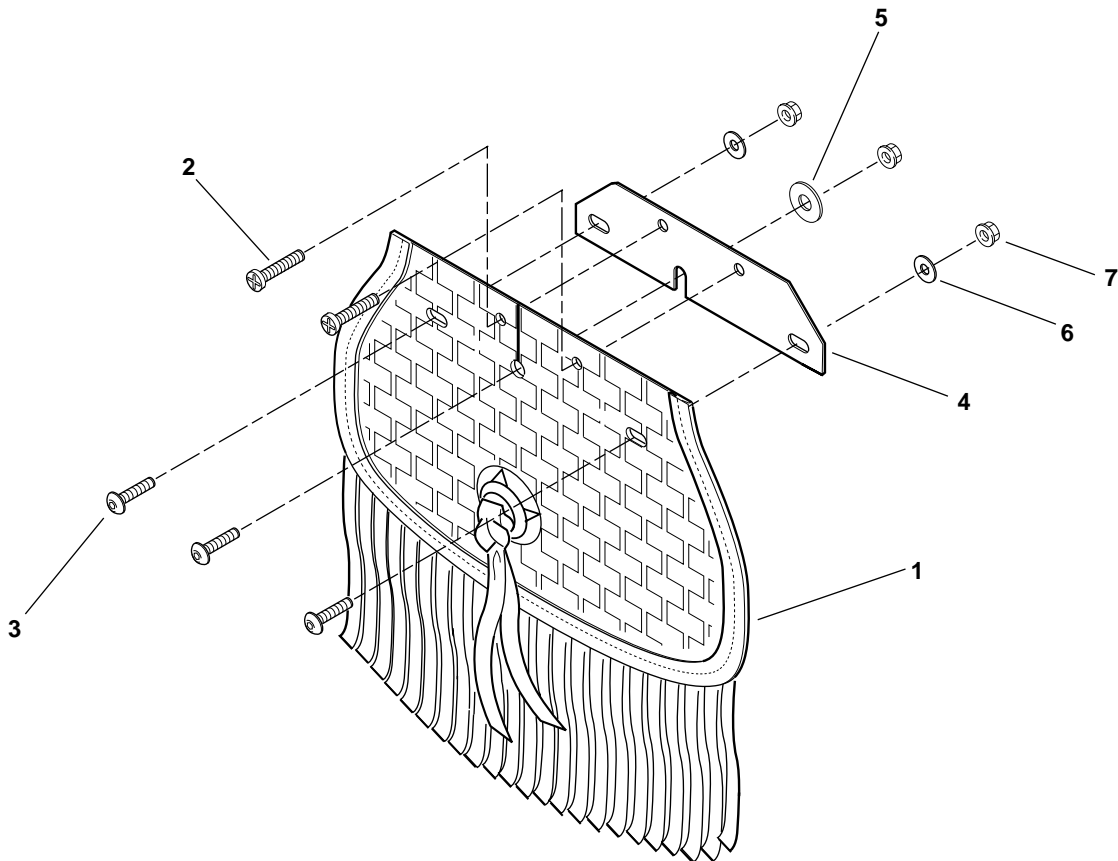

Item	Description	Part No.	Item	Description	Part No.
1	Mud flap	not sold	5	#10 fender washer	6831
2	Pan head screws (2)	2449	6	#10 flat washers (2)	6716
3	Button head screws (3)	94034-97	7	Nylon insert locknuts (3)	7626W
4	Reinforcement	not sold			

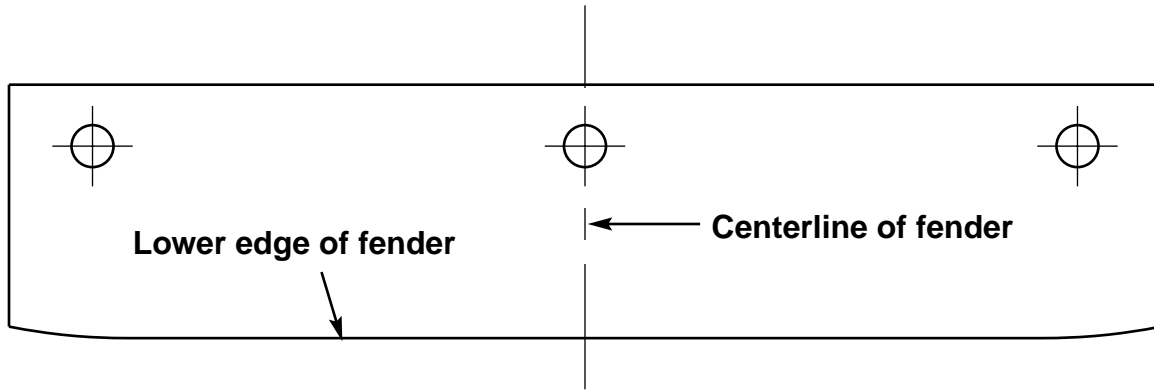

**Front Fender Template  
(FLSTS only)**

**NOTE**  
*These marks should measure  
 exactly 1 inch in each direction.  
 Please measure to verify that this  
 template is the correct size.*

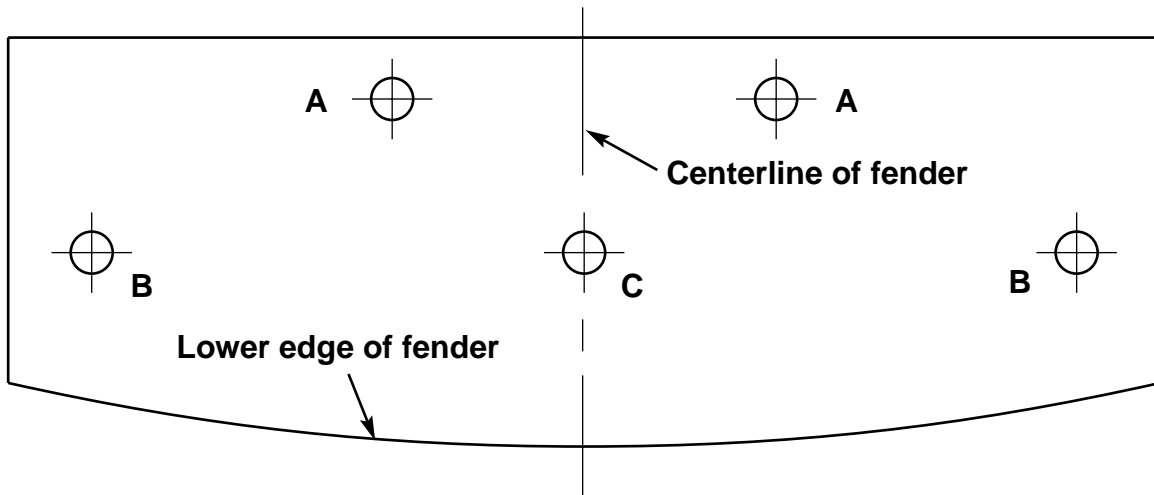
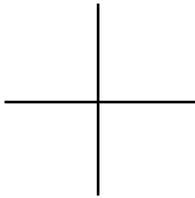

**Rear Fender Template  
(FLSTS, FLSTC, FLSTF)**