



INSTRUCTIONS

-J00578

REV 10-20-00

Kit Number 60134-01

LAYBACK LICENSE PLATE MOUNTING KIT WITH DIRECTIONAL BAR

General

This kit is designed for installation on the following models:

1999-2000 FXDS-CONV Models.

2000-2001 FXDX Models.

2001 and later FXDXT Models.

The license plate mounting bracket provided with this kit will fit license plates up to 7-1/4 inches wide by 4-1/4 inches tall.

See *Service Parts Page Illustration* for kit contents.

Installation

NOTE

A *Service Manual* for your motorcycle is available at your Harley-Davidson Dealer.

⚠ WARNING

To protect against shock and accidental start-up of vehicle, disconnect the battery cables, negative cable first, before proceeding. Inadequate safety precautions could result in death or serious injury.

⚠ WARNING

Always disconnect the negative battery cable first. If the positive cable should contact ground with the negative cable installed, the resulting sparks may cause a battery explosion which could result in death or serious injury.

1. Disconnect battery cables, negative cable first.
2. Remove two screws securing tail/stop lamp lens assembly and remove lens.

NOTE

Prior to removing turn signal wiring, refer to appendix in applicable *Service Manual* covering detailed procedures for Amp Multilock Connectors.

3. See Figure 1. Remove left and right two-place connectors from circuit board (inside rear tail lamp). Following instructions in applicable *Service Manual*, remove left and right turn signal socket terminals from connectors.
4. Cut wires at socket terminal ends as close to terminals as possible. Discard terminal ends.

NOTE

To aid in installing new turn signal wires, attach thin wire to terminals on turn signal wires before pulling wires out of conduit and directional bar. This thin wire can then be used to guide wires back through new directional bar and conduit.

5. Remove conduit from clip under fender. Unscrew the lamp housing from the directional bar and pull wiring through conduit, fender and directional bar. Save lamp housing mounting hardware. Repeat for the opposite lamp.

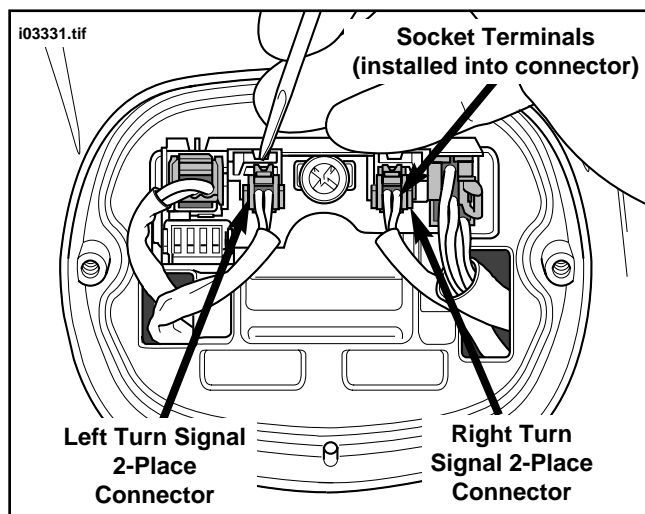

Figure 1. Remove 2-Place Connectors

6. Remove screw and nuts securing license plate bracket/directional bar and remove. Discard screw, nuts and bracket/directional bar. Clean mounting area on fender with soft damp cloth.
7. Obtain triangle gasket and new license plate bracket from kit. See Figure 2. Position triangle gasket and attach bracket using 1/2 inch screw through upper bracket hole (at 12 o'clock position). Loosely install to fender using hex kep nut (P/N 7792) from kit.
8. Insert directional bar into bracket and align bar so two directional wiring exit holes aim down, lining up with two holes in fender. Install two 3/4 inch screws through directional bar, license plate bracket and fender. Secure to fender using two remaining hex kep nuts (P/N 7792). Tighten all three bracket screws securely.

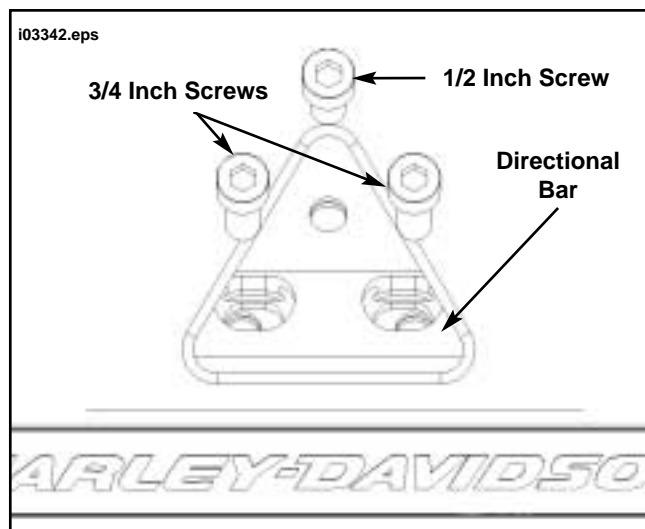

Figure 2. License Plate Bracket/Directional Bar

9. Obtain one of the turn signals removed in Step 5. Insert wiring into bar and route out through oval wiring "exit" hole in bar.
10. Align the turn signal housing on the directional bar and use mounting hardware saved in Step 5 to perform the following:
 - a. Thread nut onto directional bar.
 - b. Tighten the turn signal housing onto the bar.
 - c. Tighten nut against turn signal housing.
11. Continue to route wiring through fender and conduit, then back through fender into tail lamp assembly. Install clip (under fender) around conduit. Repeat Steps 9 through 11 for the opposite turn signal.
12. Following instructions under Amp Multilock Connectors in applicable Service Manual, install new socket terminals (P/N 73191-96) to wires, then install socket terminals to 2-place connector. Repeat for the opposite turn signal. Refer to Figure 1 and install 2-place connectors into respective positions on circuit board. Reinstall tail lamp lens.
13. See Figure 3. Obtain license plate studs and align as shown, then install each of the four stud plates through the mounting holes in the license plate using acorn nuts with flat washers. **NOTE: Finger tighten only; nuts and washers will be removed and re-installed.**

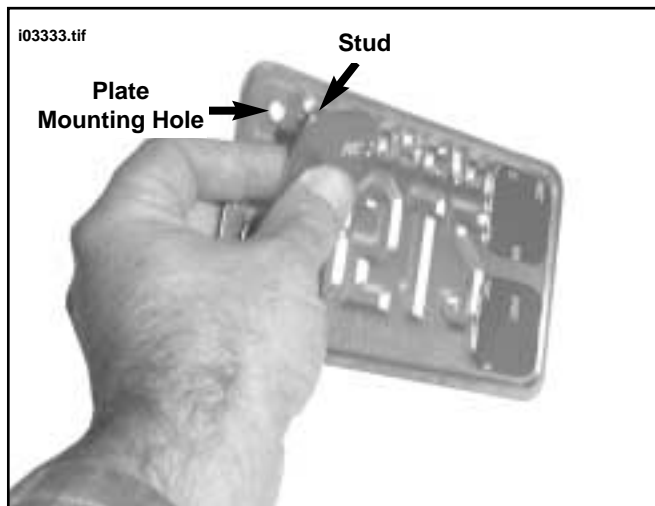

Figure 3. Align Studs to Outside Corners of License Plate

14. See Service Parts Illustration. Using isopropyl alcohol, thoroughly clean surface of the license plate mount. Let dry completely.

NOTE

License plate mount and stud plates should be at least 60° F for proper adhesion.

NOTE

You may want to conduct a trial fit prior to removing adhesive backing in the next step.

15. See Figure 4. Peel adhesive backing from each of the four stud plates. Carefully position the license plate with stud plates attached to license plate mount and press firmly into place.

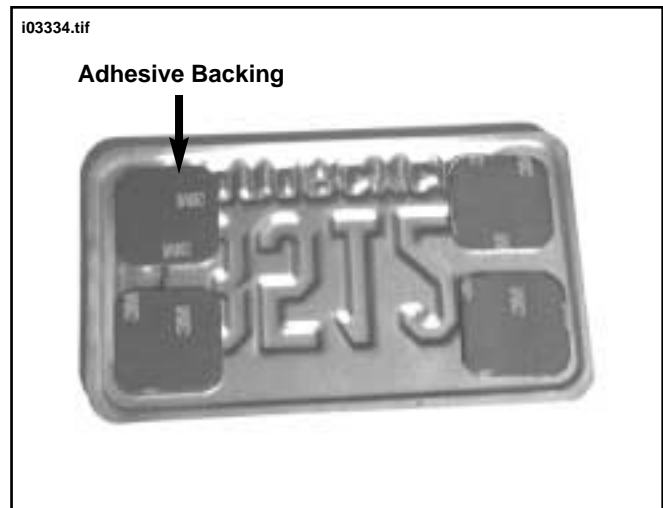

Figure 4. Peel Off Adhesive Backing from Stud Plates

16. Carefully remove the four acorn nuts and washers and remove the license plate from the studs.
17. Firmly press and rub each of the four stud plates to the bracket surface. **(The adhesive is pressure activated)** Let adhesive cure for 24 hours at 60° F.
18. Using acorn nuts and washers, re-install license plate to stud plates on mount. Tighten securely.

⚠ WARNING

Always connect the positive battery cable first. If the positive cable should contact ground with the negative cable installed, the resulting sparks may cause a battery explosion resulting in death or serious injury.

19. Connect battery cables, positive cable first.

20. Install seat if removed.

⚠ WARNING

After installing seat, pull upward on front of seat to be sure it is locked in position. If seat is loose, it could shift position during vehicle operation causing loss of control which could result in death or serious injury.

21. Check turn signals and tail lamp for proper operation.



Service Parts

Part No. 60134-01

Date 10/00

Layerback License Plate Mounting Kit

i03343.eps

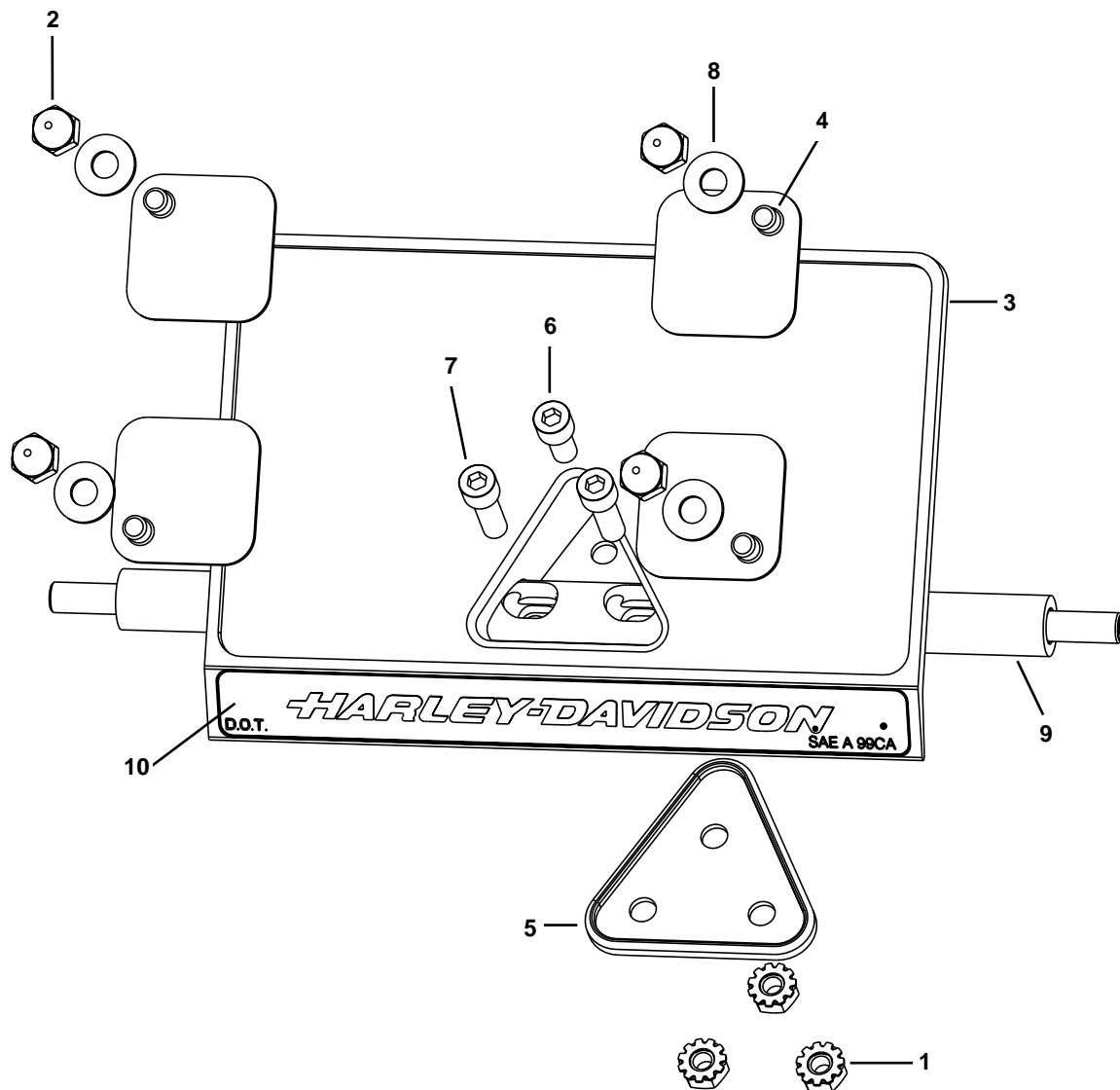

Item	Description/Qty	Part Number
1	Nut, hex kep (3)	7792
2	Nut, acorn (4)	94012-00
3	Mount, license plate	not sold
4	Plate, stud (4)	59813-00
5	Gasket, triangle	not sold
6	Screw, 1/4 X 20 X 1/2 inch	not sold
7	Screw, 1/4 X 20 X 3/4 inch (2)	not sold
8	Washer, flat 1/4 inch (4)	94065-90
9	Bar, directional	not sold
10	Tape, reflector	not sold
11	Terminals, socket (4) (not shown)	73191-96