



INSTRUCTIONS

-J00592

REV. 4-11-02

Kit Numbers 56241-96, 56246-96, 56258-96, 56263-96

CHROME AND RUBBER HANDLEBAR GRIPS

General

Kit Numbers 56241-96 and 56258-96 fit all 1982-1995 models with or without handlebar air suspension filler valve.

Kit Numbers 56246-96, and 56263-96 fit all 1996 and later models with or without handlebar air suspension filler valve.

See *Service Parts Illustration* for kit contents.

Installation

NOTE

A *Service Manual* for your motorcycle is available from your Harley-Davidson Dealer.

⚠ WARNING

Do not lubricate the left grip of handlebar in any way before installation. This could allow grip to come off while riding which could result in loss of control and death or serious injury.

1. Remove existing left handlebar grip by carefully cutting it away from the handlebar using a sharp blade or knife. Remove end cap from left handgrip, if applicable. Follow instructions in applicable Service Manual and remove right grip/throttle sleeve assembly. After removal, make sure that left and right handlebar ends are clean and smooth.

NOTE

Make sure surfaces to be glued are clean, dry and free from oil or new application may not adhere as desired. Please observe the following WARNINGS when using the adhesive contained in this kit.

⚠ WARNING

FLAMMABLE, INJURIOUS TO EYES, HARMFUL IF SWALLOWED, VAPOR HARMFUL. FLAMMABLE: CONTAINS METHYL ETHYL KETONE. Use only in well ventilated areas. Avoid contact with eyes, mucous membranes, and prolonged skin contact. KEEP OUT OF REACH OF CHILDREN. If swallowed, do not induce vomiting. call a physician immediately.

⚠ WARNING

This product contains a chemical(s) known to the State of California to cause cancer or other reproductive harm. Failure to follow instructions could result in death or serious injury.

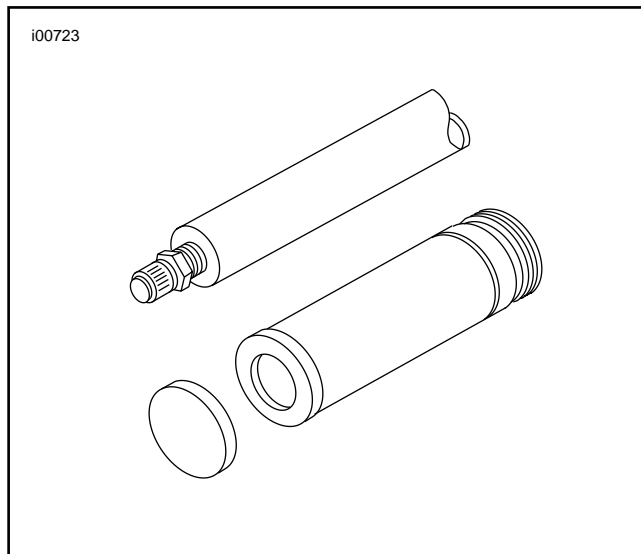

Figure 1. Aligning Left Grip With Air Valve Ends

2. Follow instructions in applicable Service Manual and install new throttle sleeve to handlebar.

NOTE

Before installing left handlebar grip, remove endcap to prevent trapping air.

3. See Figure 1. For models with handlebar mounted air valve on left handlebar, move switch housing, if necessary. This will ensure proper fitting of grip end cap.
4. Liberally apply a coat of Harley-Davidson Adhesive, Part Number 99839-95, to the inside of left handlebar grip using the cotton swab. Make sure adhesive fully covers all inside surface area of the grip. Also, apply a coat of adhesive to the handlebar end. With adhesive applied, check to make sure the horizontal pattern on left handgrip is aligned with pattern on right handgrip and immediately push the new grip completely onto handlebar end.

NOTE

Do not hesitate when installing left grip or adhesive will dry before installation is complete. Allow 6-8 hours at 70° F to achieve full cure of the adhesive.



Service Parts

Part No. 56241-96 and others

Date 12/01

Chrome and Rubber Grips

i04559

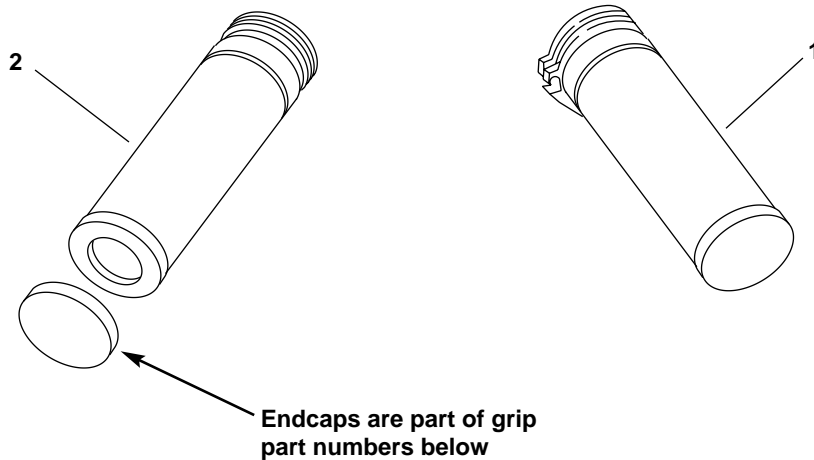

Kit Part Number 56241-96

| Item | Description | Part No. |
|------|---------------------------------------|----------|
| 1 | Grip, right (throttle) | 56245-96 |
| 2 | Grip, left | 56244-96 |
| 3 | Adhesive, 10 gram tube (not shown) | 99839-95 |
| 4 | Cotton swab (not shown) | 56009-95 |

Kit Part Number 56246-96

| Item | Description | Part No. |
|------|---------------------------------------|----------|
| 1 | Grip, right (throttle) | 56245-96 |
| 2 | Grip, left | 56247-96 |
| 3 | Adhesive, 10 gram tube (not shown) | 99839-95 |
| 4 | Cotton swab (not shown) | 56009-95 |

Kit Part Number 56258-96

| Item | Description | Part No. |
|------|---------------------------------------|----------|
| 1 | Grip, right (throttle) | 56262-96 |
| 2 | Grip, left | 56261-96 |
| 3 | Adhesive, 10 gram tube (not shown) | 99839-95 |
| 4 | Cotton swab (not shown) | 56009-95 |

Kit Part Number 56263-96

| Item | Description | Part No. |
|------|---------------------------------------|----------|
| 1 | Grip, right (throttle) | 56262-96 |
| 2 | Grip, left | 56264-96 |
| 3 | Adhesive, 10 gram tube (not shown) | 99839-95 |
| 4 | Cotton swab (not shown) | 56009-95 |