

# INSTRUCTION SHEET

**Buell**  
AMERICAN MOTORCYCLES

-J00652

Kit Number 50547-94Y

REV. 8-15-96

## FOOTPEG LOWERING KIT

### General

This kit contains mounting hardware to lower the rider footpegs for the 1995/1996 Buell S2/S2T-Thunderbolt.

QTY	DESCRIPTION
1	Footpeg lowering mount, right
1	Footpeg lowering mount, left
1	Shift lever
1	Shift rod
1	Nylon nut, toe peg
2	Nylon nut, footpeg

### Left Side Installation

1. See Figure 1. Loosen locknuts on both sides of shift rod. Remove rear turn buckle mounting nut and screw. Remove rear turn buckle and disconnect shift rod.

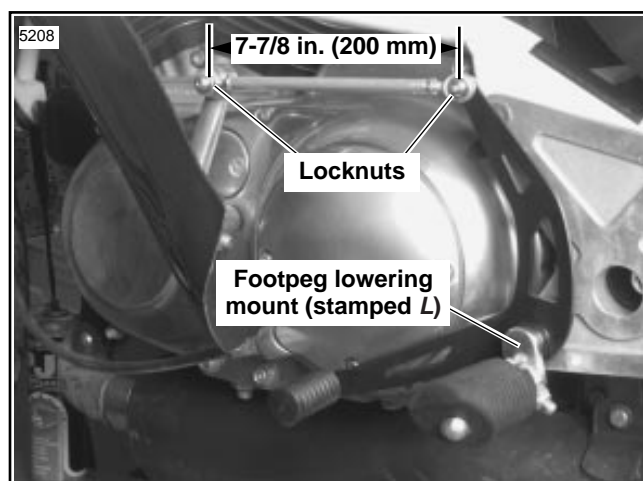

Figure 1. Shift Rod Installation

2. See Figure 2. Remove socket head cap screw (5) and hardware securing footpeg pivot mount to isolator plate. Remove footpeg pivot mount, bushings and shift lever. Keep hardware for reinstallation.
3. Remove toe peg (4) and nut (3) from shift lever. Remove footpeg (11) from old pivot mount.

#### NOTE

The footpeg lowering mounts included in this kit are stamped with a L and a R to designate left and right sides.

4. Install shift lever (2) and bushings on footpeg lowering mount (8) (stamped L). Use new bushings if necessary. (Bushings not supplied with kit. See your authorized Buell dealer.)

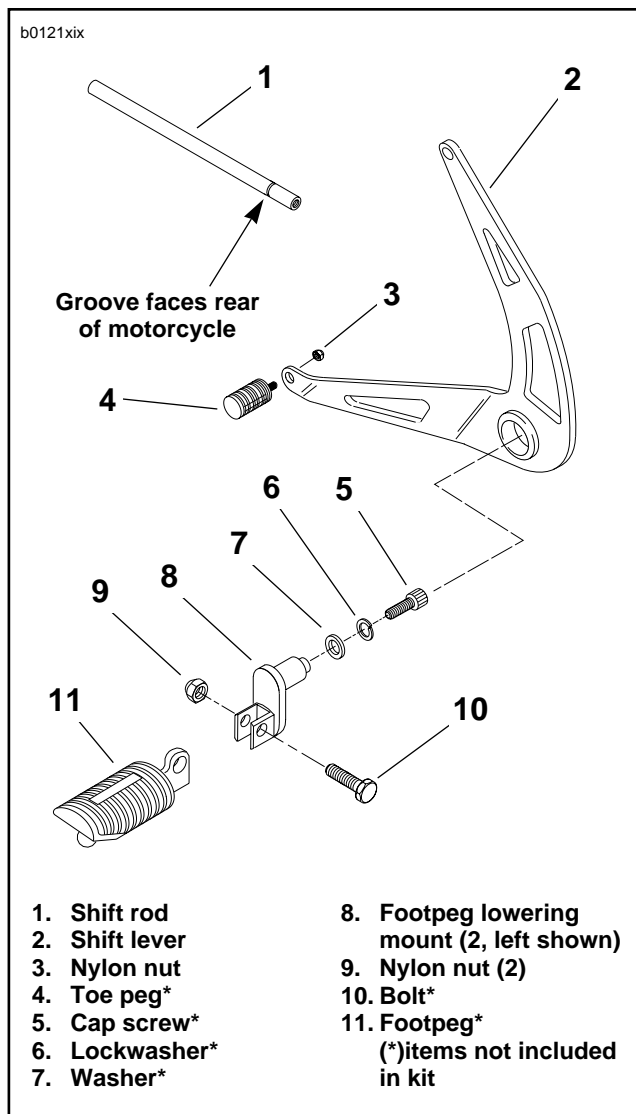

Figure 2. Lowering Kit Components

#### CAUTION

Exercise caution when installing shift lever components. Shift lever must not contact clutch cover or damage may result.

5. Mount shift lever/footpeg lowering mount assembly on isolator plate with socket head cap screw (5), lockwasher (6) and washer (7). Tighten socket head cap screw to 12 ft-lbs (16 Nm).
6. Install toe peg (4) on shift lever (2) using new nylon nut (3). Attach footpeg to footpeg lowering mount using new nylon nut (9). Tighten footpeg to 25-30 ft-lbs (34-41 Nm).

#### NOTE

See Figure 2. Left hand thread portion of shift rod (1), with groove, goes toward rear of motorcycle.

7. See Figure 1. Install new shift rod using existing hardware. There should be 7-7/8 in. (200 mm) between the shift lever and the front shift lever, measured from the retaining screws centerline.

### Right Side Installation

1. See Figure 3. Using 1/4 in. ball driver from left side, remove socket head cap screw (6), lockwasher (5), and washer (4) securing footpeg pivot mount to right isolator plate.

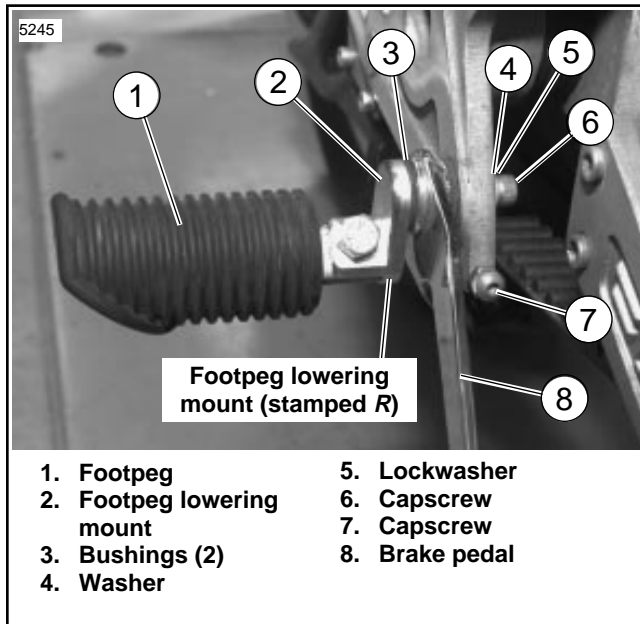

#### Attaching Solo Rack

2. Remove old footpeg pivot mount, bushings (3) and brake pedal (8).
3. Remove footpeg (1) from pivot mount.

#### NOTE

The footpeg lowering mounts included in this kit are stamped with a L and a R to designate left and right sides.

4. Install brake pedal (8) and bushings (3) on footpeg lowering mount (2) (stamped R). Use new bushings if necessary. (Bushings not supplied with kit. See your authorized Buell dealer.)
5. Mount brake pedal/footpeg lowering mount assembly on isolator plate with socket head cap screw (6), lockwasher (5) and washer (4). Tighten socket head cap screw to 12 ft-lbs (16 Nm).
6. Attach footpeg (1) to footpeg lowering mount (2) using new nylon nut. Tighten footpeg to 25-30 ft-lbs (34-41 Nm).
7. Check brake cylinder rod freeplay. Loosen jam nut. With motorcycle on level surface, adjust brake cylinder rod so that brake pedal has 3/8 in. (9.5 mm) freeplay. Tighten jam nut.
8. See Figure 3. Adjust cap screw (7) until brake pedal is parallel with swingarm/drive support bracket. Retighten jam nut if necessary.

#### NOTE

If you alter pedal height, always check pushrod freeplay.

#### WARNING

Brake rod should not be able to be removed with pedal in the unloaded state. Adjust for proper freeplay if needed with adjuster bolt on brake pedal.