

# Boom! Audio HD-N01 Quick Start Guide

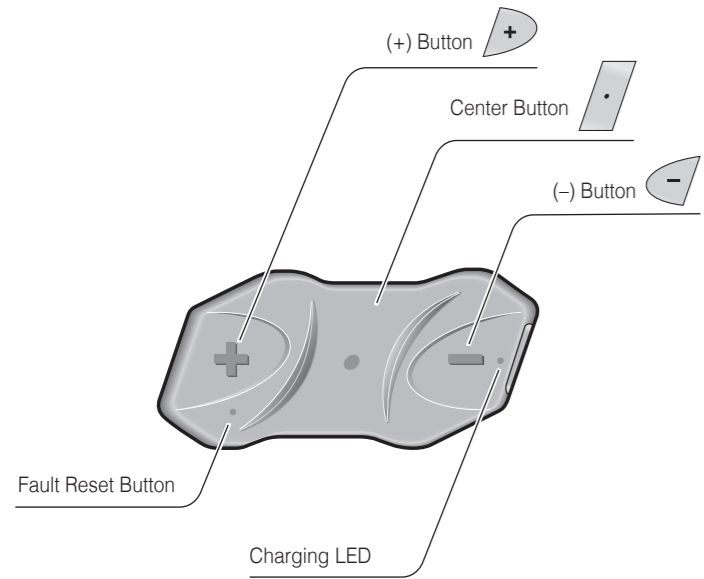

## Charging

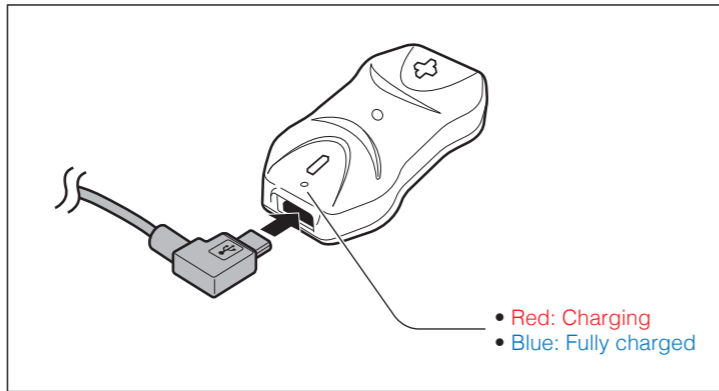

## Button Operation



## Power On/Off

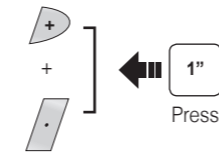

## Volume Adjustment

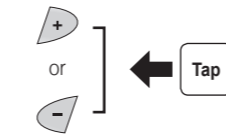

## Bluetooth Pairing Phone, MP3 and GPS

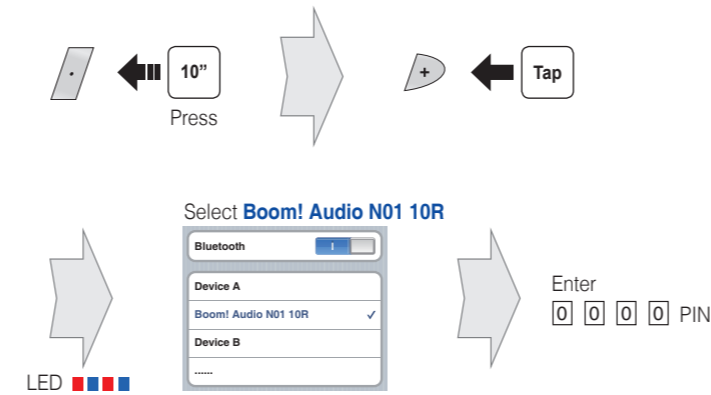

## Mobile Phone

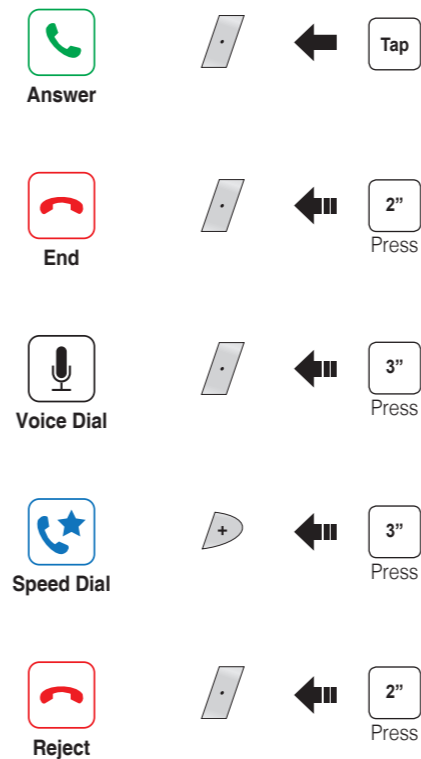

## Music

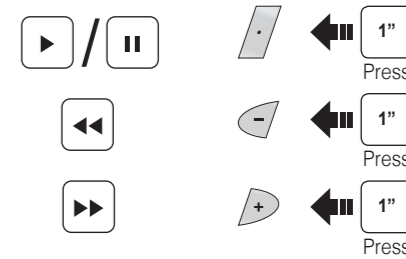

## Battery Check

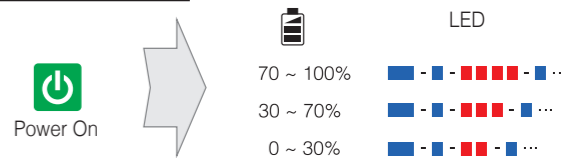

## Configuration Menu



There is **Universal Intercom Pairing** in the Configuration Menu.

### Pairing Intercom

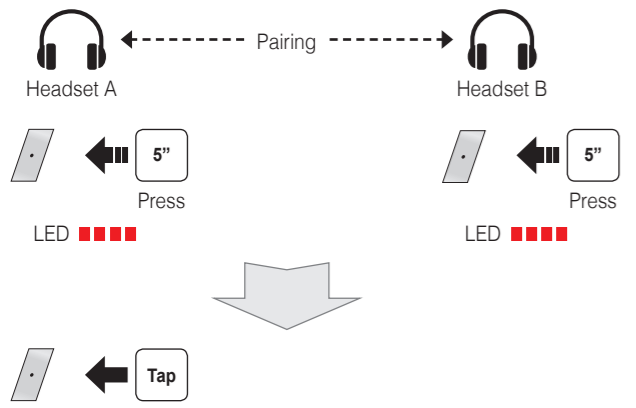

### Start/End Intercom

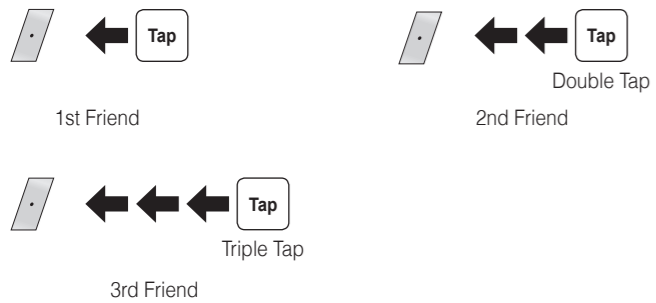

### Start/End Group Intercom

#### Start Group Intercom

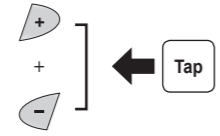

#### End Group Intercom

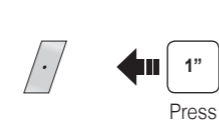

### Radio On/Off



### Radio Seek Stations

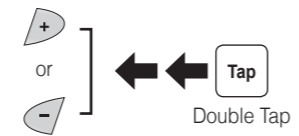

### Radio Scan Up FM Band



#### Save to preset while scanning



### Radio Save or Delete Preset



### Radio Move to Preset Station



### Setting

#### Using the Boom Audio Bluetooth Device Manager

The Device Manager allows you to upgrade the firmware and configure the device settings directly from your PC. Using this software, you can assign speed dial presets, FM radio frequency presets and more. It is available to download for both Windows and Mac. For more information on downloading the Device Manager, please visit [oem.sena.com/harley-davidson](http://oem.sena.com/harley-davidson).

#### Using the Sena Smartphone App

The Sena Smartphone App allows you to configure the device settings, create groups of intercom friends, and view the quick start guide. Simply pair your phone with your Boom! Audio HD-N01 headset, run the Sena Smartphone App and you can configure its settings directly from your smartphone. You can download the Sena Smartphone App for Android or iPhone from [oem.sena.com/harley-davidson](http://oem.sena.com/harley-davidson).

### Troubleshooting

#### Factory Reset

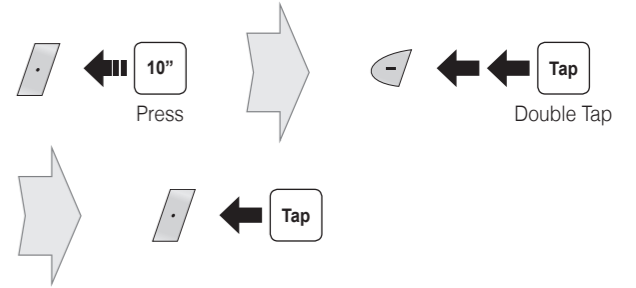

#### Fault Reset

If the Boom! Audio HD-N01 headset is not working properly for any reason, reset by gently pushing the pin-hole reset button located below the (+) button.

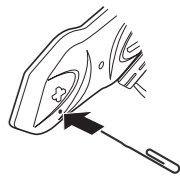

Customer Support: [support.sena.com](http://support.sena.com)  
E-mail: [support@sena.com](mailto:support@sena.com)