

RADIO

Turning System ON/OFF

1. Switch power to Accessory, Ignition or Run (CVO models).
2. If radio is OFF, press POWER (12).
3. Read the warning and select Accept.

NOTE

Pressing MUTE for more than 3 seconds will turn off radio

4. To mute or unmute audio, briefly press MUTE (12).

Select Source

1. **Navigate:** Home (7) > Audio (8).
2. **Select:** Source field (28).
3. **Select band:** AM - FM - WB (27).
4. **Select media:** USB (when connected), phone (Bluetooth), SiriusXM (if equipped) (27).

Seek and Save Station

1. **Select:** SEEK DOWN (2) or SEEK UP (3) on left hand control.
2. Press and hold preset (29) until it beeps.

Selecting a Favorite

If selecting a favorite that is saved from a phone or media device, the radio will not recognize the file unless the media source is connected.

1. **Navigate:** Home (7) > Favorites (15).
2. **Select:** Favorite.

SETUP

Audio Settings

1. **Navigate:** Home (7) > Setup (13) > Audio Settings.
2. **Adjust:** BASS or TREBLE.

Saving a Favorite

1. **Navigate:** Home (7) > Favorites (15).
2. Press and hold desired preset until screen title changes to **Select a Favorite Type**.
3. **Select:** Type.
 - a. Tuner: Currently playing station, SXM, AM, FM or WB.
 - b. Phone: Recent, Contacts on Radio or Contacts on Phone. Select from list.
 - c. Location: Recent or Saved. Select from list.
 - d. Media: USB. Select from list.

ITEM	ICON	FUNCTION
1	🏠	Home Short Press: Toggles between current screen and Home screen. Long Press: Toggles the Quick Jump screen.
2	⏮	Previous /Seek Down Media: Previous media file. Tuner: Tune/seek down.
3	⏭	Next/Seek 3 Up Media: Next media file. Tuner: Tune/seek up.
4	🔊+	Volume Up: Increases volume.
5	🔊-	Volume Down: Decreases volume.
6	🗣️	Voice Recognition: Initiates a voice recognition session.
7	🏠	Home: Displays Home screen.
8	🎵	Audio: Displays active source with audible content information.
9	📍	Navigation: Displays map with current position.
10	☎️	Phone: Displays menus for staying connected.
11	ℹ️	Info: Displays vehicle status.
12	🔇	Mute/Power: Toggles power on and off.
13	⚙️	Setup: Configure system settings. Do before riding the motorcycle.
14	📞	Communication: Displays enabled communication devices.

ITEM	ICON	FUNCTION
15	★	Favorites: Displays saved favorites.
16	🔊	Audio Setup: Displays audio setting screen.
17	↶	Back Button Short Press Back to previous screen. Long Press: Screen transitions between normal day color and high contrast color.
18	SQ +	CB Squelch +: Increases CB squelch level (if equipped).
19	PTT	CB Push to Talk: Press and hold to transmit on CB/intercom (if equipped).
20	SQ -	CB Squelch -: Decreases CB squelch level (if equipped).
21	▲	Cursor Up: Moves the highlighting up through the selections.
22	▶	Cursor Right: Moves the highlighting right through the selections. Tuner: Next preset up.
23	▼	Cursor Down: Moves the highlighting down through the selections.
24	◀	Cursor Left: Moves the highlighting left through the selections. Tuner: Next preset down.
25	↵	Select/Enter: Selects highlighted item.
26	🏠	Quick Jump.
27	FM	Band/Media.
28	▭	Source Field.
29	1	Preset.

SETUP (cont.)

Speaker Volumes

1. **Navigate:** Home (7) > Setup (13) > Audio Settings > Speaker Volumes.
2. **Adjust:** Media/Tuner, Prompt Nav, Phone, CB, Beep.

Activating Headsets or Speakers (if equipped with headset)

1. **Navigate:** Home (7) > Setup (13) > Audio Settings > Audio Routing.
2. **Select:** Speaker or headset.

Streaming Audio

NOTE

The device must first be paired with the Boom! Audio system before it can be used - See BLUETOOTH

Device must also support Bluetooth audio streaming profile

1. **Navigate:** Home (7) > Audio (8).
2. **Select:** Source button (28).
3. **Select media:** Phone (Bluetooth) (27).

BLUETOOTH

Pair a Phone or Other Device

1. Activate Bluetooth on your device.
2. **Navigate:** Home (7) > Phone (10).
3. **Prompt:** No device connected. Would you like to connect a device?
 - a. **Select:** Yes.
4. **Select:** Add new device.
5. **Prompt:** Does PIN match on device?
 - a. Check PINs (auto-generated) on audio system and device.
 - b. **Select:** Yes (if numbers match).
6. **Prompt:** Would you like to set an Emergency number?
 - a. **Select:** Yes or No.

PHONE

NOTE

The phone must first be paired with the audio system before it can be used through the Boom!™ Box infotainment system - see BLUETOOTH

A Harley-Davidson headset with microphone is required to make and receive calls via Bluetooth

Making a Call

1. **Navigate:** Home (7) > Phone (10).
2. **Select:** Calls, Contacts, SOS (Emergency) or Keypad.

Receiving a Call

1. **Select:** Accept or Ignore.

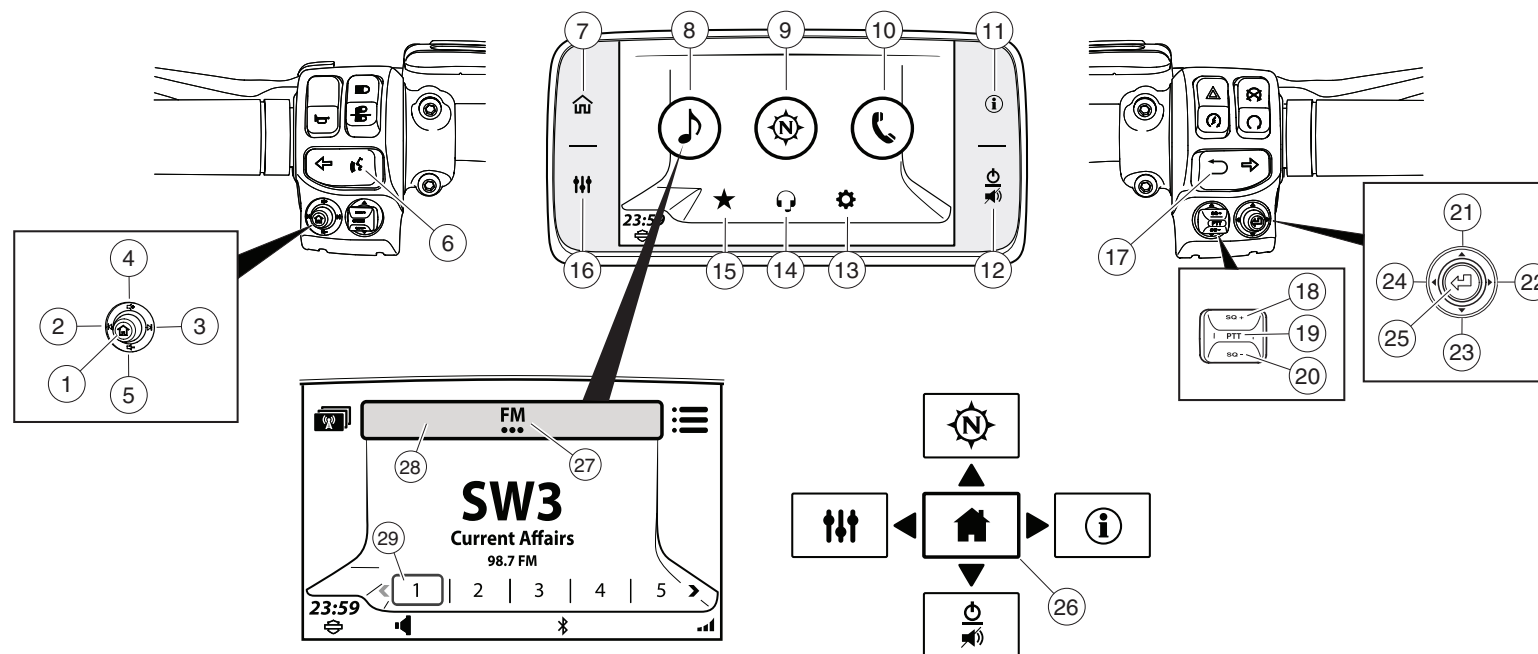

NAVIGATION SYSTEM

One Box Search

1. **Navigate:** Home (7) > Navigation (9).
2. **Select:** Search (30).
3. **Select:** Search.
 - a. Input location information.

Route to Destination: Go Home

1. **Navigate:** Home (7) > Navigation (9).
2. **Select:** Search (30).
3. **Select:** Go Home.

Saving a Destination: Go Home

1. **Navigate:** Home (7) > Navigation (9).
2. **Select:** Search (30).
3. **Select:** Go Home.
4. From Set Home screen, select a destination (perform a search, select a recent destination, select a POI or a Saved file).
5. **Select:** Save.
6. **Select:** As Home.

Skip Waypoint

NOTE

While in route and from Map screen

1. **Select:** Menu (31).
2. **Select:** Skip.
3. **Select:** Yes.

Route to Destination: Repeat Navigation Instruction

1. **Select:** Repeat icon (33). This will repeat the last command given by navigation.

Canceling or Pausing a Route: Using Menu

1. **Select:** Stop icon (32) on the map screen.
2. **Select:** Stop or Pause.

NOTE

When selecting a new route, the system provides a notification to either add or replace the existing route

There is no need to manually cancel the current route when adding or replacing it with a new route

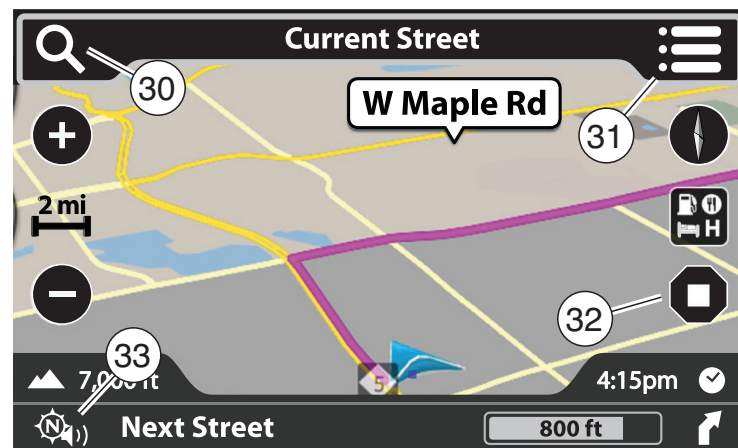

Quick Jump (26)

On the left-hand control do a long press on the Home button (1). This will display the Quick jump screen.

VOICE RECOGNITION

1. **Select:** Voice recognition (6).
2. When the system beeps, speak a voice command into headset microphone.

ITEM	ICON	FUNCTION
30		Search: Opens up search bar.
31		Menu: Opens a menu of additional options. Select the icon again to return to the original screen.
32		Pause or stop route.
33		Repeat: Repeat navigation route instruction.
34		Apple CarPlay: Takes the things you want to do with your iPhone while riding and puts them right on your radio's display.
35		Android Auto: Takes the things you want to do with your Android phone while riding and puts them right on your radio's display.

ACTIVATION REQUIREMENTS

Apple CarPlay®/Android™ Auto

- Rider headset with microphone connected to radio through a wired or wireless connection.¹
- An iPhone 5 or newer/An Android phone running Android 5.0 and up with a data plan.²
- iPhone or Android phone connected via the USB port.

¹ The vehicle may require the purchase and installation of additional parts or accessories to enable wired/wireless headset connections. Consult your Harley-Davidson® dealer.

² An Android 6.0 phone and up is recommended for best performance.

Setup

NOTE

No app is required for Apple CarPlay operation.

1. Switch power to Accessory, Ignition or Run (CVO™ models).
2. **Connect:** Wired or wireless headset to vehicle.
3. **Connect:** iPhone to USB port on vehicle.
 - a. CarPlay icon (34) or Android Auto icon (35) replaces phone icon (10) on Home page.
4. **Select:** CarPlay (34) or Android Auto (35).
5. Apple CarPlay is visible on radio screen.

Troubleshoot

If Apple CarPlay/Android Auto does not activate, in no specific order please verify:

1. Headset is connected to vehicle.
2. iPhone/Android phone is connected via USB port.
3. Projection Mode is turned on in radio settings.
 - a. **Navigate:** Home (7) > Setup (13).
 - b. **Select:** Projection Mode ON.
4. Verify Apple CarPlay is enabled in iPhone settings/Android Auto app is installed and up to date (from Google Play Store).
5. Verify Siri is enabled in iPhone settings/GTS Radio software is M21.20.17.00 for Android Auto operation.
6. Verify Apple CarPlay can be accessed while iPhone is locked in iPhone settings/ALL notifications for Android Auto are turned off.
7. Verify factory phone USB cable is used. This ensures proper performance for data change.

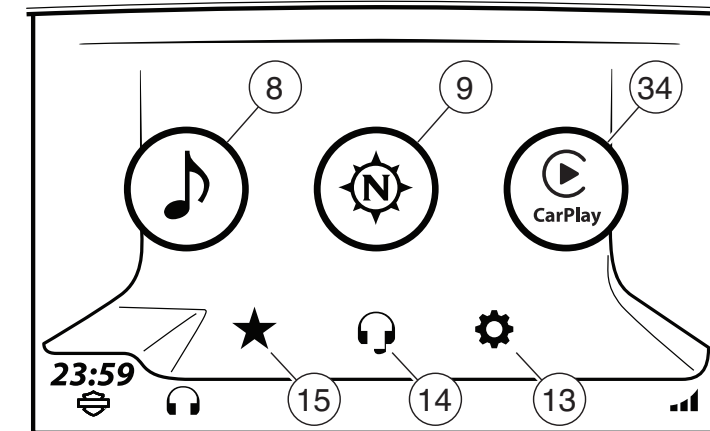

Boom!™ Box Home Screen with CarPlay.

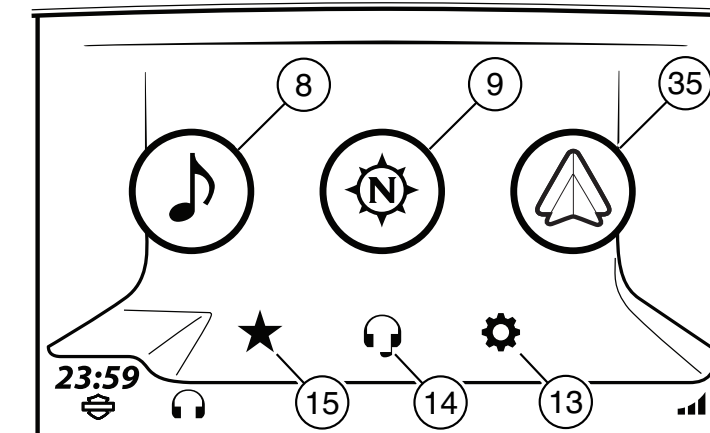

Boom!™ Box Home Screen with Android Auto.

Apple CarPlay is a trademark of Apple Inc., registered in the U.S. and other countries. Android Auto is trademark of Google LLC., registered in the U.S. and other countries.

HARLEY-DAVIDSON

A full version of the Boom!™ Box 6.5 GTS owner's manual downloadable at Harley-Davidson.com or H-D.com/BoomBoxGTS/manual

Harley-Davidson Customer Care Representative: 1-800-258-2464 or 414-343-4056.

Representatives are available: Monday through Friday, 8:00 a.m. – 8:00 p.m. Central Standard Time (CST)